

CODING
-5523004

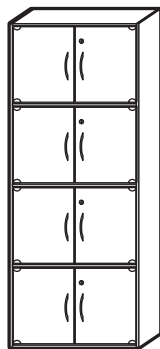

ISO 9001:2015
Reg. No. 000435-1-MY-1-QMS

nuhoom.com

Read the instructions carefully. Remove all the wrappings, staples and straps from the carton. Refer to the hardware and furniture part list for guidance. Make sure that you have all the parts before you start assembling. Place all the wooden furniture parts on a clean, flat and soft surface, such as a carpet or rubbermat to prevent scratches.

CAUTION

KEEP ALL THE PARTS OUT OF REACH OF CHILDREN.

ITEM	HARDWARE LIST		QTY
①		M5 x 40mm JCBCW Screw	20
②		M4 x 25mm Chipboard Screw	16
③		M3.5 x 12mm Chipboard Screw	32
④		Nail	24
⑤		Wood Dowel 6 x 25mm	20
⑥		Door Support 15mm	16
⑦		Leg Nail	4
⑧		Handle(1009)	8
⑨		Cam Lock 40mm	4
⑩		Door Stopper	4
⑪		Magnet	4
⑫		Magnet Plate	8
⑬		Hanger Plate	4
⑭		Allen Key	1

ITEM	PART LIST		QTY
Ⓐ	Side Panel		2
Ⓑ	Top Panel		1
Ⓒ	Shelf & Bottom Panel		4
Ⓓ	Back Panel		1
Ⓔ	Left Door Panel (Azure Blue)		1
Ⓕ	Left Door Panel (Pink)		1
Ⓖ	Left Door Panel (Apple Green)		1
Ⓗ	Left Door Panel (Orange)		1
Ⓘ	Right Door Panel (Azure Blue)		1
Ⓙ	Right Door Panel (Pink)		1
Ⓚ	Right Door Panel (Apple Green)		1
Ⓛ	Right Door Panel (Orange)		1

CODING
-5523004

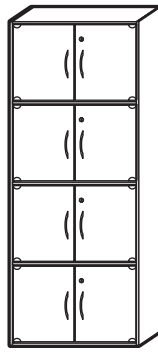

ISO 9001:2015
Reg. No. 000435-1-MY-1-QMS

nuhoom.com

Step 1

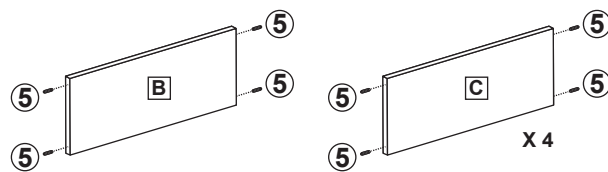

Step 2

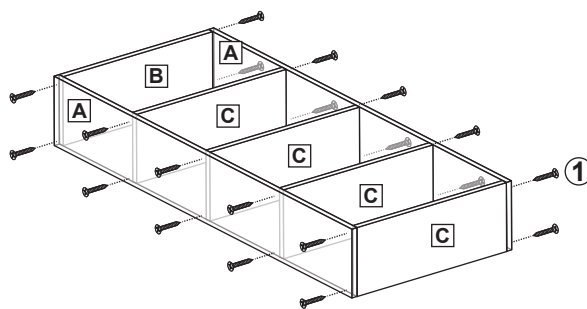

Step 3

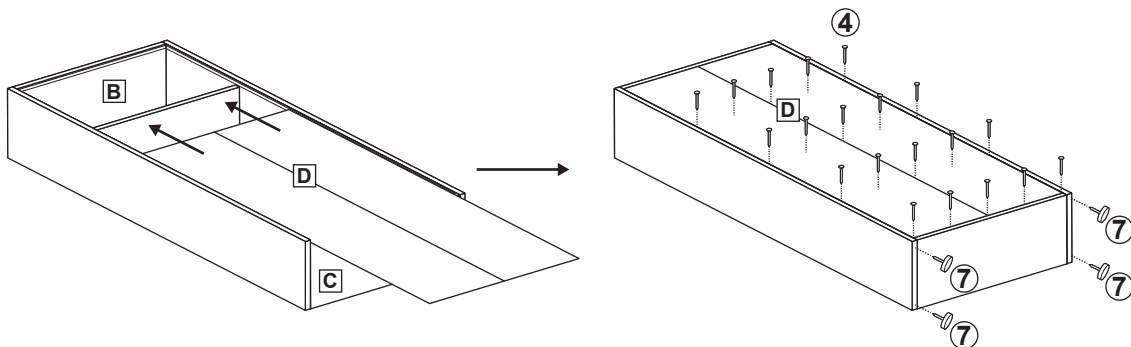

Step 4

