

CODING

-511037



ISO 9001:2015
Reg. No. 000435-1-MET-1-QMS

nuhoom.com

Read the instructions carefully. Remove all the wrappings , staples and straps from the carton. Refer to the hardware and furniture part list for guidance. Make sure that you have all the parts before you start assembling. Place all the wooden furniture parts on a clean, flat and soft surface, such as a carpet or rubbermat to prevent scratches.

CAUTION

KEEP ALL THE PARTS OUT OF CHILDREN'S REACH.

NO	PHOTO	HARDWARE LIST	QTY
A		JCBCW Screw M7 x 60mm	8
B		CSK Screw M4 x 32mm	4
C		Wood Dowel M8 x 30mm	2
D		Shelf Support 5/16	4
E		M4 Allen Key	1

ITEM	PHOTO	PART LIST	QTY
1		Table Top	1
2		Table Apron (Front)	1
3		Table Apron (Back)	1
4		Center Panel	1
5		Drawer	1
6		Table Bottom Panel	1
7		Table Side & Leg	2

CODING

-511037



ISO 9001:2015
Reg. No. 000435-1-MEX-1-QMS

nuhoom.com

1

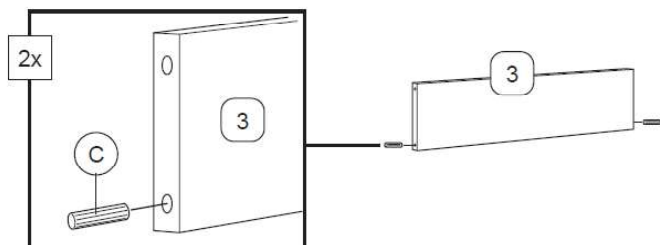

2

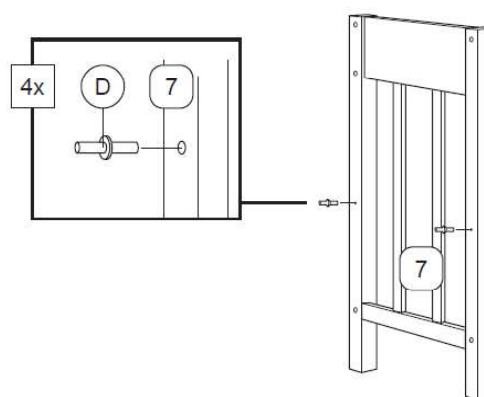

3

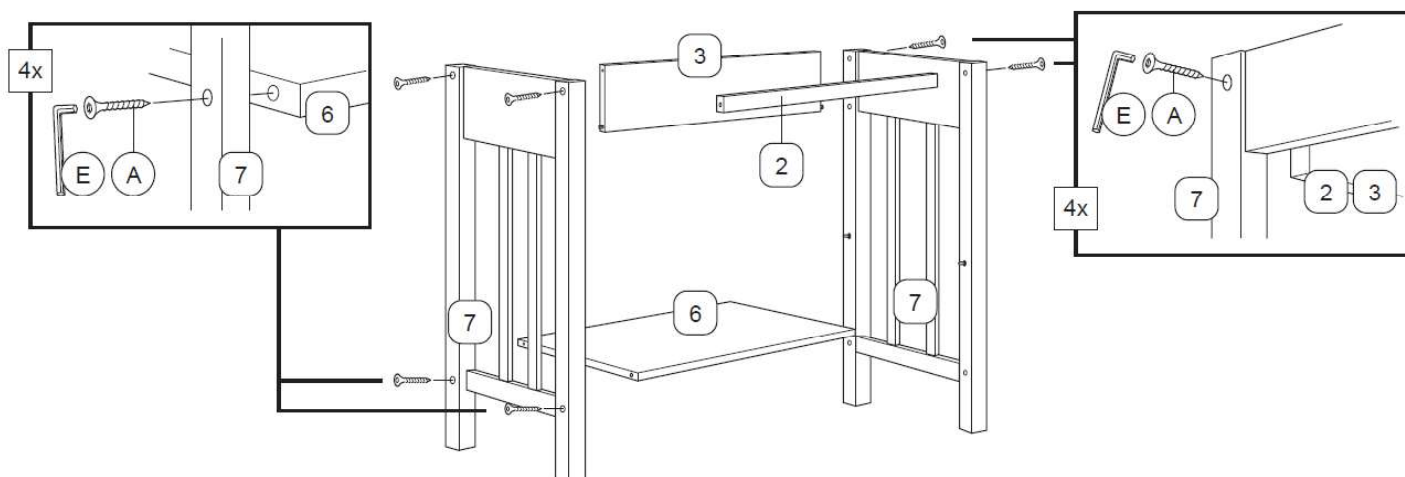

CODING

-511037



ISO 9001:2015
Reg. No. 000435-1-MEX-1-QM5

nuhoom.com

4

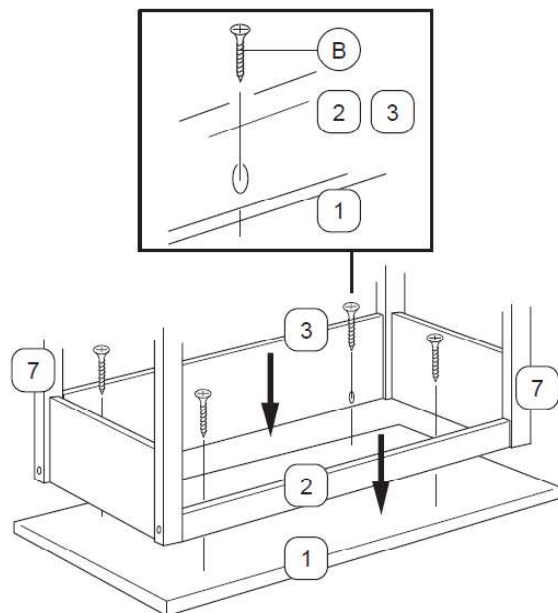

5

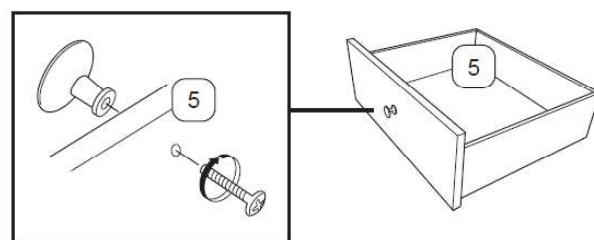

6

