

CODING

- 373007
- 373006



ISO 9001:2015
Reg. No. 000435-1-MY-1-QMS

nesthouz.com

Read the instructions carefully. Remove all the wrappings , staples and straps from the carton. Refer to the hardware and furniture part list for guidance. Make sure that you have all the parts before you start assembling. Place all the wooden furniture parts on a clean, flat and soft surface, such as a carpet or rubbermat to prevent scratches.

CAUTION

KEEP ALL THE PARTS OUT OF CHILDREN'S REACH.

ITEM	PHOTO	HAREWARE NAME	QTY
(A)		MINIFIX	18
(B)		CAM 15/12	18
(C)		DOWEL Ø8 X 30MM	20
(D)		UNITAR SCREW	2
(E)		SOFT CLOSE HINGES 7/8	4 SET
(F)		SOFT CLOSE HINGES 5/8	2 SET
(G)		CSK SCREW M3.5 X 15MM	38

ITEM	PHOTO	HAREWARE NAME	QTY
(H)		CSK SCREW 3.1 X 20	14
(I)		POP LATCH (PUSH OUT MAGNET)	3
(J)		SHELF STOPPER (5mm)	16
(K)		BACKPLY STOPPER	14
(L)		L SHAPE LEG	4
(M)		SAFETY STRAP	1
(N)		M4 ALLEN KEY	1

CODING
- 373007
- 373006



ISO 9001:2015
Reg. No. 000435-1-MY-1-QMS

nesthouz.com

ITEM	PARTS NAME	QTY
①	Side Panel	1
②	Side Panel	1
③	Top Panel	1
④	Mid Panel	1
⑤	Fix Panel	1
⑥	Bottom Panel	1
⑦	Bottom Support Panel	2
⑧	Fix Panel	1
⑨	Shelves Panel	2
⑩	Shelves Panel	2
⑪	Door Panel	1
⑫	Door Panel	1
⑬	Door Panel	1
⑭	Back Panel	2
⑮	Back Panel	1
⑯	Bottom Back Panel	1

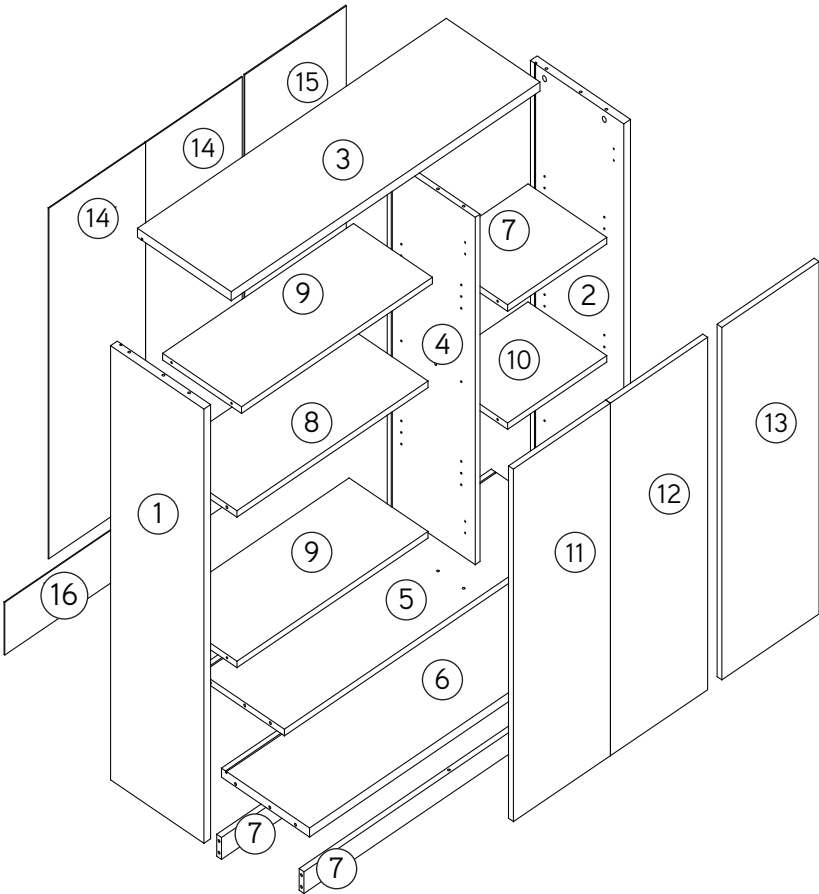

CODING

- 373007
- 373006



ISO 9001:2015
Reg. No. 000435-1-MY-1-QMS

nesthouz.com

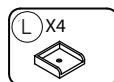
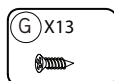
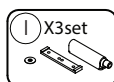
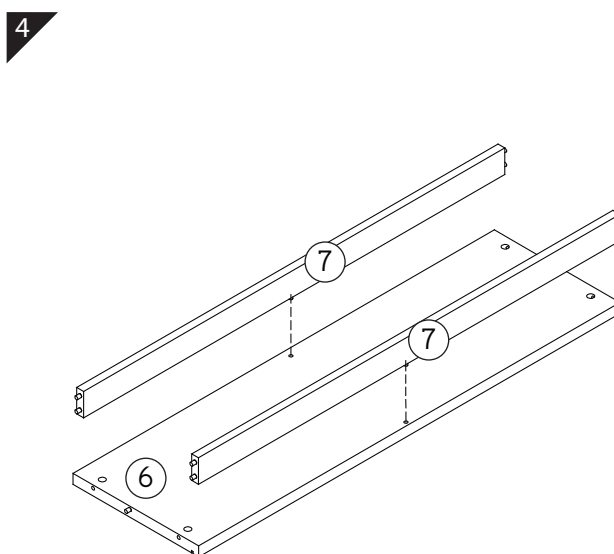
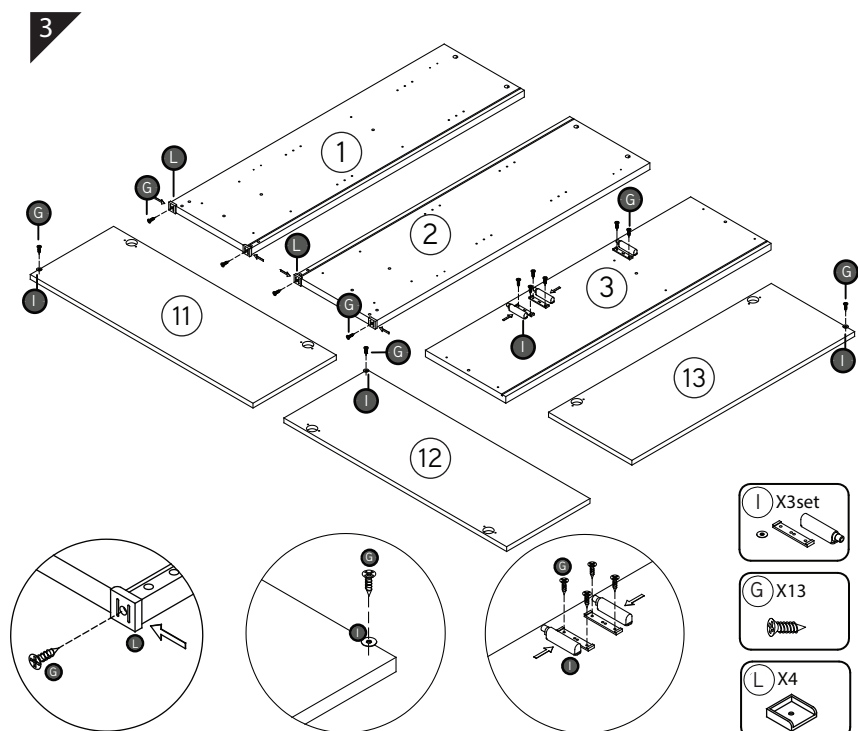
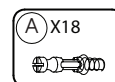
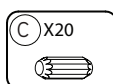
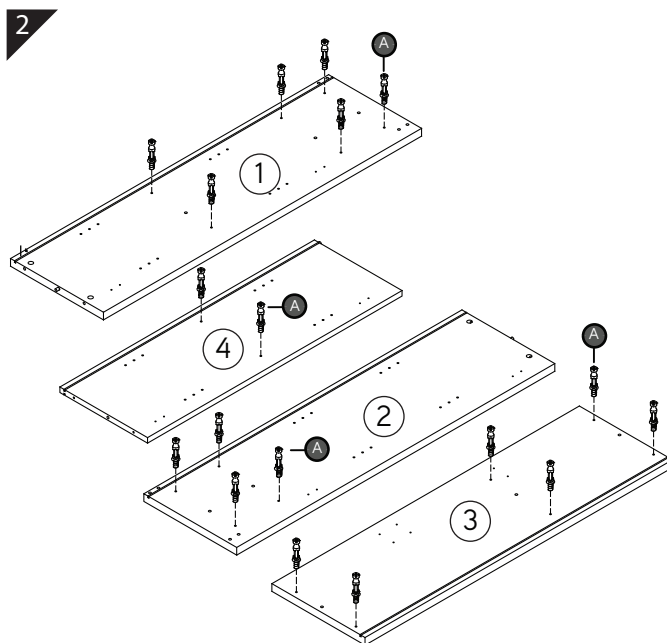
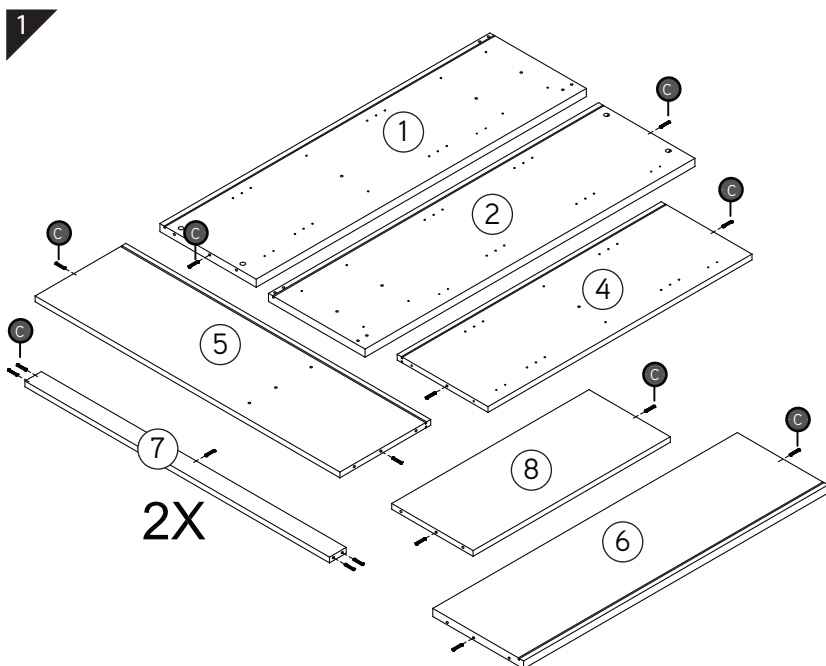

CODING

- 373007
- 373006



ISO 9001:2015
Reg. No. 000435-1-MY-1-QMS

nesthouz.com

5

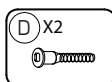
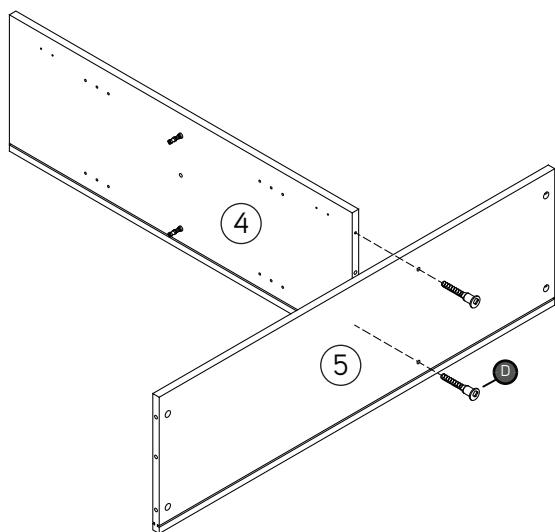

6

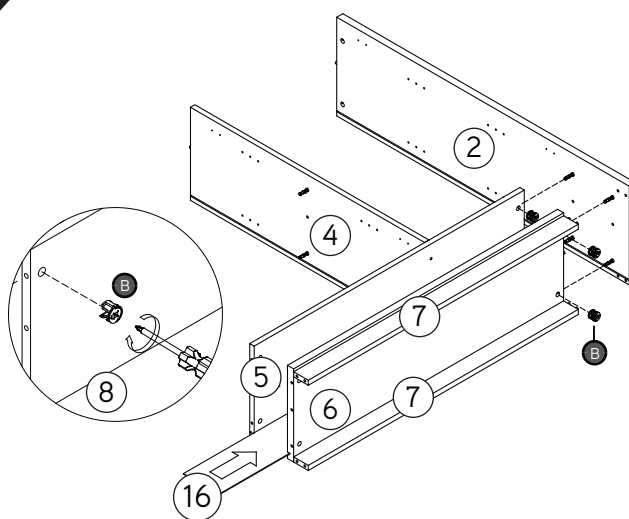

7

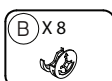
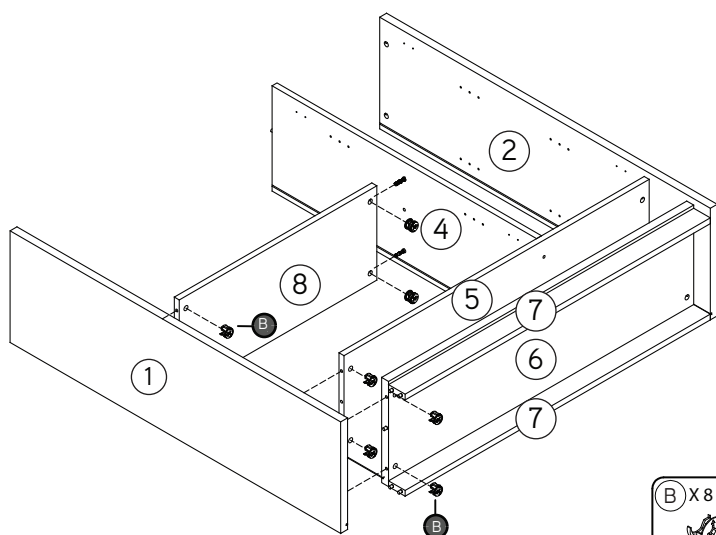

8

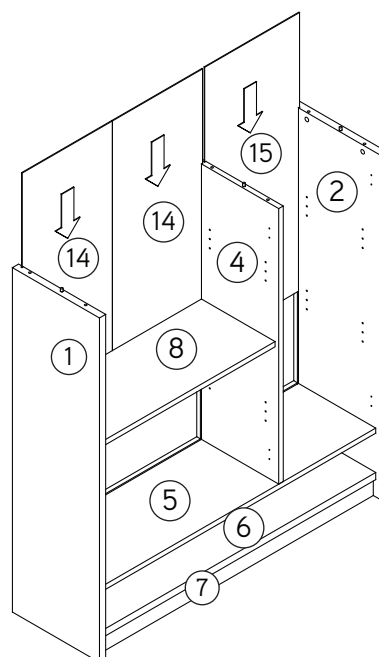

CODING

- 373007
- 373006



ISO 9001:2015
Reg. No. 000435-1-MY-1-QMS

nesthouz.com

9

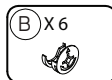
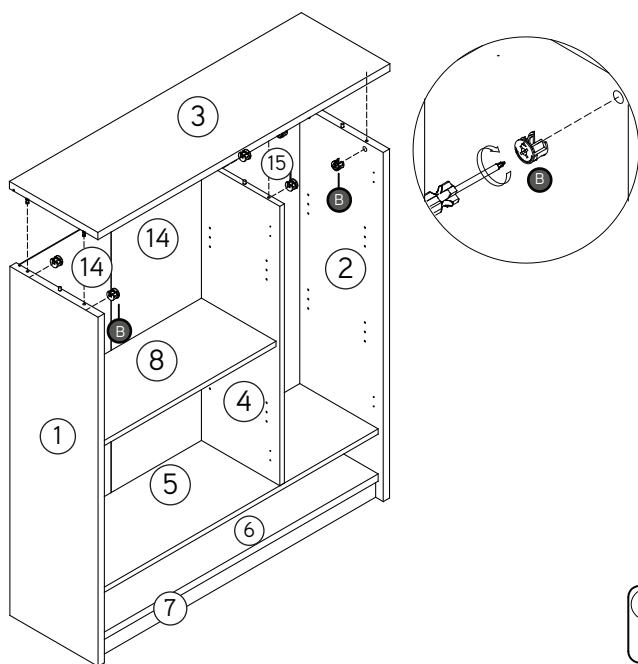

10

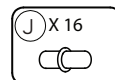
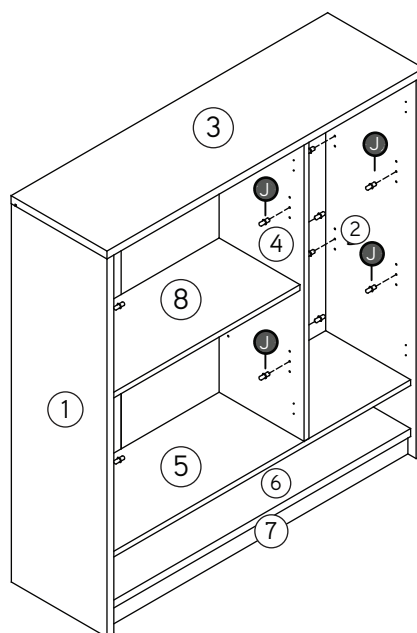

11

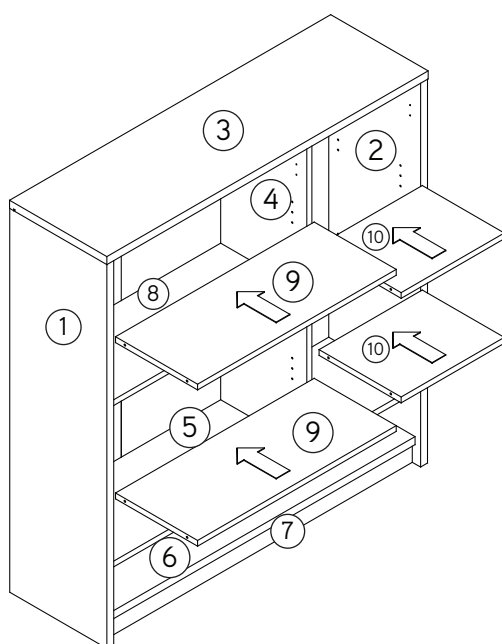

12

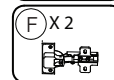
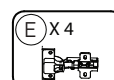
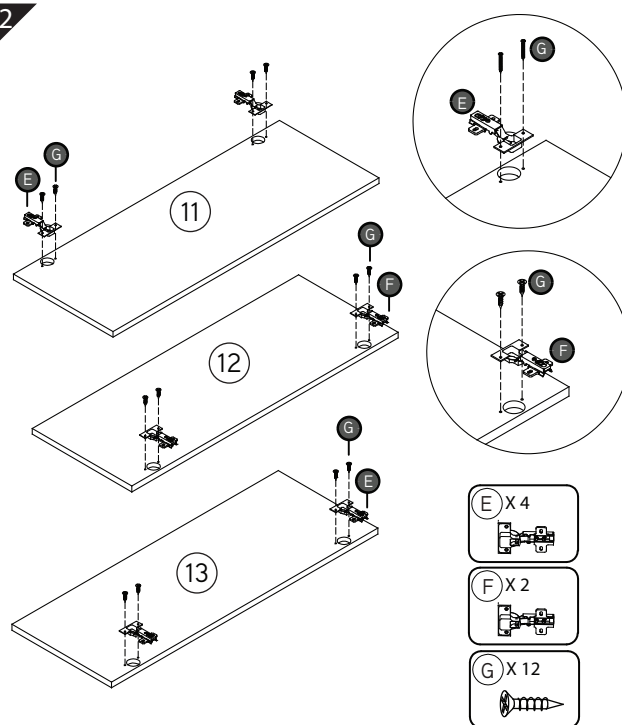

CODING

- 373007
- 373006



ISO 9001:2015
Reg. No. 000435-1-MY-1-QMS

nesthouz.com

13

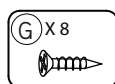
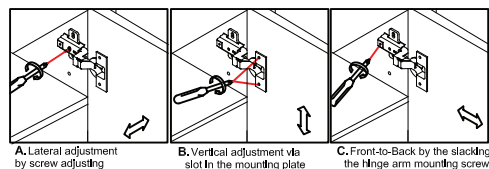
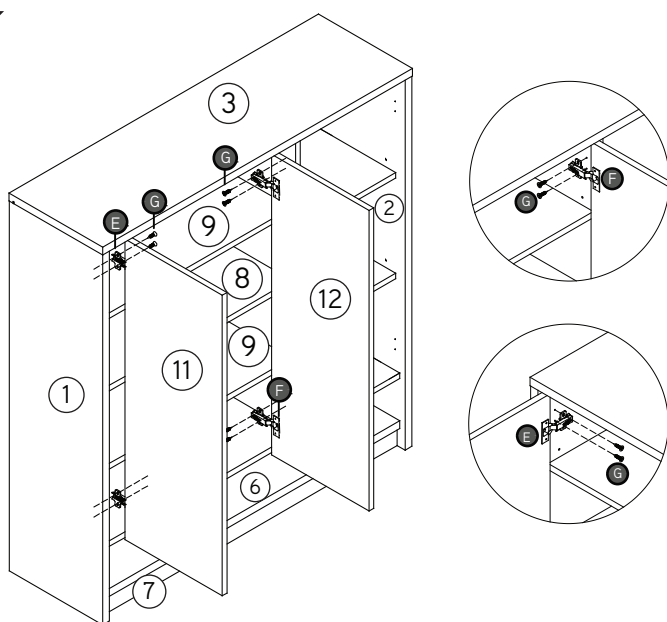

14

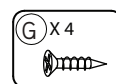
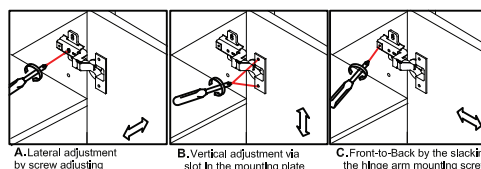
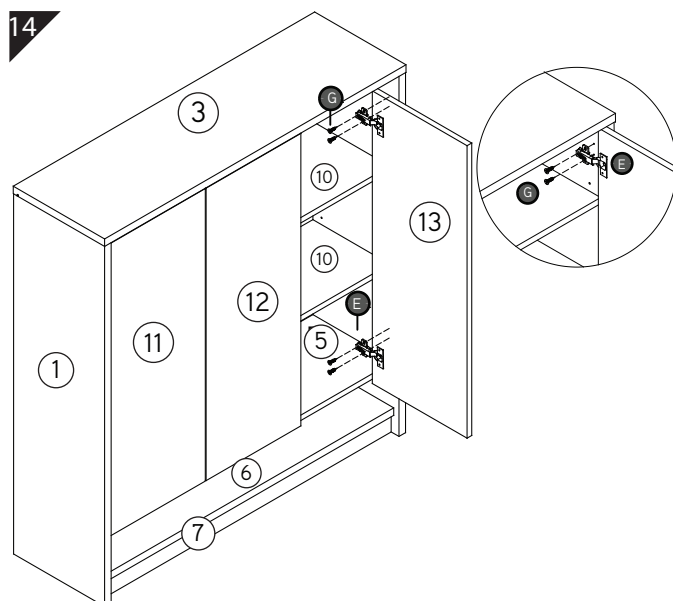

15

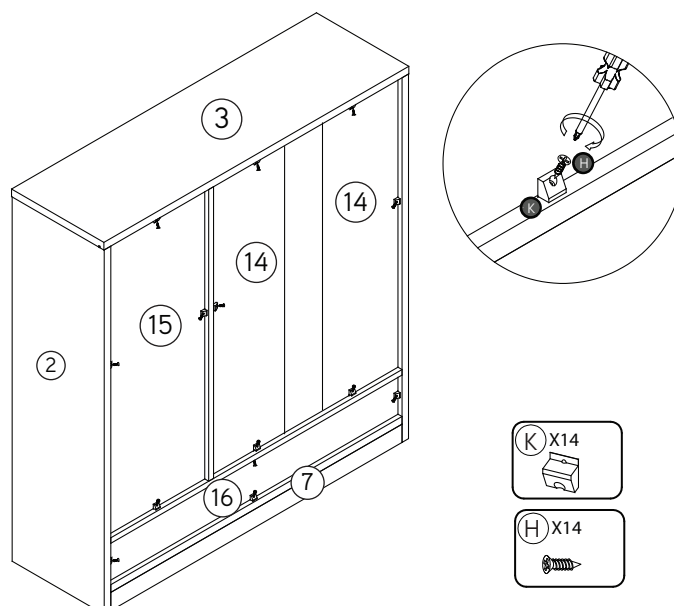

CODING

- 373007
- 373006



ISO 9001:2015
Reg. No. 000435-1-MY-1-QMS

nesthouz.com

FITTING OF ANTI-TIP SAFETY STRAP

STEP 1:
Push the screw and make hole on top panel of your furniture

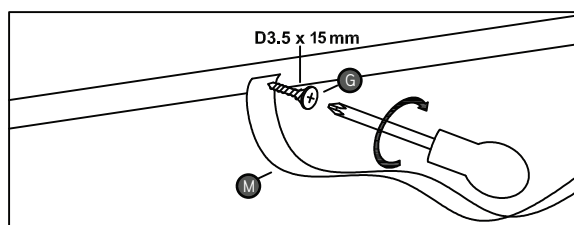

STEP 2:
Make a hole on the wall and pull the wall plug in

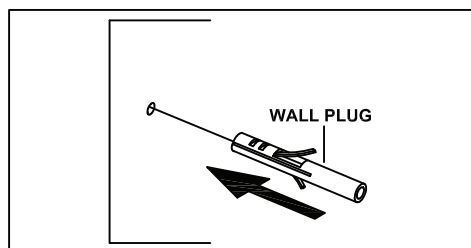

STEP 3:
Pull the screw in the wall plug hole

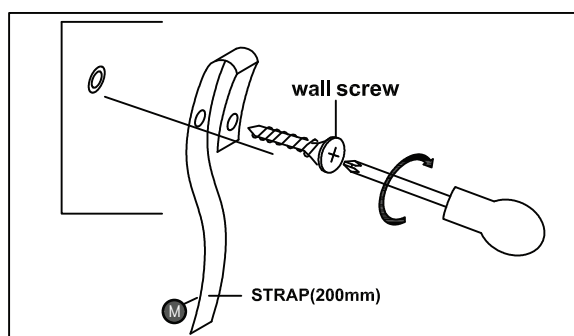

NOTE : Wall fixing are not supplied with this product as different wall materials require different types of fixing devices (such as Rawl plugs on brick work). You must use fixing devices suitable for the type of wall you intend to mount this product to. Please ensure that the head of any screw used has a diameter greater than the diameter of the mounting hole on the product and that the fixing is safe and secure before use.

The straps and screws which to fix the strap on to the furniture are provided only.

HARDWARE LIST



STRAP(200mm)-1Pc

