

CODING
- 372050

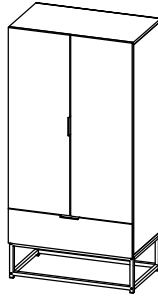

ISO 9001:2015
Reg. No. 00005-1-INT-1-QMS

nuhoom.com

Read the instructions carefully. Remove all the wrappings, staples and straps from the carton. Refer to the hardware and furniture part list for guidance. Make sure that you have all the parts before you start assembling. Place all the wooden furniture parts on a clean, flat and soft surface, such as a carpet or rubbermat to prevent scratches.

CAUTION
KEEP ALL THE PARTS OUT OF CHILDREN'S REACH.

HARDWARE			
A	MINI FIX	A1 A2 A3	8 SETS
B	M8 X 30MM WOOD DOWEL		12 PCS
C	M6 X 50MM CSK CAP WOOD SCREW		4 PCS
D	ALLEN KEY M4		1 PC
E	JCBC SCREW M6 X 30MM		4 PCS
F	JCBC SCREW M6 X 40MM		8 PCS
G	M3 X 12MM C.B SCREW		4 PCS
H	M3.5 X 16MM C.B SCREW		36 PCS
I	M4 X 38MM C.B SCREW		8 PCS
J	5/8 NAIL		36 PCS
K	METAL SHELF SUPPORT		8 PCS
L	SOFT CLOSING 5/8 HINGES		4 PCS
M	HANDLE 4020 L BAR 100MM		2 PCS
N	14" DRAWER SLIDE	N1 (L/R) N2 (L/R)	1 SET

TIPPING PACK WITH A1		2 SETS
----------------------	--	--------

SELF-PREPARED TOOLS: Tools below are NOT included in package.	
SCREWDRIVER	HAMMER

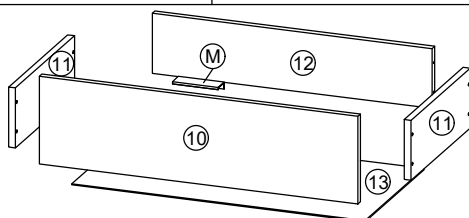

PART LIST		QTY
1	TOP PANEL	1 PC
2	BOTTOM PANEL	1 PC
3	SIDE PANEL (L)	1 PC
4	SIDE PANEL (R)	1 PC
5	MIDDLE PANEL	1 PC
6	SHELF PANEL	2 PCS
7	BACK PANEL	1 PC
8	DOOR PANEL (L)	1 PC
9	DOOR PANEL (R)	1 PC
10	DRAWER FRONT	1 PC
11	DRAWER SIDE	2 PCS
12	DRAWER BACK	1 PC
13	DRAWER BOTTOM	1 PC
14	METAL SIDE	2 PCS
15	METAL SUPPORT	4 PCS

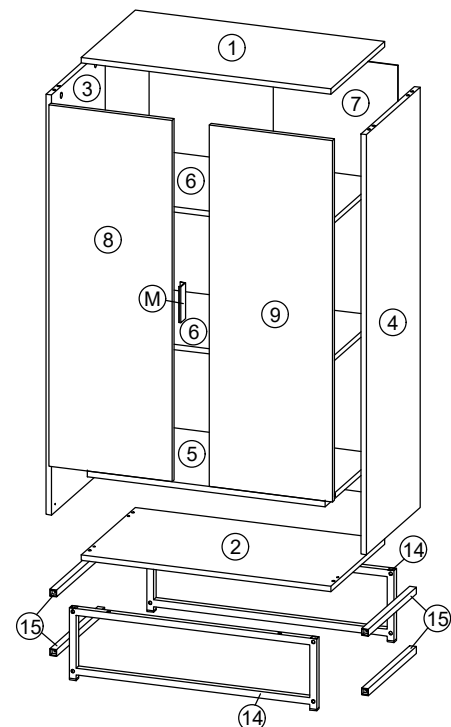

CODING
- 372050

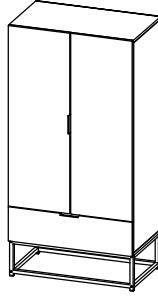

ISO 9001:2015
Reg. No. 00005-1-INT-1-QMS

nuhoom.com

STEP 1

- Insert hardware **A1** onto panel (3), (4) and (5). (Repeat 8 times.)
- Insert hardware **A2** onto panel (1), (3) and (4). (Repeat 8 times.)
- Insert hardware **B** onto panel (3), (4) and (5). (Repeat 12 times.)

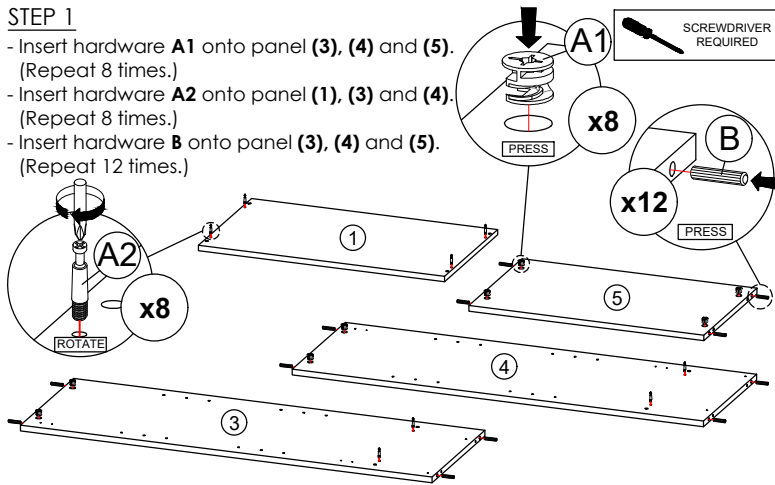

* Ensure the arrows on hardware **A1** point towards mounting positions.

STEP 2

- Fix hardware **N1 (L)** into panel (3) with hardware **H**. (Repeat 3 times for each hardware.)

STEP 2

- Fix hardware **N1 (L)** into panel (3) with hardware **H**. (Repeat 3 times for each hardware.)

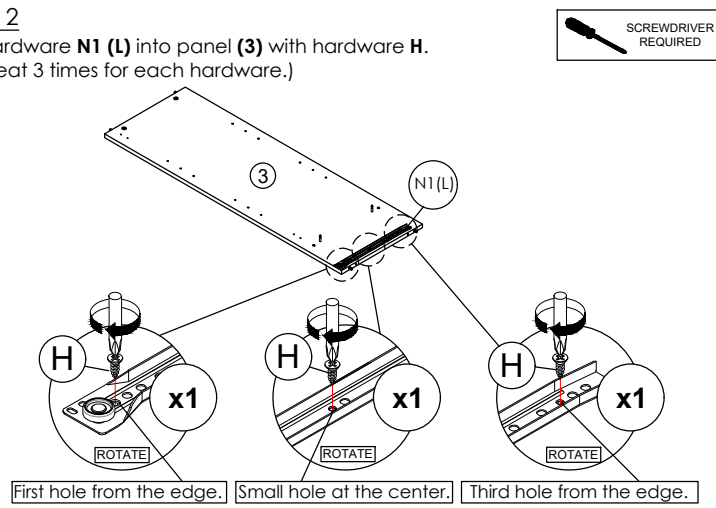

STEP 3

- Fix hardware **N1 (R)** into panel (4) with hardware **H**. (Repeat 3 times for each hardware.)

STEP 4

- Attach panel (3) and (4) to panel (5).
- Insert all hardware **A2** into **A1**.
- Rotate all **A1** until tight.
- Apply **A3** onto all **A1**. (Repeat 4 times.)

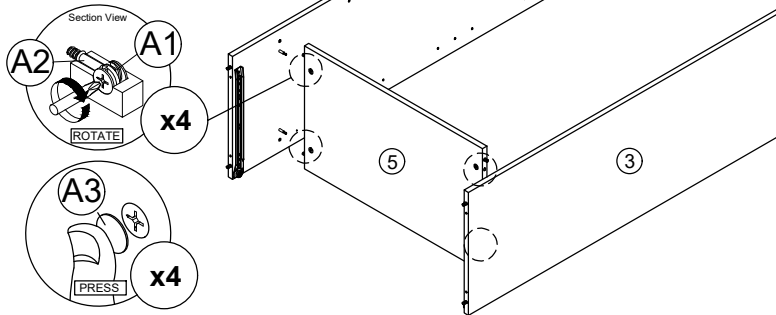
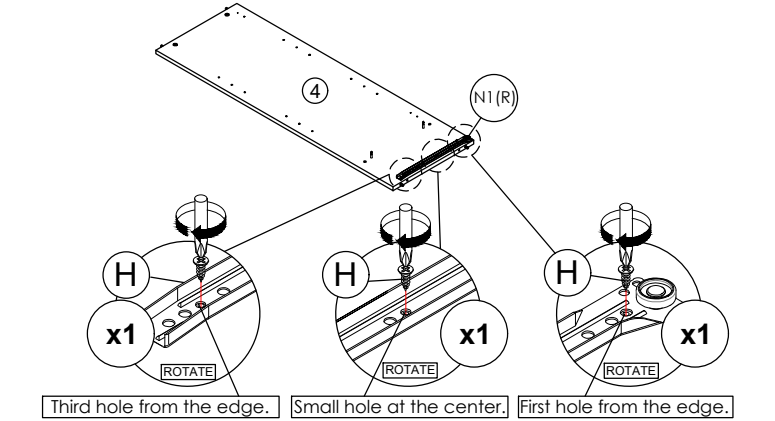

* In this step hardware **A1**, **A2** and **B** are pre-inserted.

STEP 5

- Attach panel (1) to panel (3) and (4).
- Insert all hardware **A2** into **A1**.
- Rotate all **A1** until tight.
- Apply **A3** onto all **A1**. (Repeat 4 times.)

STEP 6

- Connect panel (2) to panel (3) and (4) by using hardware **C** and **D**. (Repeat 4 times.)

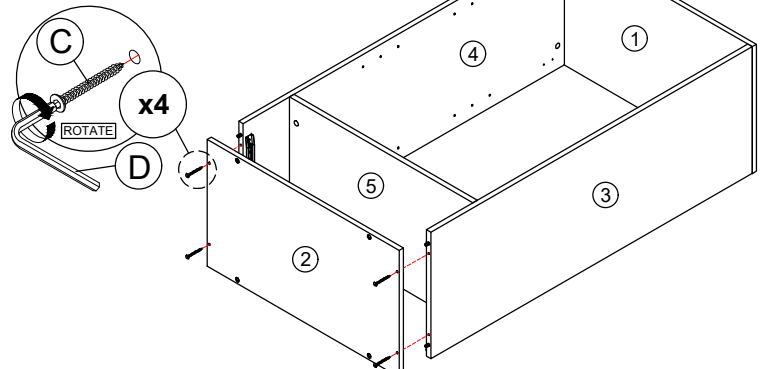
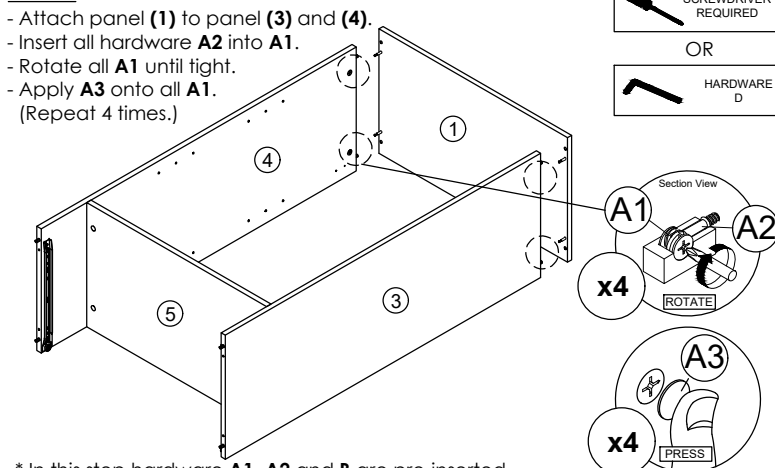

* In this step hardware **B** are pre-inserted.

* In this step hardware **A1**, **A2** and **B** are pre-inserted.

CODING
- 372050

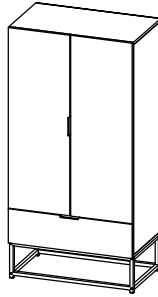

ISO 9001:2015
Reg. No. 00005-1-INT-1-QMS

nuhoom.com

STEP 7

Assemble panel (7) to entire body with hardware J.
(Repeat 24 times.)

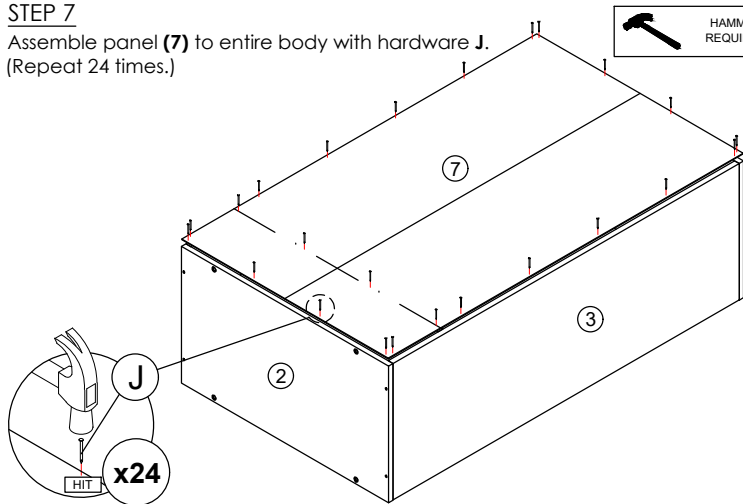

STEP 8

Connect Metal Side (14) to Metal Support (15)
by using hardware D and F.
(Repeat 8 times.)

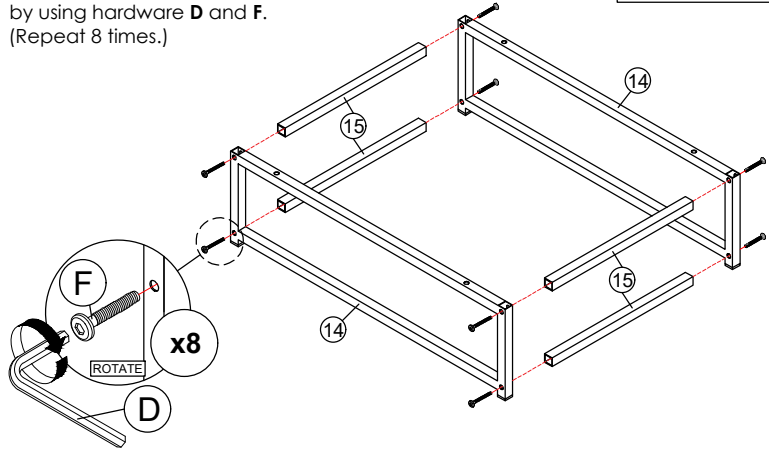

STEP 9

Connect Metal Side (14) to panel (2) by using
hardware D and E.
(Repeat 4 times.)

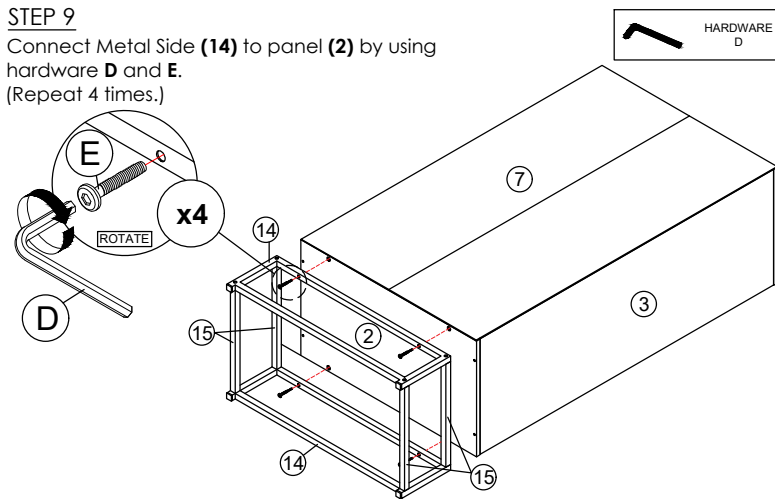

STEP 10

- Insert hardware K into mounting positions on panel (3) and (4) by hand.
(Repeat 8 times.)
- Assemble the panel (6) into between panel (3) and (4).
(Repeat 2 times.)

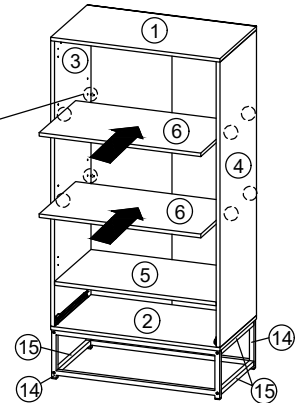
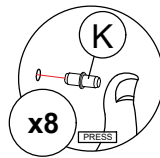

STEP 11

Fix hardware L onto panel (8) and (9) by using hardware H.
(Repeat 2 times for each hardware.)

Fix hardware M onto panel (8) and (10) by using hardware G.
(Repeat 2 times for each hardware.)

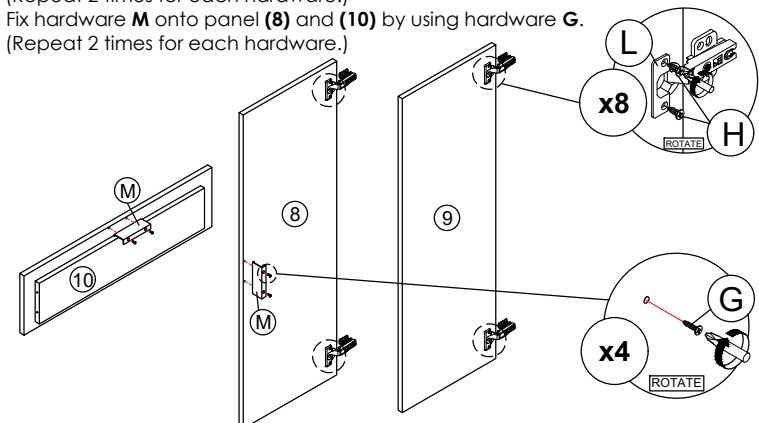

STEP 12

- Fix hardware L into panel (3) and (4) by using hardware H.
(Repeat 4 times for each hardware.)

- Tighten or loosen the screw to adjust position of panel (8) and (9).
(Do only when needed.)

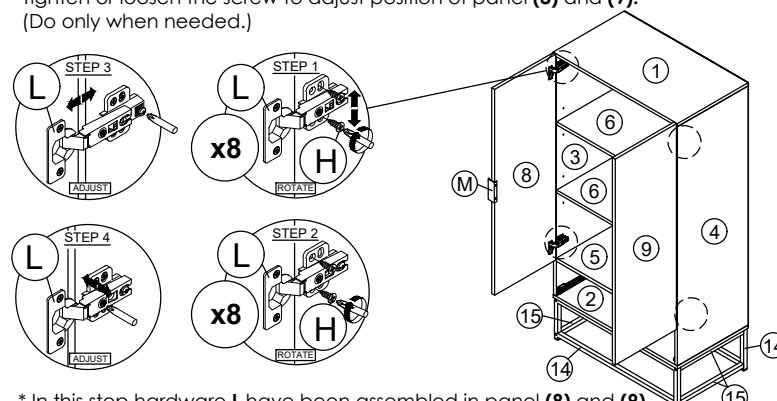

* In this step hardware L have been assembled in panel (8) and (9).

CODING
- 372050

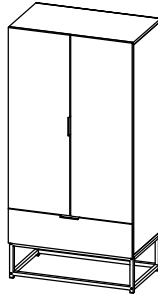

ISO 9001:2015
Reg. No. 00005-1-INT-1-QMS

nuhoom.com

STEP 13

Assemble panel (11) with panel (10) and (12) by using hardware I.
(Repeat 8 times.)



STEP 14

Assemble panel (13) to entire body with hardware J.
(Repeat 12 times.)

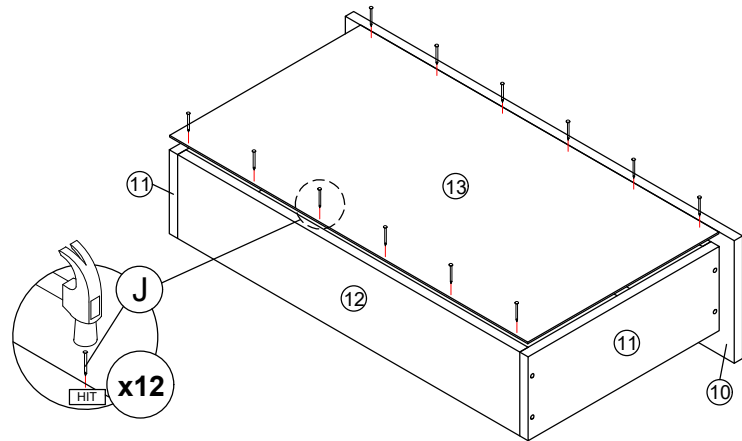
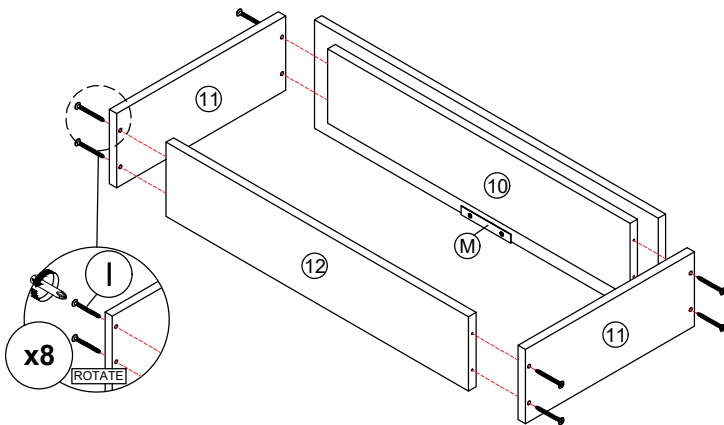

STEP 15

Assemble hardware N2 (L/R) to panel (13) by using hardware H.
(Repeat 3 times for each hardware.)



STEP 16

Put all the drawer in place along the drawer slides.

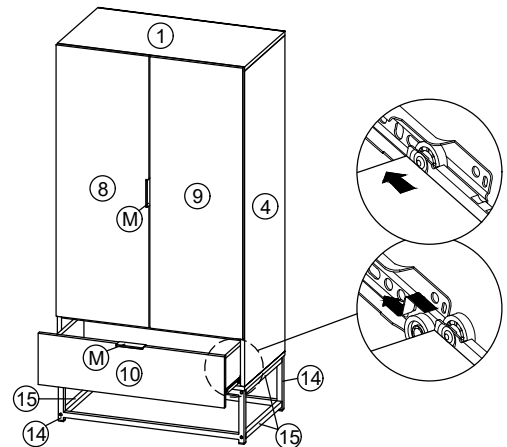
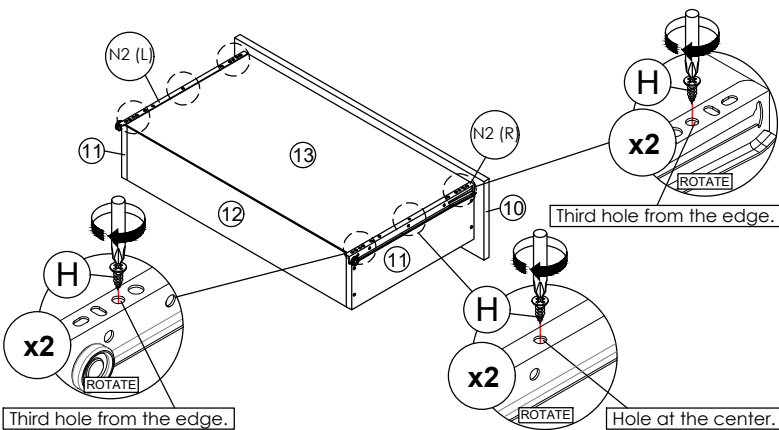

*Hardware N2 (L/R) shall be leaning against panel (10) when assembling.