

CODING  
- 3704106  
- 3704156

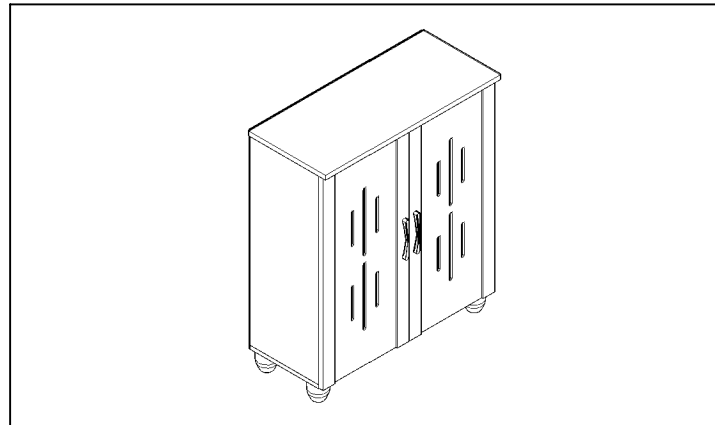

nuhoom.com

Read the instructions carefully. Remove all the wrappings, staples and straps from the carton. Refer to the hardware and furniture part list for guidance. Make sure that you have all the parts before you start assembling. Place all the wooden furniture parts on a clean, flat and soft surface, such as a carpet or rubbermat to prevent scratches.

**CAUTION**  
KEEP ALL THE PARTS OUT OF CHILDREN'S REACH.

ITEM	PHOTO	HARDWARE NAME	QTY
A		SCREW M7 x 50MM	4
B		WOOD DOWEL M8 x 30MM	8
C		IRON SHELF SUPPORT	15
D		PVC CUP LEG SCREW M4 x 45MM	4 4
E		POWER PIN	20
F		PVC "H" RAIL	2
G		MINIFIX M5x24MM	2
H		MINIFIX CASING	2
I		IRON L-BRACKET SCREW M3x12MM	2 4
J		PVC HANDLE (128mm) SCREW M4x30MM	2 4
K		ALLEN KEY	1
NH 58		HINGES 5/8" SCREW M3.5x16MM	4 24

ITEM	PHOTO	PART NAME	QTY
1		TOP PANEL	1
2		BOTTOM PANEL	1
3		SIDE PANEL (L)	1
4		SIDE PANEL (R)	1
5		INTERNAL CENTER STAND PANEL	1
6		SHELF PANEL	3
7		BACK MDF BOARD	3
8		DOOR PANEL	2

CODING  
- 3704106  
- 3704156

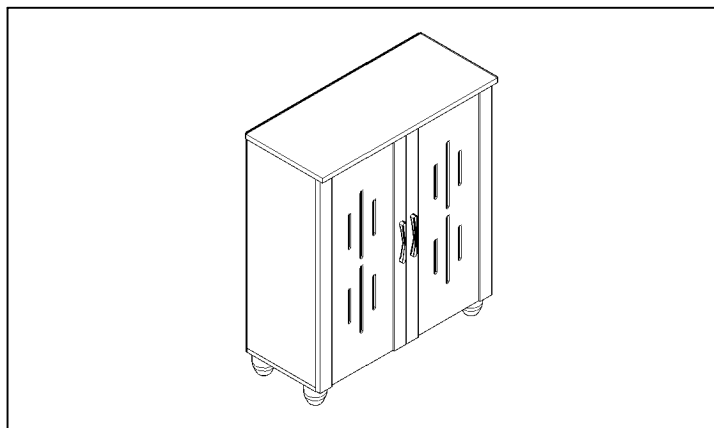

nuhoom.com

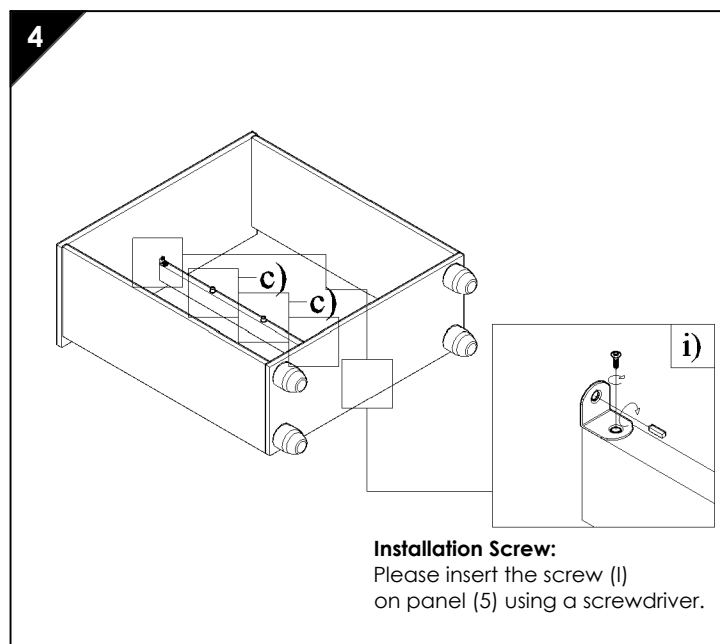
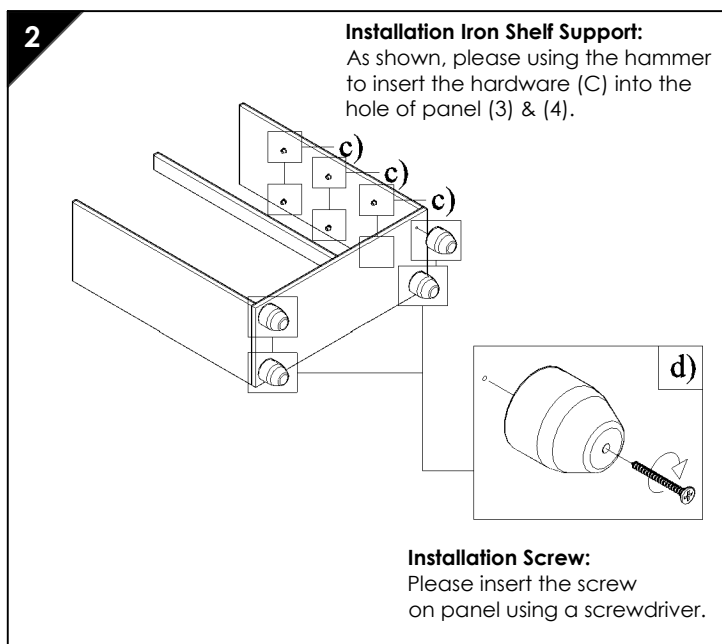
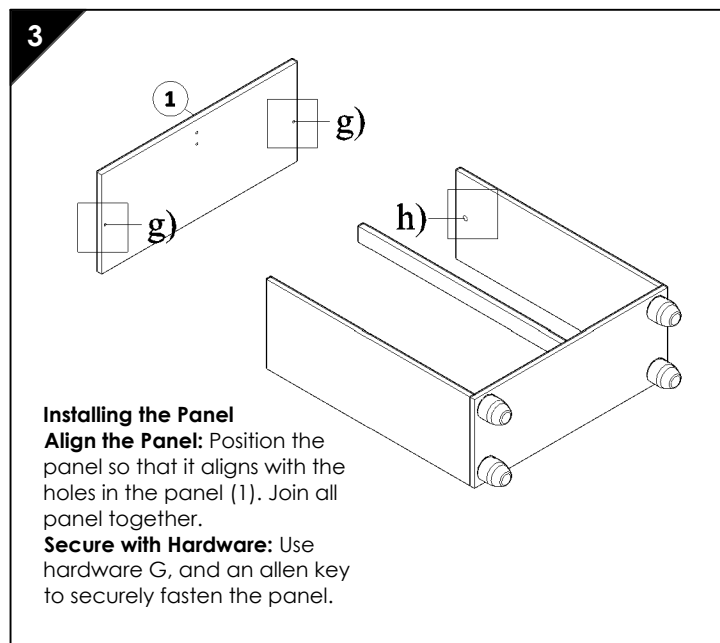
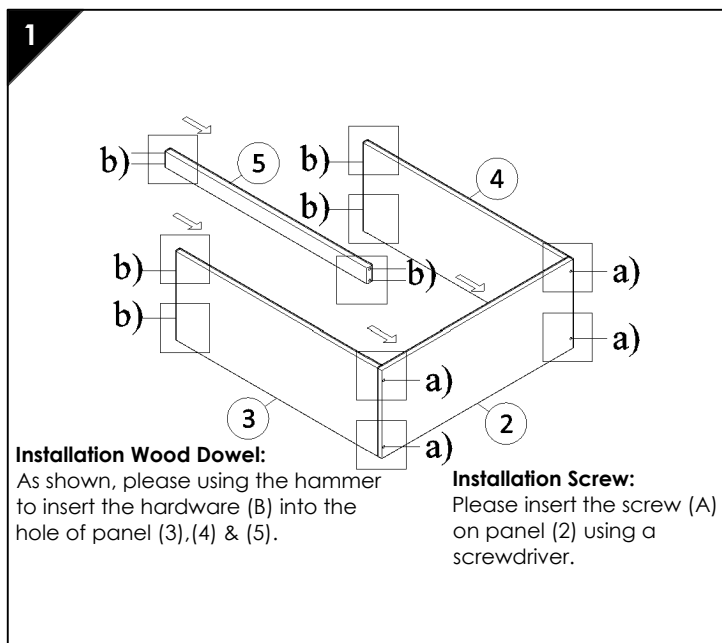

CODING  
- 3704106  
- 3704156

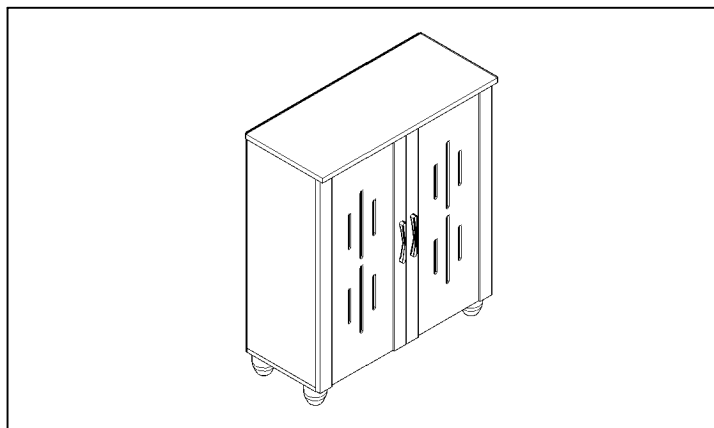

nuhoom.com

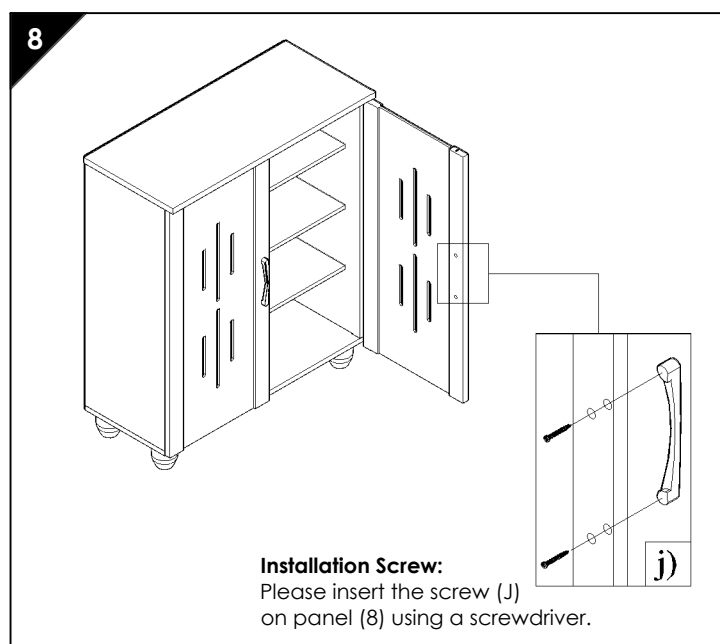
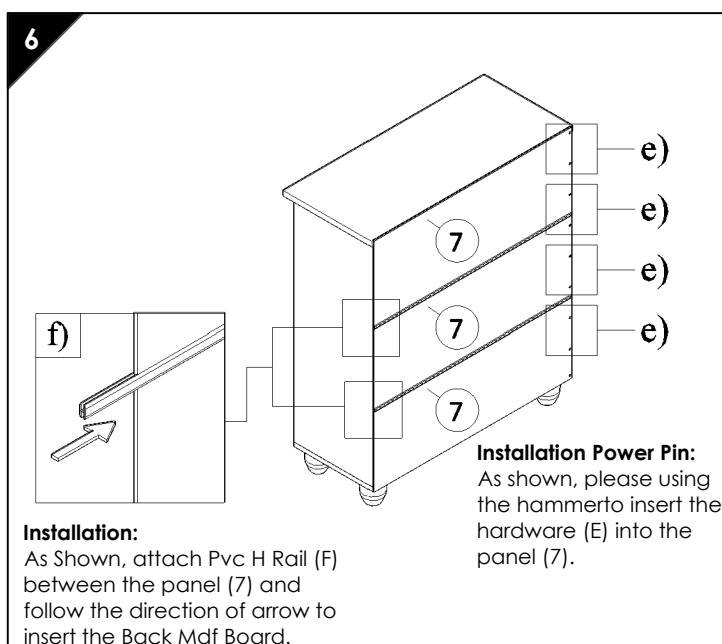
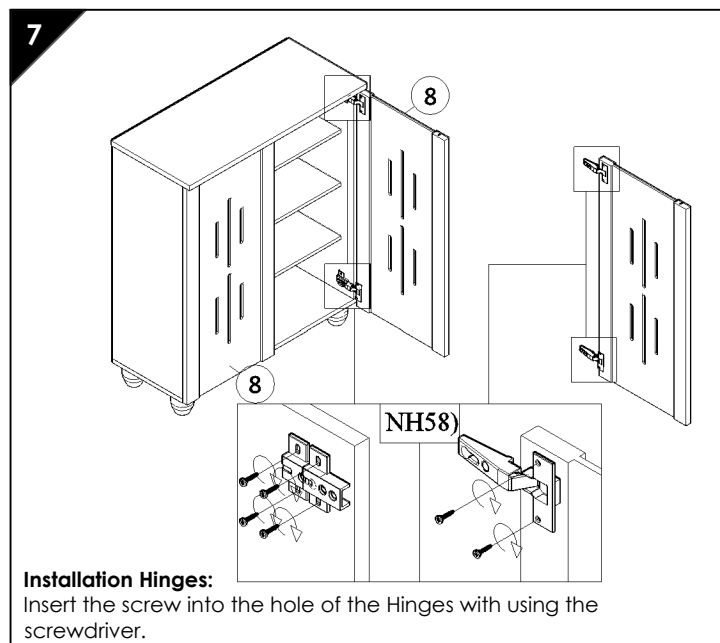
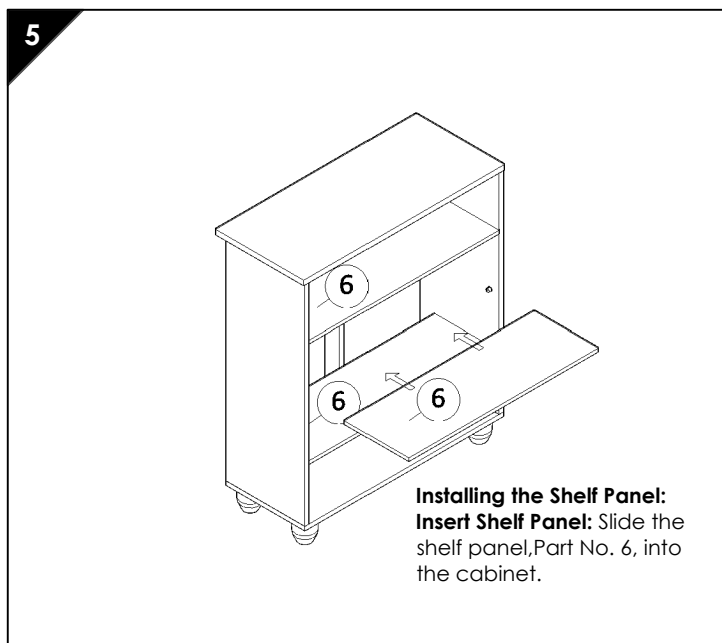

CODING  
- 3704106  
- 3704156

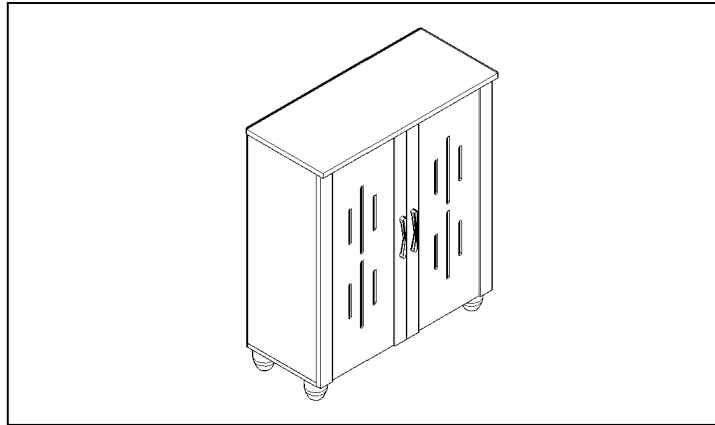

**nuhoom.com**

**9**

**Assembly Complete. Please keep  
this instruction for future reference.**

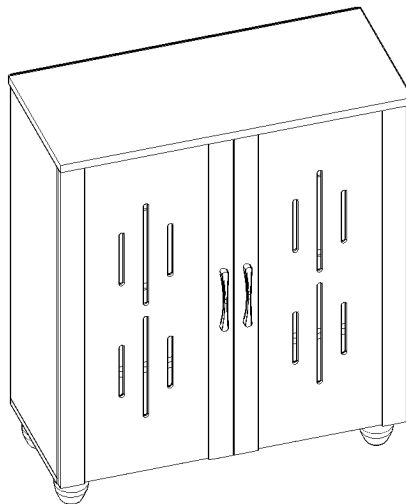

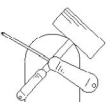

## HOW TO ADJUST GLASS/DOORS

- There is a gap between the door and the shelf with doors closed

Loosen the back adjustable screw which is one of the two screws looking from the front while supporting the doors, adjust the door by moving it back and forth, then tighten the back screw.

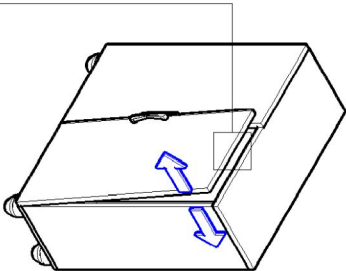

If there is a gap between the doors on the top.

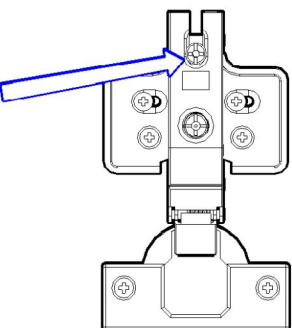

Loosen this screw, adjust by moving back and forth

- There is a gap in the middle with doors closed

Loosen the ① back adjustable screw which is one of the two screws looking from the front while supporting the doors, tighten the ② screw clockwise, then adjust the middle gap. After adjusted, tighten the ① screw.

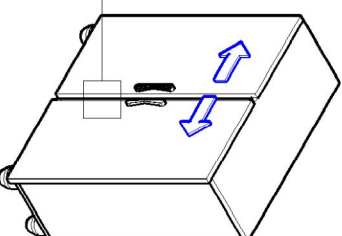

If the gap is wide

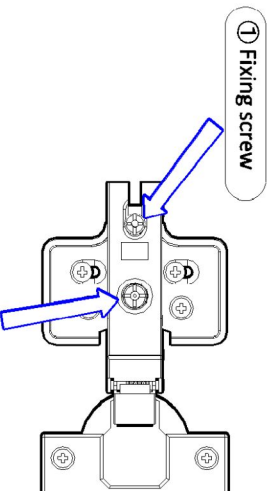

② Adjusting screw  
(If you twist clockwise once, the door moves about 2mm inward)

- There is a V gap on the top with doors closed

Loosen the ① back adjustable screw which is one of the two screws looking from the front while supporting the doors, tighten the ② screw clockwise, then adjust the middle gap. After adjusted, tighten the ① screw.

If there is a gap between the doors on the top (Please adjust slide hinge the top part door)

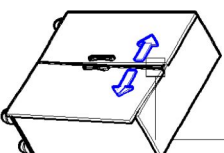

If there is a gap between the doors on the bottom (Please adjust slide hinge the bottom part door)

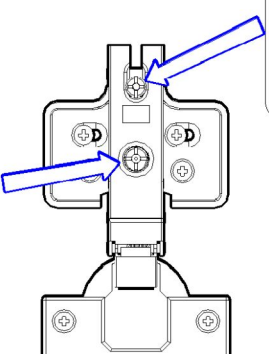
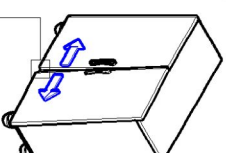

② Adjusting screw  
(If you twist clockwise once, the door moves about 2mm inward)

- There is a gap on the top of the door when doors are closed (Glass slide hinge does not require this step) (4 screw hole hinge does not require ①)

Loosen the slide hinge screw while supporting the door, adjust the door by moving it up and down then tighten the screws. (Please loosen the slide hinge screws of the door completely you are adjusting before moving it up and down.)

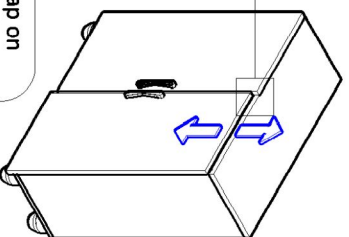

If there is a gap on the top of the door

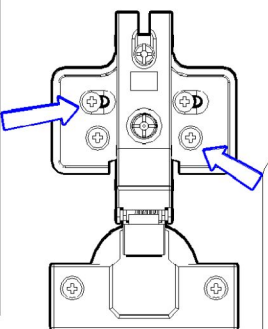

① Open screw

② Slide hinge screws (Please loosen these screws before adjusting)