

**CODING**  
- 355020

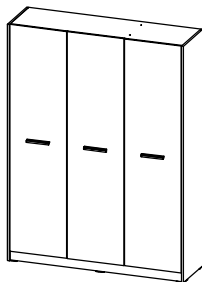

ISO 9001:2015  
Reg. No. 10003-1073-003

**nuhoom.com**

Read the instructions carefully. Remove all the wrappings , staples and straps from the carton. Refer to the hardware and furniture part list for guidance. Make sure that you have all the parts before you start assembling. Place all the wooden furniture parts on a clean, flat and soft surface, such as a carpet or rubbermat to prevent scratches.

**CAUTION**  
KEEP ALL THE PARTS OUT OF CHILDREN'S REACH.

PART LIST		QTY
1	TOP PANEL	1 PC
2	BOTTOM PANEL	1 PC
3	SIDE PANEL (L)	1 PC
4	SIDE PANEL (R)	1 PC
5	CENTER PANEL	1 PC
6	MIDDLE PANEL (L)	2 PCS
7	MIDDLE PANEL (R)	2 PCS
8	BACK BONE (L)	2 PCS
9	BACK BONE (R)	2 PCS
10	BACK PANEL (L)	1 PC
11	BACK PANEL (R)	1 PC
12	DOOR PANEL (L)(R)	3 PCS
13	CABINET LEG	2 PCS
14	CENTER LEG	1 PC

HARDWARE			
A	MINI FIX	A1  A2  A3	47 SETS
B	M8 X 30MM WOOD DOWEL		38 PCS
C	M6 X 50MM CSK CAP WOOD SCREW		4 PCS
D	ALLEN KEY M4		1 PC
E	M3.5 X 16MM C.B SCREW		116 PCS
F	STUD 192 WITH SCREW	F1  F2	16 PCS
G	433 OVAL TUBE BRACKET		4 PCS
H	433 OVAL PAIP		1 PC
I	433 OVAL PAIP		1 PC
J	SOFT CLOSING 7/8 HINGES		12 PCS
K	864 PVC NAIL LEG BLACK (L)		6 PCS
L	WOOD HANDLE ( 190MM )		3 PCS
M	M4 X 32MM C.B SCREW		9 PCS

**SELF-PREPARED TOOLS:** Tools below are NOT included in package.

	SCREWDRIVER		HAMMER
--	-------------	--	--------

CODING  
- 355020

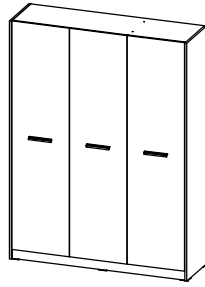

ISO 9001:2015  
Reg. No. 00005-1-077-1-020

nuhoom.com

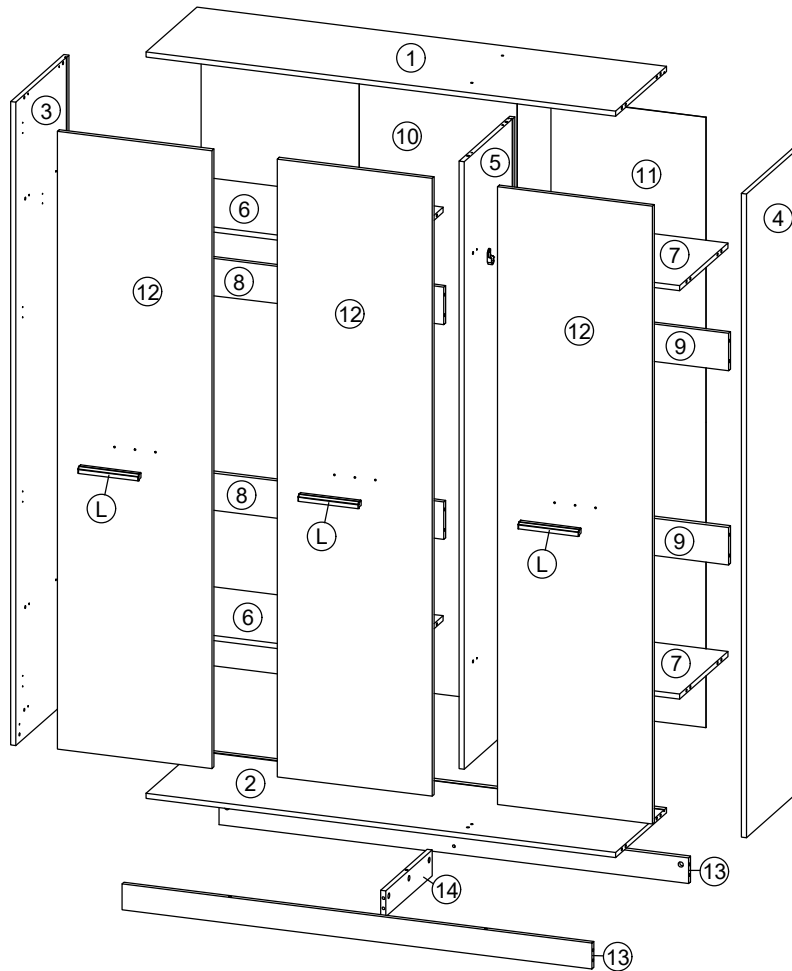

**STEP 1**

- Insert hardware **A1** onto panel (1) and (2).  
(Repeat 8 times.)
- Insert hardware **A2** onto panel (2).  
(Repeat 1 times.)
- Insert hardware **B** onto panel (1) and (2).  
(Repeat 8 times.)

SCREWDRIVER  
REQUIRED

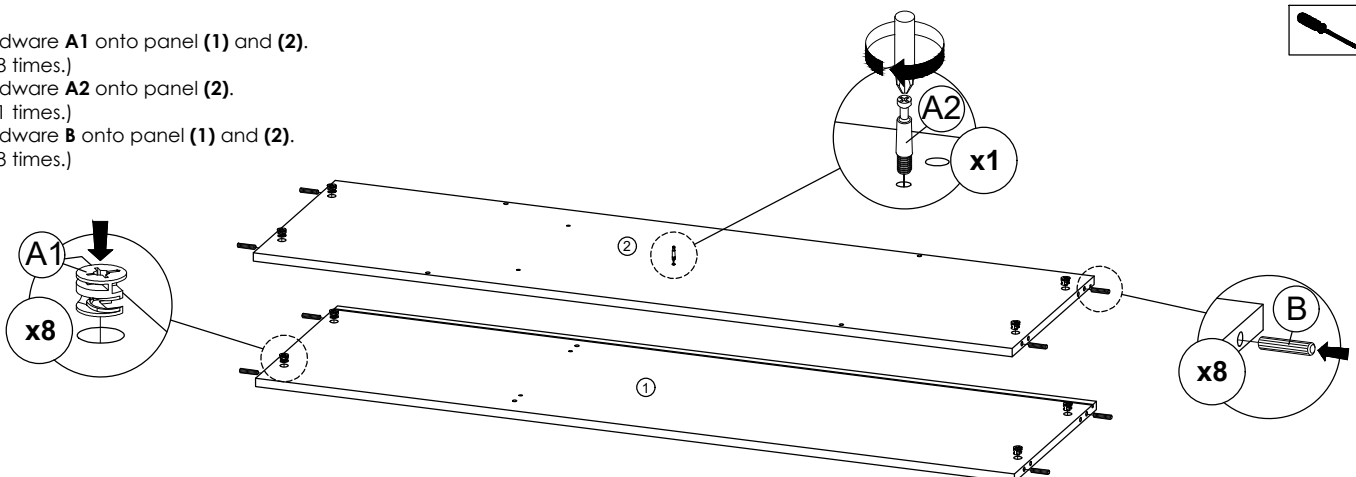

CODING  
- 355020

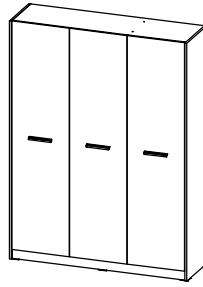

ISO 9001:2015  
Reg. No. 00005-1-017-1-010

nuhoom.com

SCREWDRIVER  
REQUIRED

## STEP 2

- Insert hardware **A2** onto panel **(3)** and **(4)**.  
(Repeat 28 times.)
- Assemble the hardware **G** onto panel **(3)** and **(4)** by using hardware **E**.  
(Repeat 2 times for each hardware.)

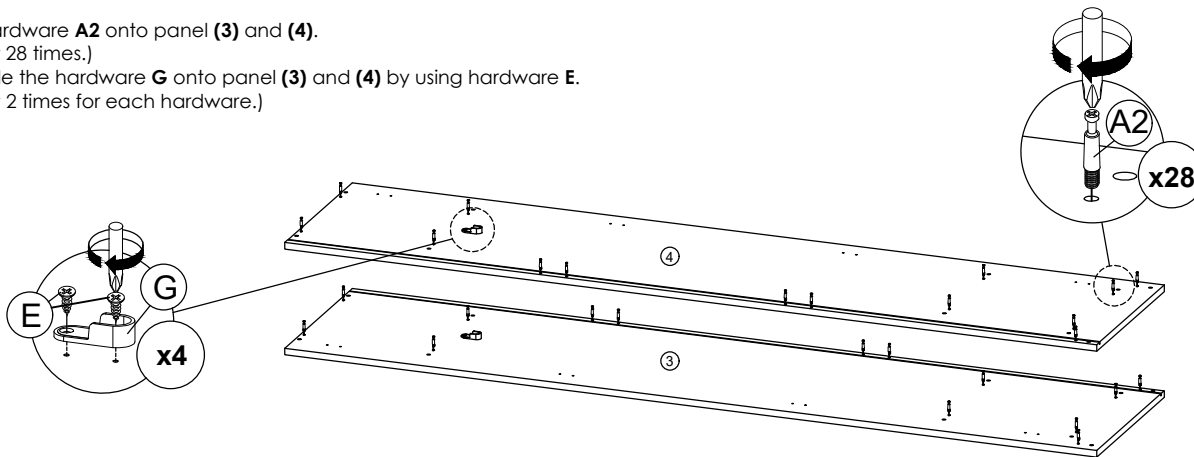

SCREWDRIVER  
REQUIRED

## STEP 3

- Insert hardware **A1** onto panel **(13)** and **(14)**.  
(Repeat 7 times.)
- Insert hardware **A2** onto panel **(5)** and **(13)**.  
(Repeat 18 times.)
- Insert hardware **B** onto panel **(5)**, **(13)** and **(14)**.  
(Repeat 14 times.)
- Assemble the hardware **G** onto panel **(5)** by using hardware **E**.  
(Repeat 2 times for each hardware.)

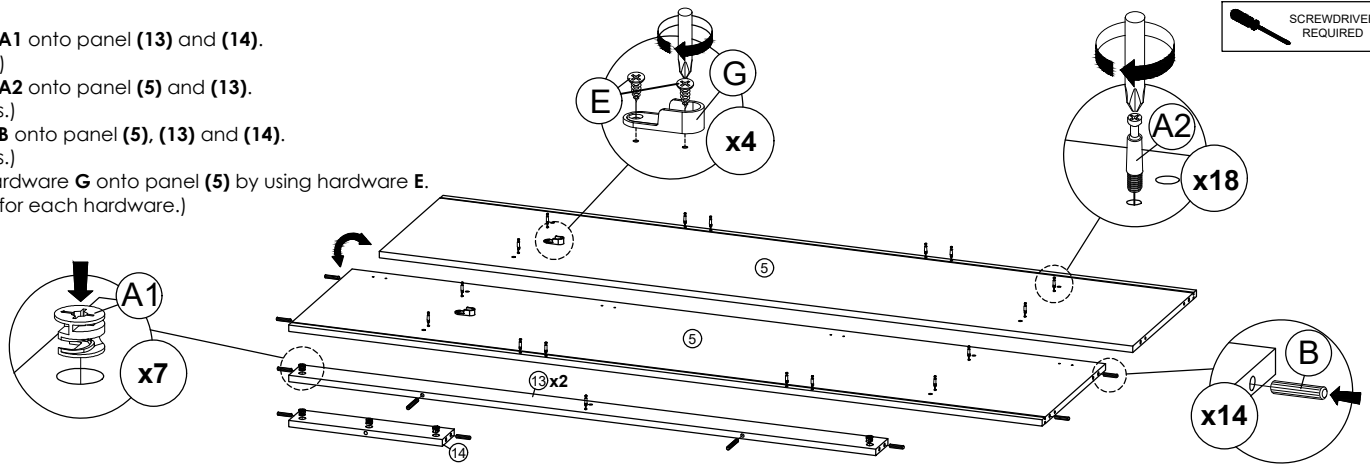

SCREWDRIVER  
REQUIRED

## STEP 4

- Insert hardware **A1** onto panel **(6)**, **(7)**, **(8)** and **(9)**.  
(Repeat 32 times.)
- Insert hardware **B** onto panel **(6)** and **(7)**.  
(Repeat 16 times.)

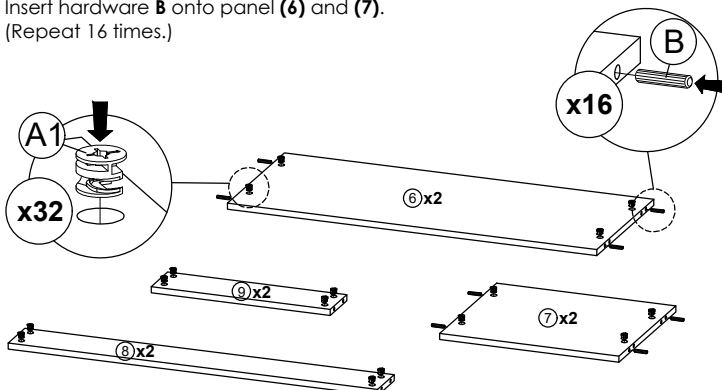

## STEP 5

- Attach panel **(13)** to panel **(14)**.
- Insert all hardware **A2** into **A1**.
- Rotate all **A1** until tight.
- Apply **A3** onto all **A1**.  
(Repeat 2 times.)

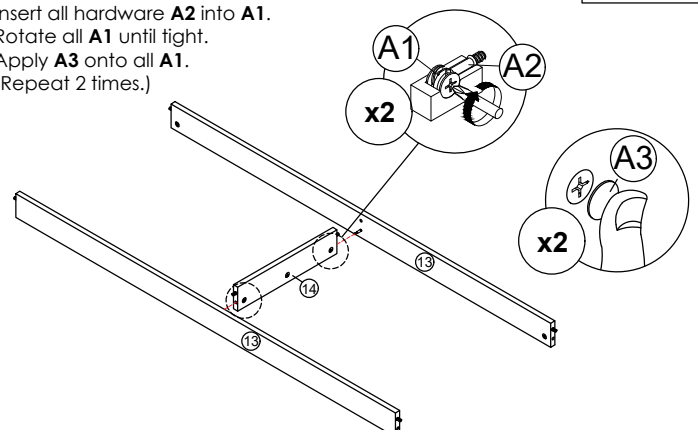

CODING  
- 355020

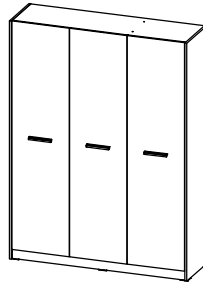

ISO 9001:2015  
Reg. No. 000055-1-017-1-010

nuhoom.com

### STEP 6

- Attach panel (2) to panel (13) and (14).
- Insert all hardware A2 into A1.
- Rotate all A1 until tight.
- Apply A3 onto all A1.
- (Repeat 1 times.)



### STEP 7

- Connect panel (2) to panel (5) by using hardware C and D.
- (Repeat 2 times.)

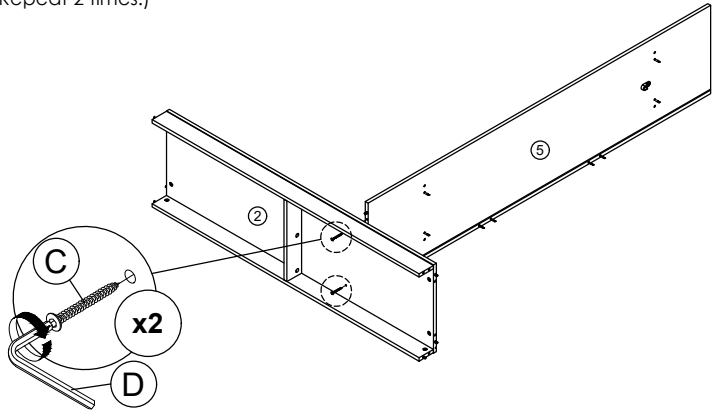
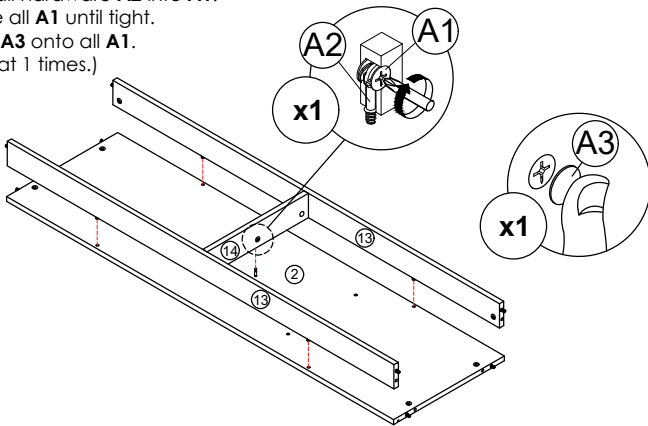

### STEP 8

- Connect panel (1) to panel (5) by using hardware C and D.
- (Repeat 2 times.)



### STEP 9

- Attach panel (6), (7), (8) and (9) to panel (5).
- Insert all hardware A2 into A1.
- Rotate all A1 until tight.
- Apply A3 onto all A1.
- (Repeat 16 times.)

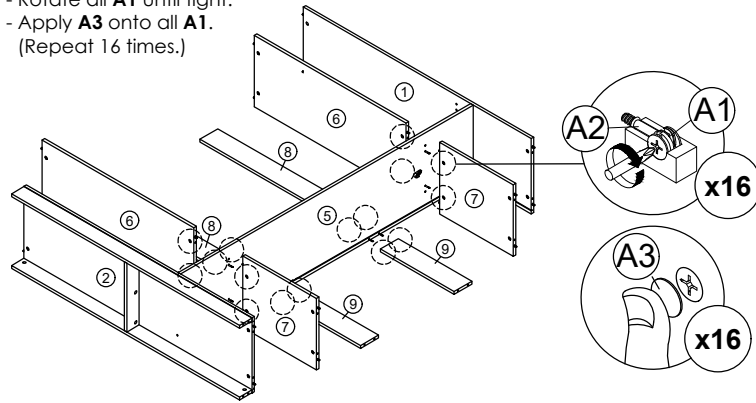
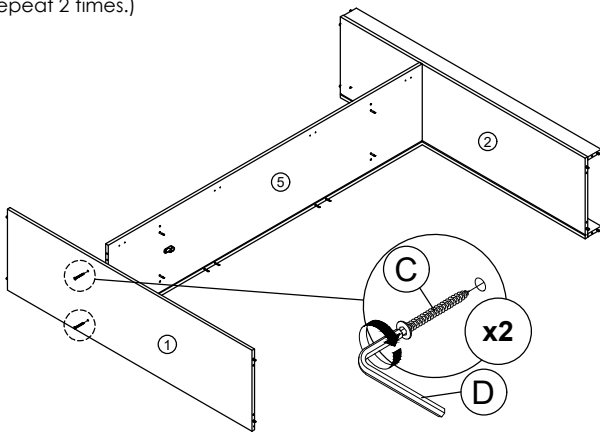

### STEP 10

Insert the panel (10) and (11) along the slot.

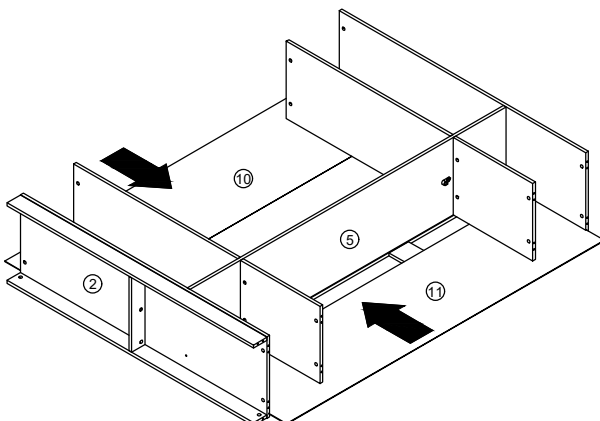

### STEP 11

- Attach panel (4) to panel (1), (2), (7), (9) and (13).
- Insert all hardware A2 into A1.
- Rotate all A1 until tight.
- Apply A3 onto all A1.
- (Repeat 14 times.)

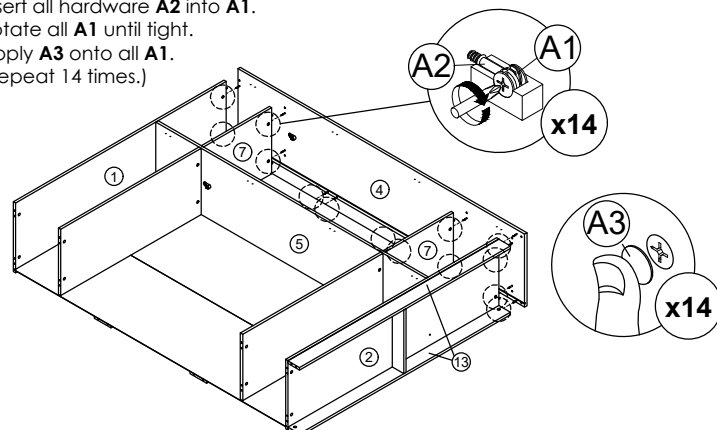

CODING  
- 355020

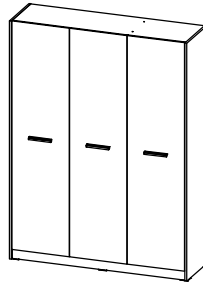

ISO 9001:2015  
Reg. No. 00005-1-017-1-010

nuhoom.com

### STEP 12

- Attach panel (3) to panel (1), (2), (6), (8) and (13).
- Insert all hardware A2 into A1.
- Rotate all A1 until tight.
- Apply A3 onto all A1.
- (Repeat 14 times.)

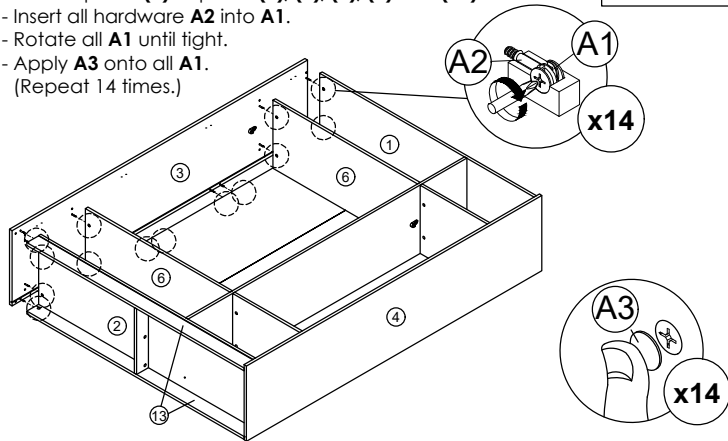

### STEP 13

- Assemble hardware K into panel (3), (4), (13) and (14) by using hardware E.
- (Repeat 6 times for each hardware.)

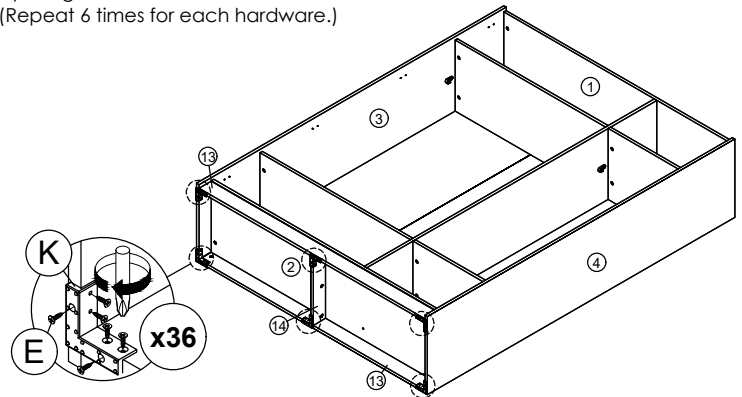

### STEP 14

- Insert hardware F1 into slot at panel (1), (2), (3), (4) and (5).
- Assemble hardware F1 by using hardware F2.
- (Repeat 16 times.)

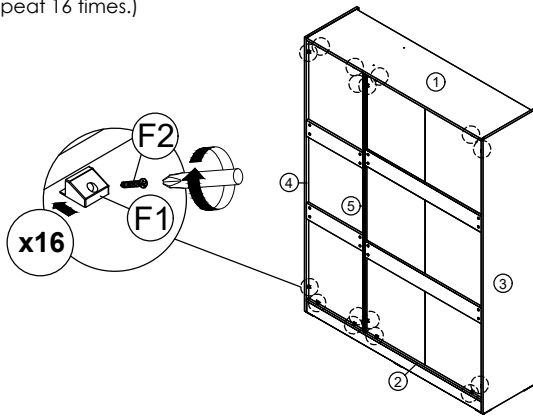

### STEP 15

- Attach hardware H and I to hardware G.

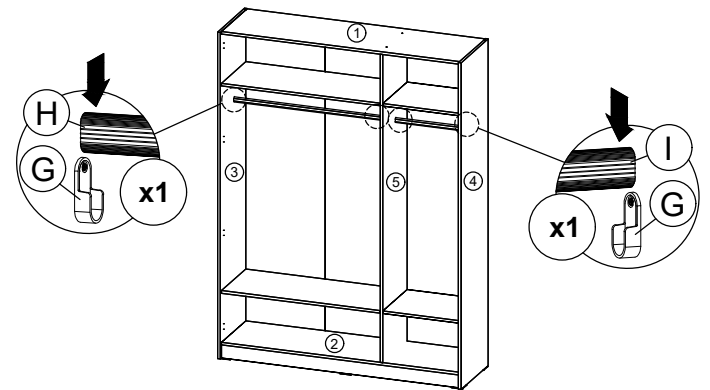

### STEP 16

- Fix hardware J onto panel (12) by using hardware E.
- (Repeat 2 times for each hardware.)
- Fix hardware L onto panel (12) by using hardware M.
- (Repeat 3 times for each hardware.)

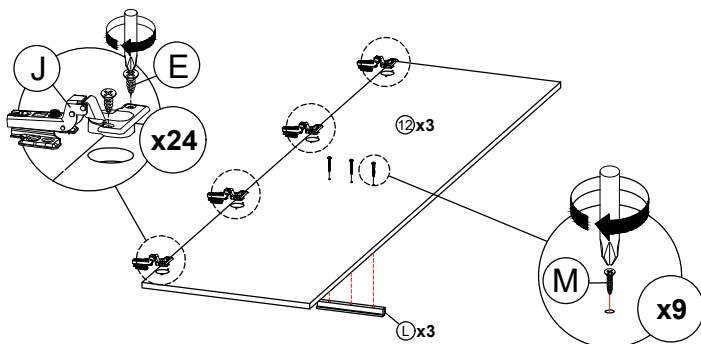

\* In this step hardware G have been assembled.

### STEP 17

- Fix hardware J into panel (3), (4) and (5) by using hardware E.
- (Repeat 4 times for each hardware.)
- Tighten or loosen the screw to adjust position of panel (12).
- (Do only when needed.)

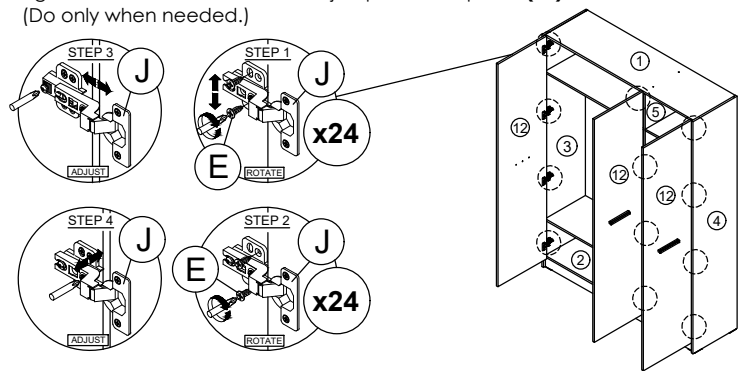

\* In this step hardware J have been assembled in panel (12).