

CODING
- 352026

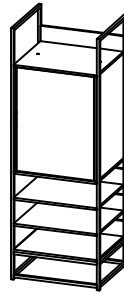

ISO 9001:2015
Reg. No. 000435-1-MY-1-QMS

nuhoom.com

Read the instructions carefully. Remove all the wrappings, staples and straps from the carton. Refer to the hardware and furniture part list for guidance. Make sure that you have all the parts before you start assembling. Place all the wooden furniture parts on a clean, flat and soft surface, such as a carpet or rubbermat to prevent scratches.

CAUTION
KEEP ALL THE PARTS OUT OF CHILDREN'S REACH.

PART LIST		QTY
1	TOP PANEL	1 PC
2	BOTTOM PANEL - 1	1 PC
3	BOTTOM PANEL - 2	1 PC
4	SIDE PANEL (L)	1 PC
5	SIDE PANEL (R)	1 PC
6	BACK BONE	4 PCS
7	BACK PANEL	1 PC
8	SHELF PANEL	2 PCS
9	DOOR PANEL	1 PC
10	METAL SIDE	2 PCS
11	METAL SUPPORT - 1	2 PCS
12	METAL SUPPORT - 2	2 PCS
13	METAL HANGER	1 PC

HARDWARE			
A	MINI FIX	A1 A2 A3	4 SETS
B	M8 X 30MM WOOD DOWEL		8 PCS
C	M6 X 50MM CSK CAP WOOD SCREW		20 PCS
D	ALLEN KEY M4		1 PC
E	M3 X 12MM C.B SCREW		2 PCS
F	M3.5 X 16MM C.B SCREW		12 PCS
G	HANDLE 4020 L BAR 100MM		1 PC
H	5/8 NAIL		18 PCS
I	STOPPER(2 PIN)		1 PC
J	JCBC SCREW M6 X 35MM		2 PCS
K	JCBC SCREW M6 X 30MM		4 PCS
L	JCBC SCREW M6 X 40MM		8 PCS
M	JCBC W SCREW M6 x 50MM		24 PCS
N	SOFT CLOSING 7/8 HINGES		2 PCS

TIPPING PACK WITH A1		2 SETS
----------------------	--	--------

SELF-PREPARED TOOLS: Tools below are NOT included in package.	
SCREWDRIVER	HAMMER

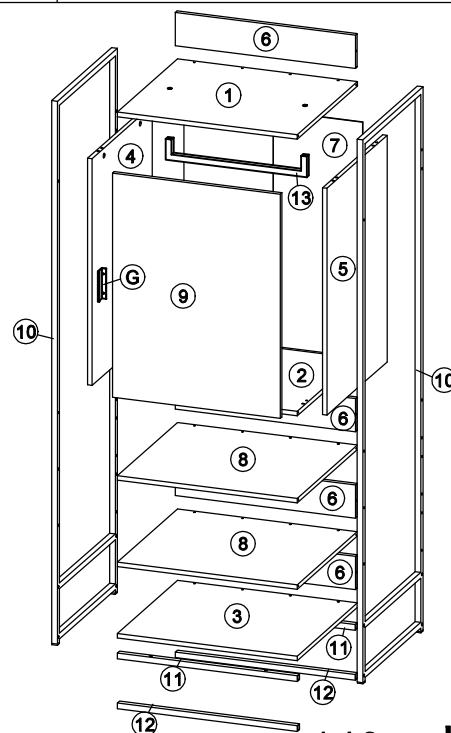

CODING
- 352026

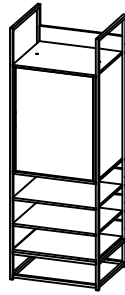

ISO 9001:2015
Reg. No. 000435-1-MY-1-QM

nuhoom.com

STEP 1

- Insert hardware **A1** onto panel **(4)** and **(5)**. (Repeat 4 times.)
- Insert hardware **A2** onto panel **(1)**. (Repeat 4 times.)
- Insert hardware **B** onto panel **(4)** and **(5)**. (Repeat 8 times.)

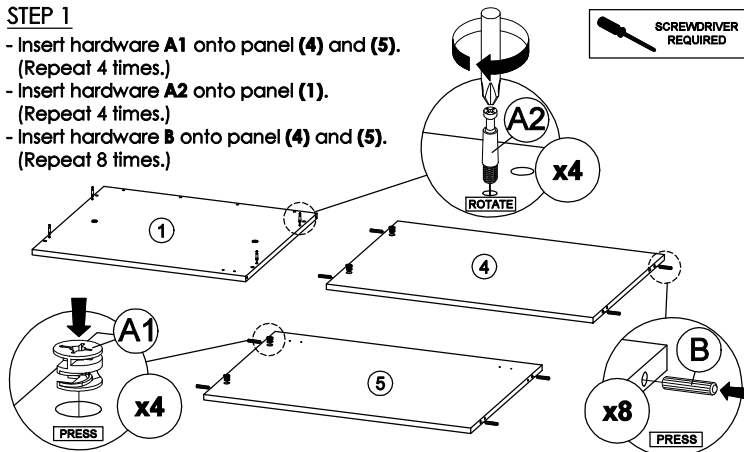

* Ensure the arrows on hardware **A1** point towards mounting positions.

STEP 3

- Connect panel **(1)** to panel **(6)** by using hardware **C** and **D**. (Repeat 4 times.)
- Hit hardware **I** onto panel **(1)**. (Repeat 1 times.)

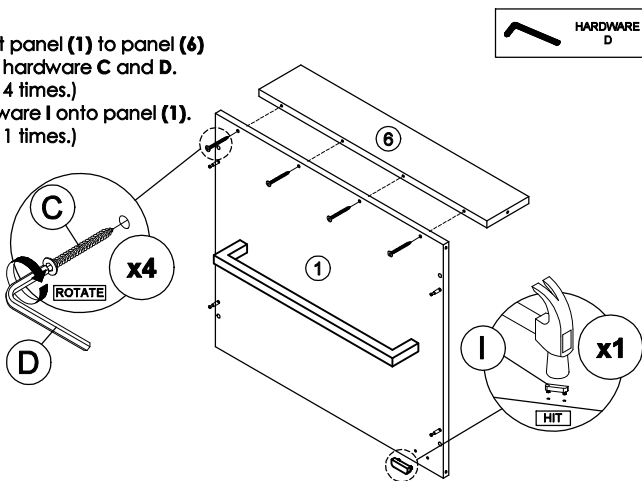

STEP 5

- Connect panel **(2)** to panel **(4)** and **(5)** by using hardware **C** and **D**. (Repeat 4 times.)

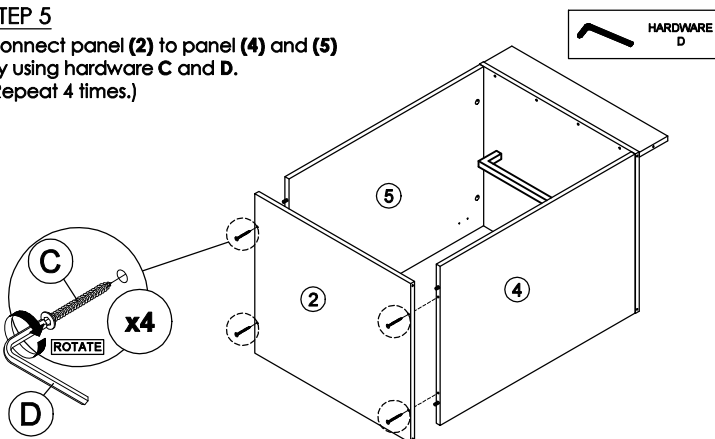

* In this step hardware **B** are pre-inserted.

STEP 2

- Connect Metal Hanger **(13)** to panel **(1)** by using hardware **D** and **J**. (Repeat 2 times.)

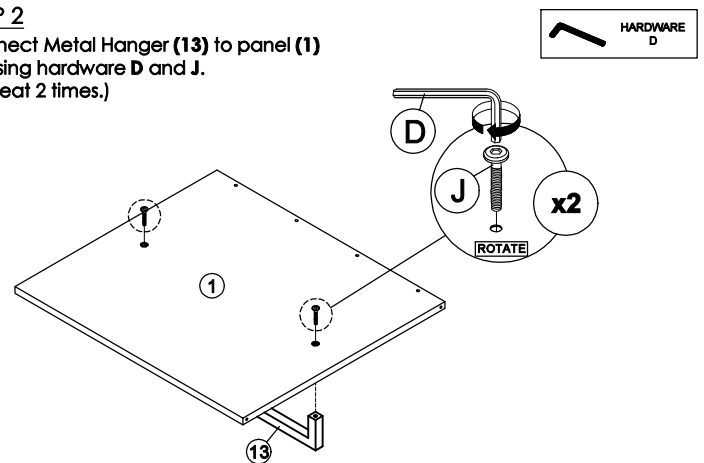

STEP 4

- Attach panel **(1)** to panel **(4)** and **(5)**.
- Insert all hardware **A2** into **A1**.
- Rotate all **A1** until tight.
- Apply **A3** onto all **A1**. (Repeat 4 times.)

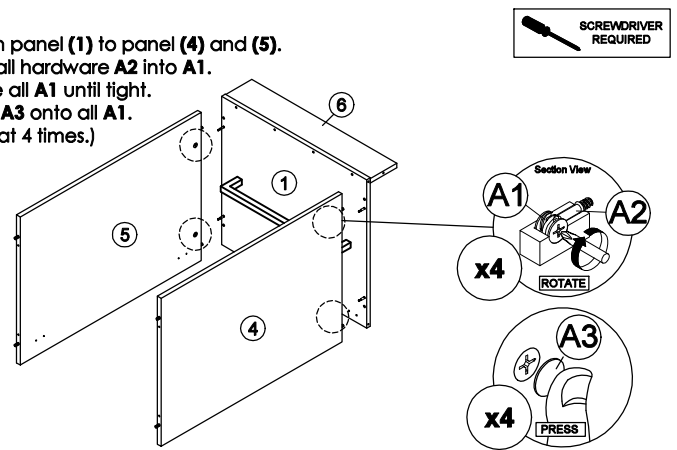

* In this step hardware **A1**, **A2** and **B** are pre-inserted.

STEP 6

- Assemble panel **(7)** to entire body with hardware **H**. (Repeat 18 times.)

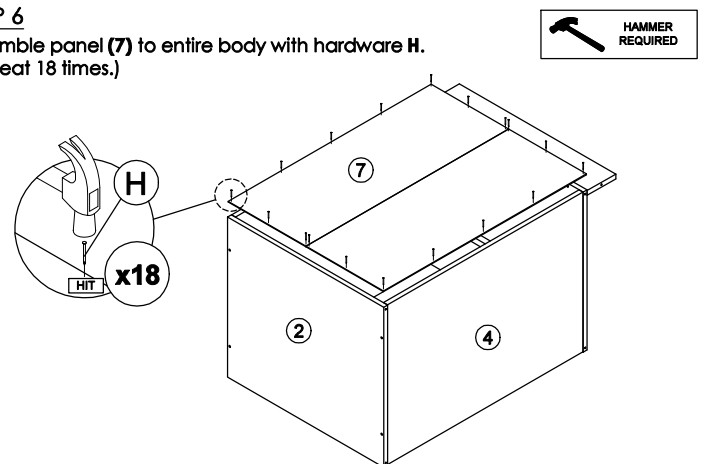

CODING
- 352026

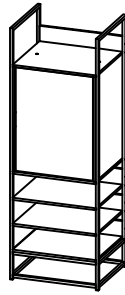

ISO 9001:2015
Reg. No. 070436-1-MY-1-QM

nuhoom.com

STEP 7

Connect panel (6) to panel (3) and (8) by using hardware C and D.
(Repeat 12 times.)

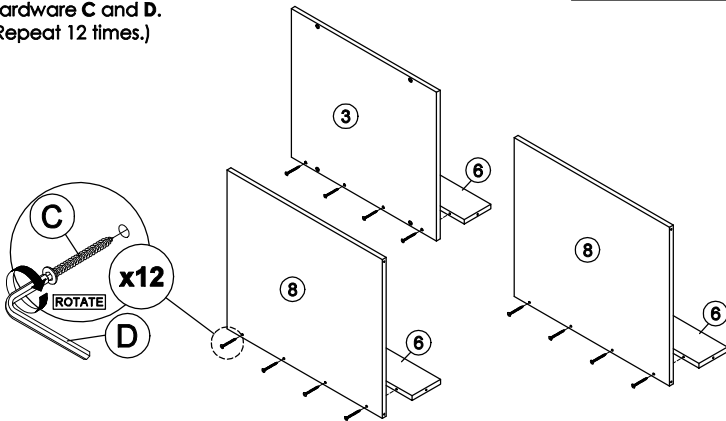

STEP 8

Connect Metal Support - 1 (11) to panel (3) by using hardware D and K.
(Repeat 4 times.)

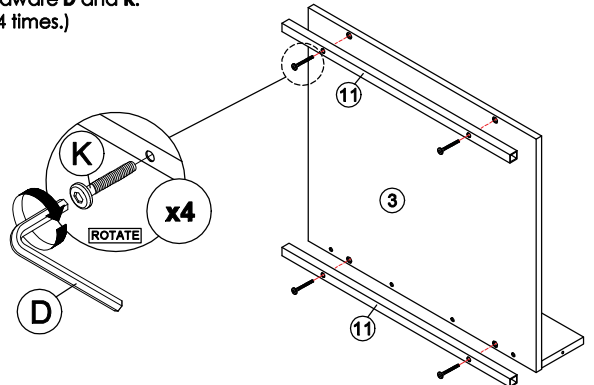

STEP 9

- Connect Metal Side (10) to panel (1), (2), (6) and (8) by using hardware D and M.
(Repeat 24 times.)
- Connect Metal Side (10) to Metal Support - 1 (11) and Metal Support - 2 (12) by using hardware D and L.
(Repeat 8 times.)

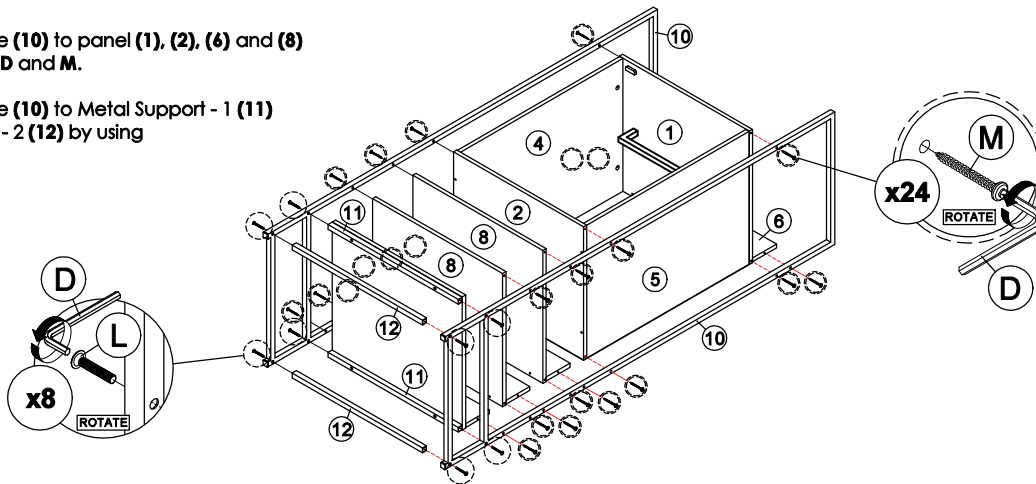

STEP 10

- Fix hardware N onto panel (9) by using hardware F.
(Repeat 2 times for each hardware.)
- Fix hardware G onto panel (9) by using hardware E.
(Repeat 2 times for each hardware.)

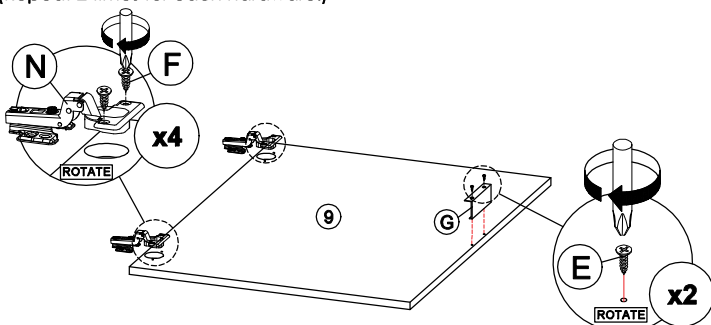

STEP 11

- Fix hardware N into panel (5) by using hardware F.
(Repeat 4 times for each hardware.)
- Tighten or loosen the screw to adjust position of panel (9).
(Do only when needed.)

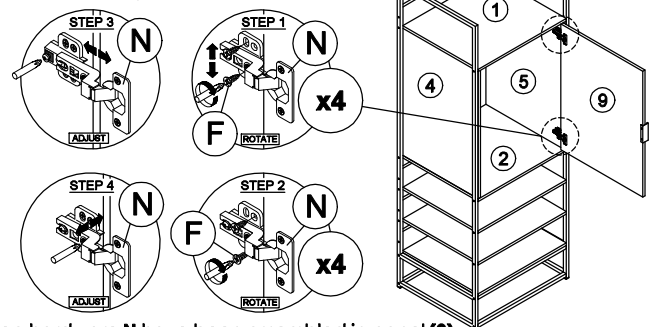

* In this step hardware N have been assembled in panel (9).