

CODING

-345055 -345058
 -345044 -345054

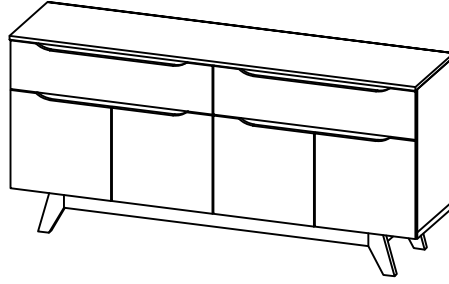

ISO 9001:2015
 Reg. No. 00005-1-2017-1-QMS

nuhoom.com

Read the instructions carefully. Remove all the wrappings, staples and straps from the carton. Refer to the hardware and furniture part list for guidance. Make sure that you have all the parts before you start assembling. Place all the wooden furniture parts on a clean, flat and soft surface, such as a carpet or rubbermat to prevent scratches.

CAUTION
 KEEP ALL THE PARTS OUT OF CHILDREN'S REACH.

HARDWARE			
A	MINI FIX	A1 A2 A3	10 SETS
B	M8 X 30MM WOOD DOWEL		32 PCS
C	M6 X 60MM CSK CAP WOOD SCREW		6 PCS
D	ALLEN KEY M4		1 PC
E	M3.5 X 16MM C.B SCREW		79 PCS
F	M4 X 30MM C.B SCREW		2 PCS
G	M4 X 38MM C.B SCREW		28 PCS
H	5/8 NAIL		52 PCS
I	5/8 PVC NAIL LEG		5 PCS
J	SOFT CLOSING 5/8 HINGES		8 PCS
K	14" DRAWER SLIDE	K1 (L/R) K2 (L/R)	2 SETS
L	ONE HOLE L BRACKET (2MM)		4 PCS

TIPPING PACK WITH AI		2 SETS
----------------------	--	--------

SELF-PREPARED TOOLS: Tools below are NOT included in package.	
SCREWDRIVER	HAMMER

PART LIST		QTY
1	TOP PANEL	1 PC
2	BOTTOM PANEL	1 PC
3	SIDE PANEL (L)	1 PC
4	SIDE PANEL (R)	1 PC
5	CENTER PANEL	1 PC
6	BONE PANEL	4 PCS
7	DOOR PANEL (L)	2 PCS
8	DOOR PANEL (R)	2 PCS
9	BACK PANEL	1 PC
10	APRON BONE (FRONT)	1 PC
11	APRON BONE (BACK)	1 PC
12	APRON BONE	2 PCS
13	CENTER LEG	1 PC
14	DRAWER FRONT	2 PCS
15	DRAWER BACK	2 PCS
16	DRAWER SIDE	4 PCS
17	DRAWER BOTTOM	2 PCS

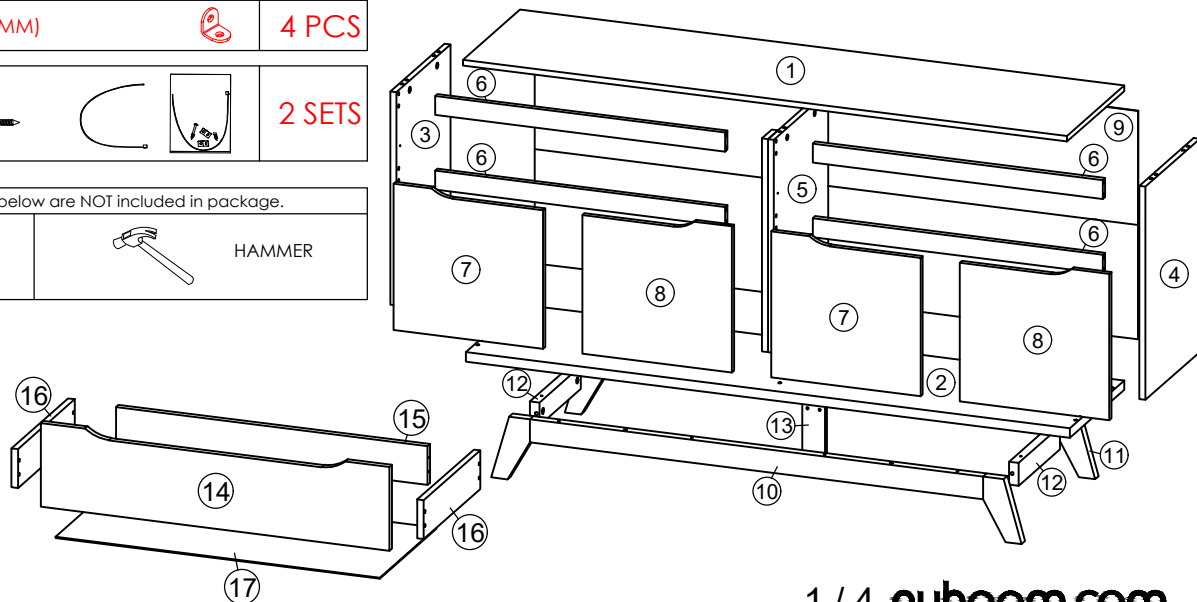

CODING
- 345044

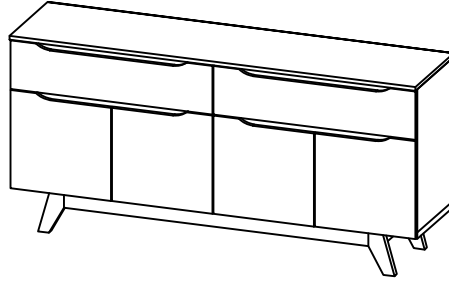

ISO 9001:2015
Reg. No. 00005-1-INT-1-QMS

nuhoom.com

STEP 1

- Insert hardware **A1** onto panel **(3), (4), (5)** and **(12)**. (Repeat 10 times.)
- Insert hardware **A2** onto panel **(1)**. (Repeat 6 times.)
- Insert hardware **B** onto panel **(3), (4)** and **(5)**. (Repeat 12 times.)

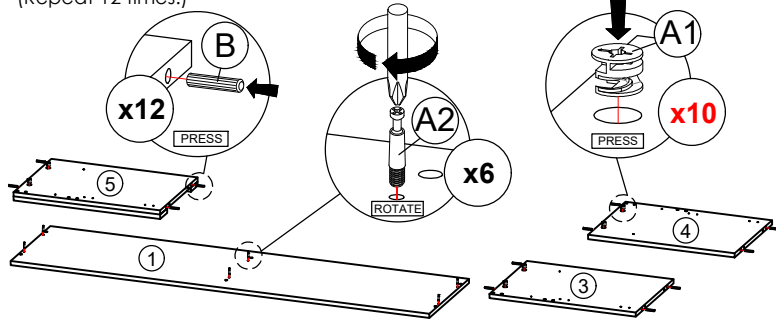

* Ensure the arrows on hardware **A1** point towards mounting positions.

STEP 3

- Fix hardware **K1 (L/R)** into panel **(3), (4)** and **(5)** with hardware **E**. (Repeat 3 times for each hardware.)

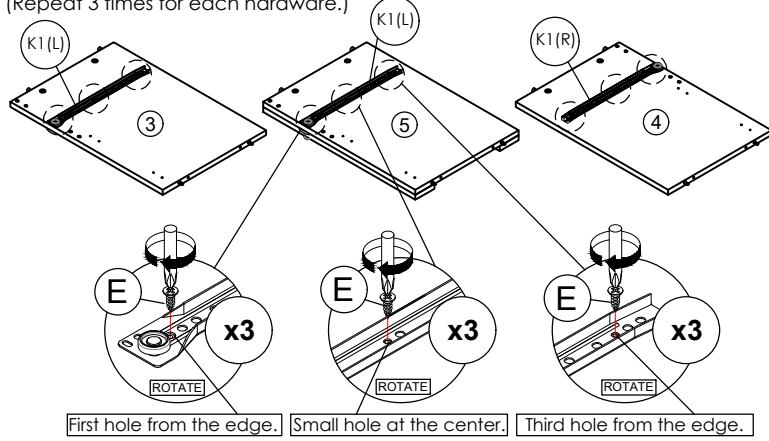
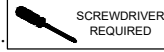

STEP 5

- Attach panel **(6)** to panel **(3), (4)** and **(5)**. (Repeat 4 times.)
- Assemble hardware **L** from panel **(6)** to panel **(3), (4)** and **(5)** with hardware **E**. (Repeat 4 times.)

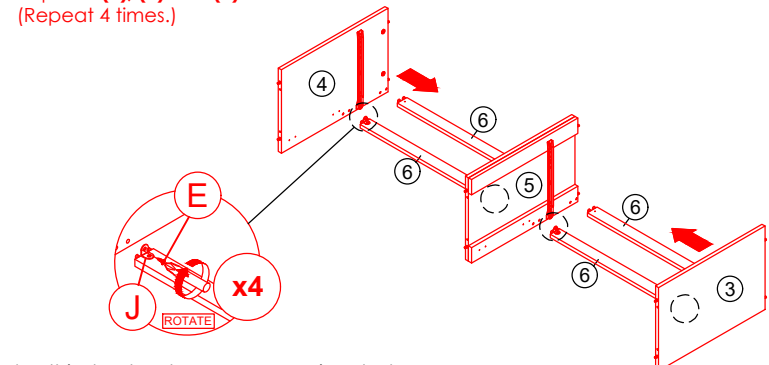

* In this step hardware **B** are pre-inserted.

STEP 2

- Assemble hardware **L** onto two of the panel **(6)** with hardware **E**. (Repeat 4 times.)
- Insert hardware **A2** onto panel **(10)** and **(11)**. (Repeat 4 times.)
- Insert hardware **B** onto panel **(6), (10)** and **(11)**. (Repeat 20 times.)

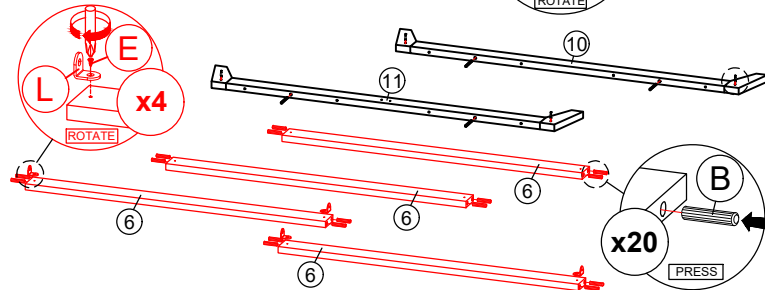

STEP 4

- Fix hardware **K1 (R)** into panel **(5)** with hardware **E**. (Repeat 2 times for each hardware.)

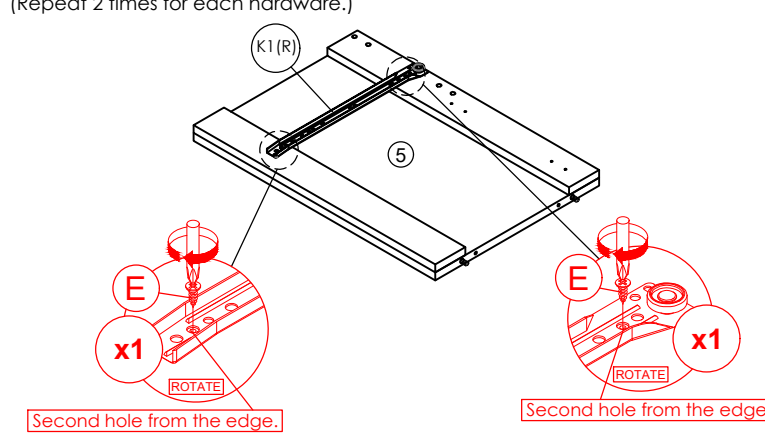
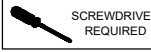

STEP 6

- Attach panel **(1)** to panel **(3), (4)** and **(5)**.
- Insert all hardware **A2** into **A1**.
- Rotate all **A1** until tight.
- Apply **A3** onto all **A1**. (Repeat 6 times.)



OR

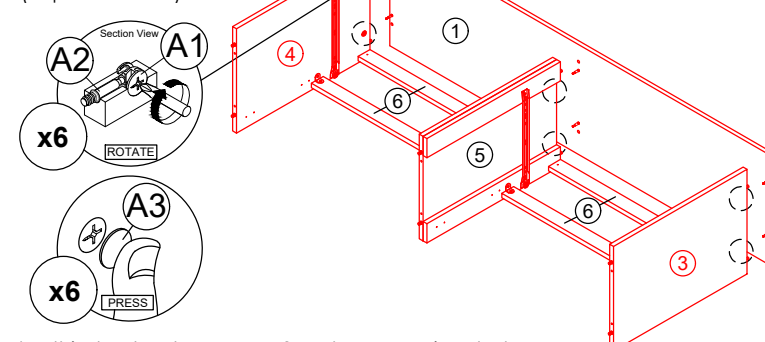

* In this step hardware **A1, A2** and **B** are pre-inserted.

CODING
- 345044

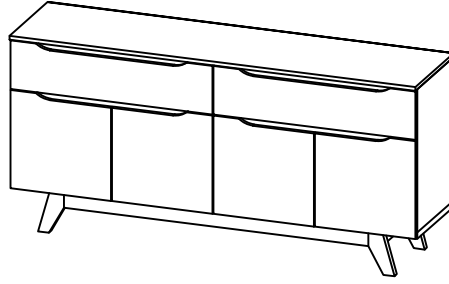

ISO 9001:2015
Reg. No. 00045-1-INT-1-QMS

nuhoom.com

STEP 7

Connect panel (2) to panel (3), (4) and (5) by using hardware C and D. (Repeat 6 times.)

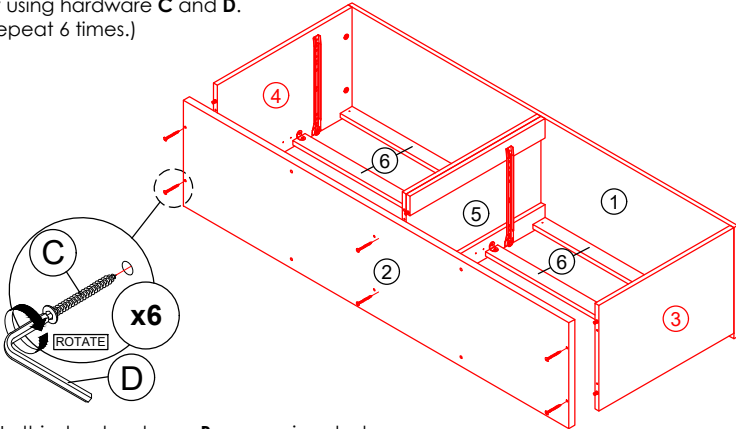

* In this step hardware B are pre-inserted.

STEP 9

Assemble panel (13) with panel (11) by using hardware F. (Repeat 2 times.)

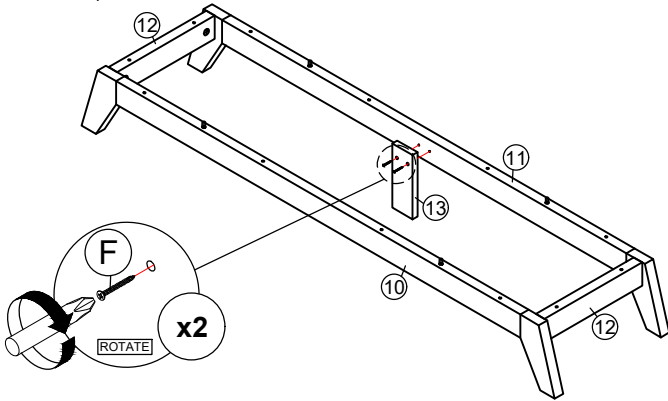

STEP 11

- Assemble panel (9) to entire body with hardware H. (Repeat 28 times.)
- Hit hardware I into bottom of panel (10), (11) and (13). (Repeat 5 times.)

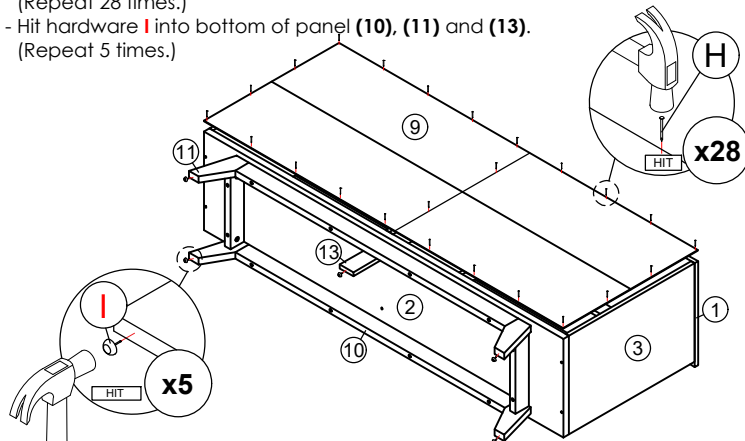

STEP 8

- Attach panel (10) and (11) to panel (12).
- Insert all hardware A2 into A1.
- Rotate all A1 until tight.
- Apply A3 onto all A1. (Repeat 4 times.)



OR

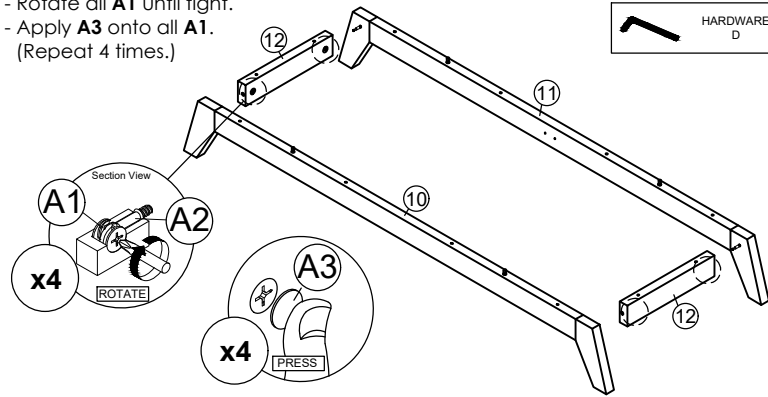

* In this step hardware A1, A2 and B are pre-inserted.

STEP 10

Assemble panel (10), (11) and (12) with panel (2) by using hardware G. (Repeat 12 times.)

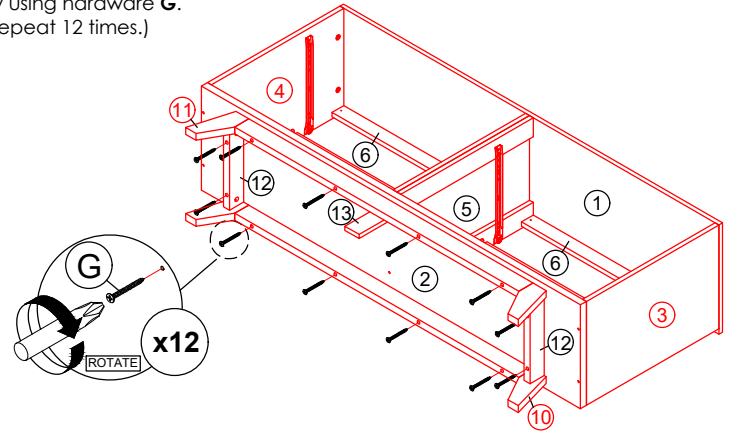

STEP 12

Fix hardware J onto panel (7) and (8) by using hardware E. (Repeat 2 times for each hardware.)

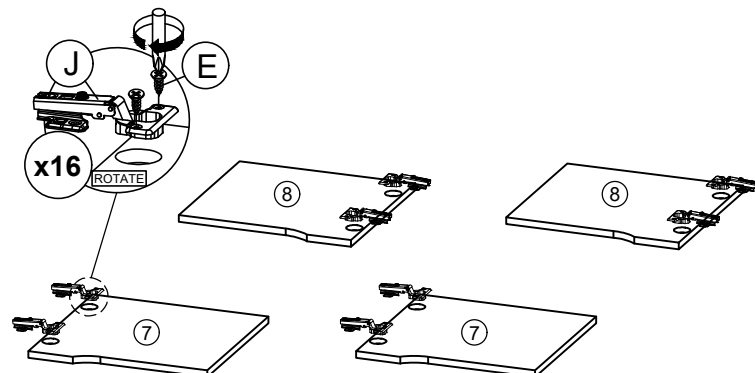

CODING
- 345044

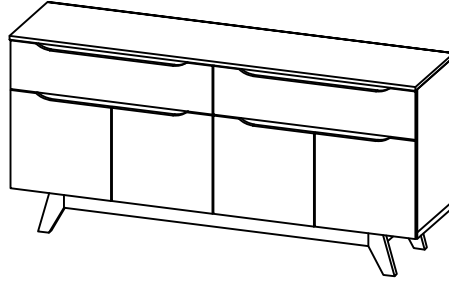

ISO 9001:2015
Reg. No. 000435-1-MTF-1-QMS

nuhoom.com

STEP 13

- Fix hardware **J** into panel **(3)**, **(4)** and **(5)** by using hardware **E**.
(Repeat 4 times for each hardware.)
- Tighten or loosen the screw to adjust position of panel **(7)** and **(8)**.
(Do only when needed.)

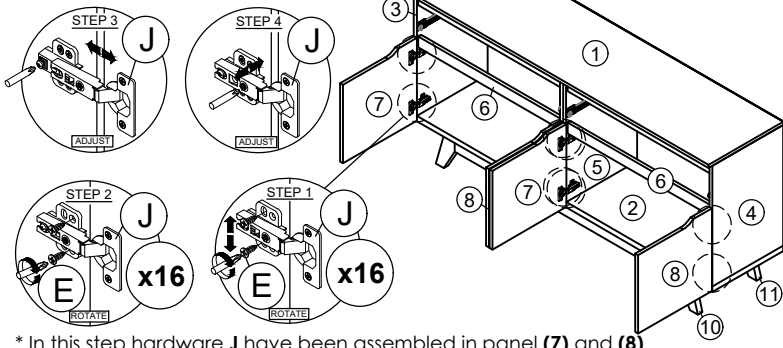

* In this step hardware **J** have been assembled in panel **(7)** and **(8)**.

STEP 15

Assemble panel **(17)** to entire body with hardware **H**.
(Repeat 24 times.)

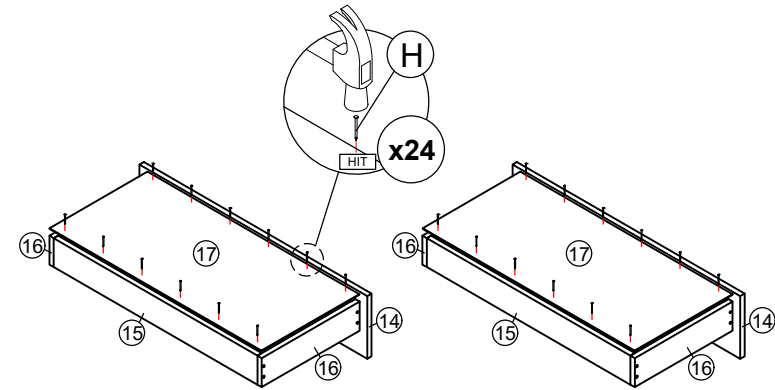
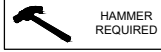

STEP 14

Assemble panel **(16)** to panel **(14)** and **(15)** by using hardware **G**.
(Repeat 16 times.)

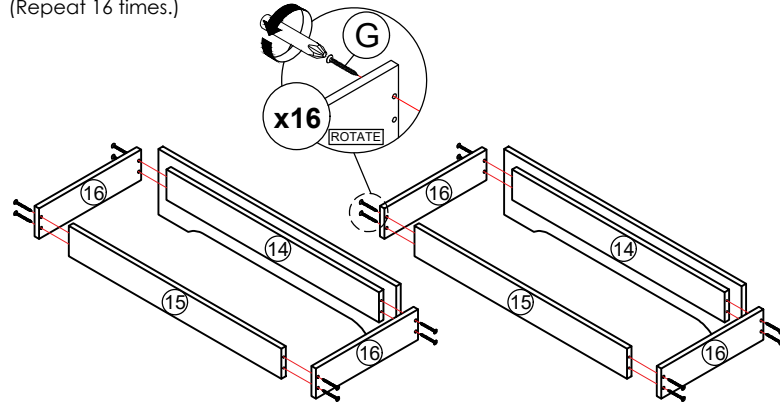

STEP 16

Assemble hardware **K2 (L/R)** to panel **(17)** by using hardware **E**.
(Repeat 3 times for each hardware.)

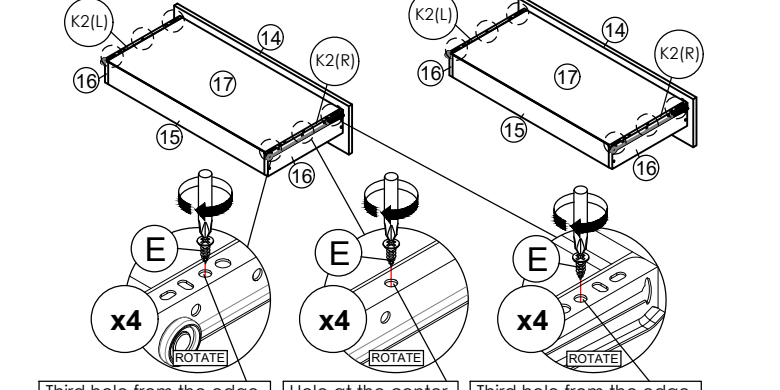

*Hardware **K2 (L/R)** shall be leaning against panel **(14)** when assembling.

STEP 17

Put all the drawer in place along the drawer slides.

