

CODING
- 345046

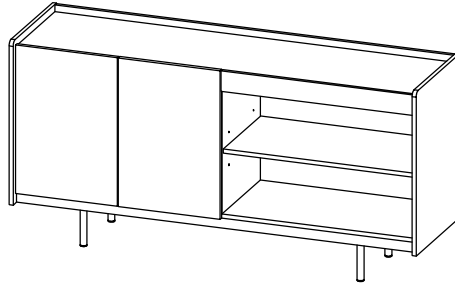

ISO 9001:2015
Reg. No. 00005-1-INT-1-QMS

nuhoom.com

Read the instructions carefully. Remove all the wrappings, staples and straps from the carton. Refer to the hardware and furniture part list for guidance. Make sure that you have all the parts before you start assembling. Place all the wooden furniture parts on a clean, flat and soft surface, such as a carpet or rubbermat to prevent scratches.

CAUTION
KEEP ALL THE PARTS OUT OF CHILDREN'S REACH.

HARDWARE			
A	MINI FIX	A1 A2 A3	23 SETS
B	M8 X 30MM WOOD DOWEL		40 PCS
C	M6 X 50MM CSK CAP WOOD SCREW		4 PCS
D	ALLEN KEY M4		1 PC
E	M3.5 X 16MM C.B SCREW		28 PCS
F	M4 X 32MM C.B SCREW		12 PCS
G	JCBC Screw M6 x 20MM		16 PCS
H	JCBC SCREW M6 X 50MM		8 PCS
I	ONE HOLE L BRACKET (2MM)		2 PCS
J	METAL SHELF SUPPORT		12 PCS
K	SOFT CLOSING 5/8 HINGES		2 PCS
L	SOFT CLOSING 7/8 HINGES		2 PCS
M	JCBC Screw M6 x 15MM		4 PCS

TIPPING PACK WITH AI			2 SETS

PART LIST		QTY
1	TOP PANEL	1 PC
2	BOTTOM PANEL	1 PC
3	SIDE PANEL (L)	1 PC
4	SIDE PANEL (R)	1 PC
5	CENTER PANEL (L)	1 PC
6	CENTER PANEL (R)	1 PC
7	SHELF PANEL (L)	2 PCS
8	SHELF PANEL (R)	1 PC
9	MIDDLE PANEL	1 PC
10	BONE PANEL	1 PC
11	BACK PANEL (UP)	1 PC
12	BACK PANEL (DOWN)	1 PC
13	DOOR PANEL (L)	1 PC
14	DOOR PANEL (R)	1 PC
15	METAL APRON	1 PC
16	METAL LEG	4 PCS

SELF-PREPARED TOOLS: Tools below are NOT included in package.	
	SCREWDRIVER
	HAMMER

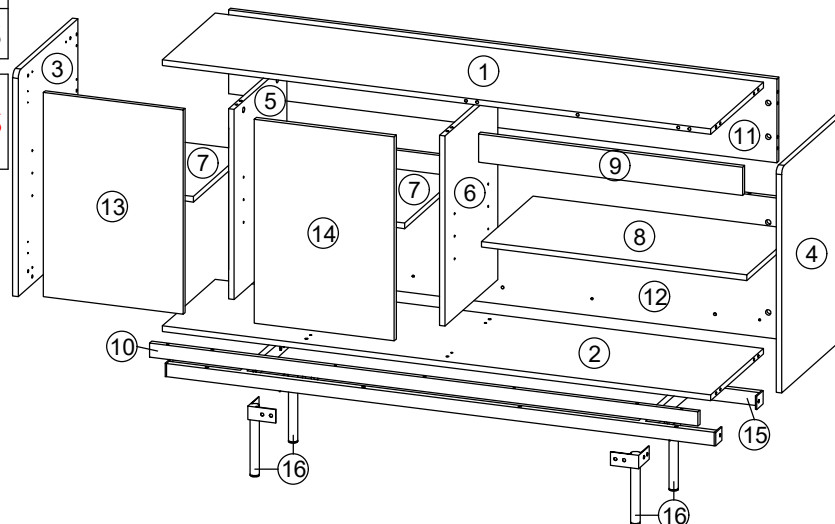

CODING
- 345046

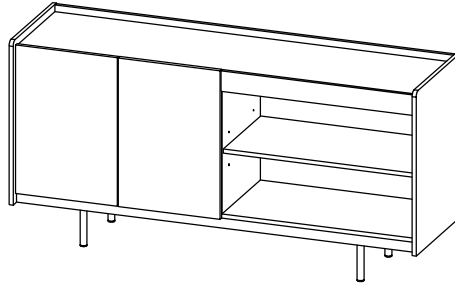

ISO 9001:2015
Reg. No. 00005-1-INT-1-QMS

nuhoom.com

STEP 1

- Insert hardware **A1** onto panel **(1)**, **(5)** and **(6)**. (Repeat 11 times.)
- Insert hardware **A2** onto panel **(1)**. (Repeat 4 times.)
- Insert hardware **B** onto panel **(1)**, **(5)** and **(6)**. (Repeat 17 times.)

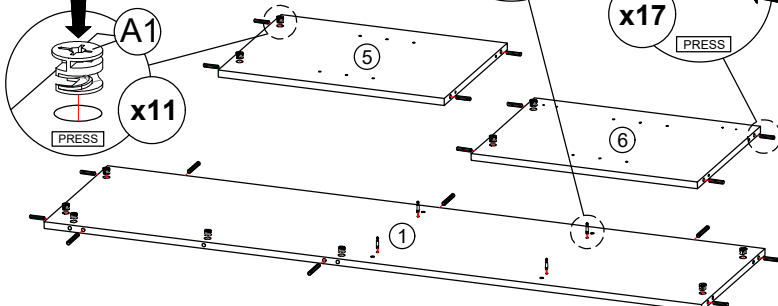

* Ensure the arrows on hardware **A1** point towards mounting positions.

STEP 3

- Insert hardware **A1** onto panel **(2)**, **(11)** and **(12)**. (Repeat 12 times.)
- Insert hardware **B** onto panel **(2)**, **(11)** and **(12)**. (Repeat 20 times.)

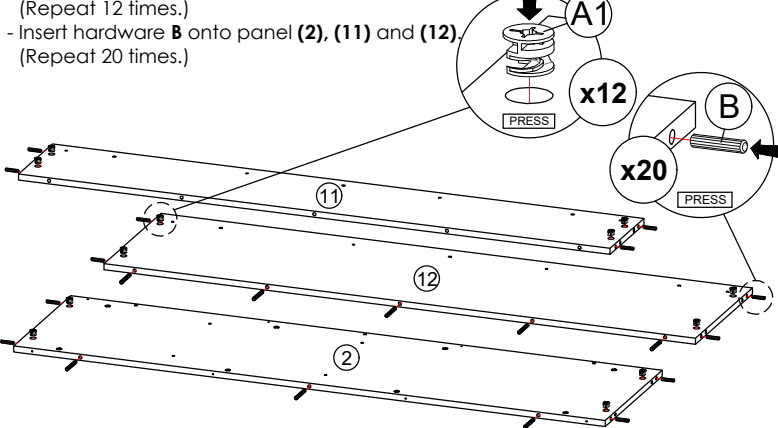

* Ensure the arrows on hardware **A1** point towards mounting positions.

STEP 5

- Attach panel **(10)** to panel **(2)** by using hardware **F**. (Repeat 4 times.)

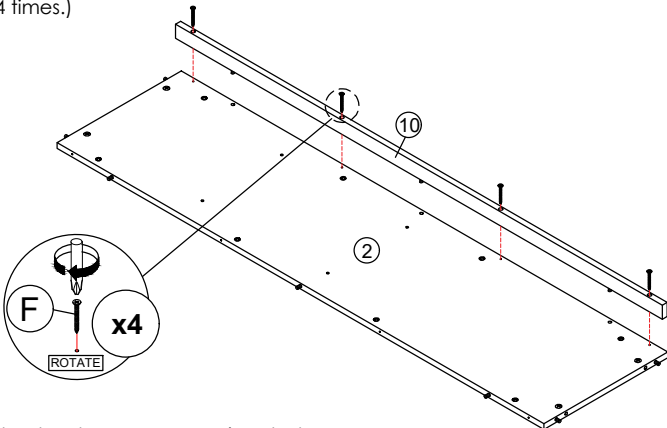

* In this step hardware **B** are pre-inserted.

STEP 2

- Assemble hardware **I** to panel **(9)** with hardware **E**. (Repeat 2 times.)
- Insert hardware **A2** onto panel **(3)**, **(4)** and **(9)**. (Repeat 19 times.)
- Insert hardware **B** onto panel **(10)**. (Repeat 3 times.)

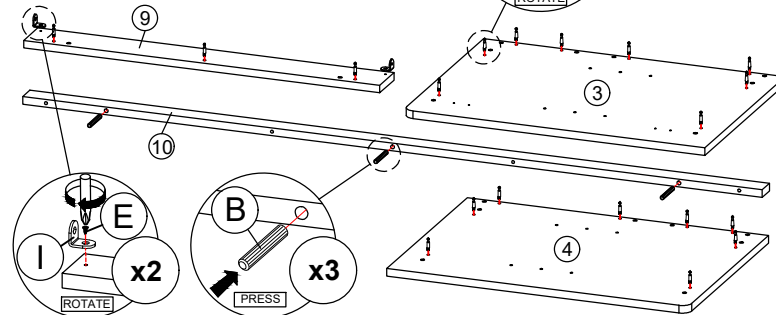

STEP 4

- Attach panel **(9)** to panel **(1)**.
- Insert all hardware **A2** into **A1**.
- Rotate all **A1** until tight.
- Apply **A3** onto all **A1**. (Repeat 3 times.)

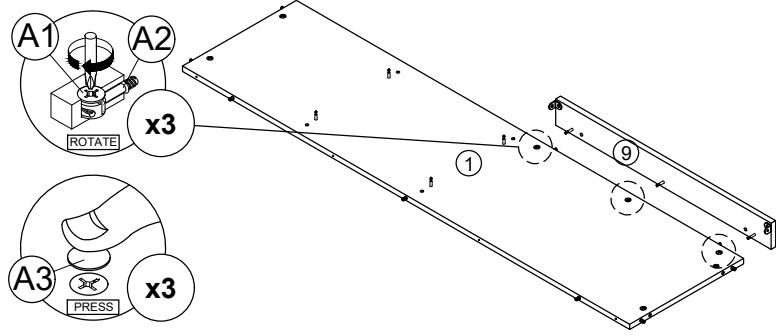
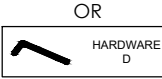

* In this step hardware **A1**, **A2** and **B** are pre-inserted.

STEP 6

- Attach panel **(5)** and **(6)** to panel **(1)**.
- Insert all hardware **A2** into **A1**.
- Rotate all **A1** until tight.
- Apply **A3** onto all **A1**. (Repeat 4 times.)

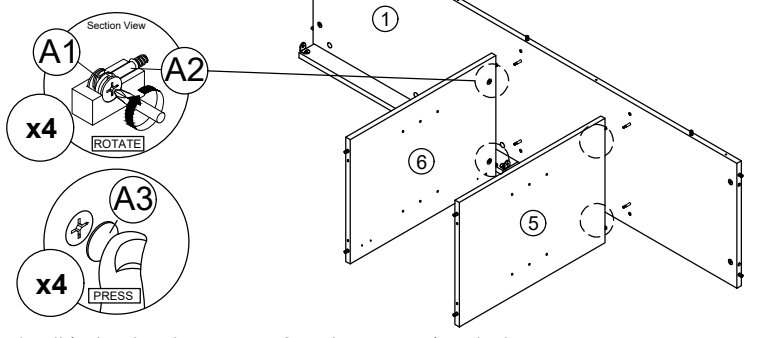
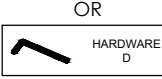

* In this step hardware **A1**, **A2** and **B** are pre-inserted.

CODING
- 345046

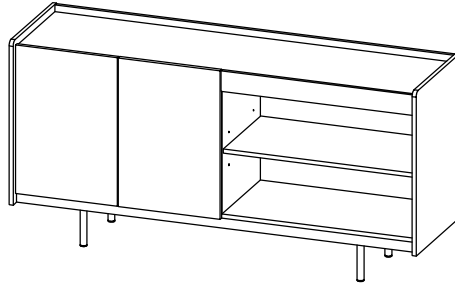

ISO 9001:2015
Reg. No. 00005-1-INT-1-QMS

nuhoom.com

STEP 7

Connect panel (2) to panel (5) and (6) by using hardware C and D.
(Repeat 4 times.)

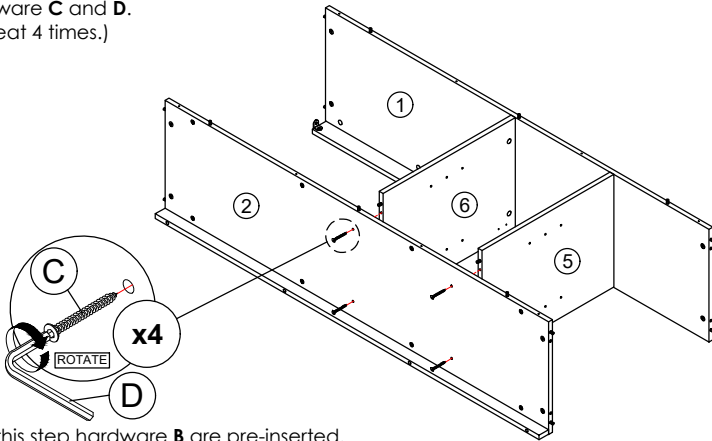
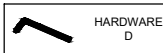

* In this step hardware B are pre-inserted.

STEP 9

Attach panel (11) and (12) to panel (1) and (2) by using hardware F.
(Repeat 8 times.)

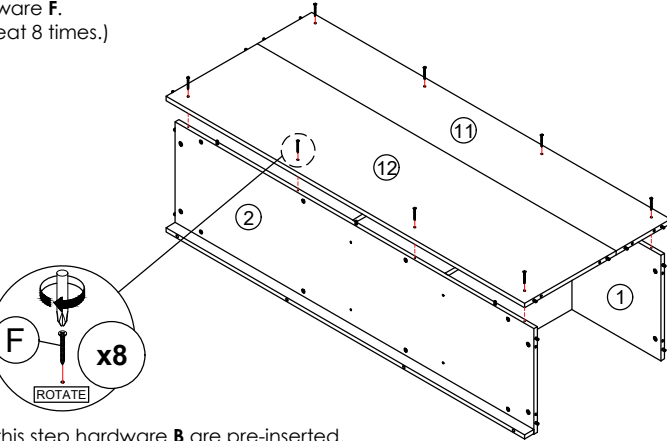
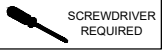

* In this step hardware B are pre-inserted.

STEP 11

- Assemble hardware I to panel (4) and (6) with hardware E.
(Repeat 2 times.)
- Connect Metal Apron (15) to panel (2) by using hardware D and H.
(Repeat 8 times.)

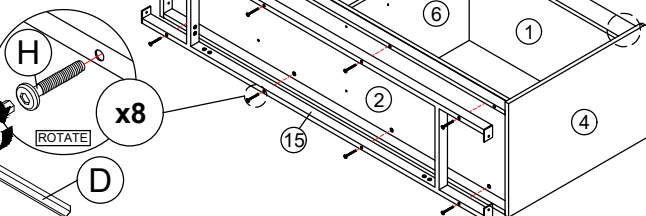
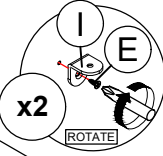

STEP 8

Attach panel (11) to panel (12).
(Repeat 1 times.)

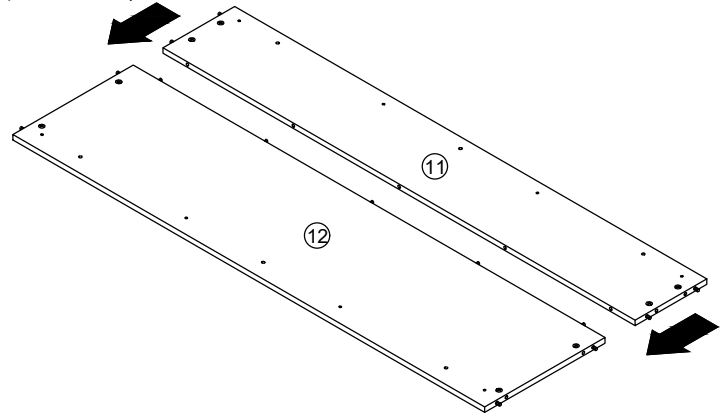

STEP 10

- Attach panel (3) and (4) to panel (1), (2), (11) and (12).
- Insert all hardware A2 into A1.
- Rotate all A1 until tight.
- Apply A3 onto all A1.
(Repeat 16 times.)

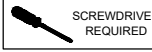

OR

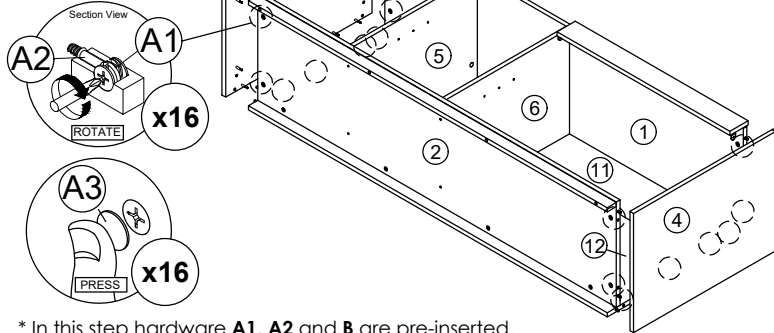

* In this step hardware A1, A2 and B are pre-inserted.

STEP 12

- Connect Metal Leg (16) to Metal Apron (15) by using hardware D and G.
(Repeat 16 times.)
- Connect Metal Apron (15) to panel (3) and (4) by using hardware D and M.
(Repeat 4 times.)

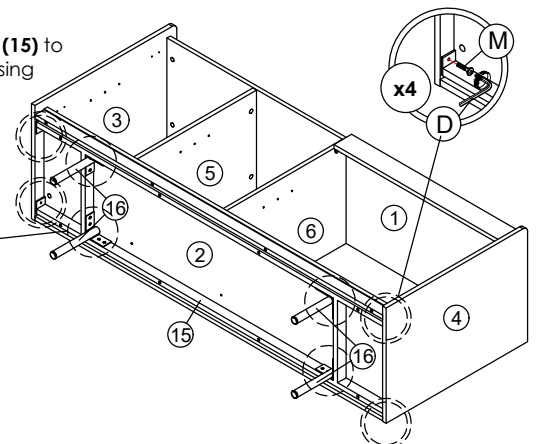
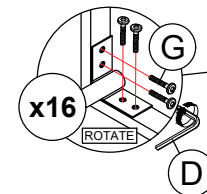

CODING
- 345046

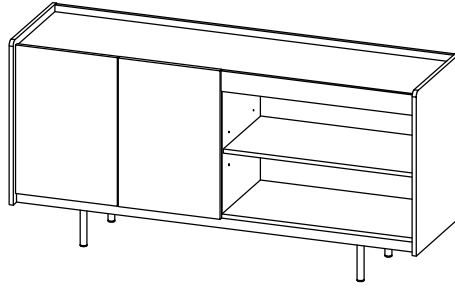

ISO 9001:2015
Reg. No. 00005-1-MIT-1-008

nuhoom.com

STEP 13

- Insert hardware **J** into mounting positions on panel **(3)**, **(4)**, **(5)** and **(6)** by hand. (Repeat 12 times.)
- Assemble the panel **(7)** and **(8)** into between panel **(3)**, **(4)**, **(5)** and **(6)**. (Repeat 3 times.)

STEP 14

- Fix hardware **L** onto panel **(13)** and hardware **K** onto panel **(14)** by using hardware **E**. (Repeat 2 times for each hardware.)

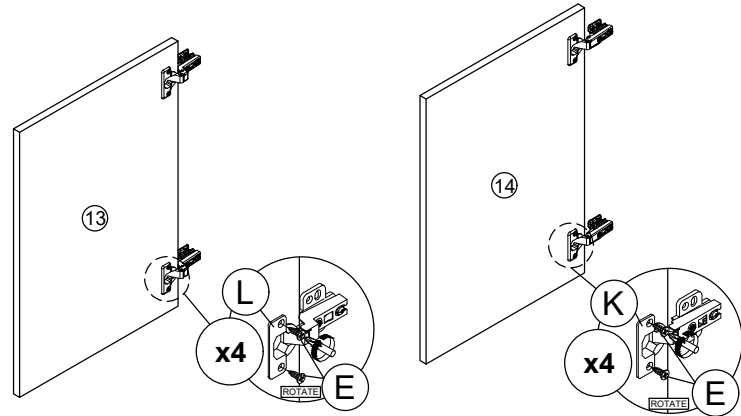
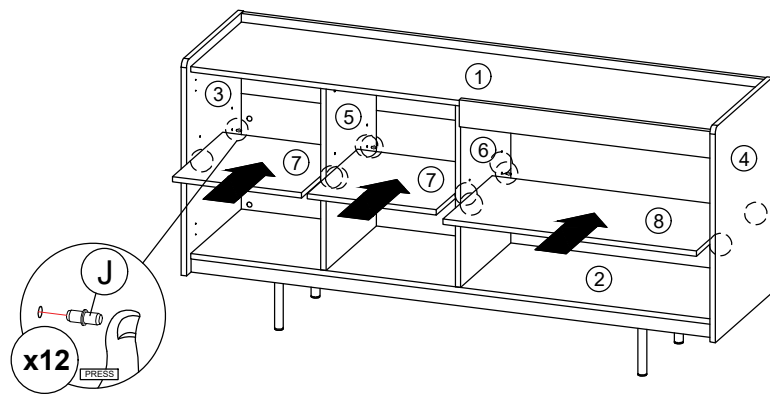

STEP 15

- Fix hardware **L** into panel **(3)** by using hardware **E**. (Repeat 4 times for each hardware.)
- Tighten or loosen the screw to adjust position of panel **(13)**. (Do only when needed.)



STEP 16

- Fix hardware **K** into panel **(6)** by using hardware **E**. (Repeat 4 times for each hardware.)
- Tighten or loosen the screw to adjust position of panel **(14)**. (Do only when needed.)

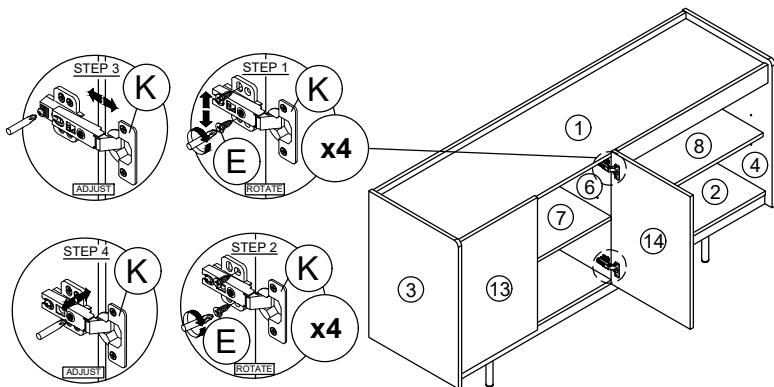
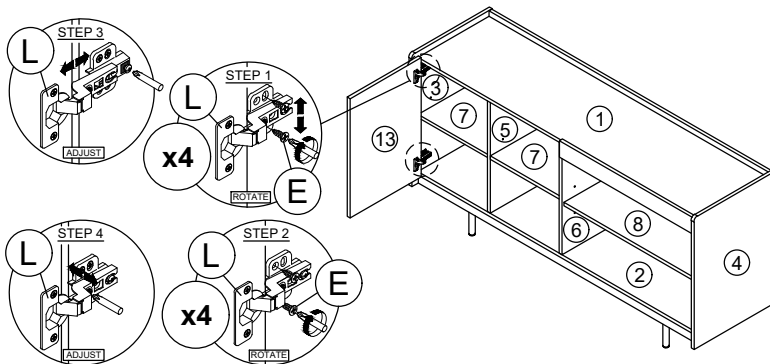

* In this step hardware **L** have been assembled in panel **(13)**.

* In this step hardware **K** have been assembled in panel **(14)**.