

CODING
- 344044

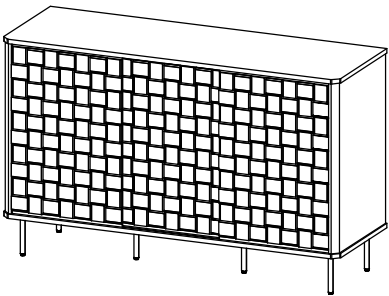

ISO 9001:2015
Reg. No. 000435-1-RTY-1-QMS



nuhoom.com

Read the instructions carefully. Remove all the wrappings , staples and straps from the carton. Refer to the hardware and furniture part list for guidance. Make sure that you have all the parts before you start assembling. Place all the wooden furniture parts on a clean, flat and soft surface, such as a carpet or rubbermat to prevent scratches.

CAUTION
KEEP ALL THE PARTS OUT OF CHILDREN’S REACH.

HARDWARE			
A	MINI FIX	A1  A2  A3 	8 SETS
B	M8 X 30MM WOOD DOWEL		16 PCS
C	M6 X 50MM CSK CAP WOOD SCREW		8 PCS
D	ALLEN KEY M4		1 PC
E	M3.5 X 16MM C.B SCREW		24 PCS
F	METAL SHELF SUPPORT		12 PCS
G	PAN HEAD SCREW M4 X 16MM		8 PCS
H	METAL CENTER LEG (50 x 50 x H140MM)		6 PCS

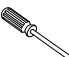
PART LIST		QTY
1	TOP PANEL	1 PC
2	BOTTOM PANEL	1 PC
3	SIDE PANEL (L)	1 PC
4	SIDE PANEL (R)	1 PC
5	CENTER PANEL (L)	1 PC
6	CENTER PANEL (R)	1 PC
7	BACK PANEL	1 PC
8	SHELF PANEL (L&R)	2 PCS
9	SHELF PANEL (CENTER)	1 PC
10	DOOR	3 PCS

SELF-PREPARED TOOLS: Tools below are NOT included in package.	
 SCREWDRIVER	 HAMMER

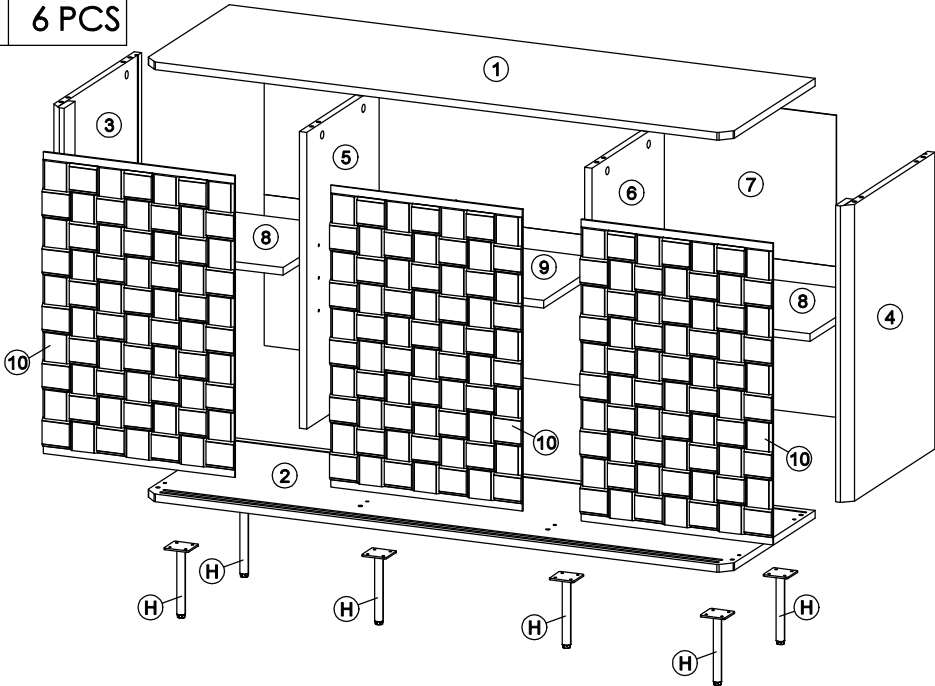

CODING
- 344044

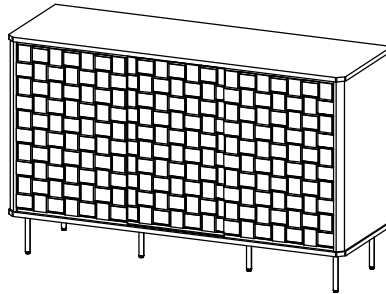

ISO 9001:2015
Reg. No. 000435-1-INT-1-QMS

nuhoom.com

STEP 1

- Insert hardware **A2** onto panel **(1)**.
(Repeat 8 times.)
- Insert hardware **B** into panel **(3)**, **(4)**, **(5)** and **(6)**.
(Repeat 16 times.)

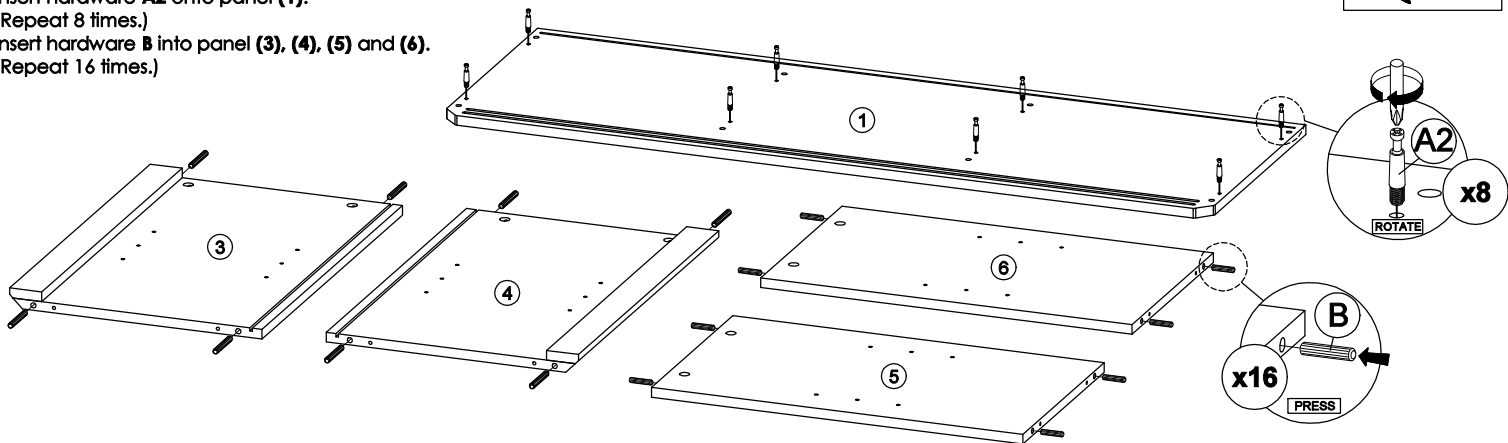

STEP 2

- Insert hardware **A1** into panel **(3)**, **(4)**, **(5)** and **(6)**.
(Repeat 8 times.)
- Attach panel **(3)**, **(4)**, **(5)** and **(6)** to panel **(1)**.
- Insert all hardware **A2** into **A1**.
- Rotate all **A1** until tight.
- Apply **A3** onto all **A1**.
(Repeat 8 times.)

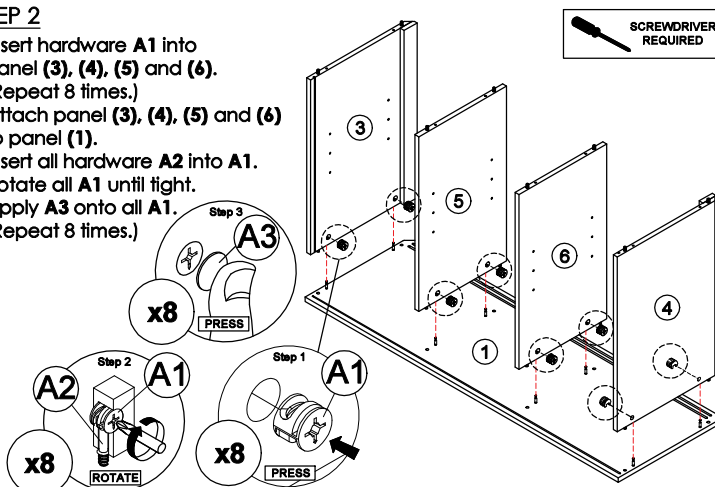

STEP 3

Insert the panel **(7)** along the slot.

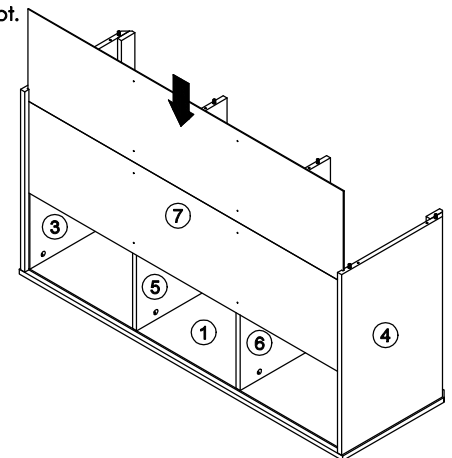

STEP 4

- Connect panel **(2)** to panel **(3)**, **(4)**, **(5)** and **(6)** by using hardware **C** and **D**.
(Repeat 8 times.)

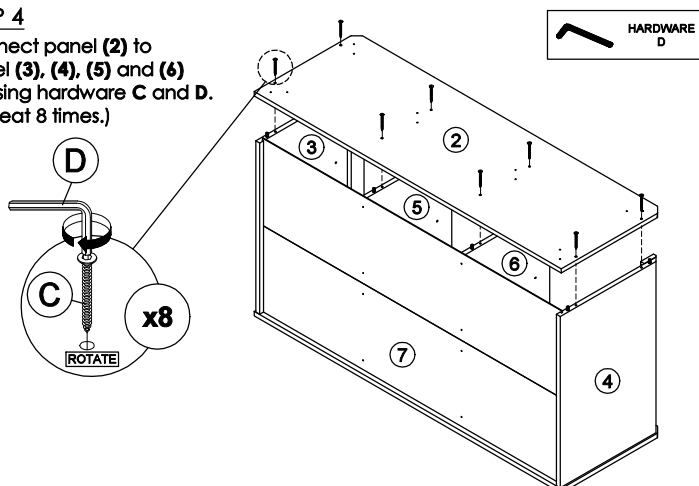

STEP 5

- Connect panel **(7)** to panel **(5)** and **(6)** by using hardware **G**.
(Repeat 8 times.)

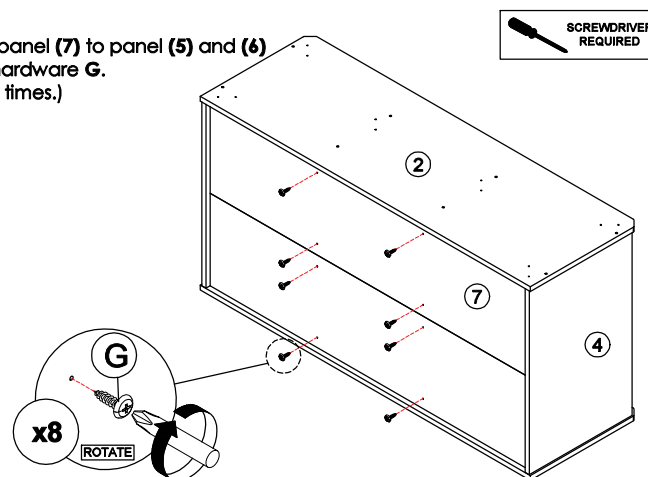

CODING
- 344044

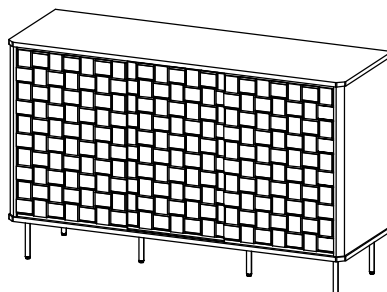

ISO 9001:2015
Reg. No. 000435-1-001-1-QMS

nuhoom.com

STEP 6

Assemble hardware **H** onto panel **(2)** by using hardware **E**.
(Repeat 4 times for each hardware.)

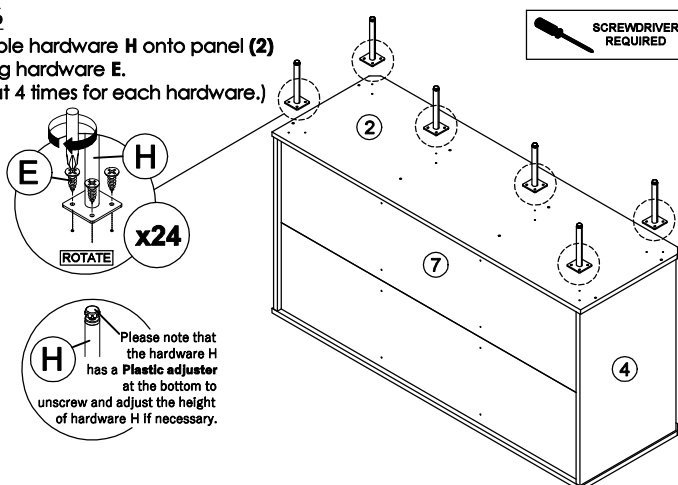

STEP 7

Insert hardware **F** into mounting positions on panel **(3)**, **(4)**, **(5)** and **(6)** by hand.
(Repeat 12 times.)

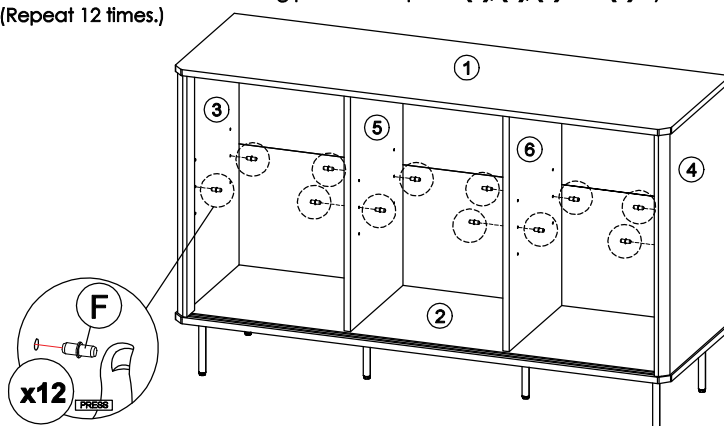

STEP 8

- Assemble the panel **(8)** into between panel **(3)** and **(5)**.
- Assemble the panel **(8)** into between panel **(4)** and **(6)**.
- Assemble the panel **(9)** into between panel **(5)** and **(6)**.

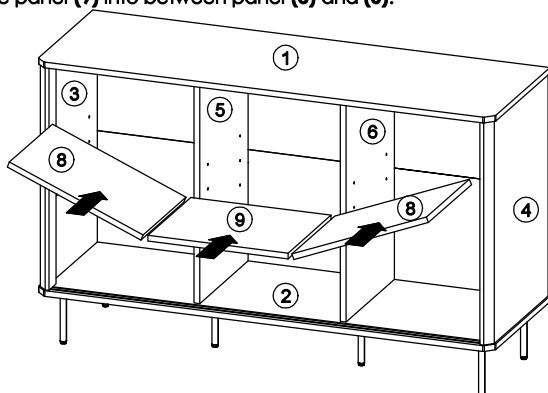

STEP 9

- Insert one door only in back groove.
- Insert the panel **(10)** in the top groove first, then enter through the bottom groove.

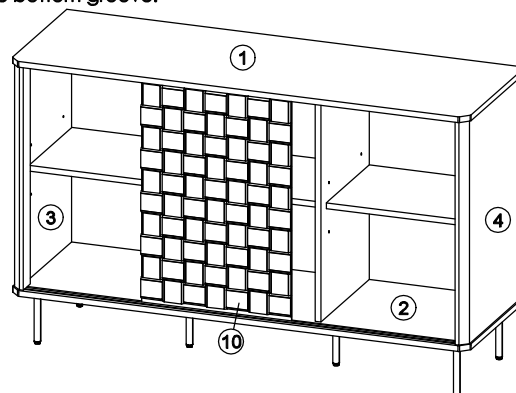

STEP 10

- Insert two door in front groove.
- Insert the panel **(10)** in the top groove first, then enter through the bottom groove.

