

CODING
- 344041

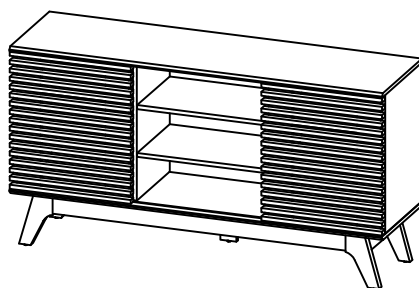

ISO 9001:2015
Reg. No. 000435-1-007-1-QM8

nuhoom.com

Read the instructions carefully. Remove all the wrappings, staples and straps from the carton. Refer to the hardware and furniture part list for guidance. Make sure that you have all the parts before you start assembling. Place all the wooden furniture parts on a clean, flat and soft surface, such as a carpet or rubbermat to prevent scratches.

CAUTION
KEEP ALL THE PARTS OUT OF CHILDREN'S REACH.

PART LIST		QTY
1	TOP PANEL	1 PC
2	BOTTOM PANEL	1 PC
3	SIDE PANEL (L)	1 PC
4	SIDE PANEL (R)	1 PC
5	CENTER PANEL	2 PCS
6	SHELF PANEL	2 PCS
7	SHELF PANEL - L/R	4 PCS
8	BACK BONE	2 PCS
9	BACK PANEL	1 PC
10	SLIDING DOOR	2 PCS
11	APRON - SHORT	2 PCS
12	CABINET LEG FRONT	1 PC
13	CABINET LEG BACK	1 PC
14	CENTER LEG	1 PC

HARDWARE			
A	MINI FIX	A1 A2 A3	16 SETS
B	M8 X 30MM WOOD DOWEL		26 PCS
C	M6 X 50MM CSK CAP WOOD SCREW		12 PCS
D	ALLEN KEY M4		1 PC
E	M3 X 12MM C.B SCREW		16 PCS
F	M4 X 30MM C.B SCREW		2 PCS
G	M4 X 65MM C.B SCREW		16 PCS
H	5/8 PVC NAIL LEG		5 PCS
I	METAL SHELF SUPPORT		24 PCS
J	STUD 192 WITH SCREW	J1 J2	10 SETS
K	U 480 ROLLER	K1 K2	4 SETS
	TIPPING PACK WITH A1		2 SETS

SELF-PREPARED TOOLS: Tools below are NOT included in package.

	SCREWDRIVER		HAMMER
--	-------------	--	--------

CODING
- 344041

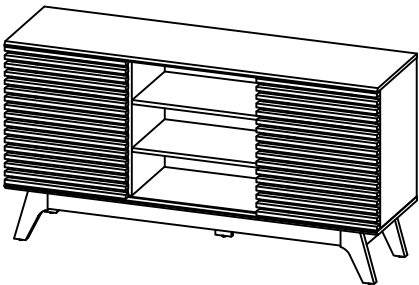

ISO 9001:2015
Reg. No. 000435-1-001-1-QMS

nuhoom.com

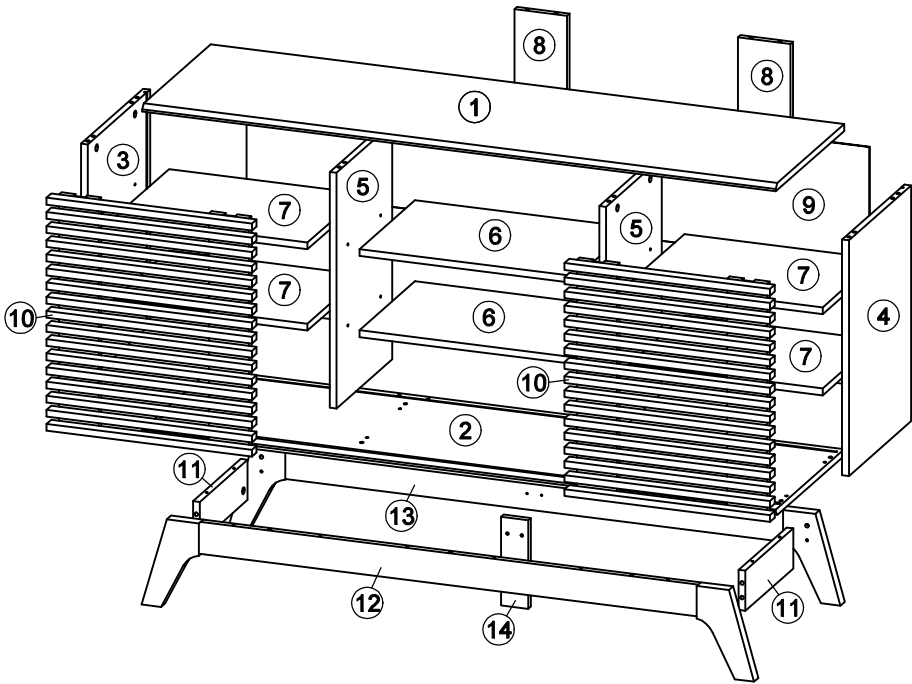

CODING
- 344041

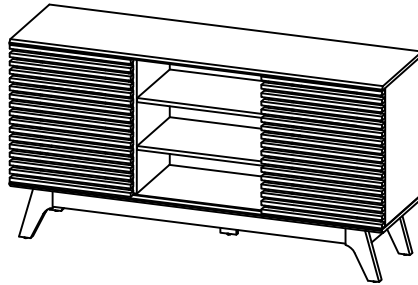

ISO 9001:2015
Reg. No. 000435-1-017-1-QMS

nuhoom.com

STEP 1

- Insert hardware **A2** onto panel (1).
(Repeat 12 times.)

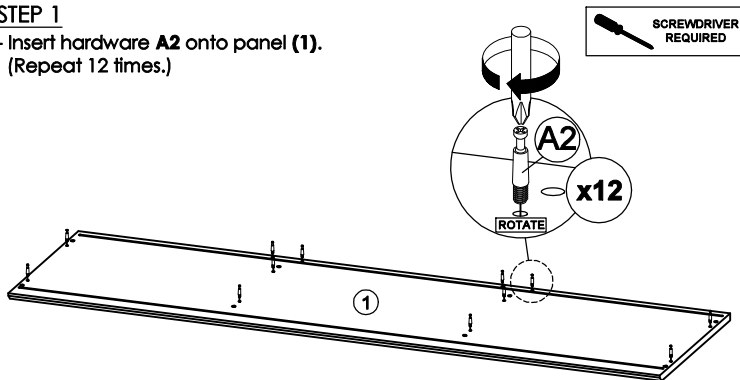

STEP 2

- Insert hardware **A1** onto panel (3), (4) and (5).
(Repeat 8 times.)
- Insert hardware **B** onto panel (3), (4) and (5).
(Repeat 16 times.)

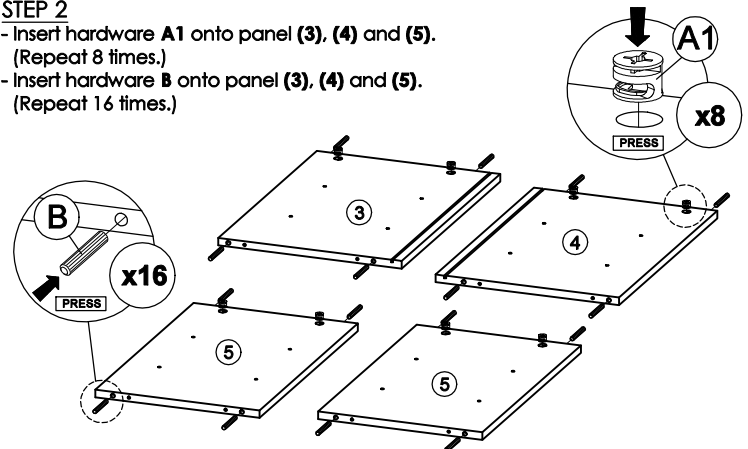

* Ensure the arrows on hardware **A1** point towards mounting positions.

STEP 3

- Insert hardware **A1** onto panel (8) and (11).
(Repeat 8 times.)
- Insert hardware **A2** onto panel (12) and (13).
(Repeat 4 times.)
- Insert hardware **B** onto panel (11), (12) and (13).
(Repeat 10 times.)

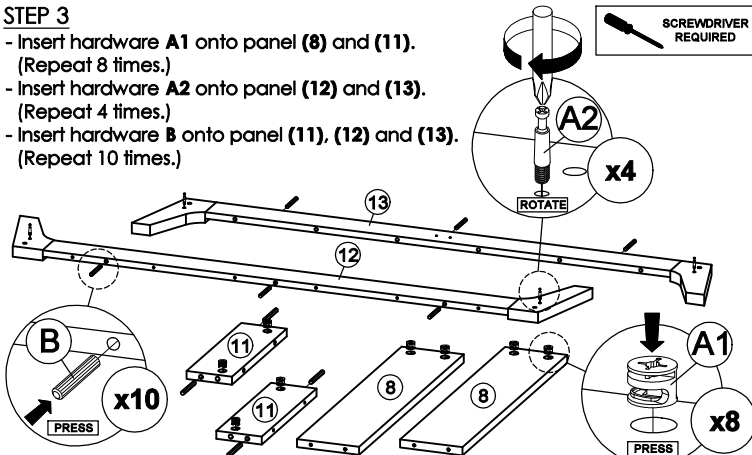

* Ensure the arrows on hardware **A1** point towards mounting positions.

STEP 4

- Attach panel (1) to panel (3), (4) and (5).
- Insert all hardware **A2** into **A1**.
- Rotate all **A1** until tight.
- Apply **A3** onto all **A1**.
(Repeat 8 times.)

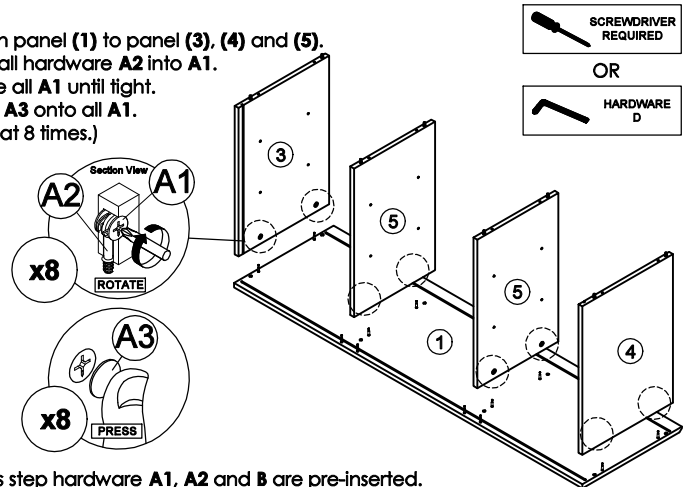

* In this step hardware **A1**, **A2** and **B** are pre-inserted.

STEP 5

- Attach panel (1) to panel (8).
- Insert all hardware **A2** into **A1**.
- Rotate all **A1** until tight.
- Apply **A3** onto all **A1**.
(Repeat 4 times.)

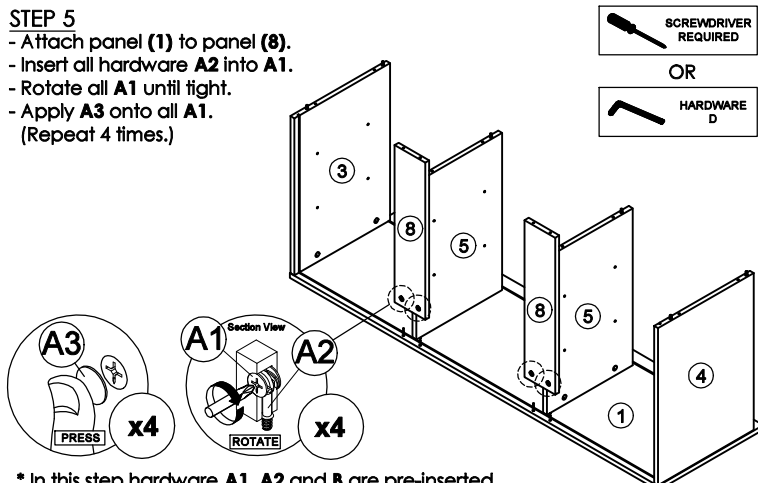

* In this step hardware **A1**, **A2** and **B** are pre-inserted.

STEP 6

- Insert the panel (9) along the slot.
(Repeat 1 times.)

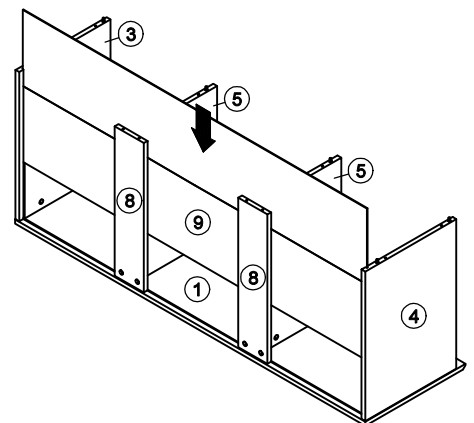

CODING
- 344041

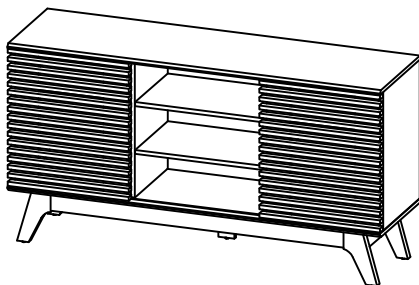

ISO 9001:2015
Reg. No. 000435-1-MY-1-QMS

nuhoom.com

STEP 7

- Connect panel (2) to panel (3), (4) and (5) by using hardware C and D.
- (Repeat 12 times.)

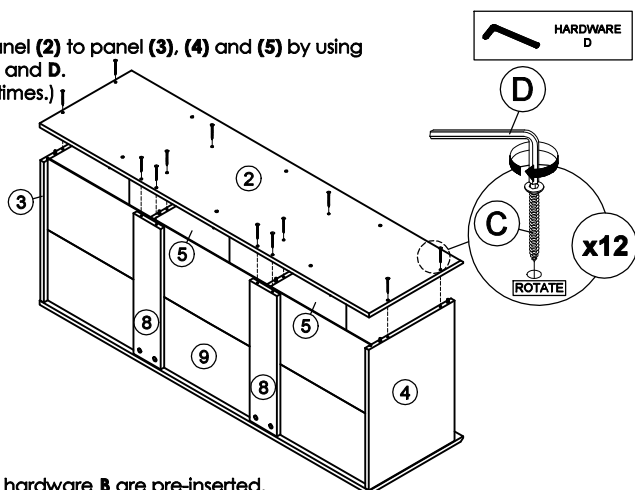

* In this step hardware B are pre-inserted.

STEP 9

- Attach panel (11) to panel (12) and (13).
- Insert all hardware A2 into A1.
- Rotate all A1 until tight.
- Apply A3 onto all A1.
- (Repeat 4 times.)

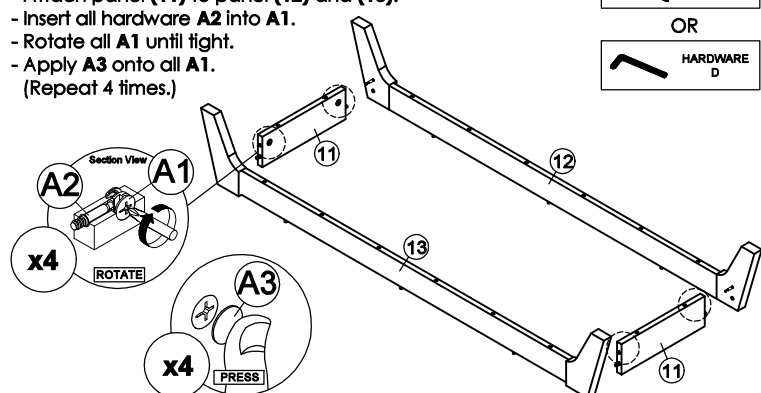

* In this step hardware A1, A2 and B are pre-inserted.

STEP 11

- Connect panel (14) to panel (13) by using hardware F.
- (Repeat 2 times.)

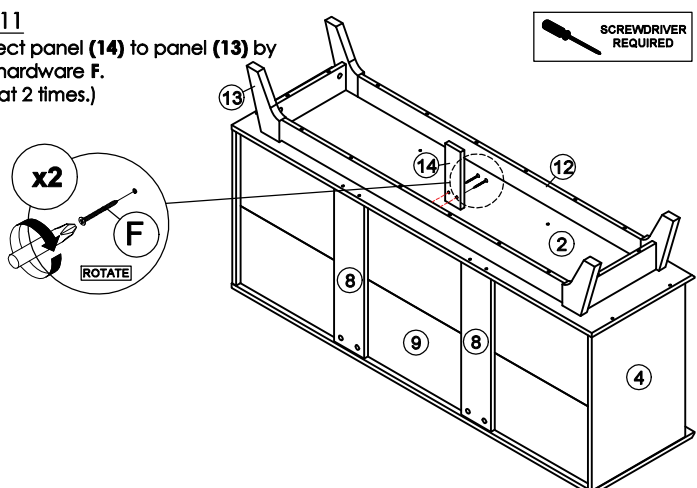

STEP 8

- Insert hardware J1 into slot at panel (9).
- Assemble hardware J1 by using hardware J2.
- (Repeat 10 times.)

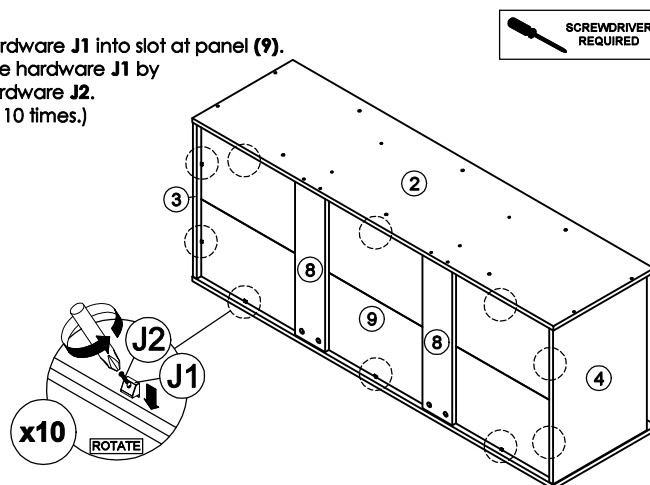

STEP 10

- Connect panel (11), (12) and (13) to panel (2) by using hardware G.
- (Repeat 16 times.)

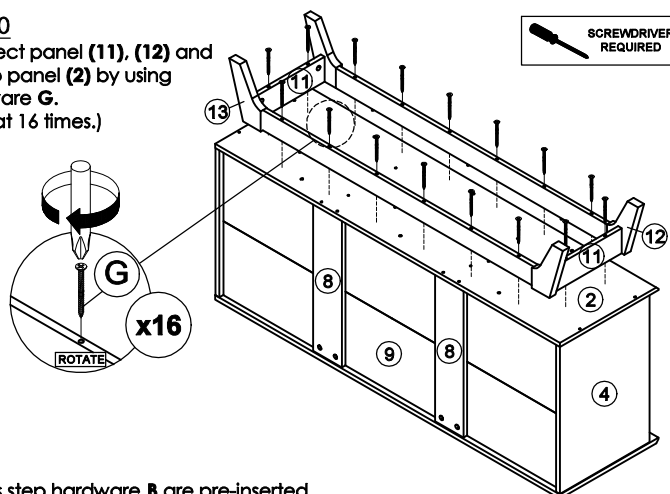

* In this step hardware B are pre-inserted.

STEP 12

- Hit hardware H into bottom of panel (12), (13) and (14).
- (Repeat 5 times.)

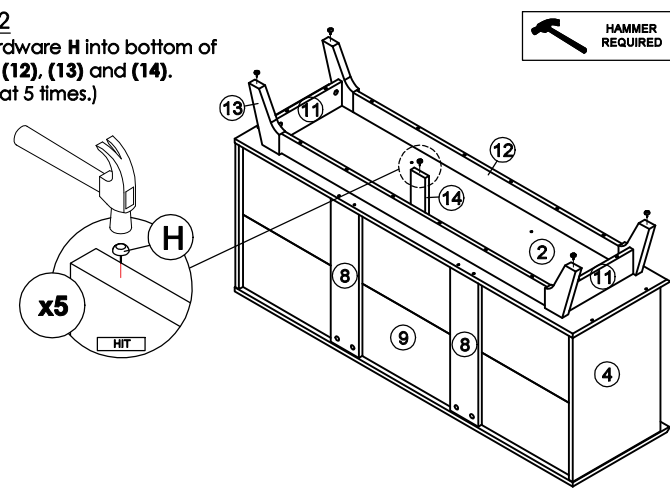

CODING
- 344041

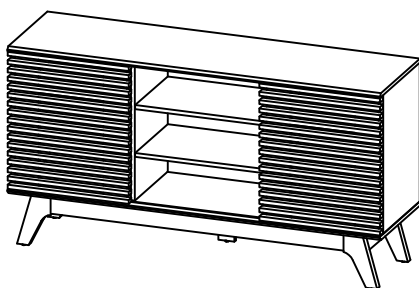

ISO 9001:2015
Reg. No. 000435-1-001-1-QM08

nuhoom.com

STEP 13

- Insert hardware **I** into mounting positions on panel **(3)**, **(4)** and **(5)** by hand.
(Repeat 24 times.)

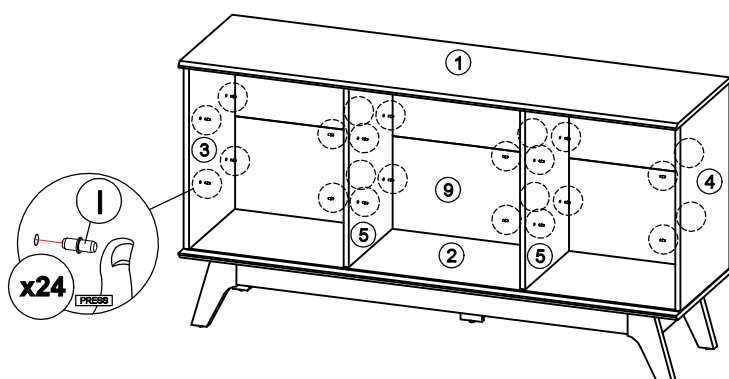

STEP 14

- Assemble the panel **(7)** into between panel **(3)** and **(5)**.
(Repeat 2 times.)
- Assemble the panel **(6)** into between both of the panel **(5)**.
(Repeat 2 times.)
- Assemble the panel **(7)** into between panel **(4)** and **(5)**.
(Repeat 2 times.)

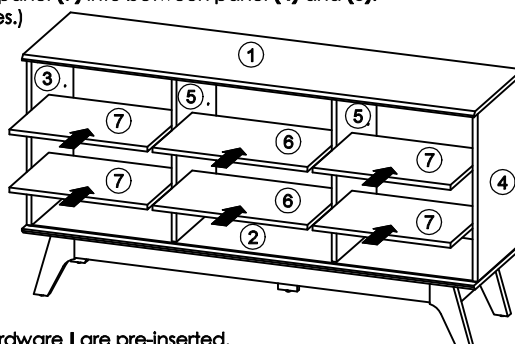

* In this step hardware **I** are pre-inserted.

STEP 15

- Assemble hardware **K1** and **K2** to two panel **(10)** with hardware **E**.
(Repeat 2 times for each hardware.)

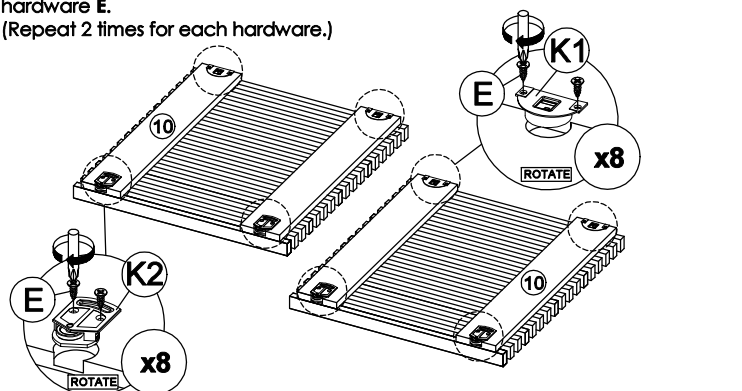

STEP 16

- Put the panel **(10)** in place.
(Repeat 2 times.)

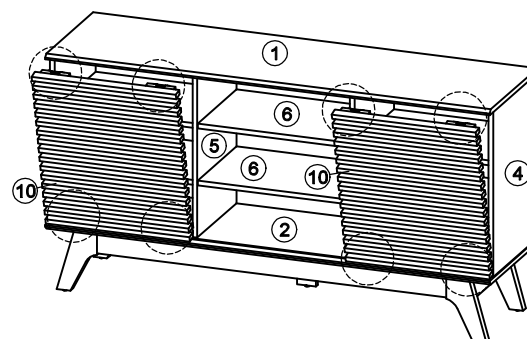

* In this step hardware **K1** and **K2** are pre-inserted.

