

CODING
- 344022

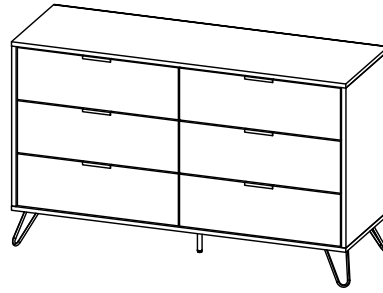

ISO 9001:2015
Reg. No. 00051-MT-1-QMS

nuhoom.com

Read the instructions carefully. Remove all the wrappings, staples and straps from the carton. Refer to the hardware and furniture part list for guidance. Make sure that you have all the parts before you start assembling. Place all the wooden furniture parts on a clean, flat and soft surface, such as a carpet or rubbermat to prevent scratches.

CAUTION
KEEP ALL THE PARTS OUT OF CHILDREN'S REACH.

PART LIST		QTY
1	TOP PANEL	1 PC
2	BOTTOM PANEL	1 PC
3	SIDE PANEL (L)	1 PC
4	SIDE PANEL (R)	1 PC
5	CENTER PANEL	1 PC
6	BACK PANEL	1 PC
7	DRAWER FRONT (L)	3 PCS
8	DRAWER FRONT (R)	3 PCS
9	DRAWER SIDE	12 PCS
10	DRAWER BACK	6 PCS
11	DRAWER BOTTOM	6 PCS

HARDWARE			
A	MINI FIX	A1 A2 A3	6 SETS
B	M8 X 30MM WOOD DOWEL		12 PCS
C	M6 X 50MM CSK CAP WOOD SCREW		6 PCS
D	ALLEN KEY M4		1 PC
E	M3 X 12MM C.B SCREW		12 PCS
F	M3.5 X 16MM C.B SCREW		92 PCS
G	M4 X 38MM C.B SCREW		48 PCS
H	5/8 NAIL		84 PCS
I	HANDLE EM 0071		6 PCS
J	METAL LEG 90 x 90 x 10 x H145MM		4 PCS
K	METAL LEG 50 x 50 x H140MM (CENTER)		1 PC
L	14" DRAWER SLIDE	L1 (L/R) L2 (L/R)	6 SETS

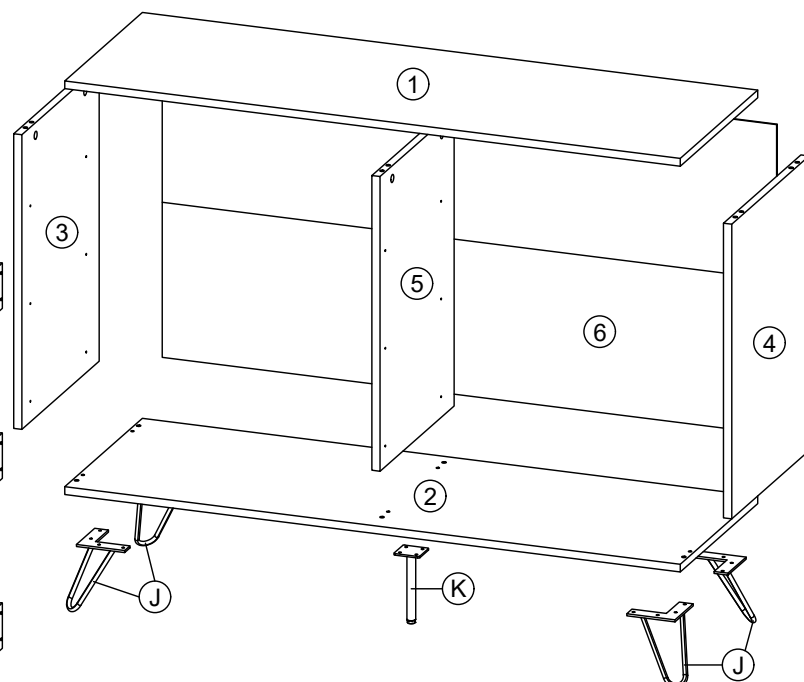
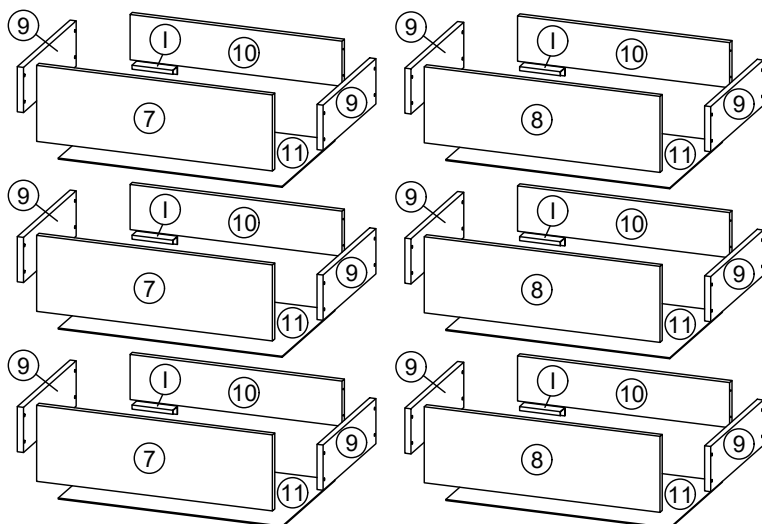

CODING
- 344022

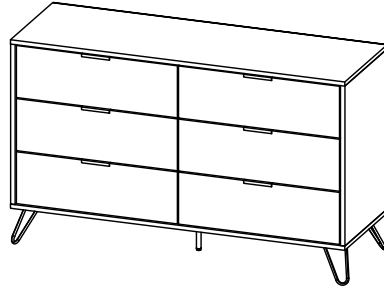

ISO 9001:2015
Reg. No. 00005-1-007-1-Q005

nuhoom.com

STEP 1

- Insert hardware **A1** onto panel (5). (Repeat 2 times.)
- Insert hardware **A2** onto panel (1). (Repeat 6 times.)
- Insert hardware **B** onto panel (5). (Repeat 4 times.)

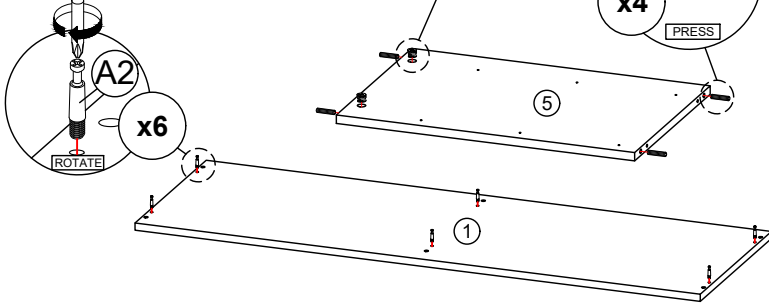

* Ensure the arrows on hardware **A1** point towards mounting positions.

STEP 3

- Fix hardware **L1 (L)** into panel (3) and (5) with hardware **F**. (Repeat 3 times for each hardware.)

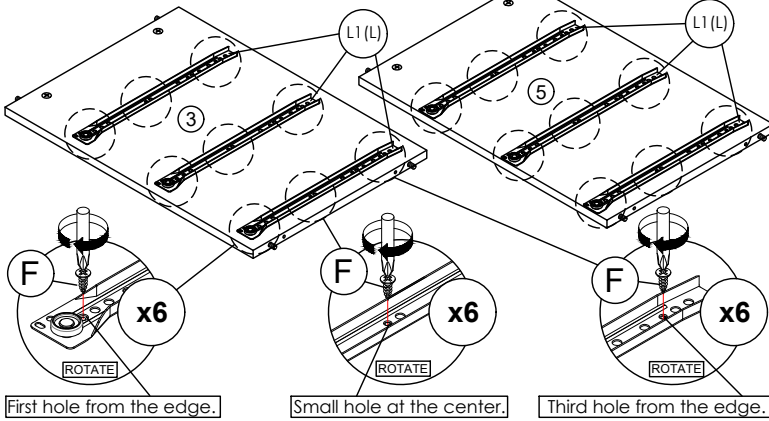

STEP 5

- Fix hardware **L1 (R)** into panel (5) with hardware **F**. (Repeat 3 times for each hardware.)

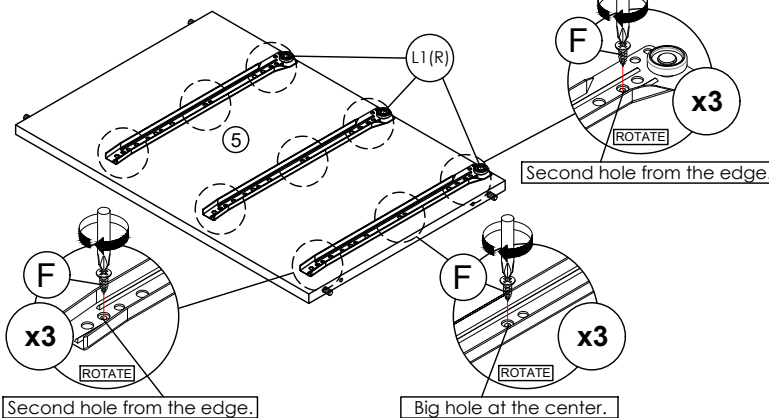

STEP 2

- Insert hardware **A1** onto panel (3) and (4). (Repeat 4 times.)
- Insert hardware **B** onto panel (3) and (4). (Repeat 8 times.)

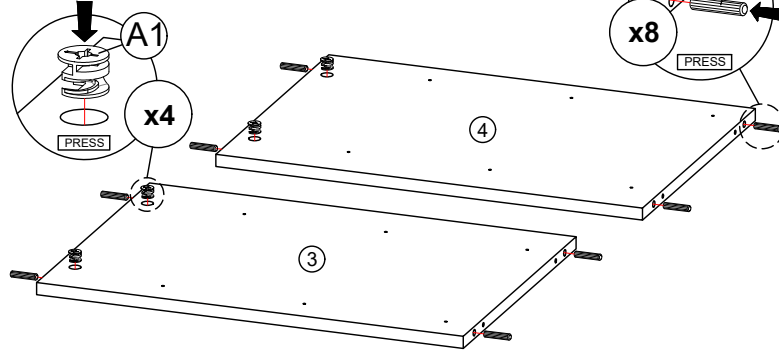

* Ensure the arrows on hardware **A1** point towards mounting positions.

STEP 4

- Fix hardware **L1 (R)** into panel (4) with hardware **F**. (Repeat 3 times for each hardware.)

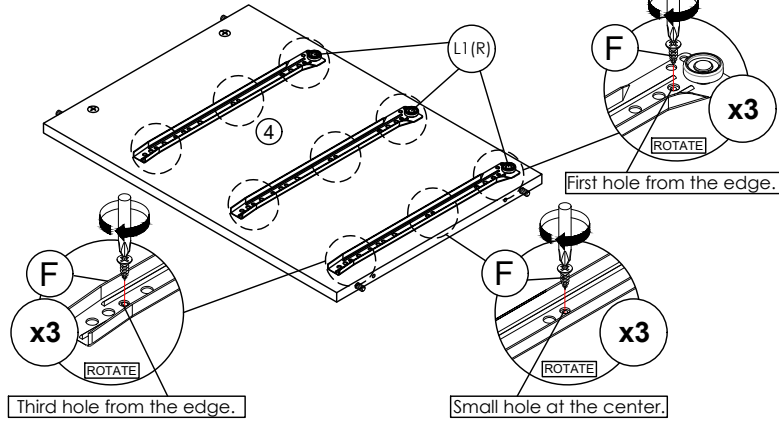

STEP 6

- Attach panel (1) to panel (3), (4) and (5).
- Insert all hardware **A2** into **A1**.
- Rotate all **A1** until tight.
- Apply **A3** onto all **A1**. (Repeat 6 times.)

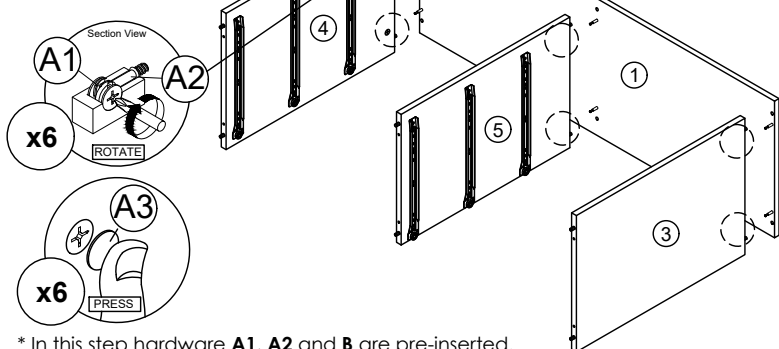

* In this step hardware **A1**, **A2** and **B** are pre-inserted.

CODING
- 344022

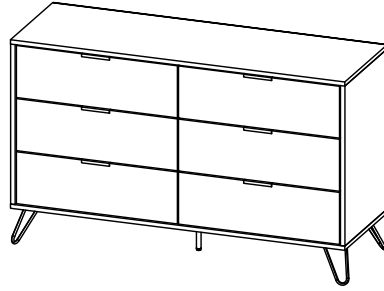

ISO 9001:2015
Reg. No. 00005-1-007-1-QMS

nuhoom.com

STEP 7

Connect panel (2) to panel (3), (4) and (5) by using hardware C and D.
(Repeat 6 times.)

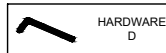

STEP 8

Assemble panel (6) to entire body with hardware H.
(Repeat 24 times.)

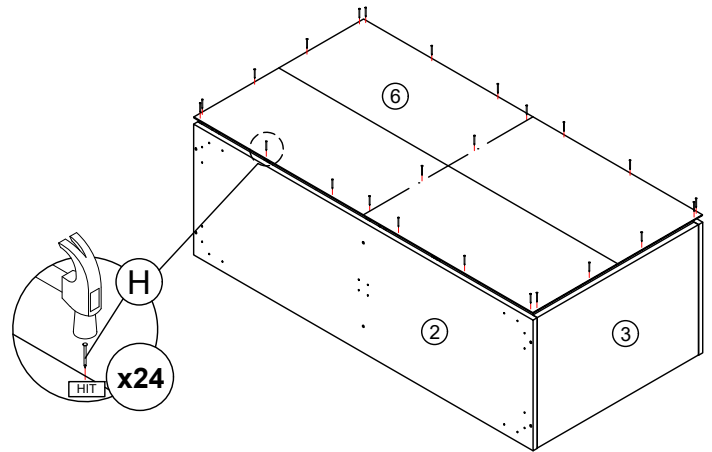
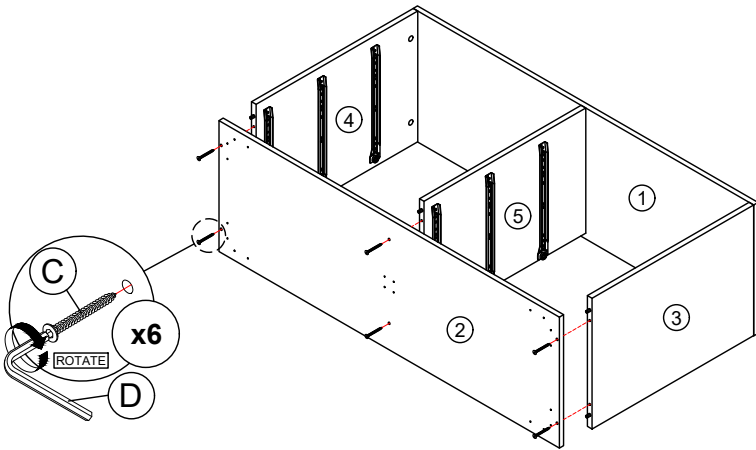

* In this step hardware B are pre-inserted.

STEP 9

Assemble hardware J and K onto panel (2) by using hardware F.
(Repeat 4 times for each hardware.)



STEP 10

Fix hardware I onto panel (7) and (8) by using hardware E.
(Repeat 12 times.)



* In this step only show one of the drawers.

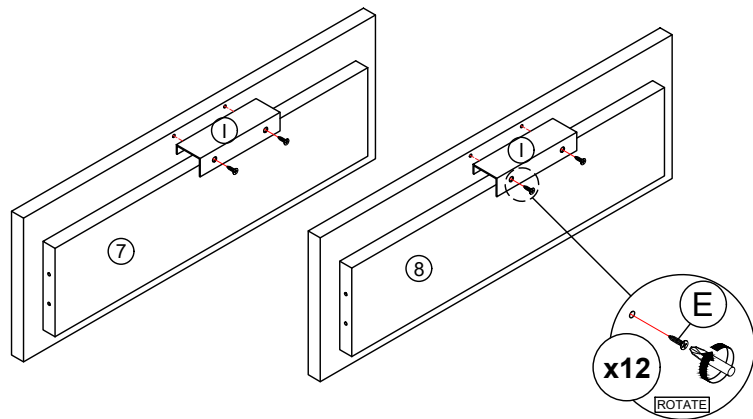
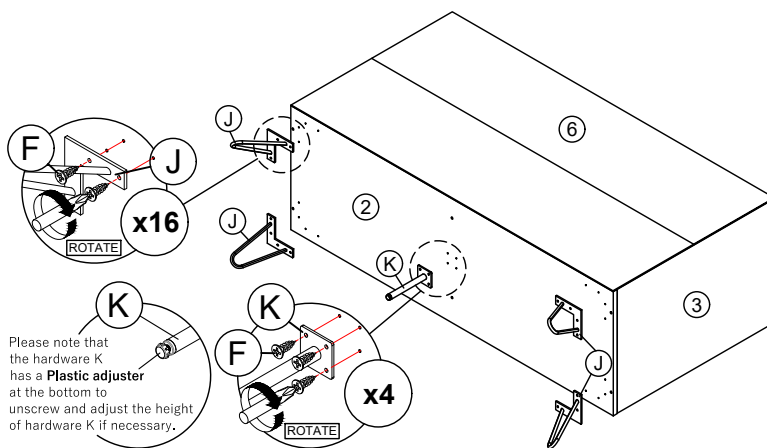

CODING
- 344022

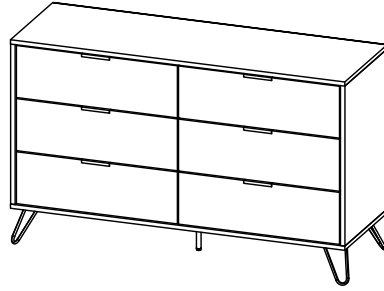

ISO 9001:2015
Reg. No. 00005-1-007-1-QMS

nuhoom.com

STEP 11

Assemble panel (9) to panel (7) or (8) and (10) by using hardware G.

(Repeat 48 times.)
* In this step only show one of the drawers.



STEP 12

Assemble panel (11) to entire body with hardware H.

(Repeat 60 times.)
* In this step only show one of the drawers.

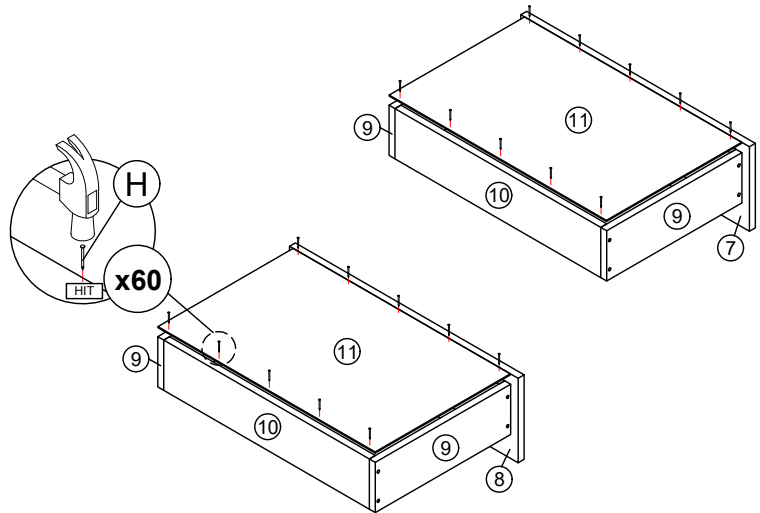
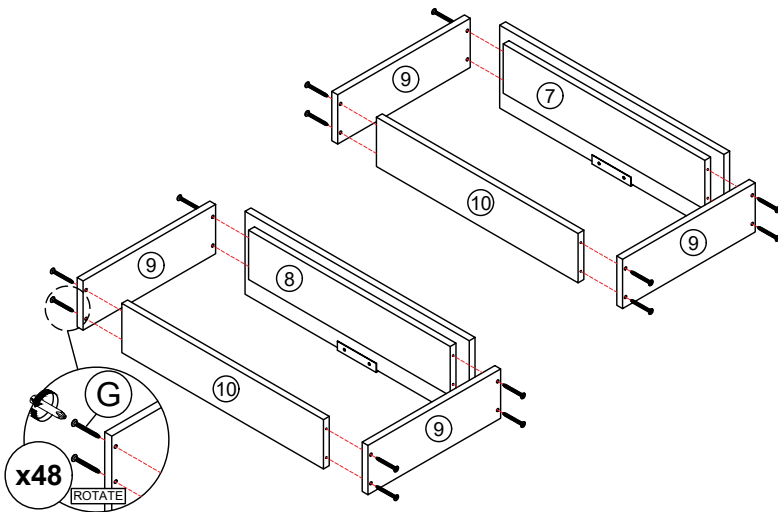

STEP 13

Assemble hardware L2 (L/R) to panel (11) by using hardware F.

(Repeat 3 times for each hardware.)
* In this step only show one of the drawers.



STEP 14

Put all the drawer in place along the drawer slides.

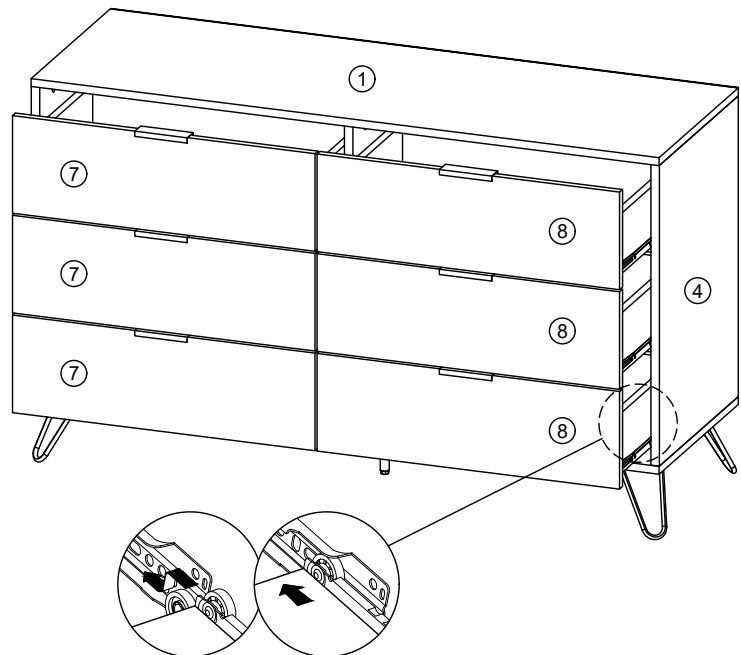
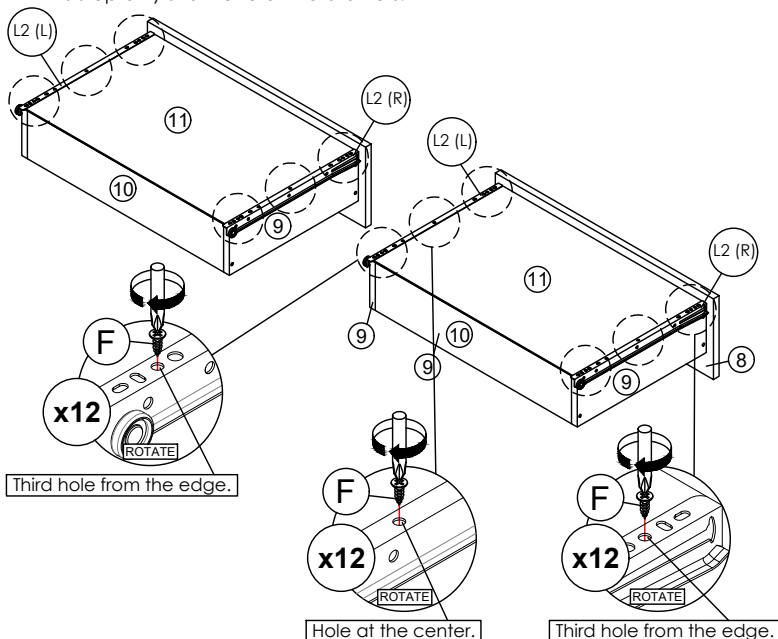

*Hardware L2 (L/R) shall be leaning against panel (7) or (8) when assembling.