

CODING
- 343038

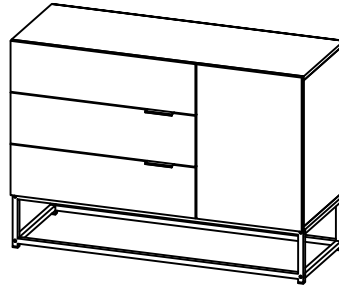

ISO 9001:2015
Reg. No. 00005-1-INT-1-QMS

nuhoom.com

Read the instructions carefully. Remove all the wrappings, staples and straps from the carton. Refer to the hardware and furniture part list for guidance. Make sure that you have all the parts before you start assembling. Place all the wooden furniture parts on a clean, flat and soft surface, such as a carpet or rubbermat to prevent scratches.

CAUTION
KEEP ALL THE PARTS OUT OF CHILDREN'S REACH.

HARDWARE				
A	MINI FIX	A1 A2 A3		10 SETS
B	M8 X 30MM WOOD DOWEL			12 PCS
C	M6 X 50MM CSK CAP WOOD SCREW			6 PCS
D	ALLEN KEY M4			1 PC
E	M3.5 X 16MM C.B SCREW			48 PCS
F	M3 X 12MM C.B SCREW			4 PCS
G	M4 X 38MM C.B SCREW			24 PCS
H	5/8 NAIL			60 PCS
I	METAL SHELF SUPPORT			4 PCS
J	MODERN HANDLE L100			2 PCS
K	JCBC SCREW M6 X 30MM			6 PCS
L	JCBC SCREW M6 X 40MM			8 PCS
M	SOFT CLOSING 5/8 HINGES			2 PCS
N	14" DRAWER SLIDE	N1 (L/R) N2 (L/R)		3 SETS

PART LIST		QTY
1	TOP PANEL	1 PC
2	BOTTOM PANEL	1 PC
3	SIDE PANEL (L)	1 PC
4	SIDE PANEL (R)	1 PC
5	CENTER PANEL	1 PC
6	SHELF PANEL	1 PC
7	MIDDLE BONE	1 PC
8	BACK PANEL	1 PC
9	DOOR PANEL	1 PC
10	DRAWER FRONT (UP)	1 PC
11	DRAWER FRONT (DOWN)	2 PCS
12	DRAWER SIDE	6 PCS
13	DRAWER BACK	3 PCS
14	DRAWER BOTTOM	3 PCS
15	METAL SIDE	2 PCS
16	METAL SUPPORT	4 PCS

SELF-PREPARED TOOLS: Tools below are NOT included in package.



SCREWDRIVER



HAMMER

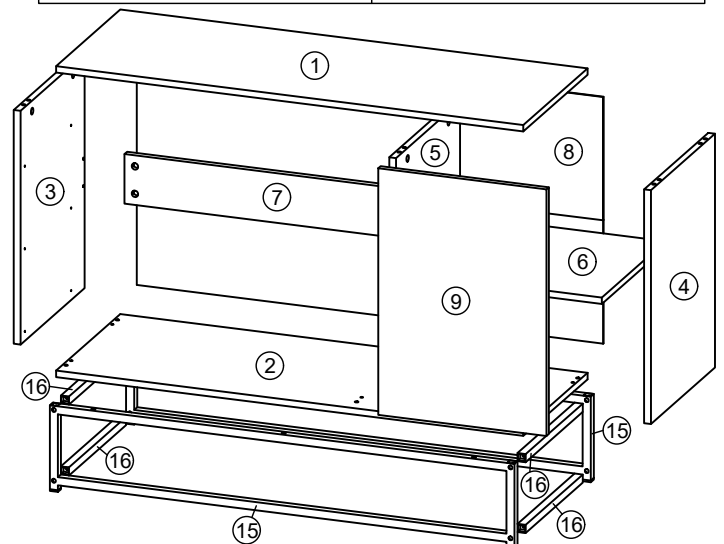
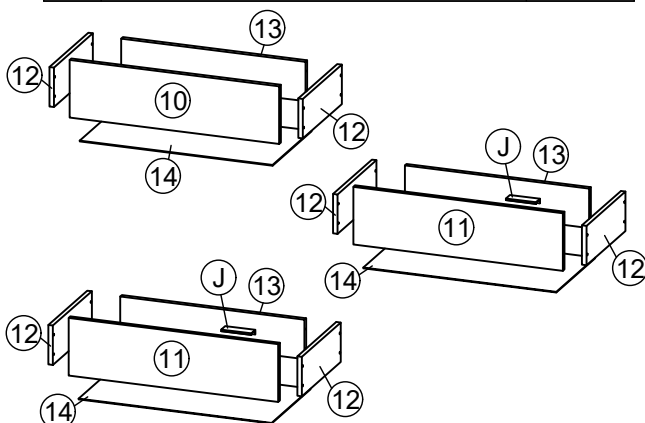

CODING
- 343038

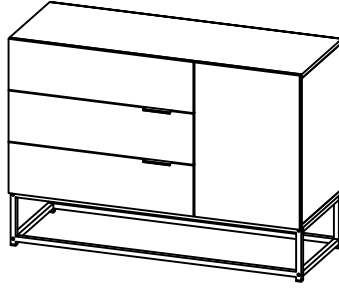

ISO 9001:2015
Reg. No. 00505-1-MF-1-QMS

nuhoom.com

STEP 1

- Insert hardware **A1** onto panel (7).
(Repeat 4 times.)
- Insert hardware **A2** onto panel (1).
(Repeat 6 times.)

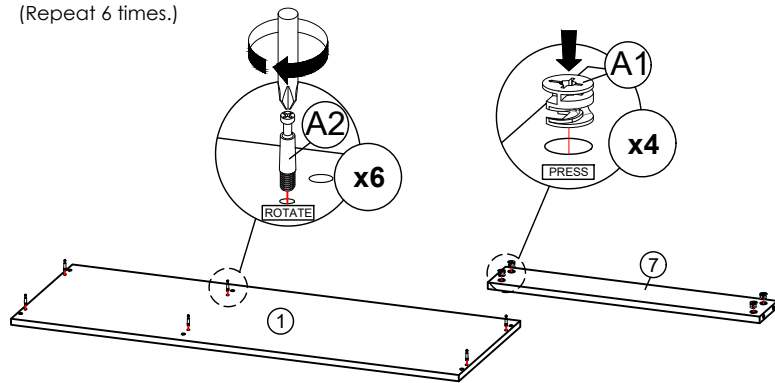

* Ensure the arrows on hardware **A1** point towards mounting positions.

STEP 3

- Fix hardware **N1 (L/R)** into panel (3) and (5) with hardware **E**.
(Repeat 3 times for each hardware.)

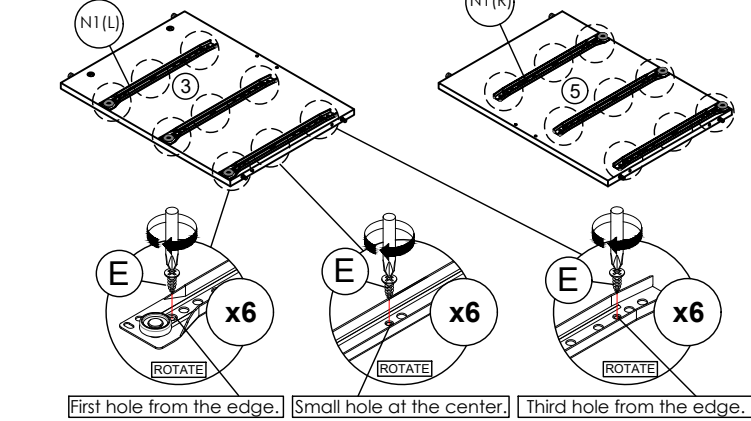
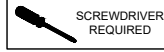

STEP 5

- Connect panel (2) to panel (3), (4) and (5) by using hardware **C** and **D**.
(Repeat 6 times.)

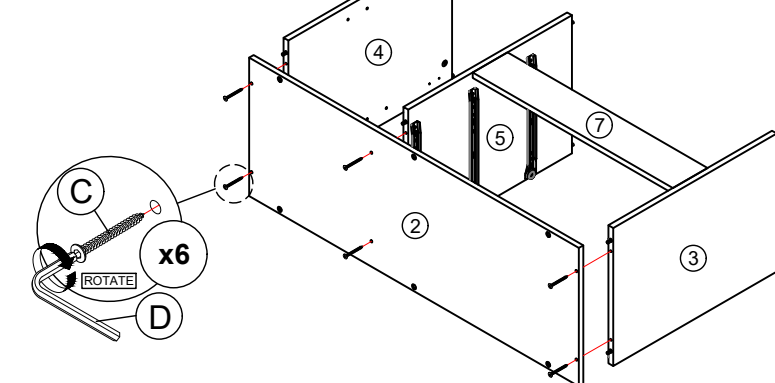

* In this step hardware **B** are pre-inserted.

STEP 2

- Insert hardware **A1** onto panel (3), (4) and (5).
(Repeat 6 times.)
- Insert hardware **A2** onto panel (3) and (5).
(Repeat 4 times.)
- Insert hardware **B** onto panel (3), (4) and (5).
(Repeat 12 times.)

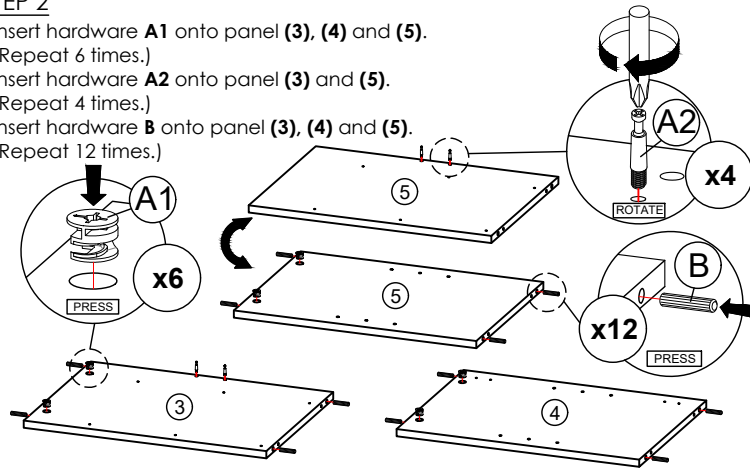

* Ensure the arrows on hardware **A1** point towards mounting positions.

STEP 4

- Attach panel (3) and (5) to panel (7).
- Insert all hardware **A2** into **A1**.
- Rotate all **A1** until tight.
- Apply **A3** onto all **A1**.
(Repeat 4 times.)

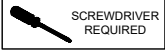

OR

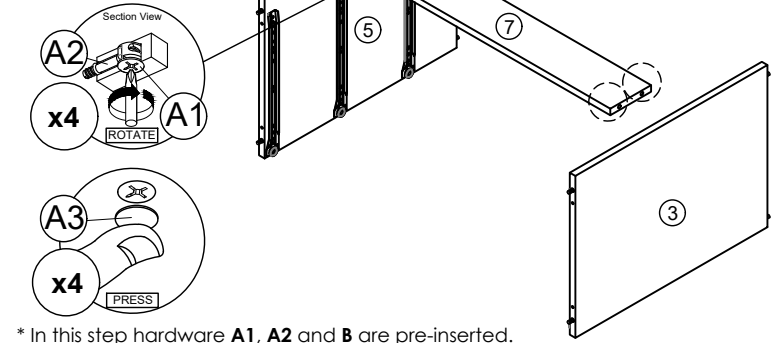

* In this step hardware **A1**, **A2** and **B** are pre-inserted.

STEP 6

- Attach panel (1) to panel (3), (4) and (5).
- Insert all hardware **A2** into **A1**.
- Rotate all **A1** until tight.
- Apply **A3** onto all **A1**.
(Repeat 6 times.)



OR

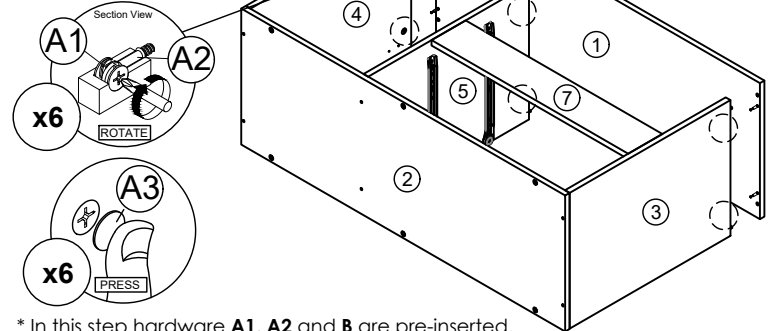
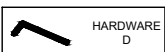

* In this step hardware **A1**, **A2** and **B** are pre-inserted.

CODING
- 343038

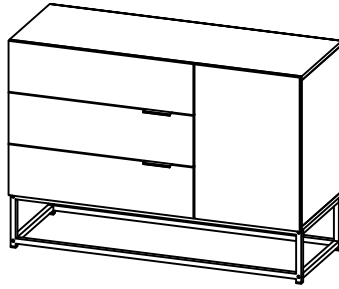

ISO 9001:2015
Reg. No. 00505-1-INT-1-QMS

nuhoom.com

STEP 7

Assemble panel (8) to entire body with hardware H.
(Repeat 30 times.)

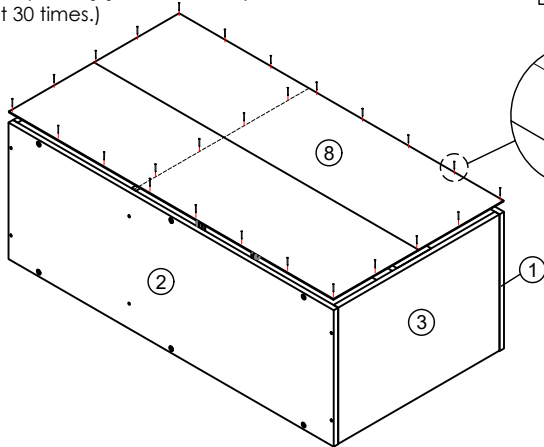
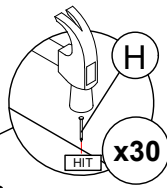

STEP 8

Connect Metal Side (15) to Metal Support (16)
by using hardware D and L.
(Repeat 8 times.)

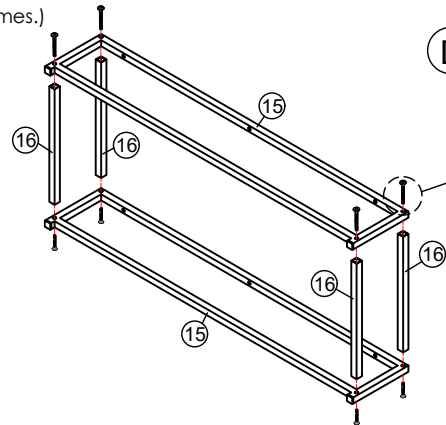
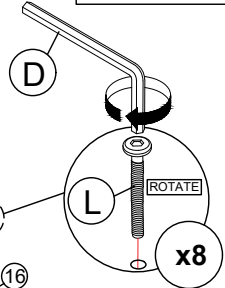

STEP 9

Connect Metal Frame (15) to panel (2)
by using hardware D and K.
(Repeat 6 times.)

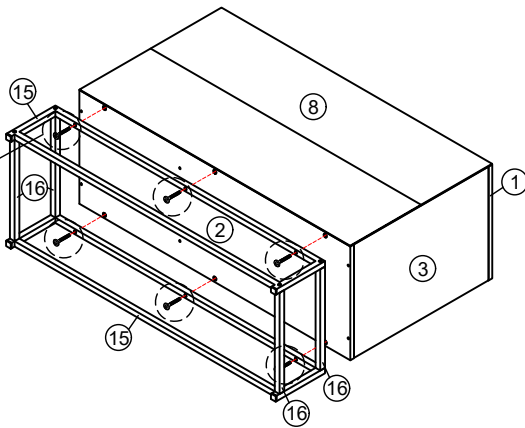
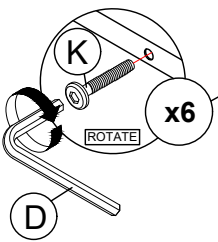

STEP 10

Insert hardware I into mounting positions on panel (4) and (5)
by hand.
(Repeat 4 times.)

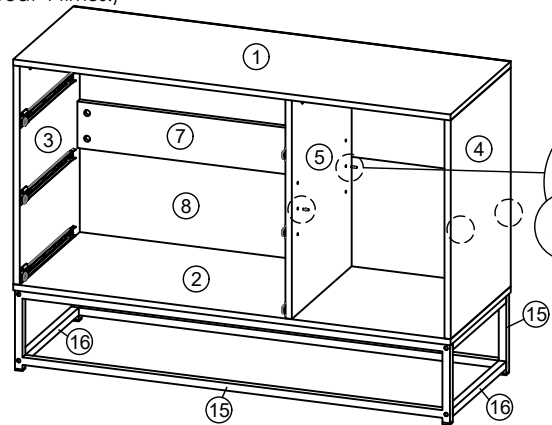
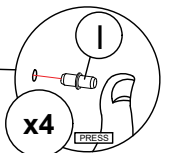

STEP 11

Assemble panel (6) into between panel (4) and (5).
(Repeat 1 times.)

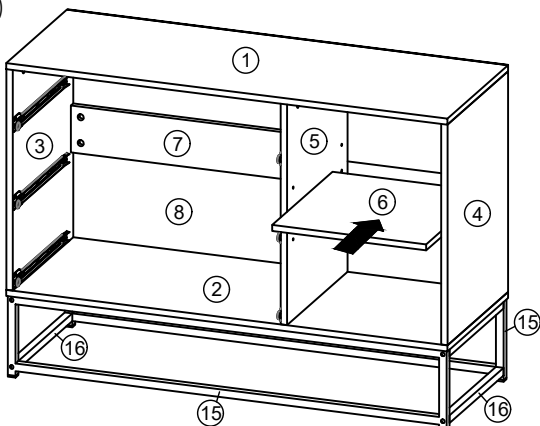

STEP 12

Fix hardware M onto panel (9) by using hardware E.
(Repeat 2 times for each hardware.)

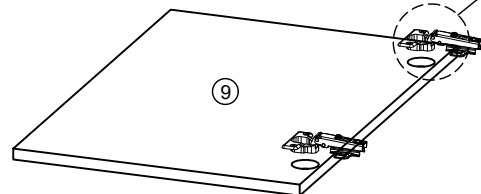
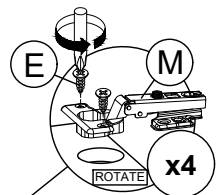

* In this step hardware I are pre-inserted.

CODING
- 343038

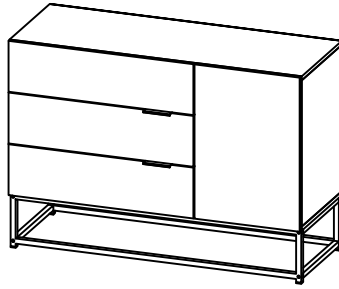

ISO 9001:2015
Reg. No. 009-05-1-MF-1-QMS

nuhoom.com

STEP 13

- Fix hardware **M** into panel **(4)** by using hardware **E**.
(Repeat 2 times for each hardware.)
- Tighten or loosen the screw to adjust position of panel **(9)**.
(Do only when needed.)



STEP 14

- Fix hardware **J** onto panel **(11)** by using hardware **F**.
(Repeat 4 times.)

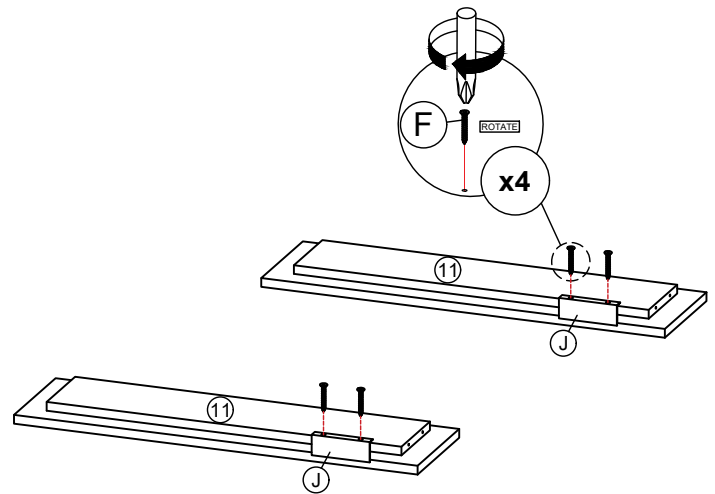
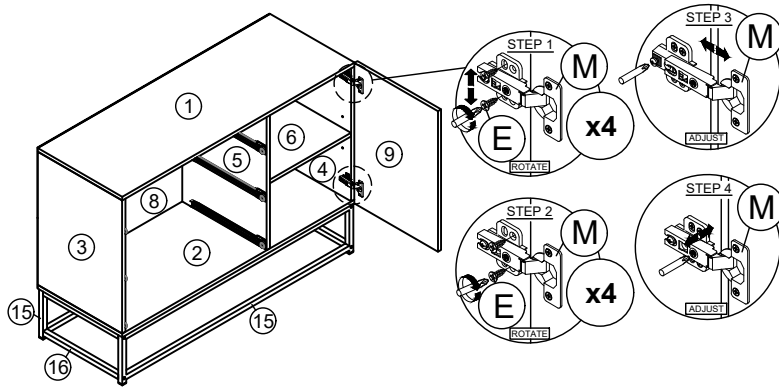

* In this step hardware **M** have been assembled in panel **(9)**.

STEP 15

- Assemble panel **(12)** to panel **(10)** or **(11)** and **(13)** by using hardware **G**.
(Repeat 12 times.)



STEP 16

- Assemble panel **(12)** to panel **(10)** or **(11)** and **(13)** by using hardware **G**.
(Repeat 12 times.)

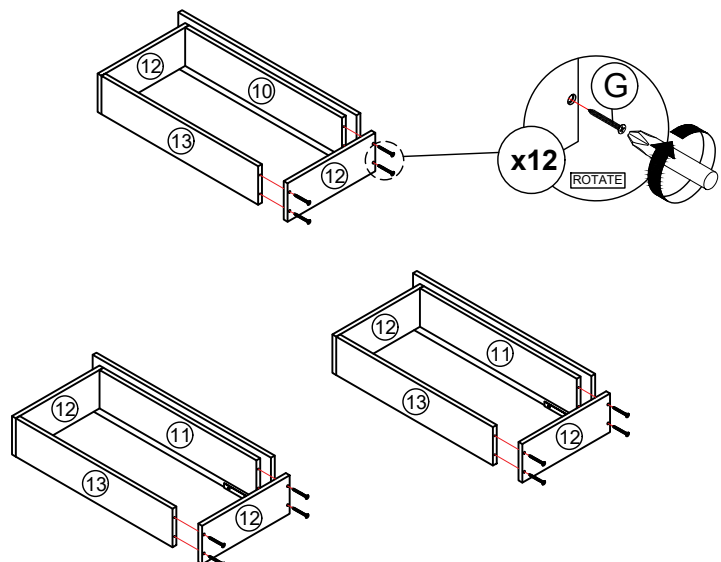
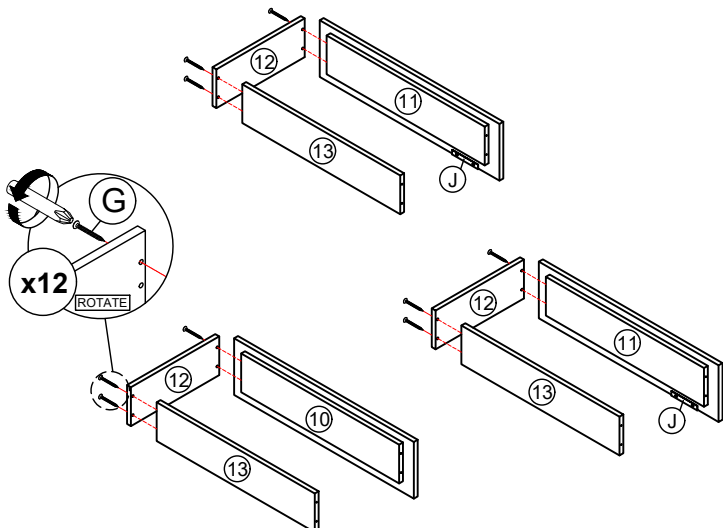

CODING
- 343038

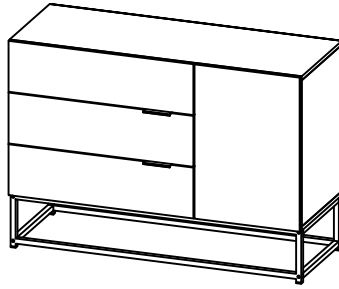

ISO 9001:2015
Reg. No. 029-05-1-MF-1-QMS

nuhoom.com

STEP 17

Assemble panel (14) to entire body with hardware H.
(Repeat 30 times.)



STEP 18

Assemble hardware N2 (L/R) to panel (14) by using hardware E.
(Repeat 3 times for each hardware.)

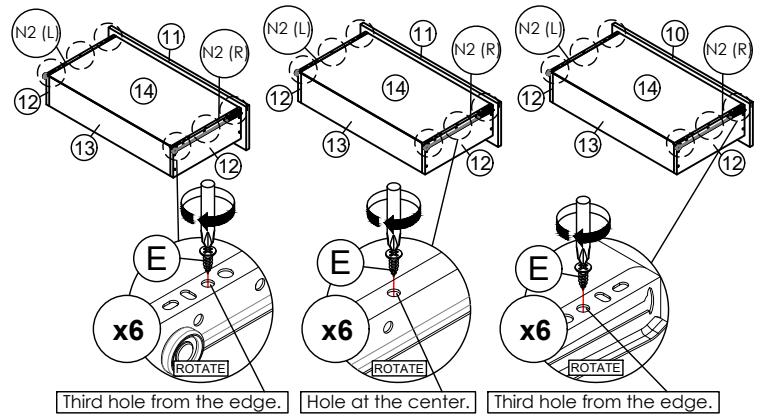
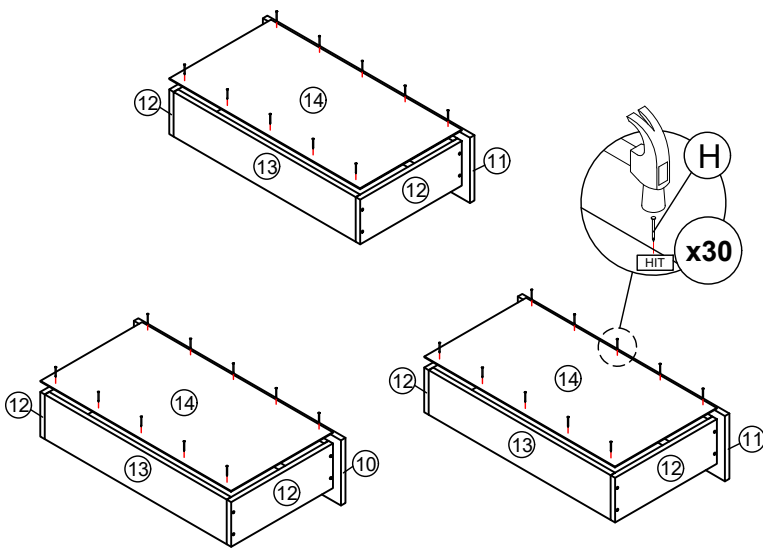

*Hardware N2 (L/R) shall be leaning against panel (10) or (11) when assembling.

STEP 19

Put all the drawer in place along the drawer slides.

