

**CODING**  
- 336066

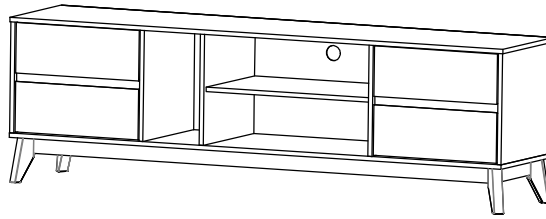

ISO 9001:2015  
Reg. No. 07035-1-MY-1-QMS

nuhoom.com

Read the instructions carefully. Remove all the wrappings, staples and straps from the carton. Refer to the hardware and furniture part list for guidance. Make sure that you have all the parts before you start assembling. Place all the wooden furniture parts on a clean, flat and soft surface, such as a carpet or rubbermat to prevent scratches.

CAUTION  
KEEP ALL THE PARTS OUT OF CHILDREN'S REACH.

PART LIST		QTY
1	TOP PANEL	1 PC
2	BOTTOM PANEL	1 PC
3	SIDE PANEL (L)	1 PC
4	SIDE PANEL (R)	1 PC
5	CENTER PANEL (L)	1 PC
6	CENTER PANEL (R)	1 PC
7	CENTER PANEL	1 PC
8	BONE PANEL	2 PCS
9	SHELF PANEL	1 PC
10	BACK PANEL	1 PC
11	DRAWER FRONT (UP)	2 PCS
12	DRAWER FRONT (DOWN)	2 PCS
13	DRAWER SIDE	8 PCS
14	DRAWER BACK	4 PCS
15	DRAWER BOTTOM	4 PCS
16	LEG	4 PCS

HARDWARE			
A	MINI FIX	A1  A2  A3	10 PCS
B	M8 X 30MM WOOD DOWEL		28 PCS
C	M6 X 50MM CSK CAP WOOD SCREW		10 PCS
D	5/8 NAIL		67 PCS
E	ALLEN KEY M4		1 PC
F	ONE HOLE L BRACKET (2MM)		4 PCS
G	M3.5 X 16MM C.B SCREW		56 PCS
H	M4 X 38MM C.B SCREW		32 PCS
I	METAL SHELF SUPPORT		4 PCS
J	14" DRAWER SLIDE	J1 (L/R)  J2 (L/R)	4 SETS
K	JCBC Screw M6 x 70		8 PCS
L	SPRING WASHER M6		8 PCS
M	FLAT WASHER M6		8 PCS
N	TIPPING PACK	N1  N2  N3  N4  N5	2 SETS

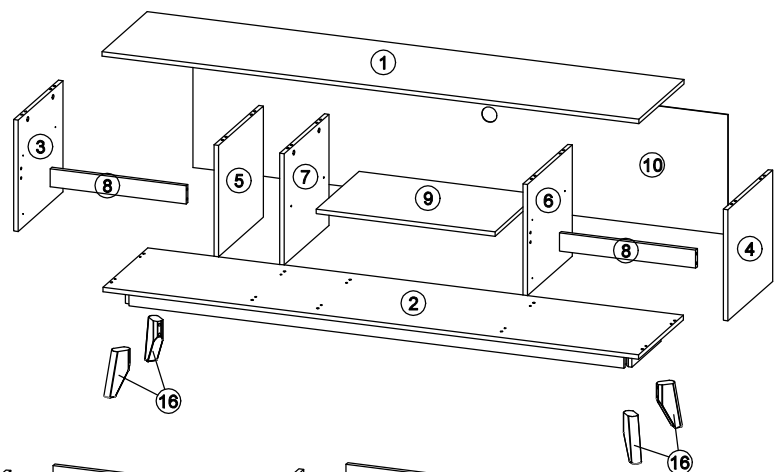

SELF-PREPARED TOOLS: Tools below are NOT included in package.	
	SCREWDRIVER
	HAMMER

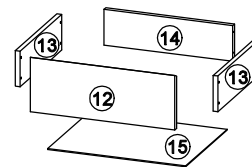
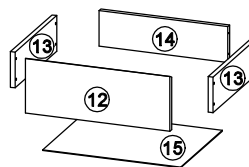
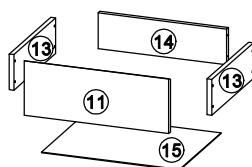
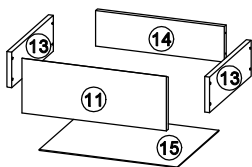

**CODING**  
- 336066

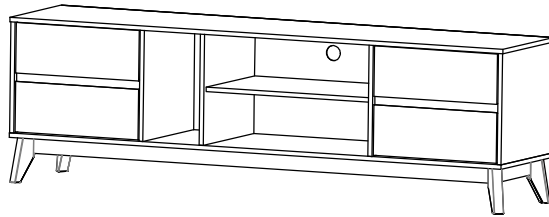

ISO 9001:2015  
Reg. No. 000436-1-MY-1-QMS

nuhoom.com

**STEP 1**

- Insert hardware **A2** onto panel **(1)**.  
(Repeat 10 times.)
- Assemble hardware **F** to panel **(8)** with hardware **G**.  
(Repeat 2 times on each panel.)
- Insert hardware **B** onto panel **(8)**.  
(Repeat 4 times on each panel.)

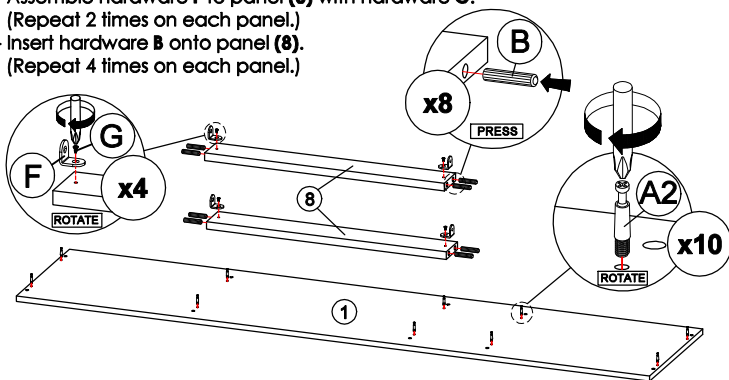

**STEP 2**

- Insert hardware **A1** onto panel **(3), (4), (5), (6)** and **(7)**.  
(Repeat 2 times on each panel.)
- Insert hardware **B** onto panel **(3), (4), (5), (6)** and **(7)**.  
(Repeat 4 times on each panel.)

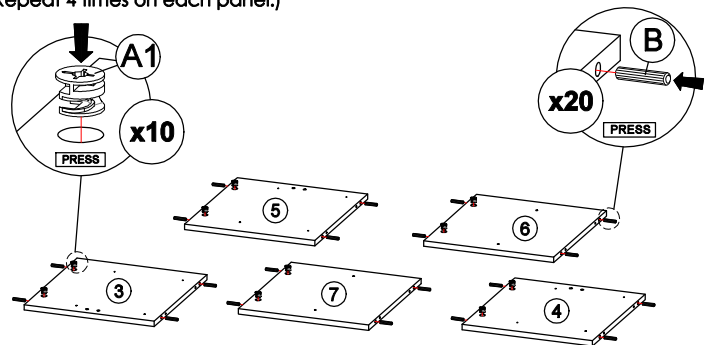

\* Ensure the arrows on hardware **A1** point towards mounting positions.

**STEP 3**

- Fix hardware **J1 (L)** into panel **(3)** and **(6)** with hardware **G**.  
(Repeat 3 times for each hardware.)

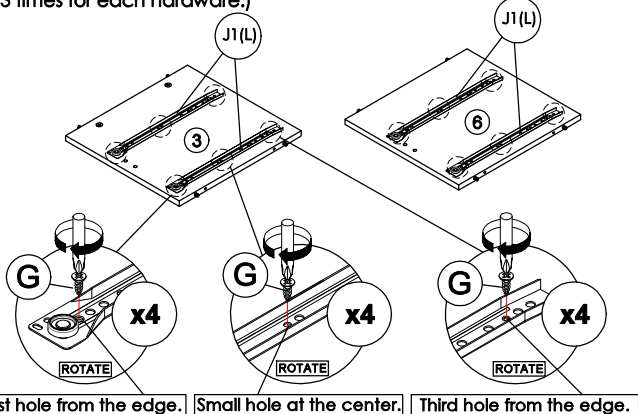

**STEP 4**

- Fix hardware **J1 (R)** into panel **(4)** and **(5)** with hardware **G**.  
(Repeat 3 times for each hardware.)

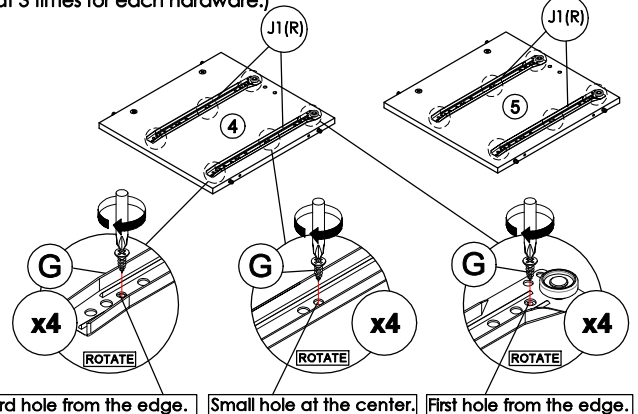

**STEP 5**

- Attach panel **(8)** to panel **(3)** and **(5)**.  
(Repeat 1 times.)
- Attach panel **(8)** to panel **(4)** and **(6)**.  
(Repeat 1 times.)

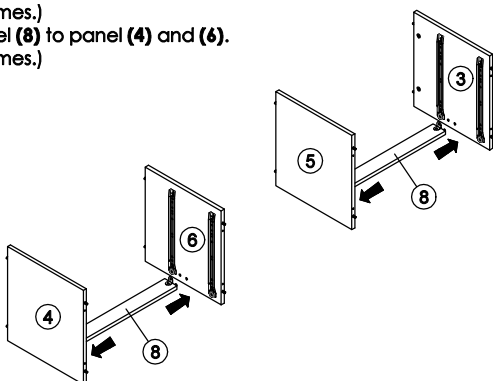

\* In this step hardware **B** are pre-inserted.

**STEP 6**

- Attach panel **(3), (4), (5), (6)** and **(7)** to panel **(1)**.
- Insert all hardware **A2** into **A1**.
- Rotate all **A1** until tight.
- Apply **A3** onto all **A1**.  
(Repeat 10 times.)



OR

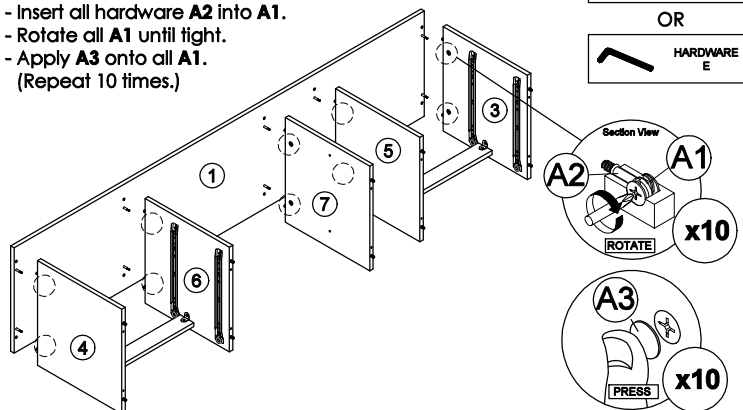

\* In this step hardware **A1, A2** and **B** are pre-inserted.

**CODING**  
- 336066

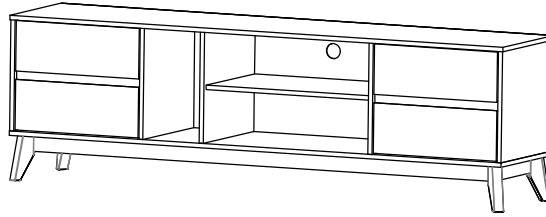

ISO 9001:2015  
Reg. No. 070435-1-MY-1-QMS

nuhoom.com

**STEP 7**

- Assemble hardware F on panel (8) to panel (3) and (5) by using hardware G.
- Assemble hardware F on panel (8) to panel (4) and (6) by using hardware G.
- (Repeat 1 times on each side panel.)

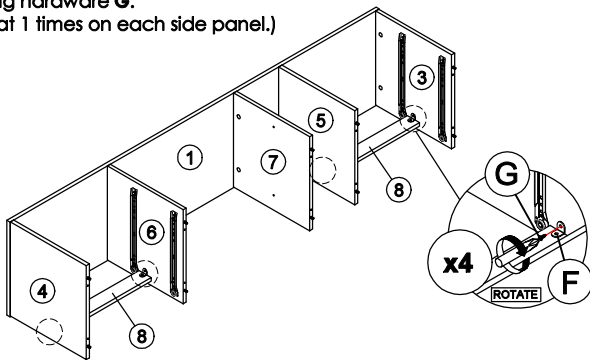

**STEP 8**

- Connect panel (2) to panel (3), (4), (5), (6) and (7) by using hardware C and E.
- (Repeat 10 times.)

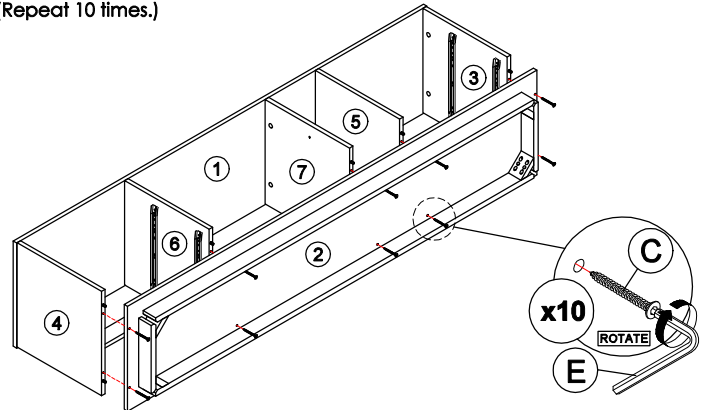

\* In this step hardware B are pre-inserted.

**STEP 9**

- Assemble part 16 into panel (2) by using hardware E, K, L and M.
- (Repeat 2 times for each Leg.)

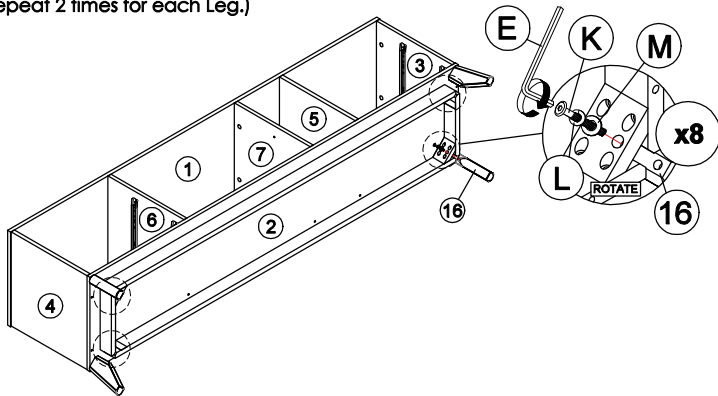

**STEP 10**

- Assemble panel (10) to entire body with hardware D.
- (Repeat 35 times.)

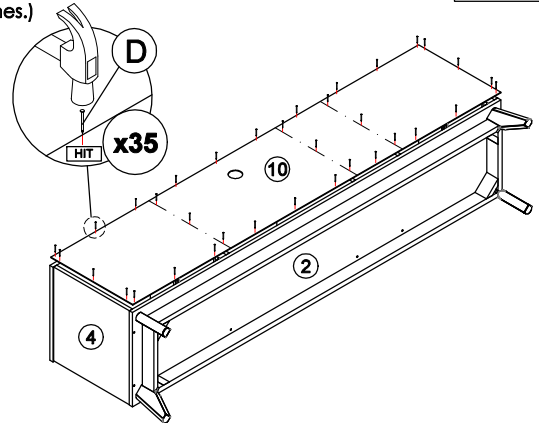

**STEP 11**

- Insert hardware I into mounting positions on panel (6) and (7) by hand.
- (Repeat 4 times.)

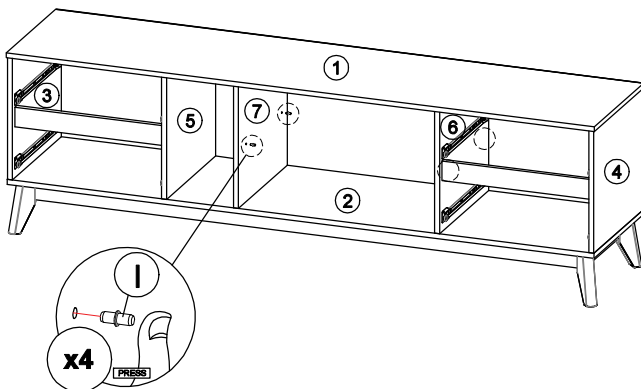

**STEP 12**

- Assemble the panel (9) into between panel (6) and (7).
- (Repeat 1 times.)

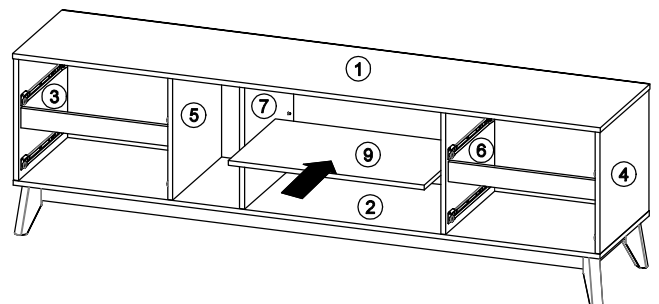

\* In this step hardware I are pre-inserted.

**CODING**  
- 336066

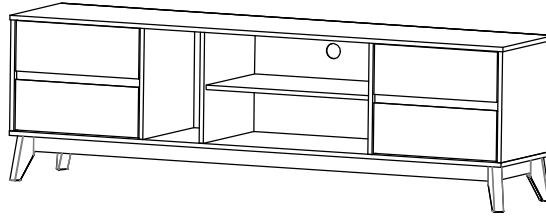

ISO 9001:2015  
Reg. No. 000435-1-MY-1-QMS

nuhoom.com

**STEP 13**

Assemble panel (13) with panel (11) or (12) and (14) by using hardware H.  
(Repeat 8 times for each drawer.)  
\* In this step only show one of the drawers.

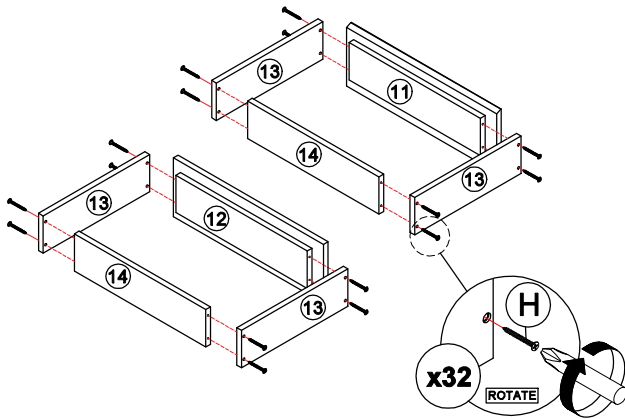

**STEP 14**

Assemble panel (15) to entire body with hardware D.  
(Repeat 8 times for each drawer.)  
\* In this step only show one of the drawers.

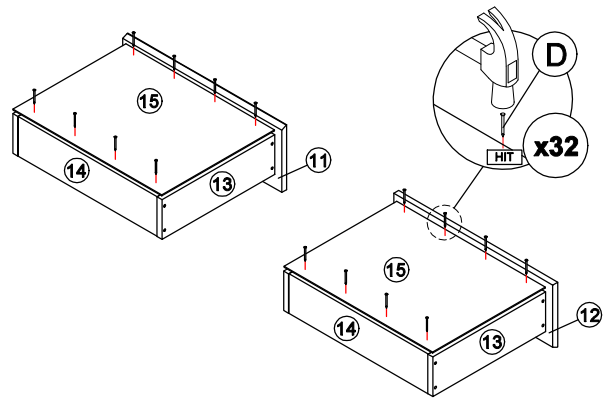

**STEP 15**

Assemble hardware J2 (L/R) to panel (15) by using hardware G.  
(Repeat 3 times for each hardware.)  
\* In this step only show one of the drawers.

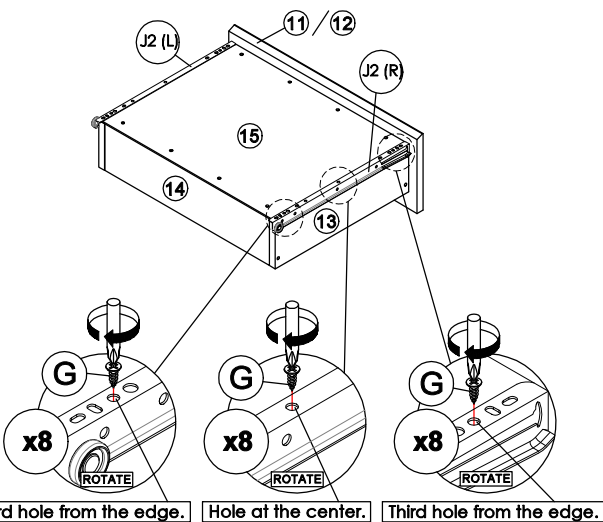

**STEP 16**

Put all the drawer in place along the drawer slides.

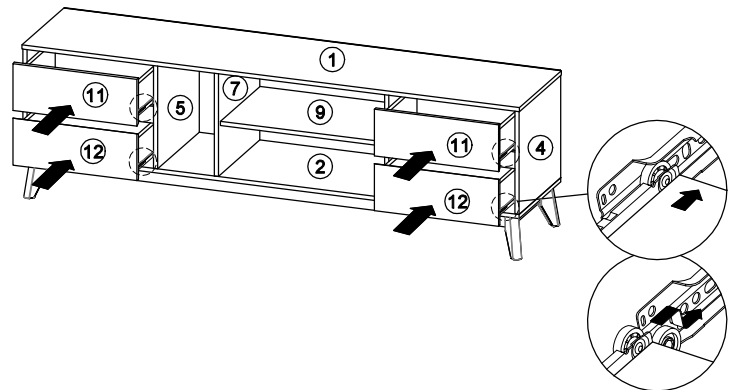

\*Hardware J2 (L/R) shall be leaning against panel (11) or (12) when assembling.

**CODING**  
- 336066

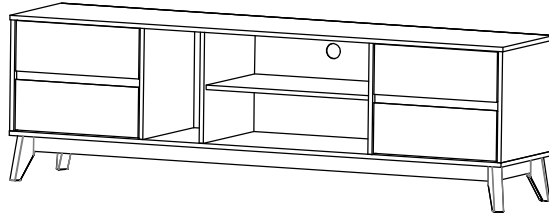

ISO 9001:2015  
Reg. No. 000435-1-MY-1-QMS

nuhoom.com

**STEP 17**

Assemble hardware **N1** into panel **(1)** and **(10)** by using hardware **N2**.  
(Repeat **2** times.)

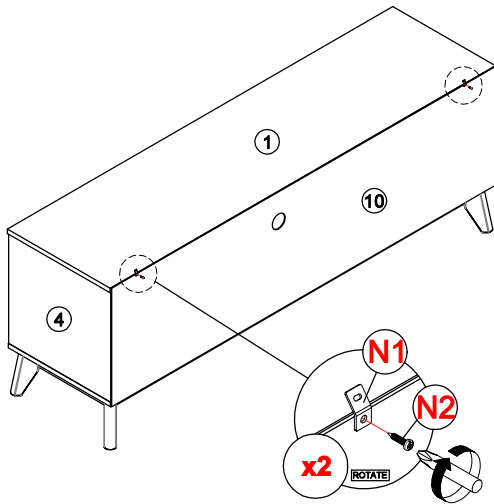

**STEP 18**

- Mark and use the power drill to drill a hole on the wall.  
- Hit hardware **N3** into the wall.  
(Repeat **2** times.)

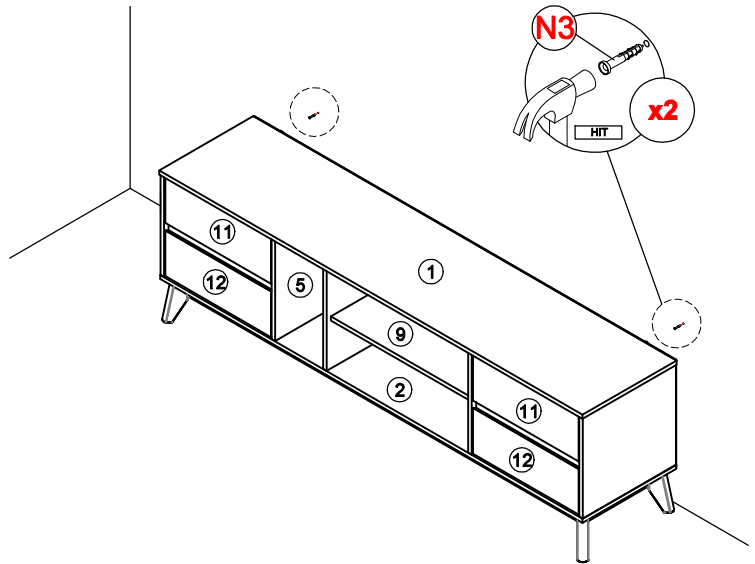

**STEP 19**

Assemble hardware **N1** to **N3** by using hardware **N4**.  
(Repeat **2** times.)

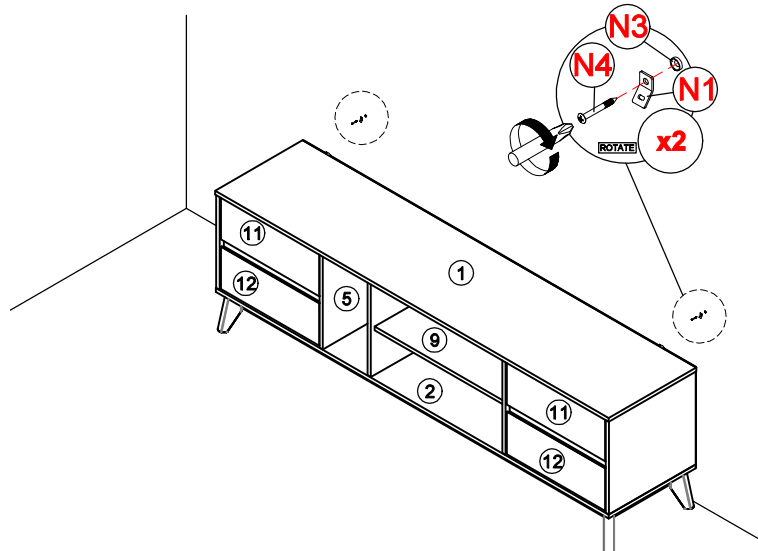

**STEP 20**

- Connect both of the hardware **N1** by using hardware **N5**.  
- Tighten the hardware **N5**.  
(Repeat **2** times.)

