

CODING
- 336049

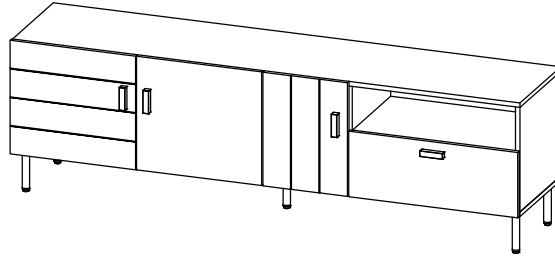

ISO 9001:2015
Reg. No. 00005-1-2017-1-QMS

nuhoom.com

Read the instructions carefully. Remove all the wrappings, staples and straps from the carton. Refer to the hardware and furniture part list for guidance. Make sure that you have all the parts before you start assembling. Place all the wooden furniture parts on a clean, flat and soft surface, such as a carpet or rubbermat to prevent scratches.

CAUTION
KEEP ALL THE PARTS OUT OF CHILDREN'S REACH.

PART LIST		QTY
1	TOP PANEL	1 PC
2	BOTTOM PANEL	1 PC
3	SIDE PANEL (L)	1 PC
4	SIDE PANEL (R)	1 PC
5	CENTER PANEL (L)	1 PC
6	CENTER PANEL (R)	1 PC
7	CENTER PANEL	1 PC
8	MIDDLE PANEL	1 PC
9	BACK SUPPORT	1 PC
10	BACK PANEL	1 PC
11	DOOR PANEL (L)	1 PC
12	DOOR PANEL (R)	1 PC
13	CENTER DOOR	1 PC
14	DRAWER FRONT	1 PC
15	DRAWER BACK	1 PC
16	DRAWER SIDE (L)	1 PC
17	DRAWER SIDE (R)	1 PC
18	DRAWER BONE	1 PC
19	DRAWER BOTTOM	1 PC

HARDWARE			
A	MINI FIX	A1 A2 A3	20 SETS
B	M8 X 30MM WOOD DOWEL		28 PCS
C	M6 X 50MM CSK CAP WOOD SCREW		12 PCS
D	ALLEN KEY M4		1 PC
E	M3.5 X 16MM C.B SCREW		68 PCS
F	M4 X 32MM C.B SCREW		8 PCS
G	M4 X 38MM C.B SCREW		4 PCS
H	WOOD HANDLE (80MM)		4 PCS
I	METAL LEG 50 x 50 x H145MM (CENTER ROUND Ø25)		5 PCS
J	SOFT CLOSING 5/8 HINGES		4 PCS
K	SOFT CLOSING 7/8 HINGES		2 PCS
L	14" DRAWER SLIDE	L1 (L/R) L2 (L/R)	1 SETS

TIPPING PACK WITH A1			2 SETS
----------------------	--	--	---------------

SELF-PREPARED TOOLS: Tools below are NOT included in package.	
SCREWDRIVER	HAMMER

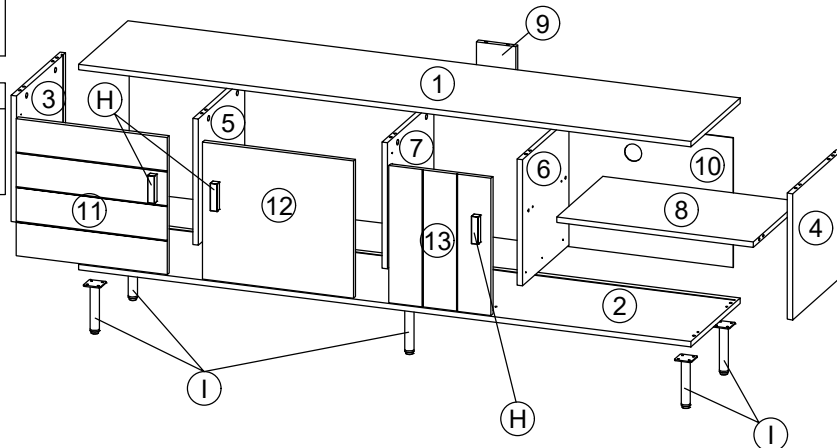
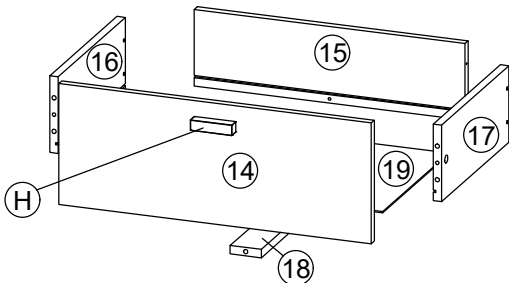

CODING
- 336049

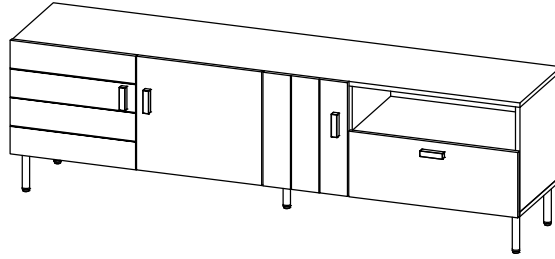

ISO 9001:2015
Reg. No. 00005-1-0001-0005

nuhoom.com

STEP 1

- Insert hardware **A1** onto panel (3), (4), (5) and (6). (Repeat 8 times.)
- Insert hardware **A2** onto panel (1), (4) and (6). (Repeat 16 times.)
- Insert hardware **B** onto panel (3), (4), (5) and (6). (Repeat 16 times.)

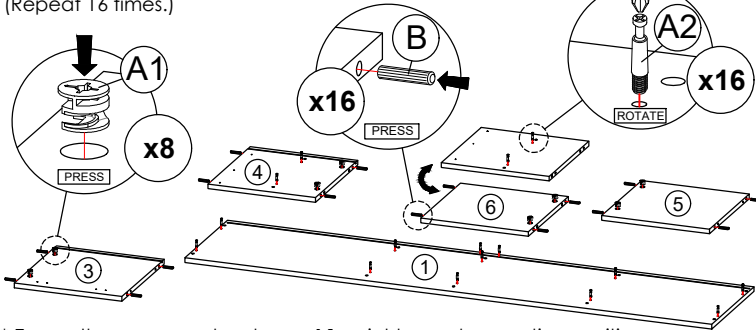

* Ensure the arrows on hardware **A1** point towards mounting positions.

STEP 3

- Fix hardware **L1 (L)** into panel (6) with hardware **E**. (Repeat 3 times for each hardware.)
- Fix hardware **L1 (R)** into panel (4) with hardware **E**. (Repeat 3 times for each hardware.)

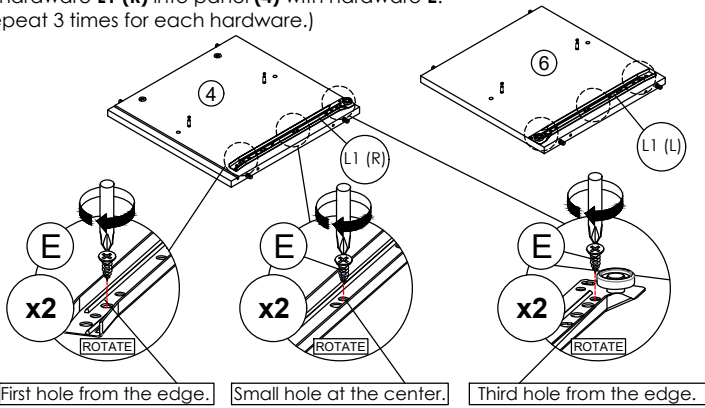
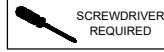

STEP 5

- Attach panel (4) and (6) to panel (1).
- Insert all hardware **A2** into **A1**.
- Rotate all **A1** until tight.
- Apply **A3** onto all **A1**. (Repeat 4 times.)

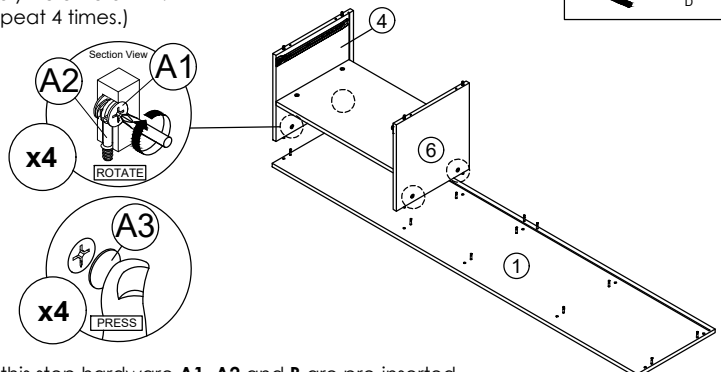
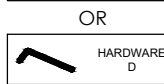

* In this step hardware **A1**, **A2** and **B** are pre-inserted.

STEP 2

- Insert hardware **A1** onto panel (7), (8), (9), (16), (17), and (18). (Repeat 12 times.)
- Insert hardware **A2** onto panel (14) and (15). (Repeat 4 times.)
- Insert hardware **B** onto panel (7), (8), (16) and (17). (Repeat 12 times.)

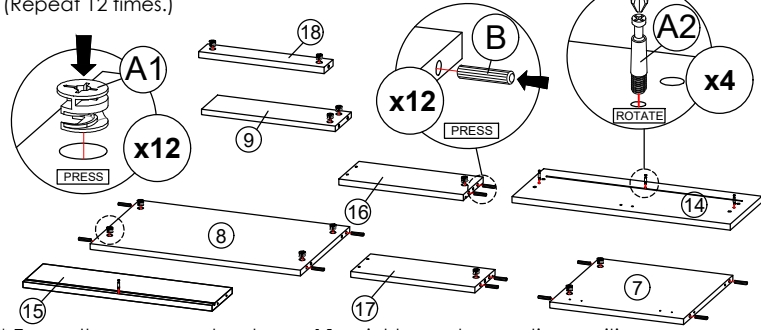

* Ensure the arrows on hardware **A1** point towards mounting positions.

STEP 4

- Attach panel (4) and (6) to panel (8).
- Insert all hardware **A2** into **A1**.
- Rotate all **A1** until tight.
- Apply **A3** onto all **A1**. (Repeat 4 times.)



OR

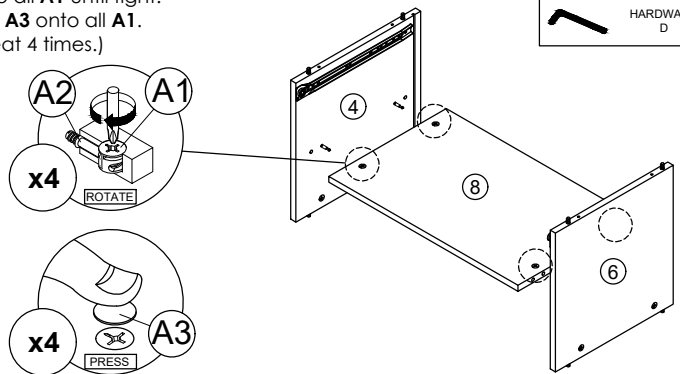

* In this step hardware **A1**, **A2** and **B** are pre-inserted.

STEP 6

- Attach panel (3), (5) and (7) to panel (1).
- Insert all hardware **A2** into **A1**.
- Rotate all **A1** until tight.
- Apply **A3** onto all **A1**. (Repeat 6 times.)



OR

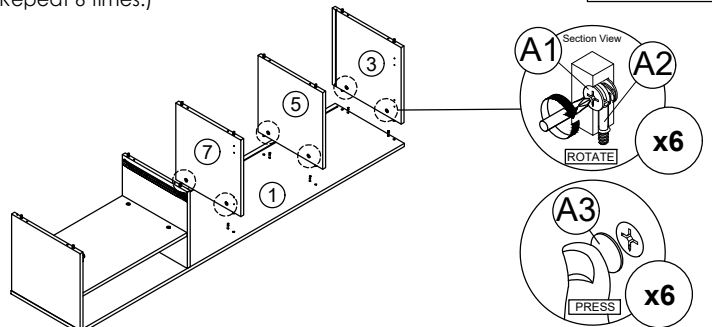

* In this step hardware **A1**, **A2** and **B** are pre-inserted.

CODING
- 336049

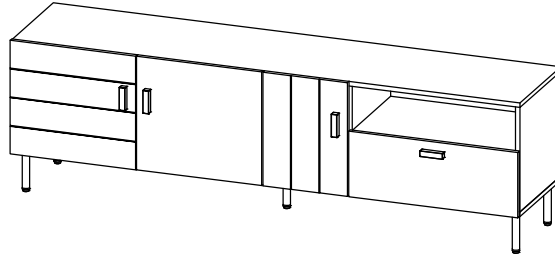

ISO 9001:2015
Reg. No. 00005-1-2017-1-0265

nuhoom.com

STEP 7

Insert the panel (10) along the slot.
(Repeat 1 times.)

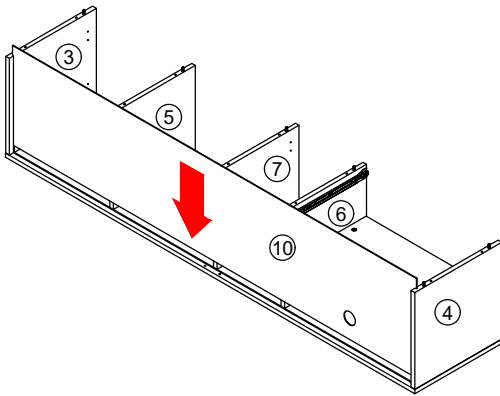

STEP 8

- Attach panel (9) to panel (1).
- Insert all hardware A2 into A1.
- Rotate all A1 until tight.
- Apply A3 onto all A1.
- (Repeat 2 times.)

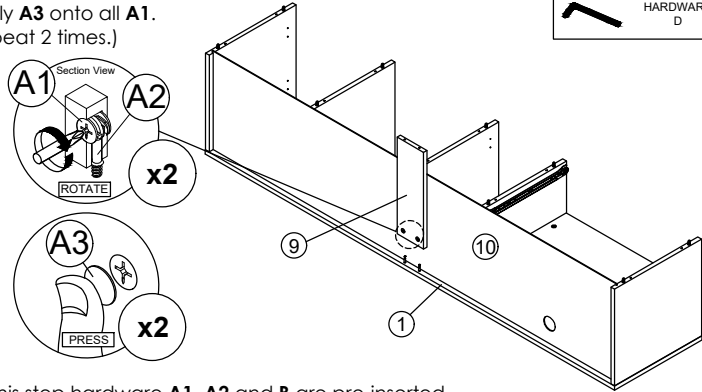
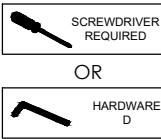

* In this step hardware A1, A2 and B are pre-inserted.

STEP 9

Connect panel (2) to panel (3), (4), (5), (6), (7) and (9)
by using hardware C and D.
(Repeat 12 times.)

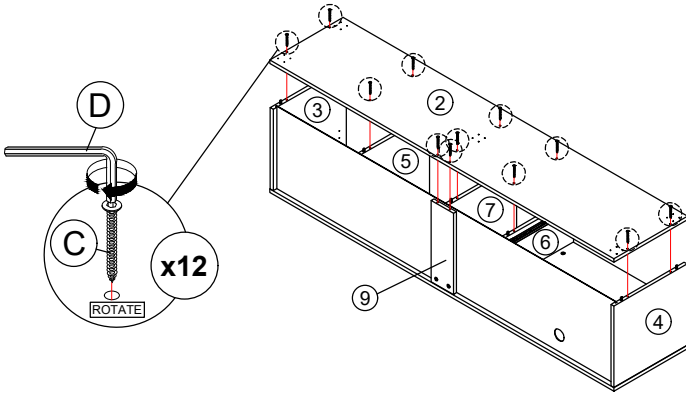

STEP 10

Assemble hardware I onto panel (2) by using hardware E.
(Repeat 4 times for each hardware.)

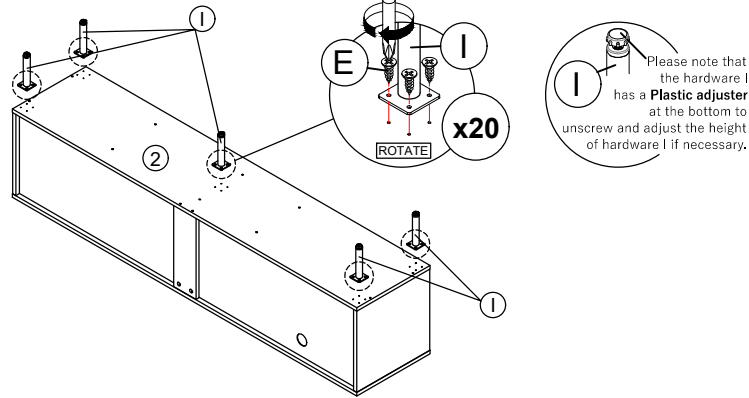

STEP 11

- Fix hardware H onto panel (11) and (13) by using hardware F.
- (Repeat 2 times for each hardware.)
- Fix hardware J onto panel (11) and (13) by using hardware E.
- (Repeat 2 times for each hardware.)

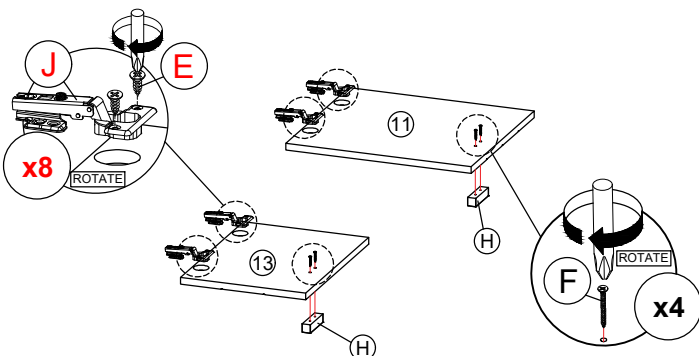

STEP 12

- Fix hardware H onto panel (12) and (14) by using hardware F.
- (Repeat 2 times for each hardware.)
- Fix hardware K onto panel (12) by using hardware E.
- (Repeat 2 times for each hardware.)

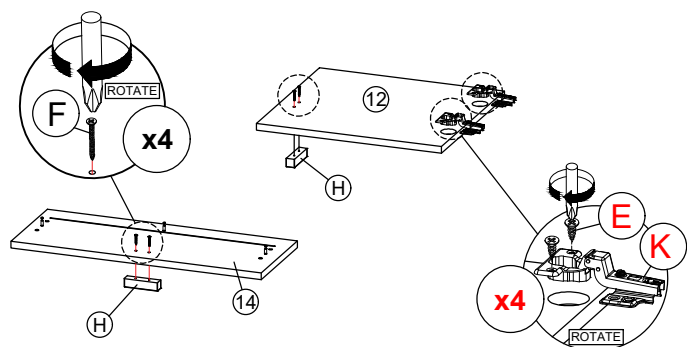

CODING
- 336049

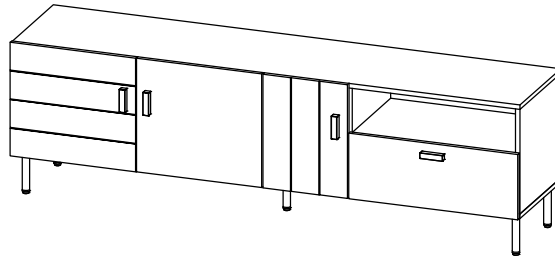

ISO 9001:2015
Reg. No. 000435-1-MFF-1-QMS

nuhoom.com

STEP 13

- Fix hardware **K** into panel **(7)** by using hardware **E**.
(Repeat 4 times for each hardware.)
- Tighten or loosen the screw to adjust position of panel **(12)**.
(Do only when needed.)

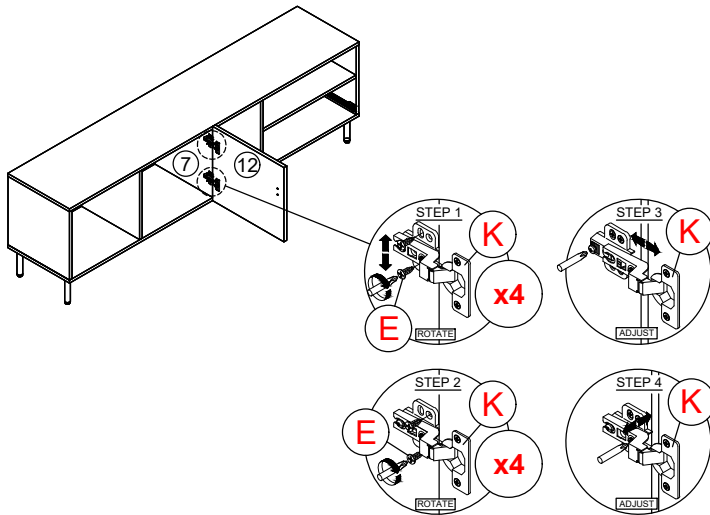

STEP 14

- Fix hardware **J** into panel **(3)** and **(7)** by using hardware **E**.
(Repeat 4 times for each hardware.)
- Tighten or loosen the screw to adjust position of panel **(11)** and **(13)**.
(Do only when needed.)

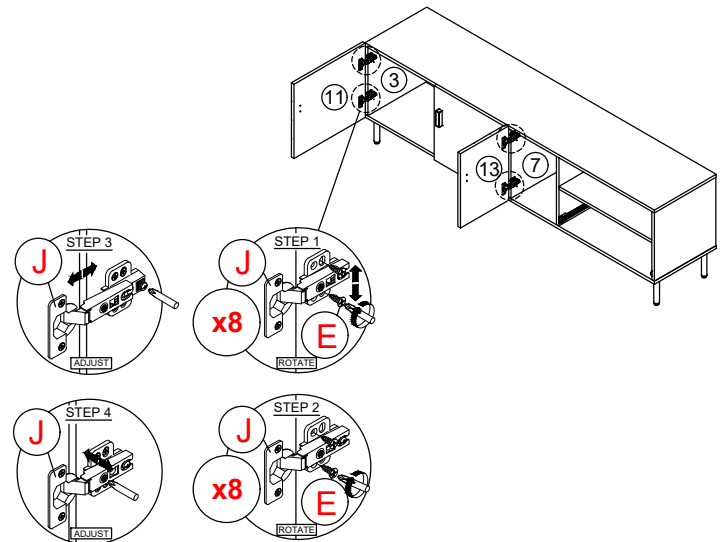

STEP 15

- Assemble panel **(16)** and **(17)** to panel **(15)** by using hardware **G**.
(Repeat 4 times.)

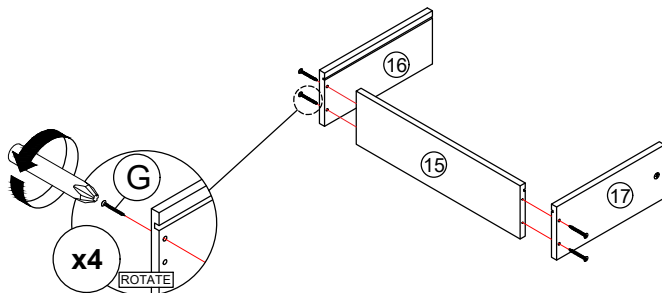

STEP 16

- Insert the panel **(19)** along the slot.
(Repeat 1 times.)

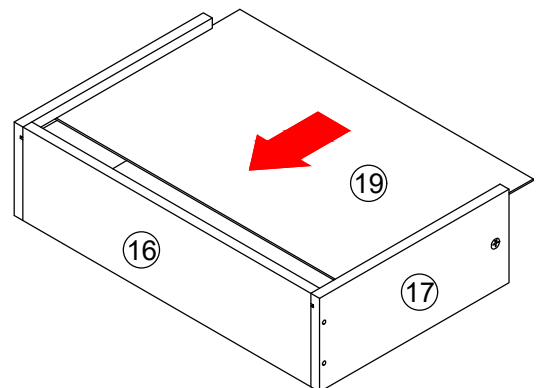

CODING
- 336049

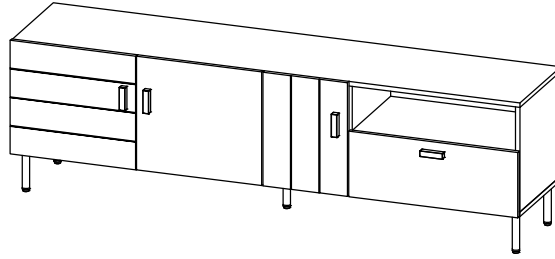

ISO 9001:2015
Reg. No. 000435-1-INT-1-QMS

nuhoom.com

STEP 17

- Attach panel (18) to panel (15).
- Insert all hardware A2 into A1.
- Rotate all A1 until tight.
- Apply A3 onto all A1.
- (Repeat 1 times.)

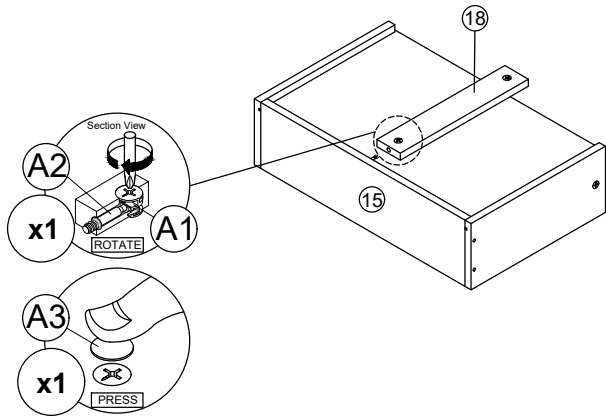
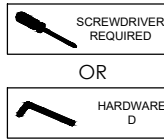

STEP 18

- Attach panel (14) to panel (16), (17) and (18).
- Insert all hardware A2 into A1.
- Rotate all A1 until tight.
- Apply A3 onto all A1.
- (Repeat 3 times.)

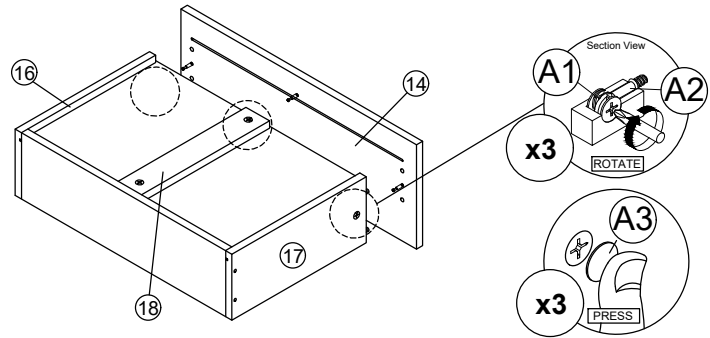
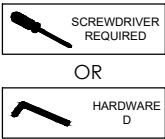

* In this step hardware A1, A2 and B are pre-inserted.

STEP 19

- Assemble hardware L2 (L/R) to panel (16) and (17) by using hardware E.
- (Repeat 3 times for each hardware.)



* In this step hardware A1, A2 and B are pre-inserted.

STEP 20

- Put all the drawer in place along the drawer slides.

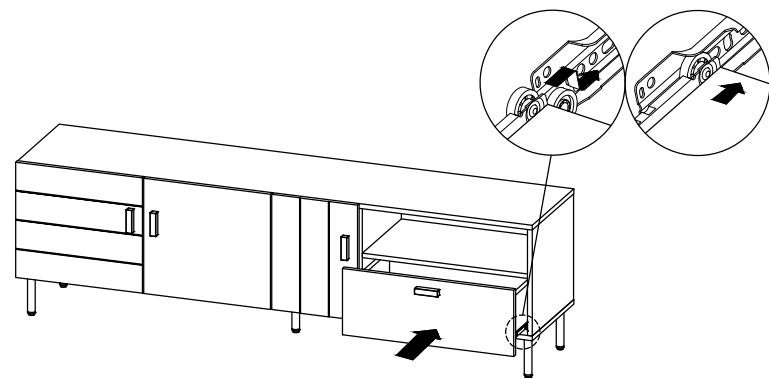
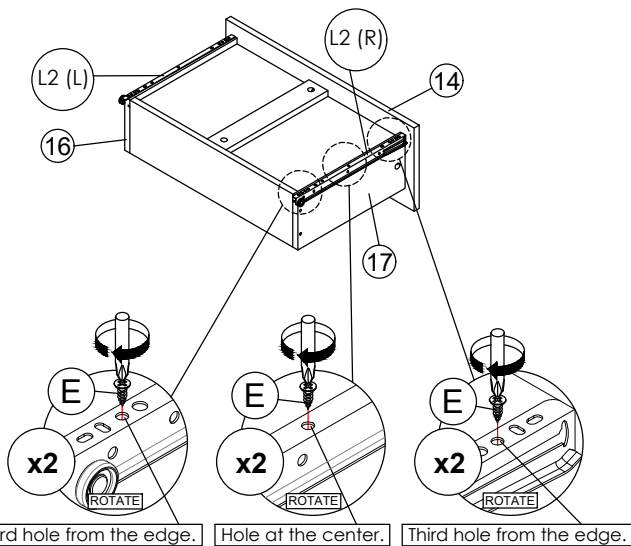

*Hardware L2 (L/R) shall be leaning against panel (14) when assembling.