

**CODING**  
- 336047

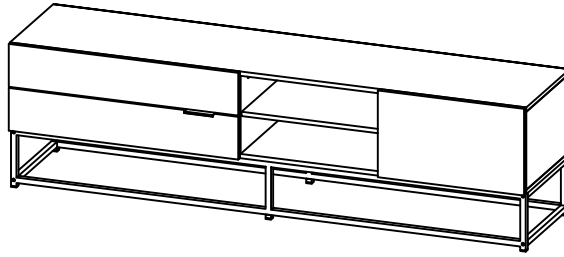

ISO 9001:2015  
Reg. No. 00505-1-INT-1-QMS

nuhoom.com

Read the instructions carefully. Remove all the wrappings, staples and straps from the carton. Refer to the hardware and furniture part list for guidance. Make sure that you have all the parts before you start assembling. Place all the wooden furniture parts on a clean, flat and soft surface, such as a carpet or rubbermat to prevent scratches.

**CAUTION**  
KEEP ALL THE PARTS OUT OF CHILDREN'S REACH.

HARDWARE			
A	MINI FIX	A1  A2  A3	8 SETS
B	M8 X 30MM WOOD DOWEL		16 PCS
C	M6 X 50MM CSK CAP WOOD SCREW		8 PCS
D	ALLEN KEY M4		1 PC
E	M3X 12MM C.B SCREW		2 PCS
F	M3.5 X 16MM C.B SCREW		36 PCS
G	M4 X 38MM C.B SCREW		16 PCS
H	5/8 NAIL		52 PCS
I	JCBC SCREW M6 X 30MM		8 PCS
J	JCBC SCREW M6 X 40MM		8 PCS
K	MODERN HANDLE L100		1 PC
L	METAL SHELF SUPPORT		4 PCS
M	SOFT CLOSING 5/8 HINGES		2 PCS
N	14" DRAWER SLIDE	N1 (L/R)  N2 (L/R)	2 SETS

PART LIST		QTY
1	TOP PANEL	1 PC
2	BOTTOM PANEL	1 PC
3	SIDE PANEL (L)	1 PC
4	SIDE PANEL (R)	1 PC
5	CENTER PANEL (L)	1 PC
6	CENTER PANEL (R)	1 PC
7	SHELF PANEL	1 PC
8	DOOR PANEL	1 PC
9	BACK PANEL	1 PC
10	DRAWER FRONT (UP)	1 PC
11	DRAWER FRONT (DOWN)	1 PC
12	DRAWER BACK	2 PCS
13	DRAWER SIDE	4 PCS
14	DRAWER BOTTOM	2 PCS
15	METAL SIDE	2 PCS
16	METAL SUPPORT	4 PCS

**SELF-PREPARED TOOLS:** Tools below are NOT included in package.



SCREWDRIVER



HAMMER

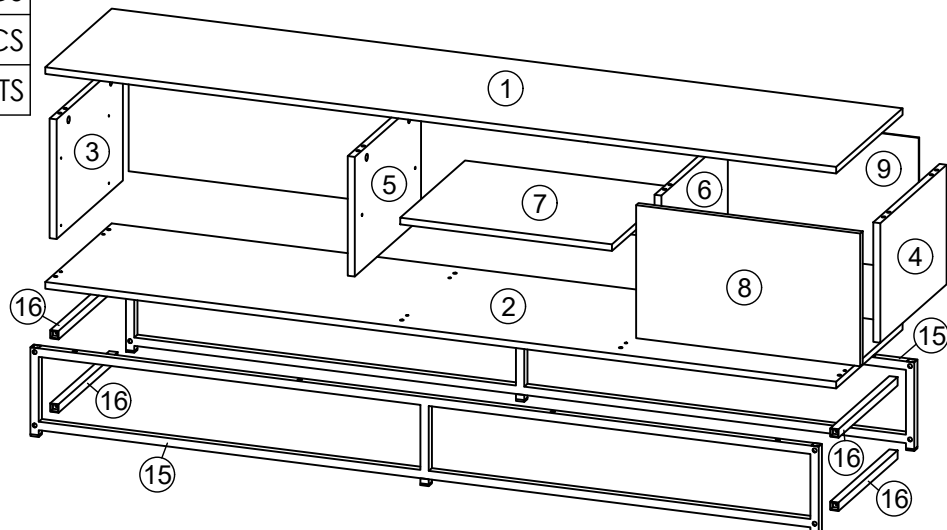
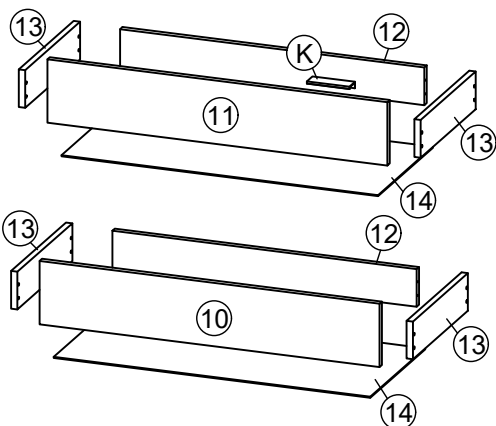

**CODING**  
- 336047

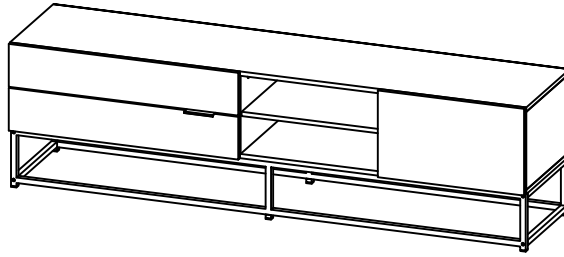

ISO 9001:2015  
Reg. No. 005-1-MF-1-QMS

nuhoom.com

**STEP 1**

- Insert hardware **A1** onto panel (3), (4), (5) and (6). (Repeat 8 times.)
- Insert hardware **A2** onto panel (1). (Repeat 8 times.)
- Insert hardware **B** onto panel (3), (4), (5) and (6). (Repeat 16 times.)

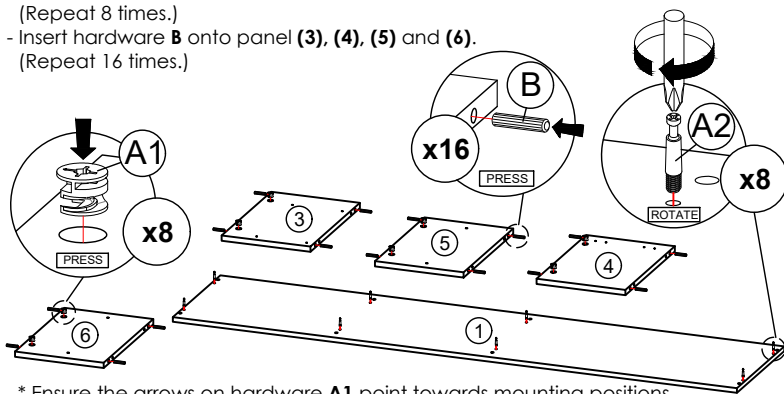

\* Ensure the arrows on hardware **A1** point towards mounting positions.

**STEP 2**

- Fix hardware **N1 (L/R)** into panel (3) and (5) with hardware **F**. (Repeat 3 times for each hardware.)

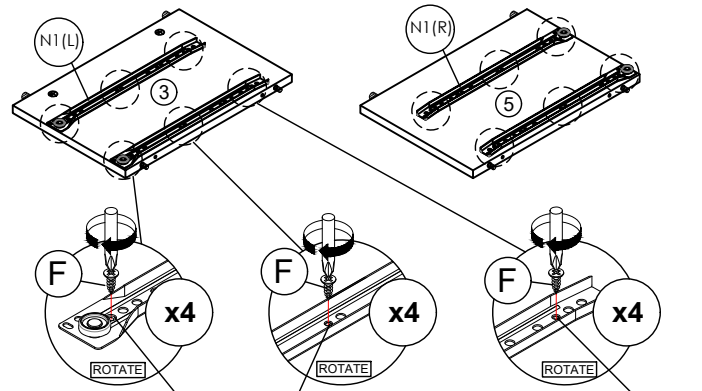

**STEP 3**

- Attach panel (1) to panel (3), (4), (5) and (6).
- Insert all hardware **A2** into **A1**.
- Rotate all **A1** until tight.
- Apply **A3** onto all **A1**. (Repeat 8 times.)

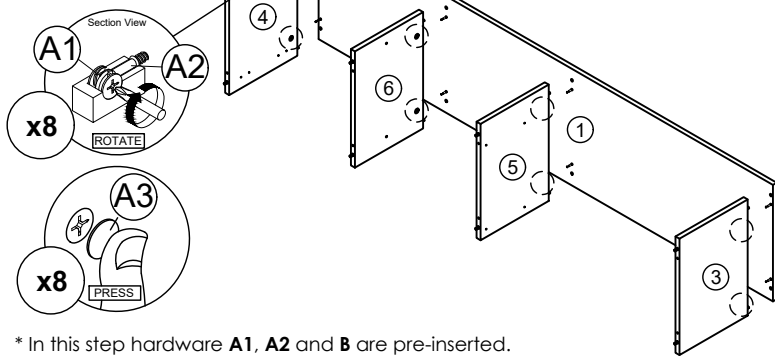

\* In this step hardware **A1**, **A2** and **B** are pre-inserted.

**STEP 4**

- Connect panel (2) to panel (3), (4), (5) and (6) by using hardware **C** and **D**. (Repeat 8 times.)

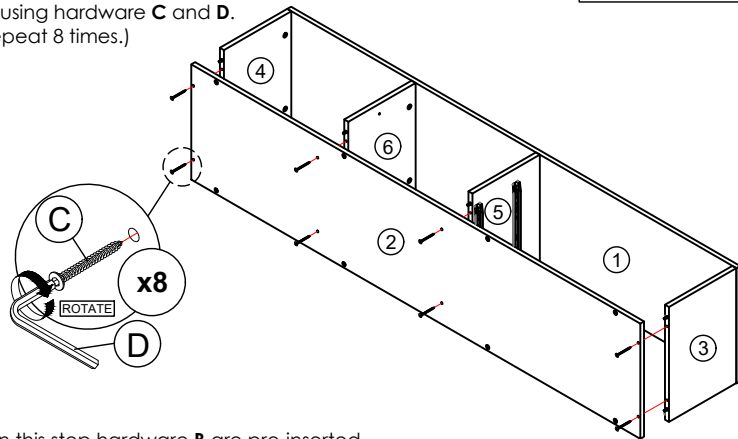
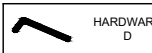

\* In this step hardware **B** are pre-inserted.

**STEP 5**

- Assemble panel (9) to entire body with hardware **H**. (Repeat 28 times.)

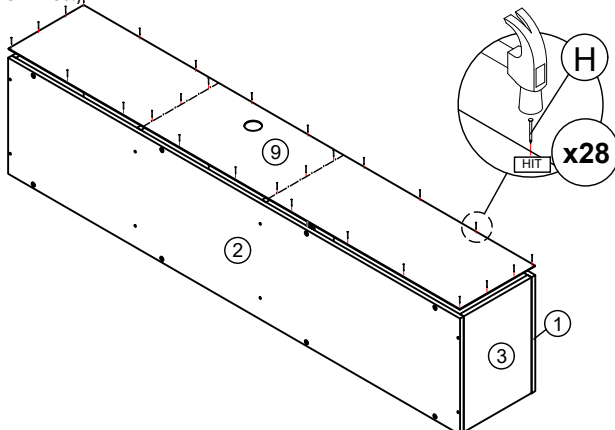
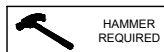

**STEP 6**

- Connect Metal Side (15) to Metal Support (16) by using hardware **D** and **J**. (Repeat 8 times.)

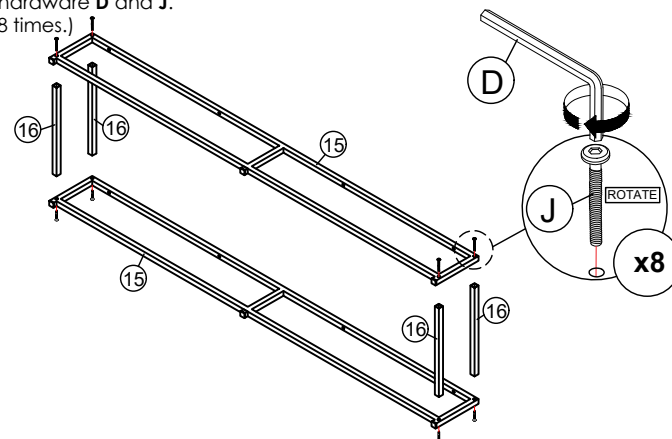
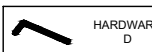

**CODING**  
- 336047

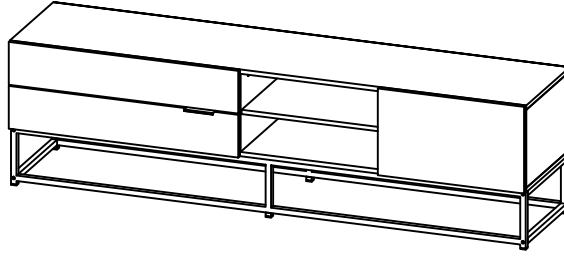

ISO 9001:2015  
Reg. No. 00905-1-MIT-1-QMS

nuhoom.com

**STEP 7**

Connect Metal Side (15) to panel (2) by using hardware D and I. (Repeat 8 times.)

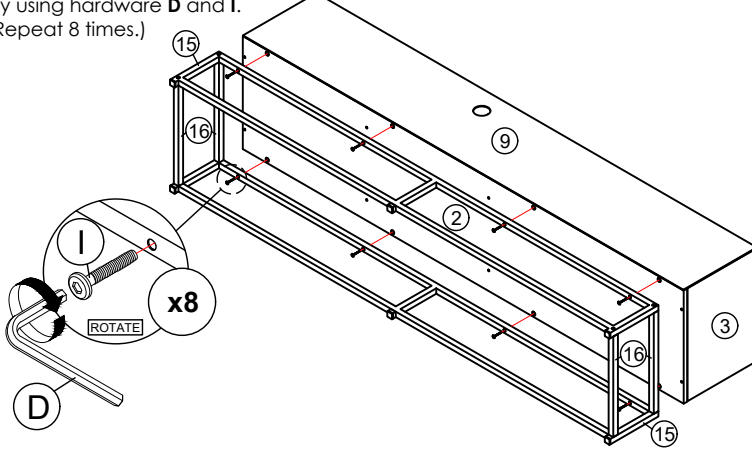

**STEP 8**

Insert hardware L into mounting positions on panel (5) and (6) by hand. (Repeat 4 times.)

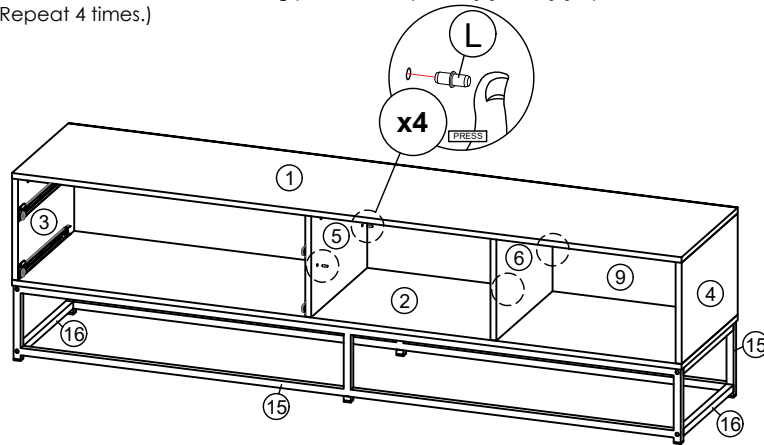

**STEP 9**

Assemble panel (7) into between panel (5) and (6). (Repeat 1 times.)

**STEP 10**

Fix hardware M onto panel (8) by using hardware F. (Repeat 2 times for each hardware.)

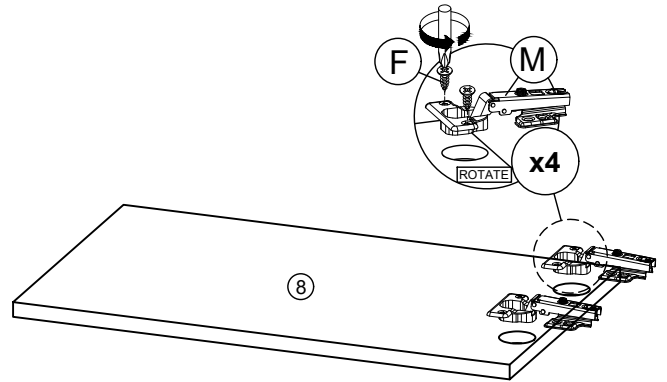
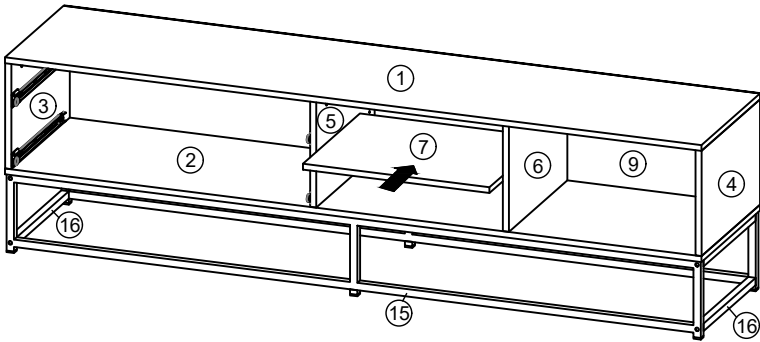

\* In this step hardware L are pre-inserted.

**STEP 11**

- Fix hardware M into panel (4) by using hardware F. (Repeat 4 times for each hardware.)  
- Tighten or loosen the screw to adjust position of panel (8). (Do only when needed.)



**STEP 12**

Fix hardware K onto panel (11) by using hardware E. (Repeat 2 times.)

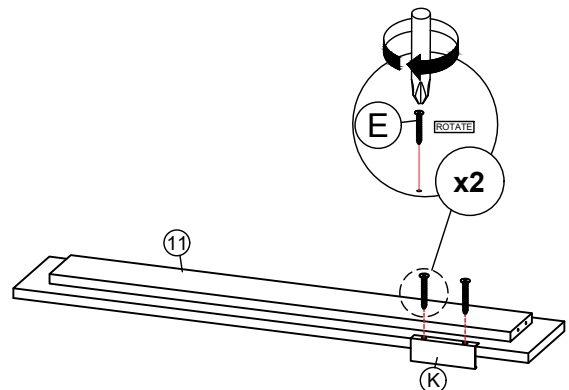
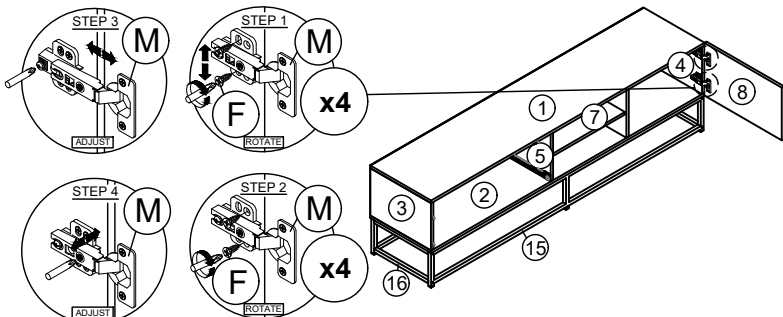

\* In this step hardware M have been assembled in panel (8).

**CODING**  
- 336047

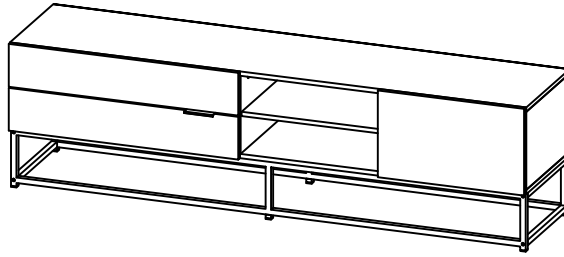

ISO 9001:2015  
Reg. No. 00005-1-INT-1-QMS

nuhoom.com

**STEP 13**

Assemble panel (13) to panel (10) or (11) and (12) by using hardware G. (Repeat 16 times.)



**STEP 14**

Assemble panel (14) to entire body with hardware H. (Repeat 24 times.)

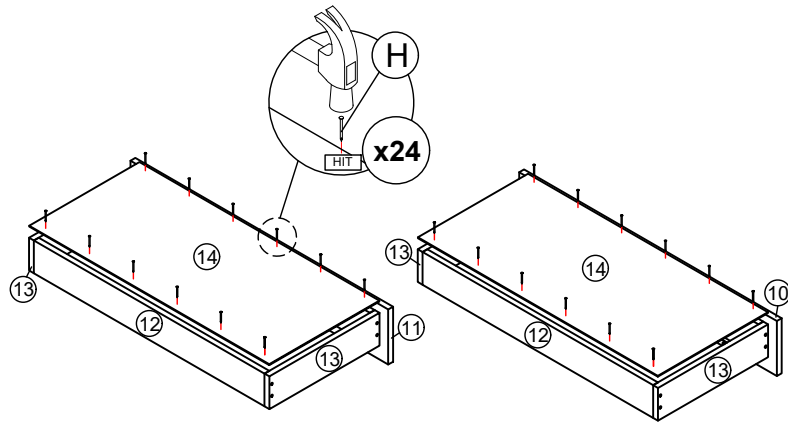
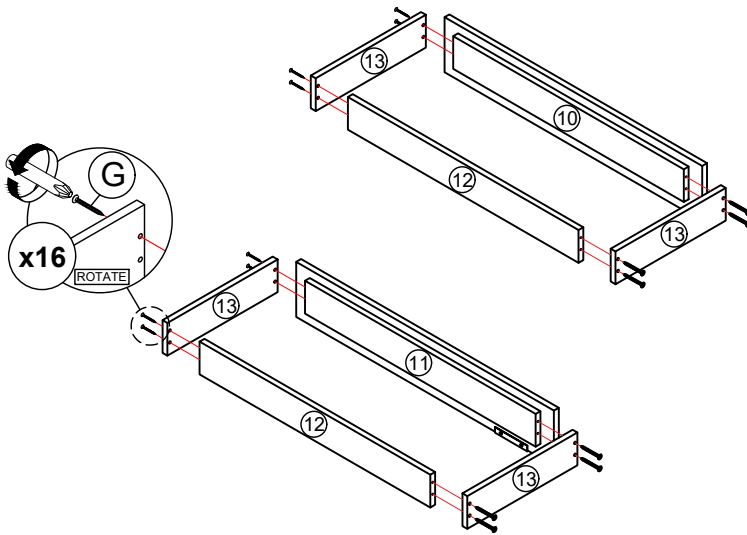

**STEP 15**

Assemble hardware N2 (L/R) to panel (14) by using hardware F. (Repeat 3 times for each hardware.)

**STEP 16**

Put all the drawer in place along the drawer slides.

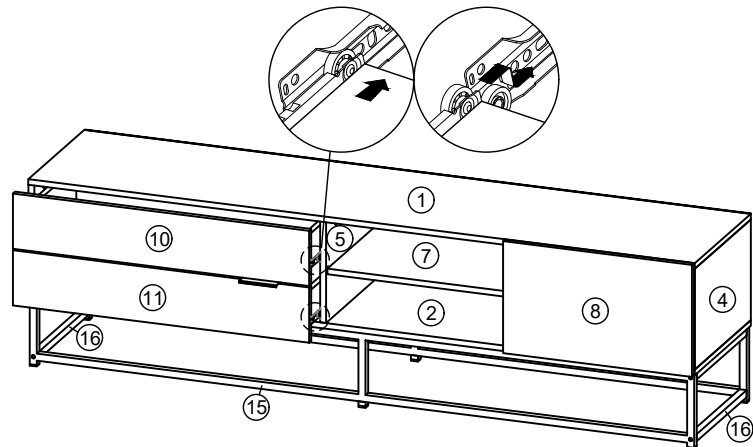
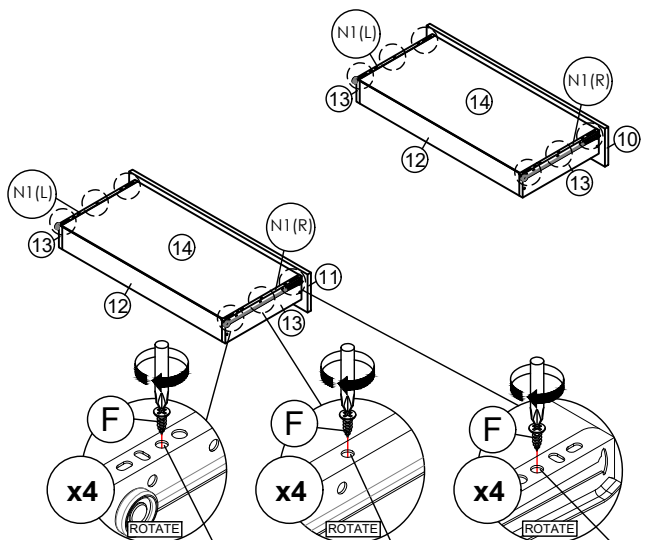

Third hole from the edge. Hole at the center. Third hole from the edge.

\*Hardware N2 (L/R) shall be leaning against panel (10) or (11) when assembling.