

## CODING

-233299

-233300



**ISO 9001:2015**  
Reg. No. 000435-1-MY-1-QMS

**LUooma.com**

Read the instruction carefully. Remove all the wrapping material, staples and straps from the carton. Refer to the hardware and furniture part list for guidance. Be sure that you have all the parts before you start assembling. Place all the wooden furniture part on a clean and flat soft surface, such as carpet or rubbermat to prevent from scratches.

## CAUTION

KEEP ALL THE PARTS OUT OF REACH OF CHILDREN .

| ITEM | PHOTO | HARDWARE NAME         | QTY |
|------|-------|-----------------------|-----|
| 1    |       | JCBB SCREW M8X60MM    | 2   |
| 2    |       | FLAT WASHER M8        | 6   |
| 3    |       | ALLEN KEY M5          | 1   |
| 4    |       | BARREL NUT M8         | 2   |
| 5    |       | WOOD DOWEL M10 X 40MM | 4   |
| 6    |       | WOOD BUTTON 18.5MM    | 6   |
| 7    |       | JCBB SCREW M8X80MM    | 4   |
| 8    |       | C/B SCREW M4 X 50MM   | 3   |
| 9    |       | PASTE PAD 20MM        | 4   |
| 10   |       | L-BRACKET             | 2   |
| 11   |       | C/B SCREW M4 X 20MM   | 4   |
| 12   |       | SPRING WASHER M8      | 6   |

| ITEM | PHOTO | PART NAME | QTY |
|------|-------|-----------|-----|
| A    |       | BACK      | 1   |
| B    |       | SEAT      | 1   |
| C    |       | RAIL      | 1   |
| D    |       | ARM       | 2   |

# FIGARO

ASSEMBLY GUIDE

## CODING

-233299

-233300



ISO 9001:2015  
Reg. No. 000435-1-MY-1-QMS

LUOMA.COM

1

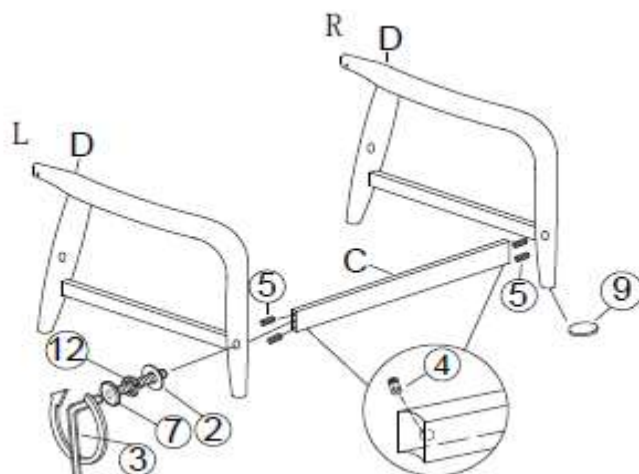

2

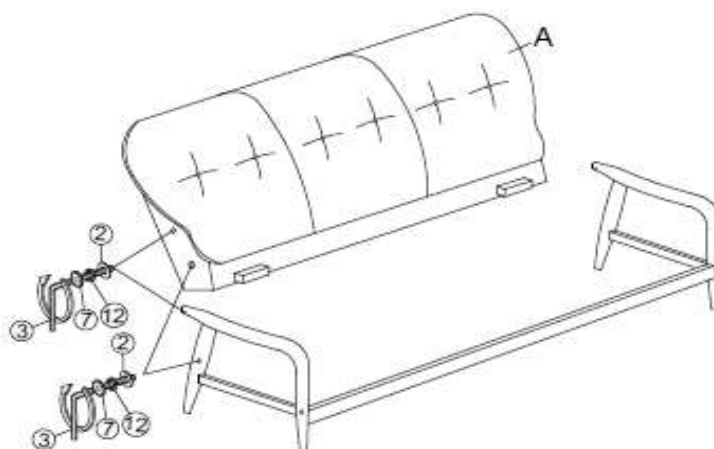

3

