

CODING:-
- 230029
- 230030
- 230055
- 230056

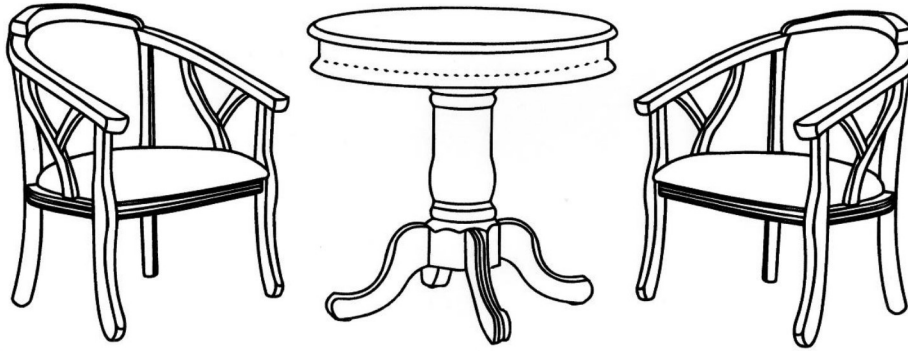

ISO 9001:2015
Reg. No. 000435-I-MY-I-QMS

nuhoom.com

Read the instruction carefully. Remove all the wrapping material, staples and straps from the carton. Refer to the hardware and furniture part list for guidance. Be sure that you have all the parts before you start assembling. Place all the wooden furniture part on a clean and flat soft surface, such as carpet or rubbermat to prevent from scratches.

CAUTION

KEEP ALL THE PARTS OUT OF REACH OF CHILDREN

ITEM	PHOTO		QTY	ITEM	PHOTO	PARTS NAME	QTY
(A)		JCBC BOLTS M6 X 40MM	4 PCS	1		TABLE TOP	1PC
(B)		CB SCREW M4 X 32MM	4 PCS	2		COLUMN	1PC
(C)		FLAT WASHER 5/16	4 PCS	3		CROSSBAR	1SET
(D)		ALLEN KEY M4	1 PC	4		FEET	4PCS
(E)		SPANNER	1 PC				
(F)		ADJUST SCREW	4 PCS				
(G)		HEX NUT 5/16	4 PCS				

STEP 1

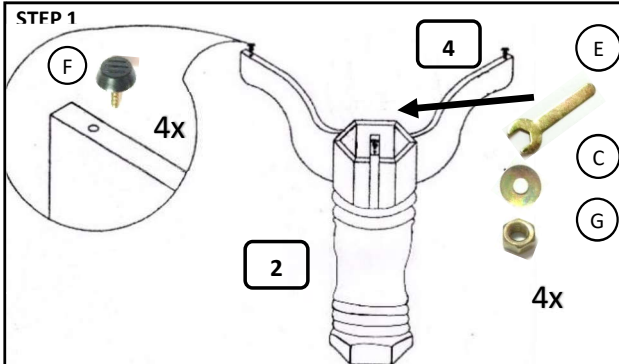

STEP 2

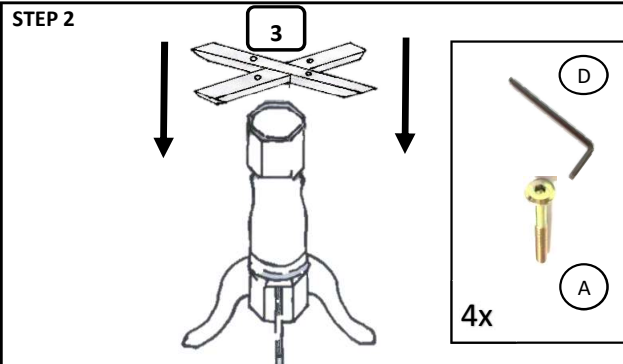

STEP 3

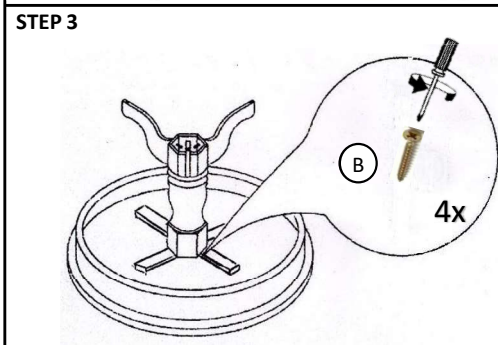

COMPLETED

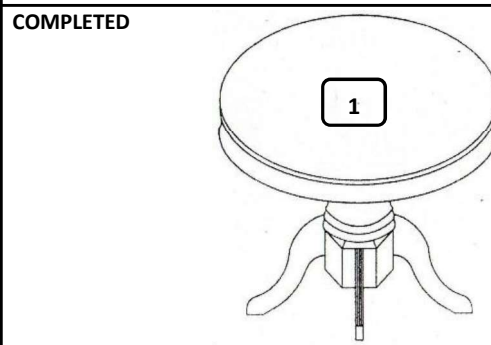

CODING:-
- 230029
- 230030
- 230055
- 230056

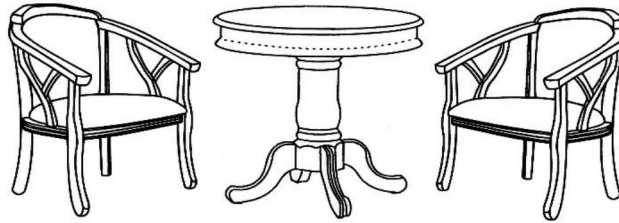

ISO 9001:2015
Reg. No. 000435-1-MY-1-QMS

nuhoom.com

Read the instruction carefully. Remove all the wrapping material, staples and straps from the carton. Refer to the hardware and furniture part list for guidance. Be sure that you have all the parts before you start assembling. Place all the wooden furniture part on a clean and flat soft surface, such as carpet or rubbermat to prevent from scratches.

CAUTION

KEEP ALL THE PARTS OUT OF REACH OF CHILDREN

ITEM	PHOTO		QTY	ITEM	PHOTO	PARTS NAME	QTY
(A)	JCBC BOLTS M6 X 50MM		12PCS	1		Chair Back	1PC
(B)	JCBC BOLTS M6 X 40MM		4PCS	2		ARM SET	2PCS
(C)	SPRING WASHER M6		12PCS	3		FRONT PANEL	1PC
(D)	ALLEN KEY M4		1PC	4		SEAT CENTER SUPPORT	1PC
(E)	CSK SCREW M4 X 32MM		34PCS	5		SEAT CORNER BLOCK	2PCS
(F)	WOOD DOWEL M8 X 35		4PCS	6		BACK PANEL	1PC
(G)	WOOD BUTTON		4PCS				

STEP 1

STEP 2

STEP 3

STEP 4

COMPLETED