

CODING
- 152010

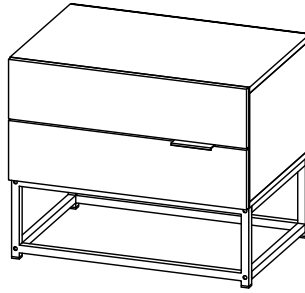

ISO 9001:2015
Reg. No. 00905-1-MIT-1-QMS

nuhoom.com

Read the instructions carefully. Remove all the wrappings, staples and straps from the carton. Refer to the hardware and furniture part list for guidance. Make sure that you have all the parts before you start assembling. Place all the wooden furniture parts on a clean, flat and soft surface, such as a carpet or rubbermat to prevent scratches.

CAUTION
KEEP ALL THE PARTS OUT OF CHILDREN'S REACH.

HARDWARE			
A	MINI FIX	A1 A2 A3	4 SETS
B	M8 X 30MM WOOD DOWEL		8 PCS
C	M6 X 50MM CSK CAP WOOD SCREW		4 PCS
D	ALLEN KEY M4		1 PC
E	JCBC SCREW M6 X 30MM		4 PCS
F	JCBC SCREW M6 X 40MM		8 PCS
G	M3 X 12MM C.B SCREW		2 PCS
H	M3.5 X 16MM C.B SCREW		24 PCS
I	M4 X 38MM C.B SCREW		16 PCS
J	5/8 NAIL		30 PCS
K	MODERN HANDLE L (100MM)		1 PC
L	14" DRAWER SLIDE	L1 (L/R) L2 (L/R)	2 SETS

PART LIST		QTY
1	TOP PANEL	1 PC
2	BOTTOM PANEL	1 PC
3	SIDE PANEL (L)	1 PC
4	SIDE PANEL (R)	1 PC
5	BACK PANEL	1 PC
6	DRAWER FRONT (UP)	1 PC
7	DRAWER FRONT (DOWN)	1 PC
8	DRAWER SIDE	4 PCS
9	DRAWER BACK	2 PCS
10	DRAWER BOTTOM	2 PCS
11	METAL SIDE	2 PCS
12	METAL SUPPORT	4 PCS

SELF-PREPARED TOOLS: Tools below are NOT included in package.	
	SCREWDRIVER
	HAMMER

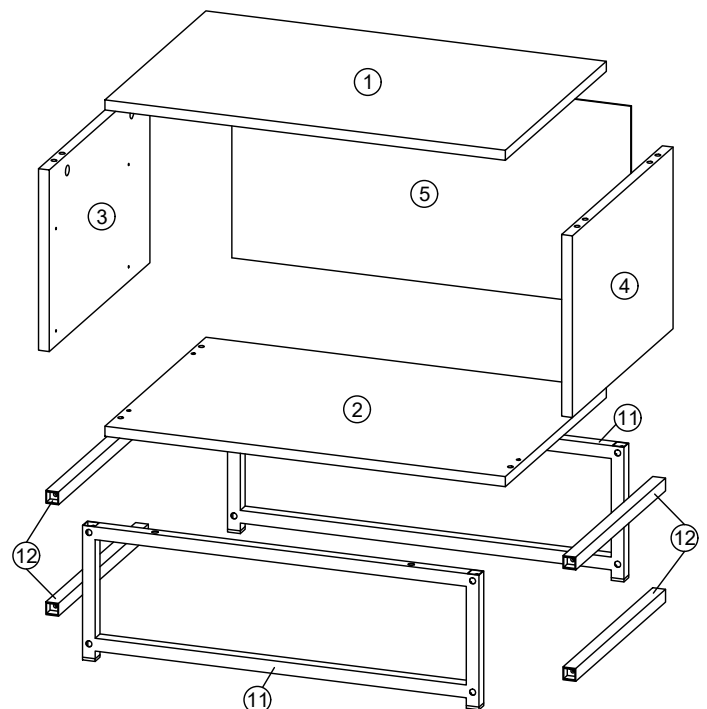
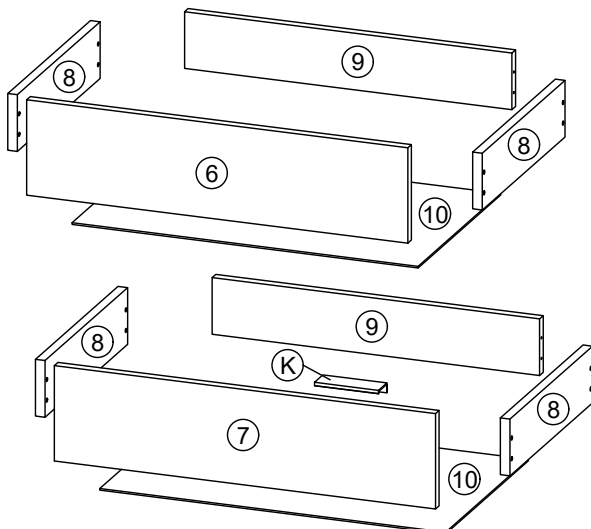

CODING
- 152010

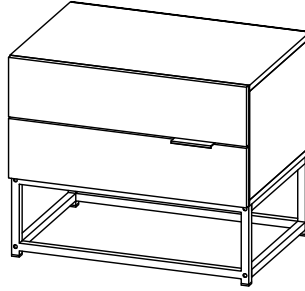

ISO 9001:2015
Reg. No. 00005-1-MF-1-QMS

nuhoom.com

STEP 1

- Insert hardware **A1** onto panel (3) and (4).
(Repeat 4 times.)
- Insert hardware **A2** onto panel (1).
(Repeat 4 times.)
- Insert hardware **B** onto panel (3) and (4).
(Repeat 8 times.)

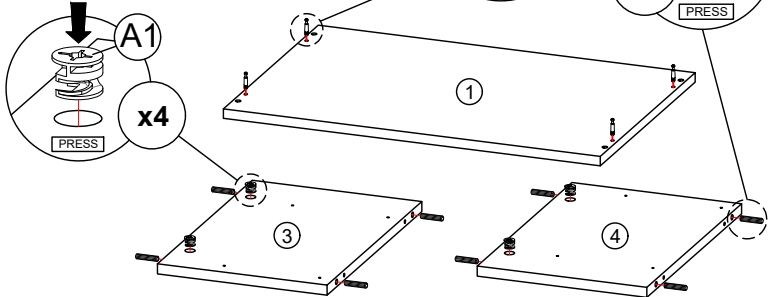

STEP 2

- Fix hardware **L1 (L/R)** into panel (3) and (4) with hardware **H**.
(Repeat 3 times for each hardware.)

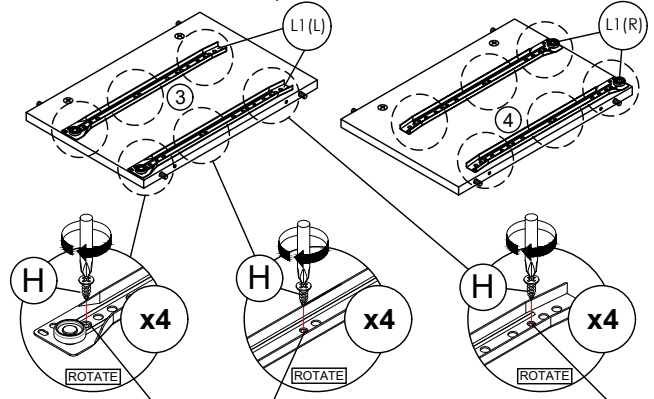

* Ensure the arrows on hardware **A1** point towards mounting positions.

STEP 3

- Attach panel (3) and (4) to panel (1).
- Insert all hardware **A2** into **A1**.
- Rotate all **A1** until tight.
- Apply **A3** onto all **A1**.
(Repeat 4 times.)



OR

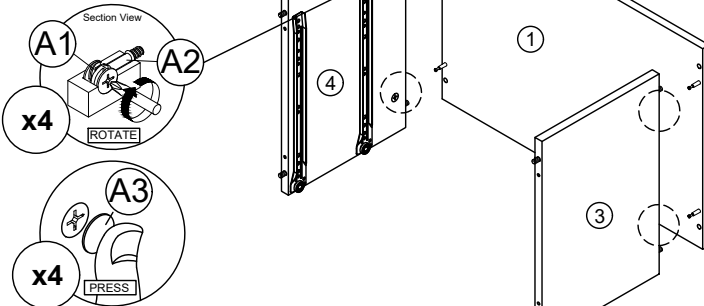

* In this step hardware **A1**, **A2** and **B** are pre-inserted.

STEP 5

- Assemble panel (5) to entire body with hardware **J**.
(Repeat 14 times.)

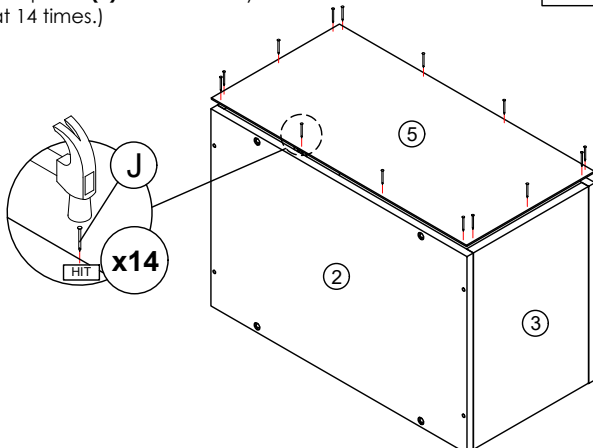
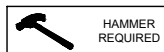

STEP 4

- Connect panel (2) to panel (3) and (4) by using hardware **C** and **D**.
(Repeat 4 times.)

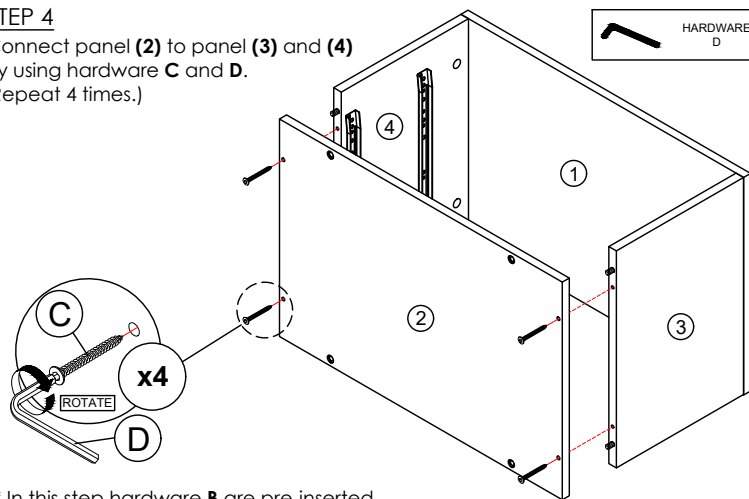

* In this step hardware **B** are pre-inserted.

STEP 6

- Connect Metal Side (11) to Metal Support (12) by using hardware **D** and **F**.
(Repeat 8 times.)

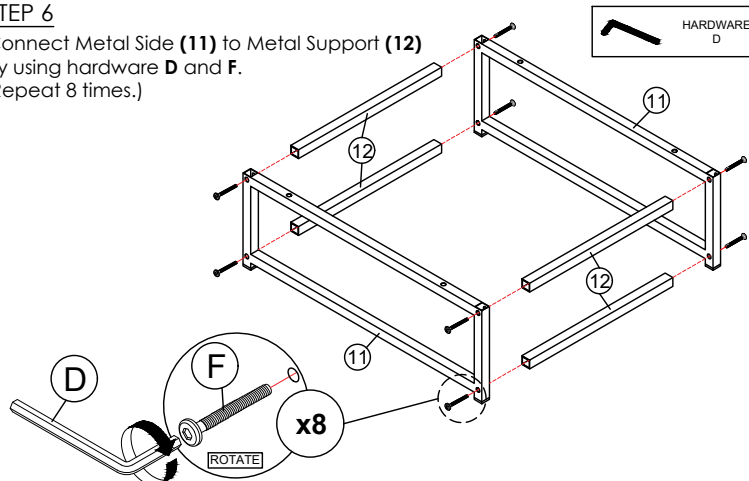

CODING
- 152010

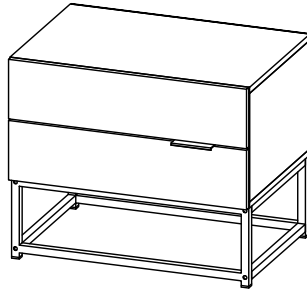

ISO 9001:2015
Reg. No. 00905-1-MF-1-QMS

nuhoom.com

STEP 7

Connect Metal Side (11) to panel (2) by using hardware D and E. (Repeat 4 times.)

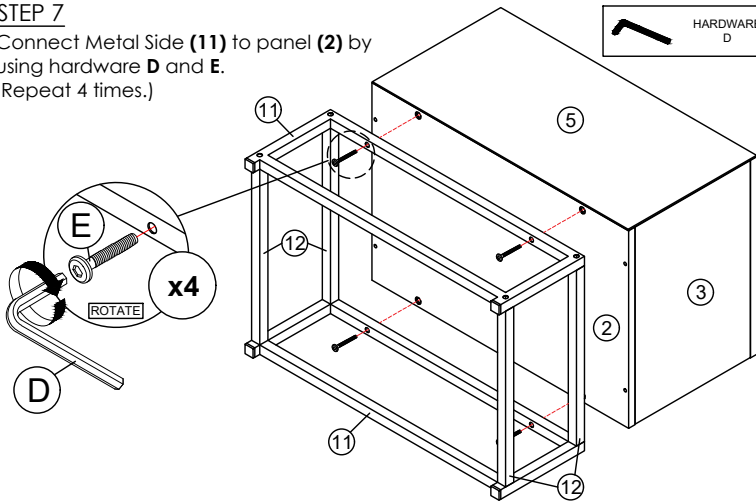
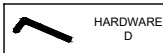

STEP 8

Assemble panel (8) with panel (6) or (7) and (9) by using hardware I. (Repeat 16 times.)

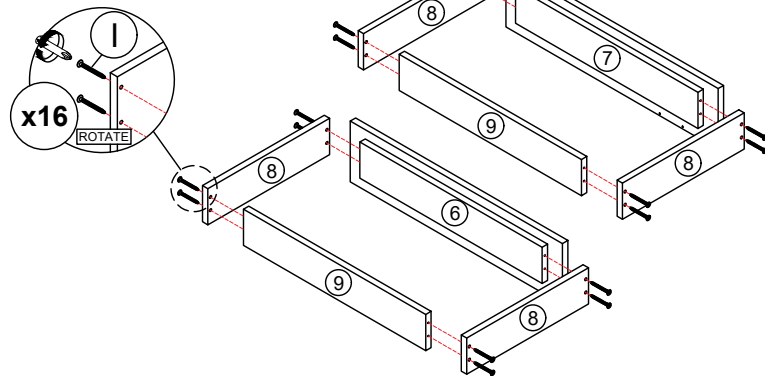

STEP 9

Assemble panel (10) to entire body with hardware J. (Repeat 16 times.)

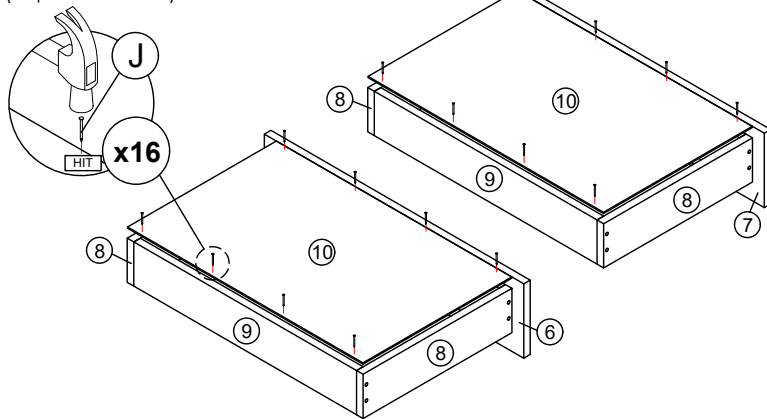

STEP 10

Assemble hardware L2 (L/R) to panel (10) by using hardware H. (Repeat 3 times for each hardware.)

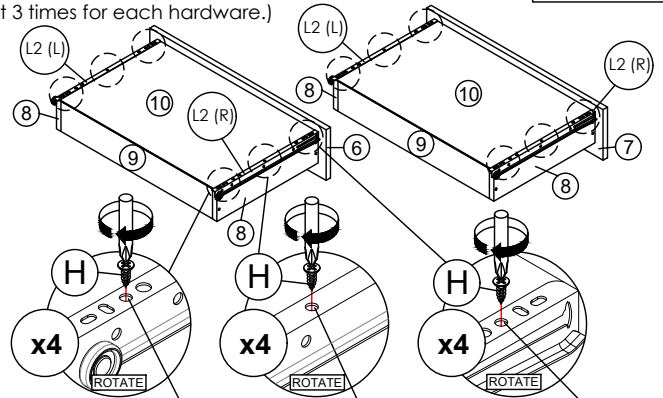

Third hole from the edge. | Hole at the center. | Third hole from the edge.

*Hardware L2 (L/R) shall be leaning against panel (6) or (7) when assembling.

STEP 11

Fix hardware K onto panel (7) by using hardware G. (Repeat 2 times.)

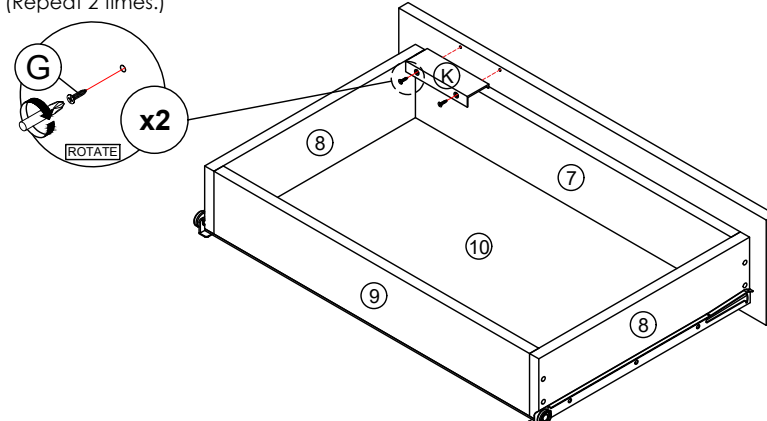

STEP 12

Put all the drawer in place along the drawer slides.

