

CODING
- 133084

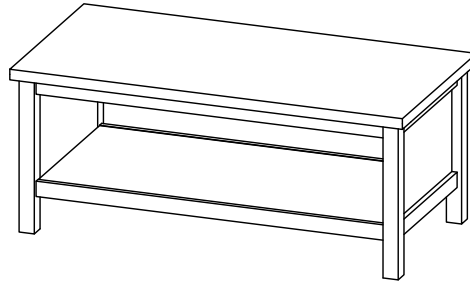

ISO 9001:2015
Reg. No. 00005-1-MIT-1-QMS

nuhoom.com

Read the instructions carefully. Remove all the wrappings, staples and straps from the carton. Refer to the hardware and furniture part list for guidance. Make sure that you have all the parts before you start assembling. Place all the wooden furniture parts on a clean, flat and soft surface, such as a carpet or rubbermat to prevent scratches.

CAUTION
KEEP ALL THE PARTS OUT OF CHILDREN'S REACH.

PART LIST		QTY
1	TOP PANEL	1 PC
2	BOTTOM PANEL	1 PC
3	SIDE PANEL	2 PCS
4	RAIL TOP	2 PCS
5	RAIL BOTTOM	2 PCS
6	RAIL CENTER	1 PC

HARDWARE			
A	MINI FIX	A1 A2 A3	30 SETS
B	M8 X 30MM WOOD DOWEL		23 PCS
C	M8 X 40MM WOOD DOWEL		16 PCS
D	ALLEN KEY M4		1 PC
E	5/8 PVC NAIL LEG		4 PCS

SELF-PREPARED TOOLS: Tools below are NOT included in package.	
SCREWDRIVER	HAMMER

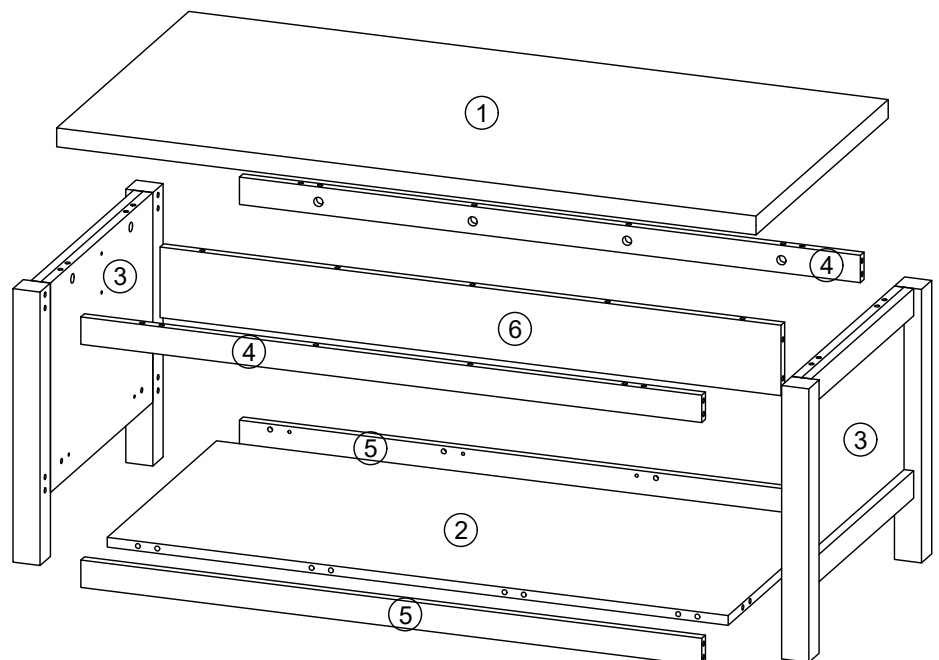

CODING
- 133084

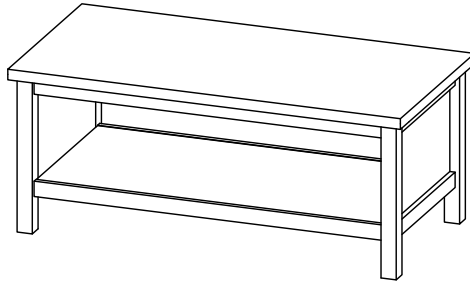

ISO 9001:2015
Reg. No. 00505-1-MF-1-QMS

nuhoom.com

STEP 1

- Insert hardware **A2** onto panel (1) and (5).
(Repeat 22 times.)
- Insert hardware **C** onto panel (5).
(Repeat 8 times.)

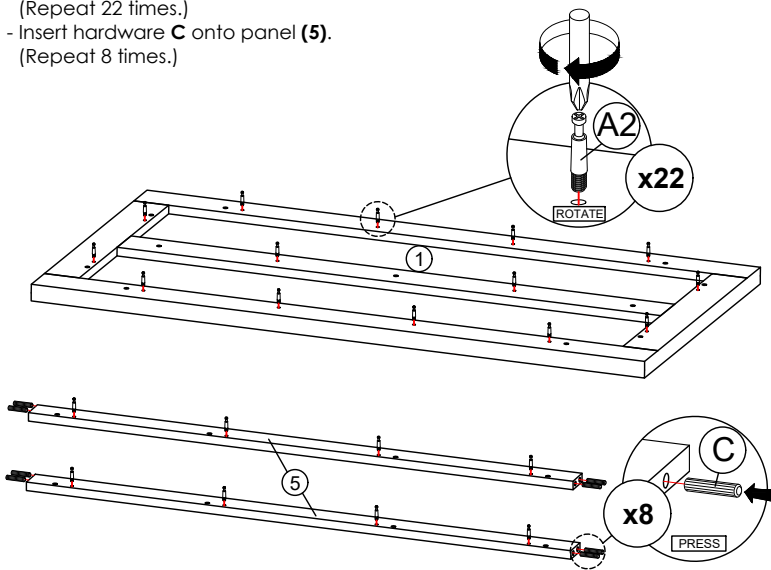

STEP 2

- Insert hardware **A1** onto panel (2) and (6).
(Repeat 18 times.)
- Insert hardware **B** onto panel (2) and (6).
(Repeat 15 times.)

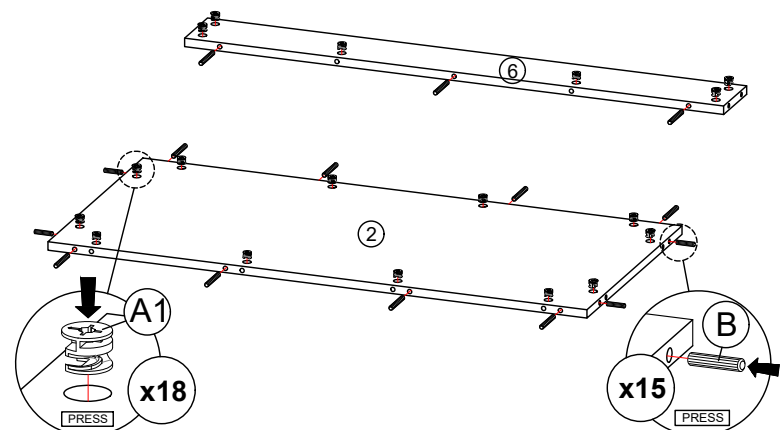

STEP 3

- Insert hardware **A1** onto panel (4).
(Repeat 8 times.)
- Insert hardware **B** onto panel (4).
(Repeat 4 times.)
- Insert hardware **C** onto panel (4).
(Repeat 8 times.)

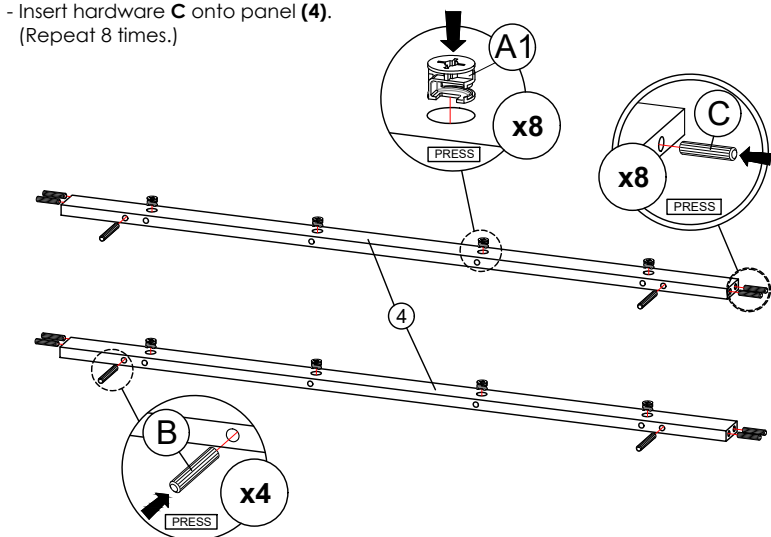

* Ensure the arrows on hardware **A1** point towards mounting positions.

STEP 4

- Insert hardware **A1** onto panel (3).
(Repeat 4 times.)
- Insert hardware **A2** onto panel (3).
(Repeat 8 times.)
- Insert hardware **B** onto panel (3).
(Repeat 4 times.)

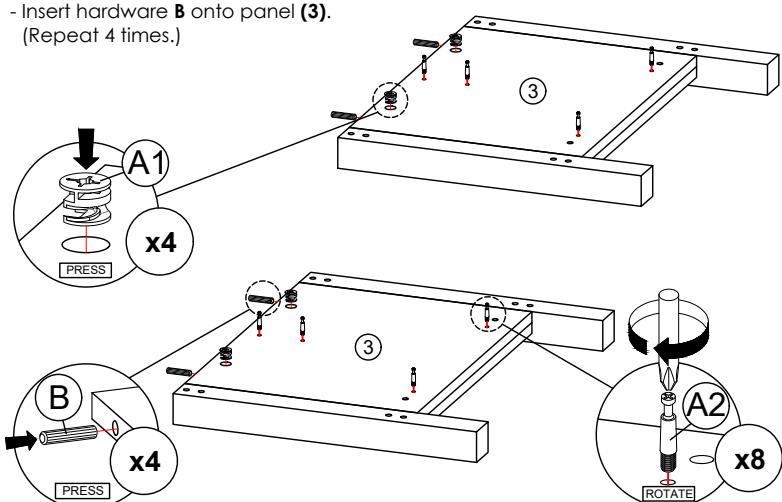
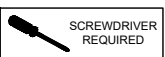

* Ensure the arrows on hardware **A1** point towards mounting positions.

* Ensure the arrows on hardware **A1** point towards mounting positions.

CODING
- 133084

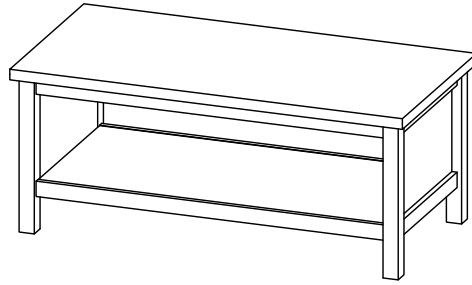

ISO 9001:2015
Reg. No. 00005-1-MF-1-QMS

nuhoom.com

STEP 5

- Attach panel (5) to panel (2).
- Insert all hardware **A2** into **A1**.
- Rotate all **A1** until tight.
- Apply **A3** onto all **A1**.
- (Repeat 8 times.)

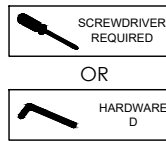

STEP 6

- Attach panel (3) to panel (2), (4), (5) and (6).
- Insert all hardware **A2** into **A1**.
- Rotate all **A1** until tight.
- Apply **A3** onto all **A1**.
- (Repeat 8 times.)

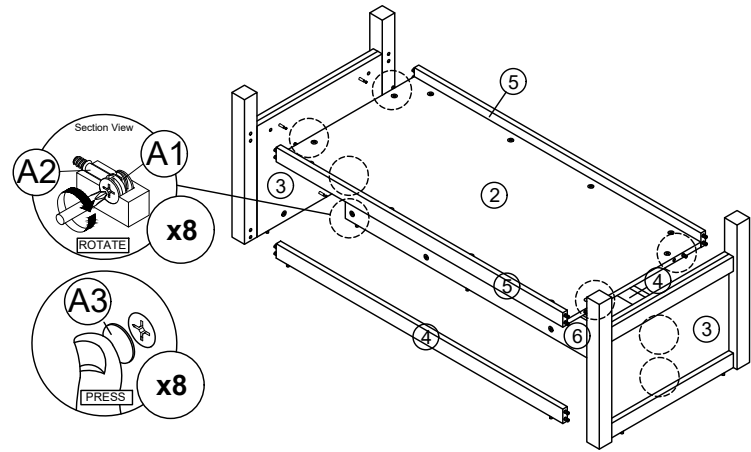
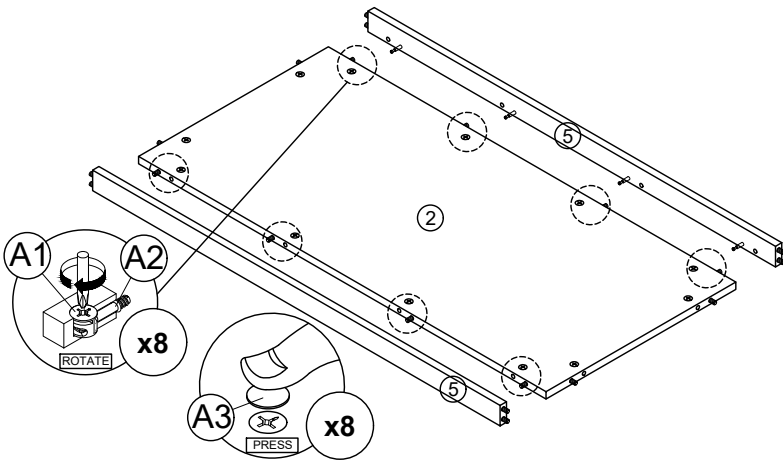
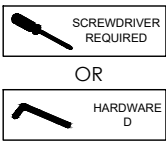

* In this step hardware **A1**, **A2** and **B** are pre-inserted.

* In this step hardware **A1**, **A2** and **B** are pre-inserted.

STEP 7

- Attach panel (1) to panel (3), (4) and (6).
- Insert all hardware **A2** into **A1**.
- Rotate all **A1** until tight.
- Apply **A3** onto all **A1**.
- (Repeat 14 times.)

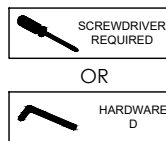

STEP 8

- Hit hardware **E** into bottom of panel (3).
- (Repeat 4 times.)

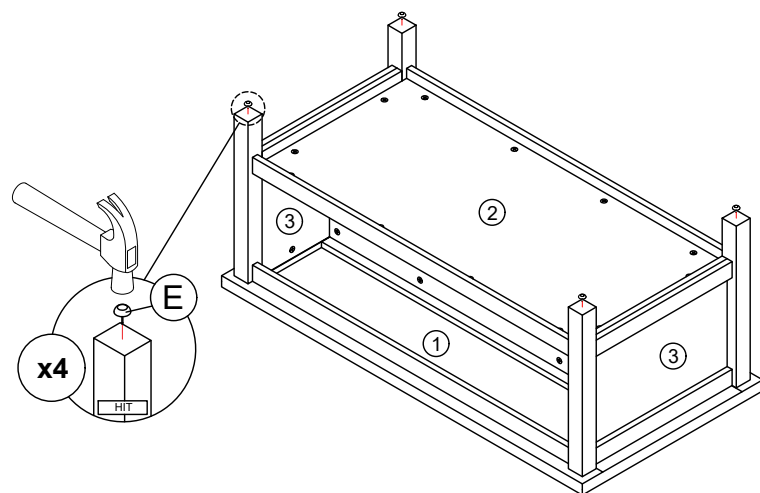
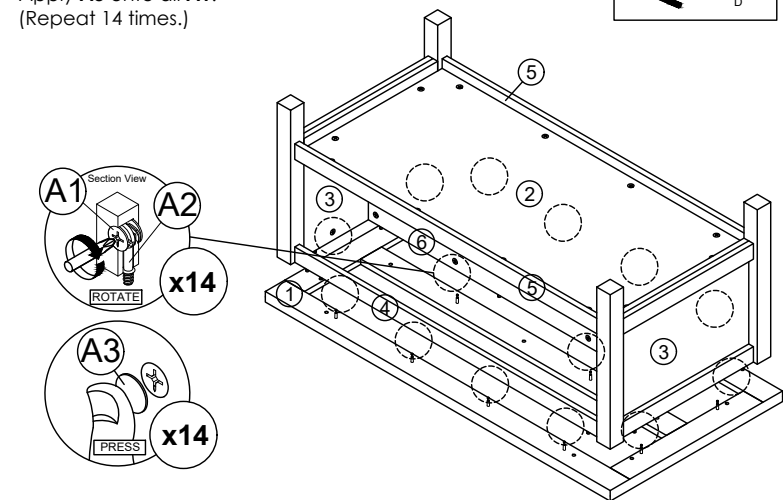
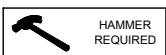

* In this step hardware **A1**, **A2** and **B** are pre-inserted.