

CODING
- 133083

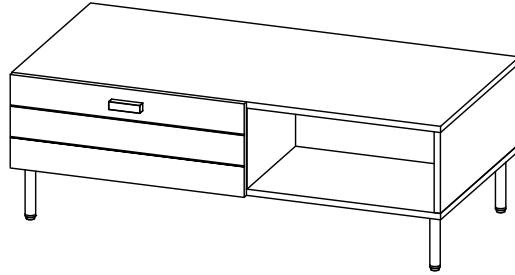

ISO 9001:2015
Reg. No. 00005-1-007-1-Q08

nuhoom.com

Read the instructions carefully. Remove all the wrappings, staples and straps from the carton. Refer to the hardware and furniture part list for guidance. Make sure that you have all the parts before you start assembling. Place all the wooden furniture parts on a clean, flat and soft surface, such as a carpet or rubbermat to prevent scratches.

CAUTION
KEEP ALL THE PARTS OUT OF CHILDREN'S REACH.

HARDWARE			
A	MINI FIX	A1 A2 A3	14 SETS
B	M8 X 30MM WOOD DOWEL		18 PCS
C	M6 X 50MM CSK CAP WOOD SCREW		8 PCS
D	ALLEN KEY M4		1 PC
E	M3.5 X 16MM C.B SCREW		28 PCS
F	M4 X 32MM C.B SCREW		2 PCS
G	M4 X 38MM C.B SCREW		4 PCS
H	WOOD HANDLE (80MM)		1 PC
I	METAL LEG 50 x 50 x H145MM (CENTER ROUND Ø25)		4 PCS
J	12" DRAWER SLIDE	J1 (L/R) J2 (L/R)	1 SET

PART LIST		QTY
1	TOP PANEL	1 PC
2	BOTTOM PANEL	1 PC
3	SIDE PANEL (L)	1 PC
4	SIDE PANEL (R)	1 PC
5	CENTER PANEL	1 PC
6	MIDDLE PANEL	1 PC
7	DRAWER FRONT	1 PC
8	DRAWER BACK	1 PC
9	DRAWER SIDE (L)	1 PC
10	DRAWER SIDE (R)	1 PC
11	DRAWER BOTTOM	1 PC
12	DRAWER BONE	1 PC

SELF-PREPARED TOOLS: Tools below are NOT included in package.



SCREWDRIVER



HAMMER

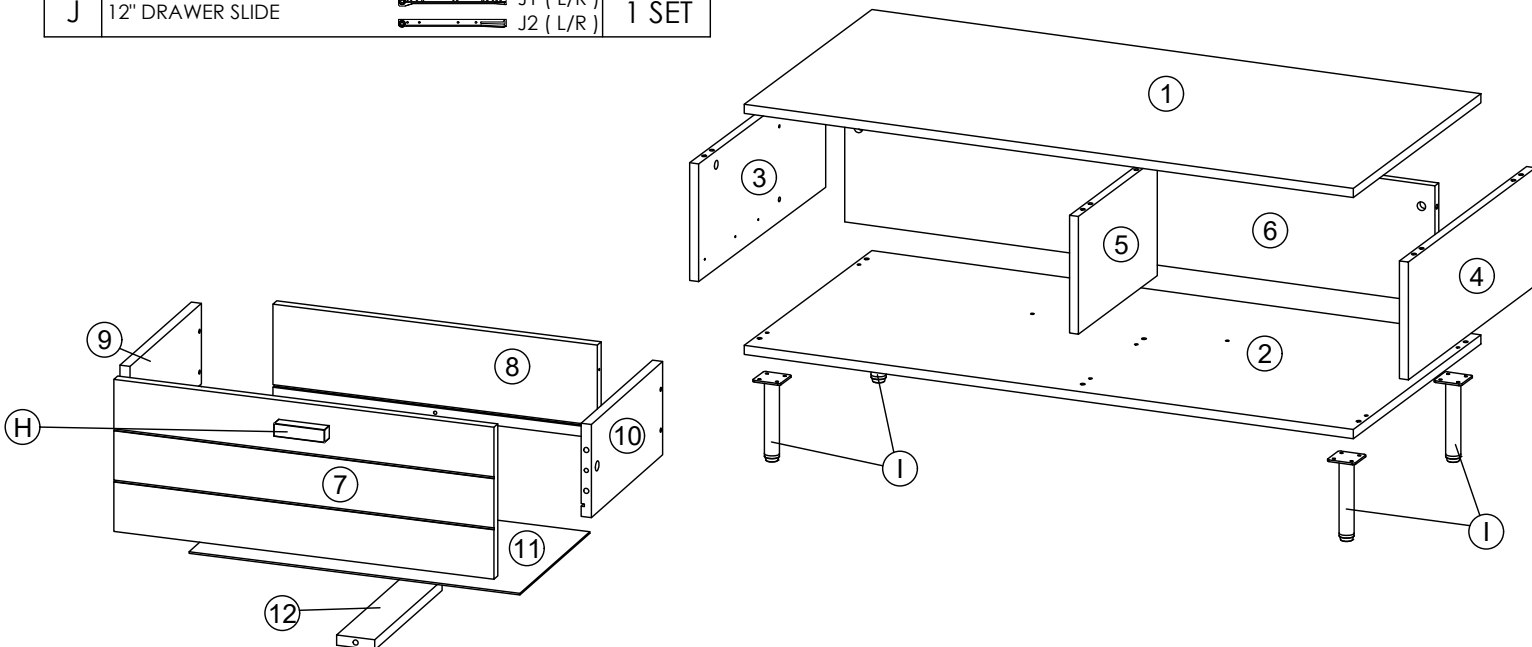

CODING
- 133083

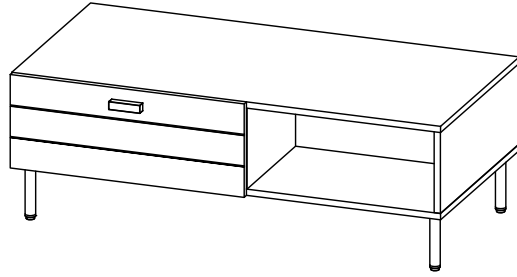

ISO 9001:2015
Reg. No. 0005-1-007-1-Q08

nuhoom.com

STEP 1

- Insert hardware **A1** onto panel **(3)**, **(4)**, **(5)**, **(6)**, **(9)**, **(10)**, and **(12)**. (Repeat 14 times.)
- Insert hardware **A2** onto panel **(1)**, **(3)**, **(4)**, **(7)**, and **(8)**. (Repeat 14 times.)
- Insert hardware **B** onto panel **(3)**, **(4)**, **(5)**, **(6)**, **(9)**, and **(10)**. (Repeat 18 times.)

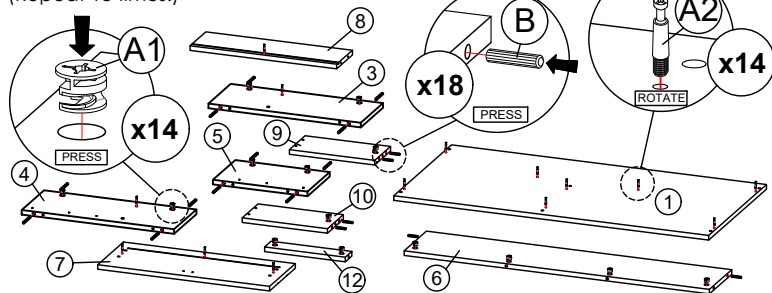

* Ensure the arrows on hardware **A1** point towards mounting positions.

STEP 3

- Attach panel **(6)** to panel **(3)** and **(4)**.
- Insert all hardware **A2** into **A1**.
- Rotate all **A1** until tight.
- Apply **A3** onto all **A1**. (Repeat 2 times.)



OR

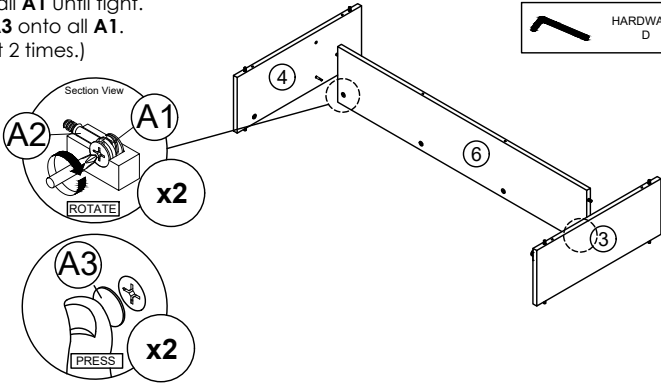

* In this step hardware **A1**, **A2** and **B** are pre-inserted.

STEP 5

- Connect panel **(2)** to panel **(3)**, **(4)**, **(5)** and **(6)** by using hardware **C** and **D**. (Repeat 8 times.)

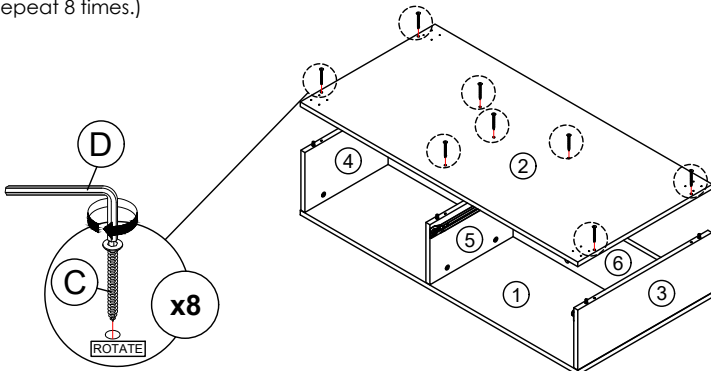

STEP 2

- Fix hardware **J1 (L)** into panel **(3)** with hardware **E**. (Repeat 3 times for each hardware.)
- Fix hardware **J1 (R)** into panel **(5)** with hardware **E**. (Repeat 3 times for each hardware.)

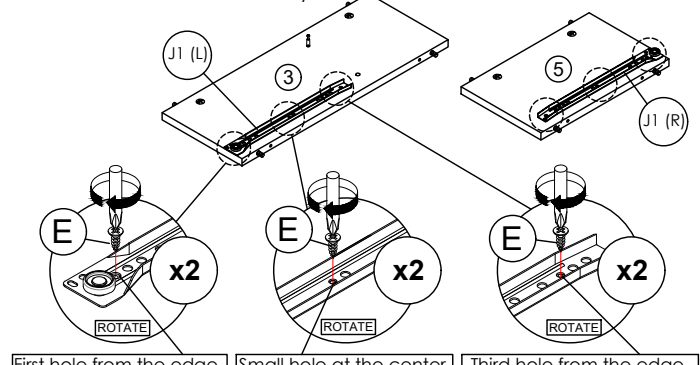

STEP 4

- Attach panel **(3)**, **(4)**, **(5)**, and **(6)** to panel **(1)**.
- Insert all hardware **A2** into **A1**.
- Rotate all **A1** until tight.
- Apply **A3** onto all **A1**. (Repeat 8 times.)



OR

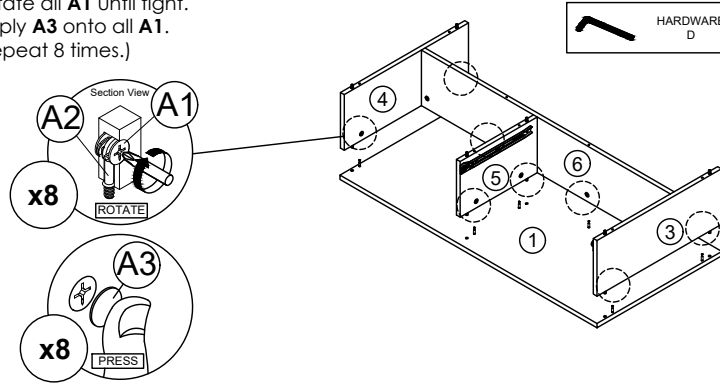

* In this step hardware **A1**, **A2** and **B** are pre-inserted.

STEP 6

- Assemble hardware **I** onto panel **(2)** by using hardware **E**. (Repeat 4 times for each hardware.)

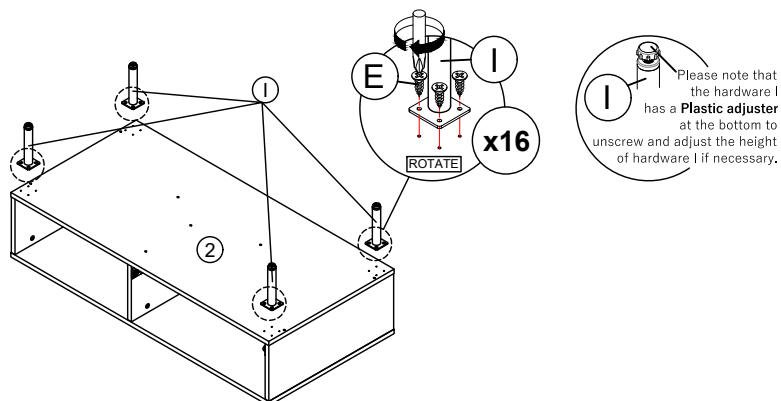

CODING
- 133083

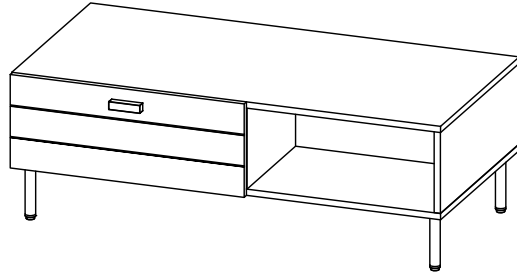

ISO 9001:2015
Reg. No. 00005-1-007-1-Q008

nuhoom.com

STEP 7

Fix hardware **H** onto panel **(7)** with hardware **F**.
(Repeat 2 times for each hardware.)

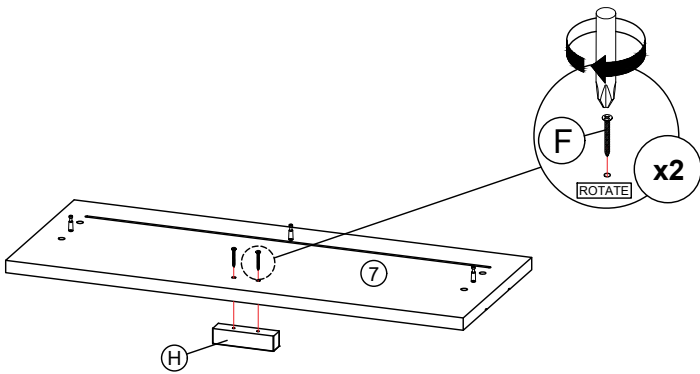

STEP 8

Assemble panel **(9)** and **(10)** to panel **(8)** by using hardware **G**.
(Repeat 4 times.)

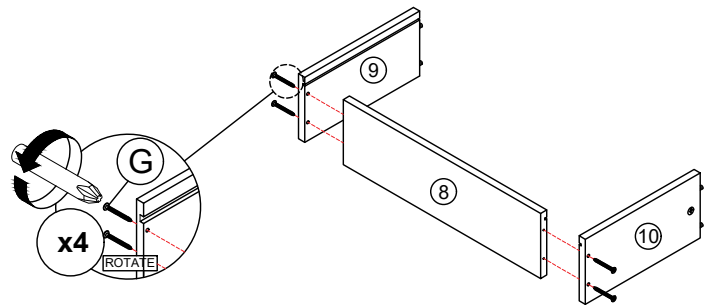

STEP 9

Insert the panel **(11)** along the slot.
(Repeat 1 times.)

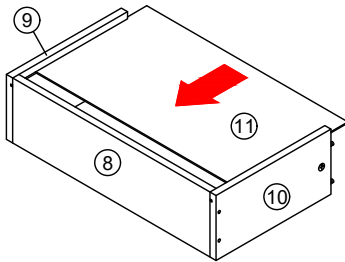

STEP 10

- Attach panel **(12)** to panel **(8)**.
- Attach panel **(7)** to panel **(9)**, **(10)** and **(12)**.
- Insert all hardware **A1** into **A1**.
- Rotate all **A1** until tight.
- Apply **A3** onto all **A1**.
(Repeat 4 times.)



OR

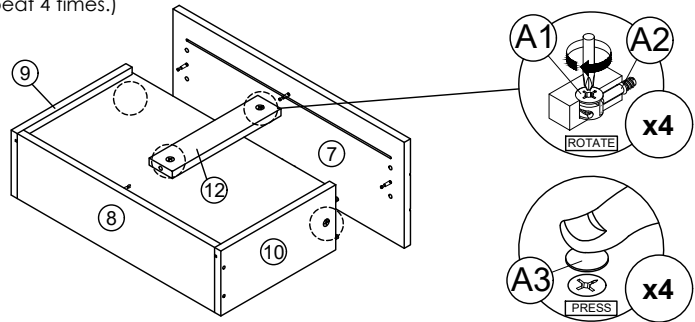

* In this step hardware **A1**, **A2** and **B** are pre-inserted.

STEP 11

Assemble hardware **J2 (L/R)** to panel **(9)** and **(10)** by using hardware **E**.
(Repeat 3 times for each hardware.)

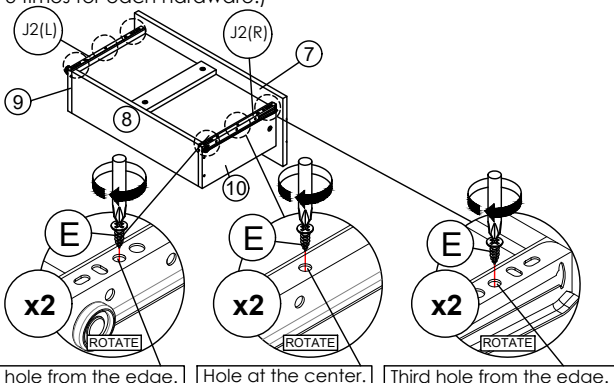

Third hole from the edge. | Hole at the center. | Third hole from the edge.

STEP 12

Put all the drawer in place along the drawer slides.

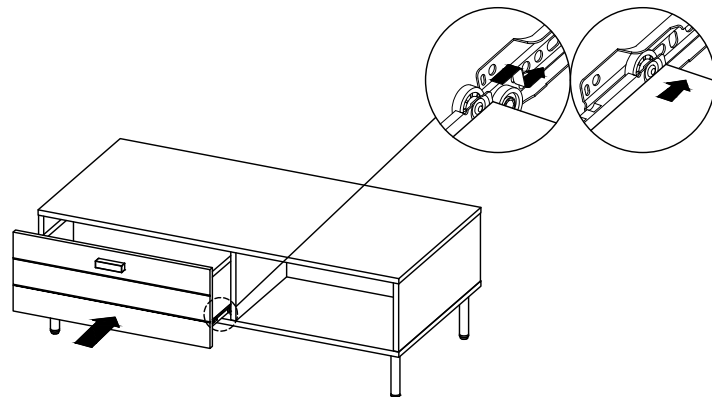

*Hardware **J2 (L/R)** shall be leaning against panel **(7)** when assembling.