

CODING
- 131096

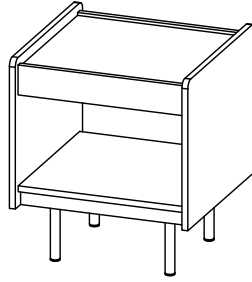

ISO 9001:2015
Reg. No. 00005-1-INT-1-QMS

nuhoom.com

Read the instructions carefully. Remove all the wrappings, staples and straps from the carton. Refer to the hardware and furniture part list for guidance. Make sure that you have all the parts before you start assembling. Place all the wooden furniture parts on a clean, flat and soft surface, such as a carpet or rubbermat to prevent scratches.

CAUTION
KEEP ALL THE PARTS OUT OF CHILDREN'S REACH.

| PART LIST | | QTY |
|-----------|--------------|-------|
| 1 | TOP PANEL | 1 PC |
| 2 | BOTTOM PANEL | 1 PC |
| 3 | SIDE PANEL | 2 PCS |
| 4 | MIDDLE PANEL | 2 PCS |
| 5 | BONE PANEL | 2 PCS |
| 6 | METAL APRON | 1 PC |
| 7 | METAL LEG | 4 PCS |

| HARDWARE | | | |
|----------|--------------------------|------------|---------|
| A | MINI FIX | A1 A2 A3 | 14 SETS |
| B | M8 X 30MM WOOD DOWEL | | 16 PCS |
| C | ALLEN KEY M4 | | 1 PC |
| D | M3.5 X 16MM C.B SCREW | | 8 PCS |
| E | M4 X 32MM C.B SCREW | | 6 PCS |
| F | JCBC Screw M6 x 20MM | | 16 PCS |
| G | JCBC SCREW M6 X 50MM | | 4 PCS |
| H | ONE HOLE L BRACKET (2MM) | | 4 PCS |

| SELF-PREPARED TOOLS: Tools below are NOT included in package. | |
|---------------------------------------------------------------|--------|
| SCREWDRIVER | HAMMER |

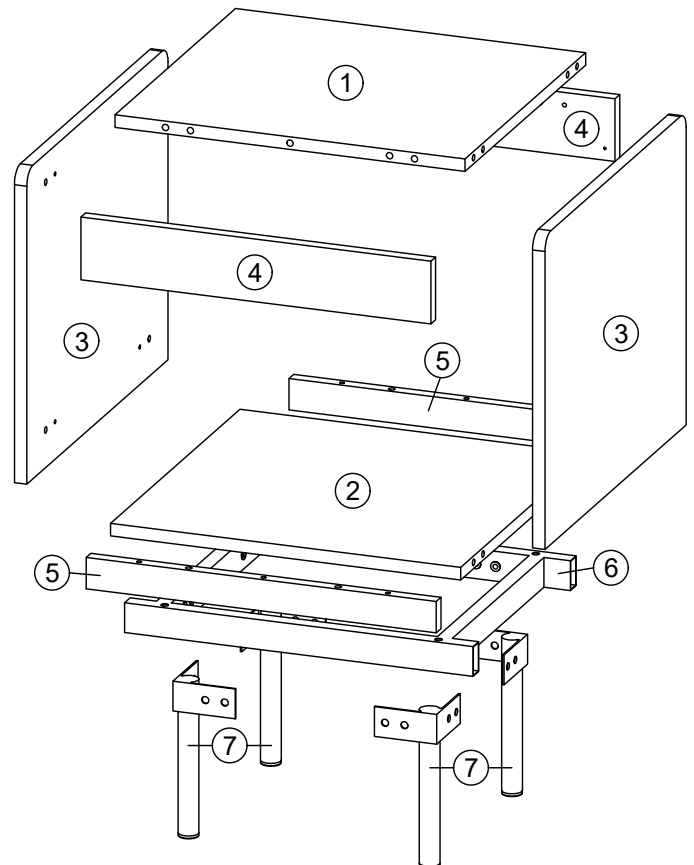

CODING
- 131096

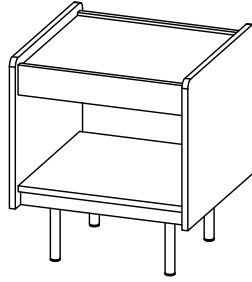

ISO 9001:2015
Reg. No. 00105-1-MF-1-QMS

nuhoom.com

STEP 1

- Insert hardware **A1** onto panel (1) and (2).
(Repeat 14 times.)
- Insert hardware **B** onto panel (1) and (2).
(Repeat 12 times.)



STEP 2

- Assemble hardware **H** to panel (4) with hardware **D**.
(Repeat 4 times.)
- Insert hardware **A2** onto panel (3) and (4).
(Repeat 14 times.)
- Insert hardware **B** onto panel (5).
(Repeat 4 times.)

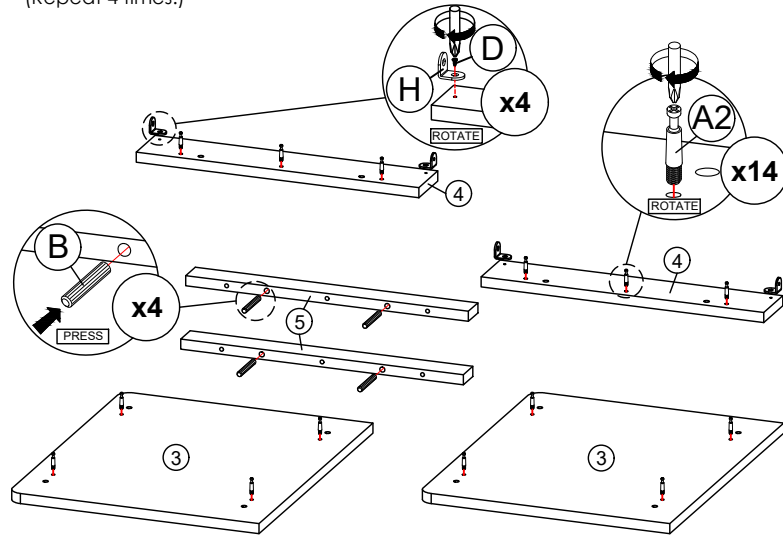
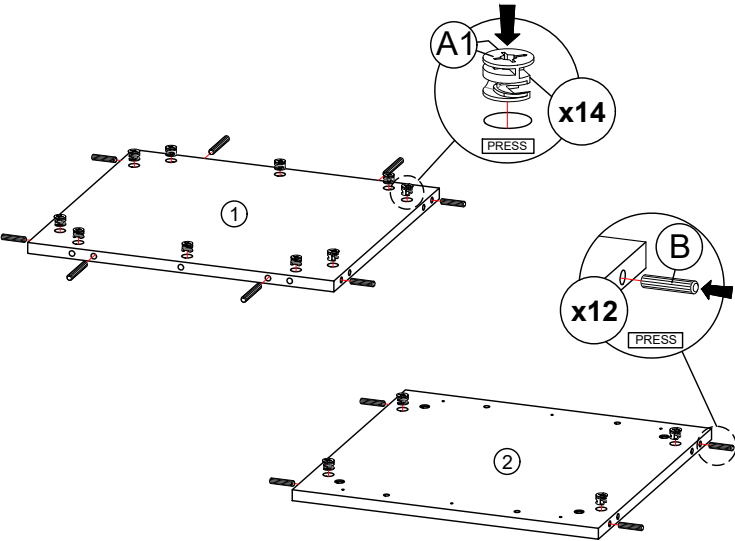

* Ensure the arrows on hardware **A1** point towards mounting positions.

* Ensure the arrows on hardware **A1** point towards mounting positions.

STEP 3

- Attach panel (4) to panel (1).
- Insert all hardware **A2** into **A1**.
- Rotate all **A1** until tight.
- Apply **A3** onto all **A1**.
(Repeat 6 times.)



OR



STEP 4

- Attach panel (5) to panel (2) by using hardware **E**.
(Repeat 6 times.)

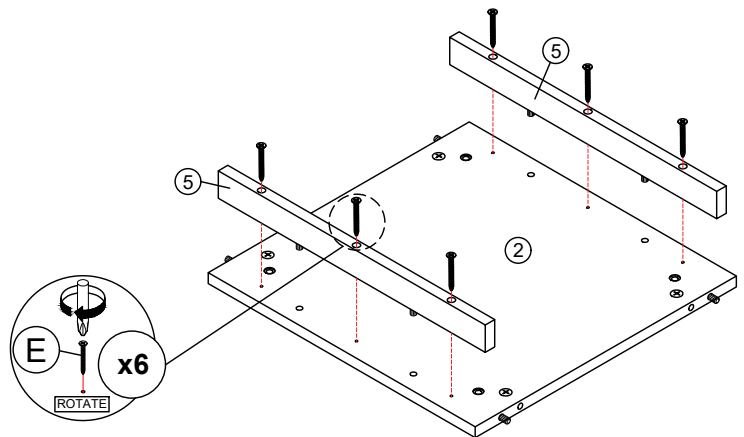
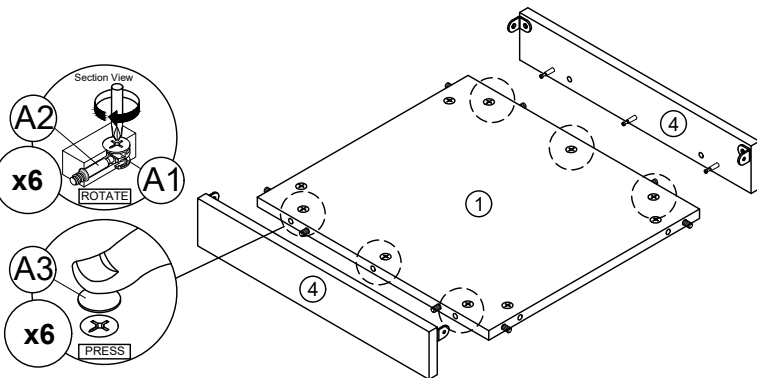

* In this step hardware **A1**, **A2** and **B** are pre-inserted.

CODING
- 131096

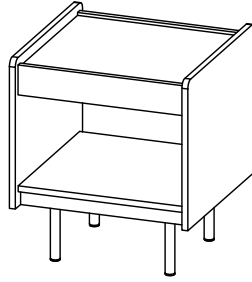

ISO 9001:2015
Reg. No. 00005-1-MIT-1-QMS

nuhoom.com

STEP 5

- Attach panel (3) to panel (1) and (2).
 - Insert all hardware A2 into A1.
 - Rotate all A1 until tight.
 - Apply A3 onto all A1.
- (Repeat 8 times.)

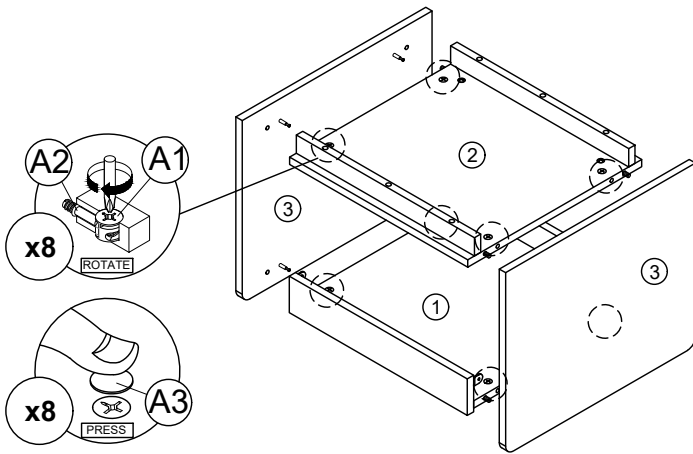
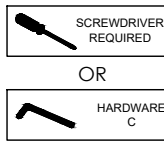

STEP 6

- Assemble hardware H to panel (3) with hardware D.
- (Repeat 4 times.)

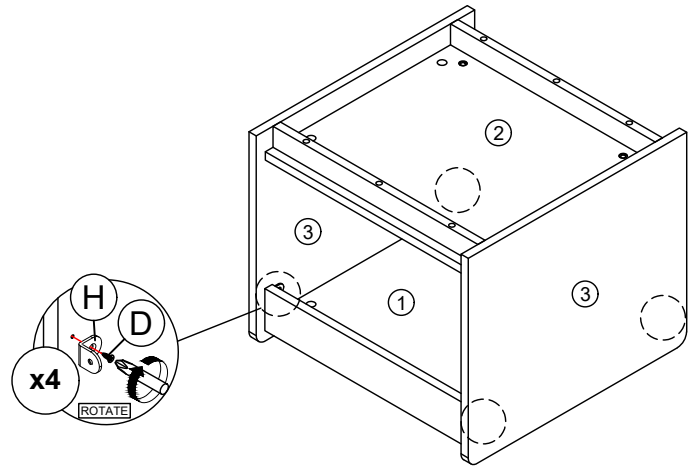

* In this step hardware A1, A2 and B are pre-inserted.

STEP 7

- Connect Metal Apron (6) to panel (2) by using hardware C and G.
- (Repeat 4 times.)

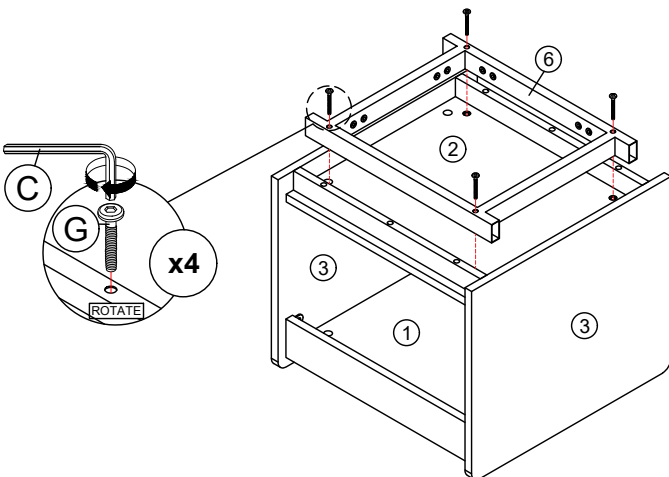
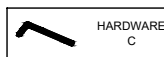

STEP 8

- Connect Metal Leg (7) to Metal Apron (6) by using hardware C and F.
- (Repeat 16 times.)

