

CODING
- 124057

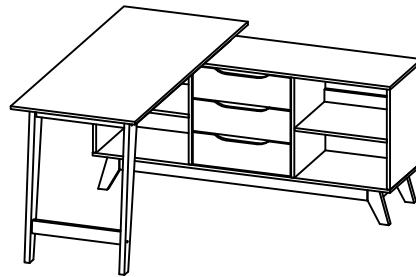

ISO 9001:2015
Reg. No. 000435-1-MY-1-QMS

nuhoom.com

Read the instructions carefully. Remove all the wrappings , staples and straps from the carton. Refer to the hardware and furniture part list for guidance. Make sure that you have all the parts before you start assembling. Place all the wooden furniture parts on a clean, flat and soft surface, such as a carpet or rubbermat to prevent scratches.

CAUTION
KEEP ALL THE PARTS OUT OF CHILDREN'S REACH.

PART LIST		QTY
1	TOP PANEL	1 PC
2	BOTTOM PANEL	1 PC
3	SIDE PANEL (L)	1 PC
4	SIDE PANEL (R)	1 PC
5	CENTER PANEL (L)	1 PC
6	CENTER PANEL (R)	1 PC
7	BONE PANEL	3 PCS
8	BACK BONE	2 PCS
9	BACK PANEL	1 PC
10	SHELF PANEL	2 PCS
11	DRAWER FRONT	3 PCS
12	DRAWER BACK	3 PCS
13	DRAWER SIDE	6 PCS
14	DRAWER BOTTOM	3 PCS
15	APRON - SHORT	6 PCS
16	APRON - FRONT	1 PC
17	APRON - BACK	1 PC
18	CENTER LEG	1 PC
19	TABLE TOP	1 PC
20	TOP APRON - LONG (L)	1 PC
21	TOP APRON - LONG (R)	1 PC
22	TOP APRON - SHORT	3 PCS
23	LEG SUPPORT	1 PC
24	TABLE LEG SUPPORT	2 PCS
25	TOP TABLE LEG - L	1 PC
26	TOP TABLE LEG - R	1 PC

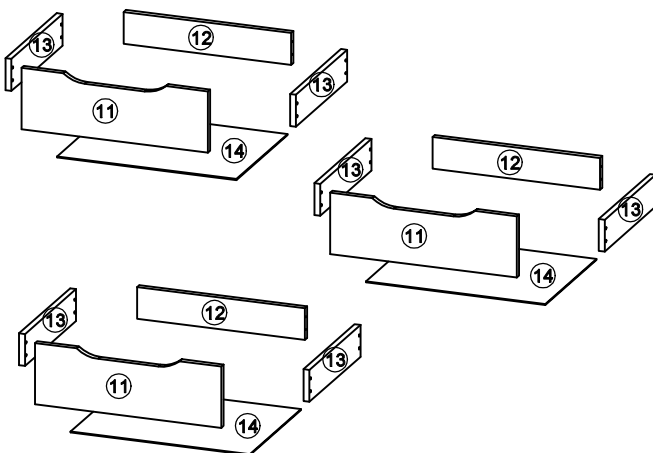
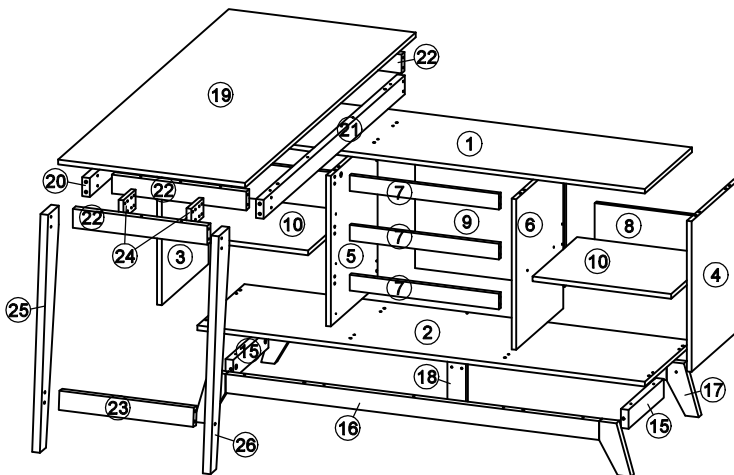

CODING
- 124057

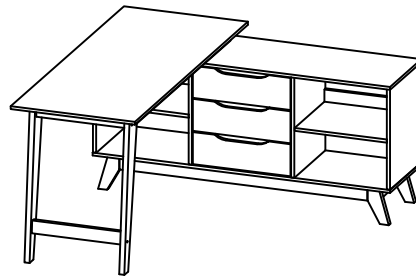

ISO 9001:2015
Reg. No. 000435-1-MY-1-QMS

nuhoom.com

HARDWARE			
A	MINI FIX A1 A2 A3		24 SETS
B	M8 X 30MM WOOD DOWEL		46 PCS
C	M8 X 40MM WOOD DOWEL		4 PCS
D	M6 X 50MM CSK CAP WOOD SCREW		13 PCS
E	M6 X 60MM CSK CAP WOOD SCREW		12 PCS
F	ALLEN KEY M4		1 PC
G	M3.5 X 16MM C.B SCREW		36 PCS
H	M4 X 30MM C.B SCREW		18 PCS

I	M4 X 38MM C.B SCREW	55 PCS
J	JCBC SCREW M6 X 70MM	2 PCS
K	JRN NUT	2 PCS
L	METAL SHELF SUPPORT	8 PCS
M	5/8 NAIL	24 PCS
N	5/8 PVC NAIL LEG	7 PCS
O	14" DRAWER SLIDE	O1 (L/R) O2 (L/R) 3 SET

SELF-PREPARED TOOLS: Tools below are NOT included in package.



SCREWDRIVER



HAMMER

STEP 1

- Insert hardware **A1** onto panel **(3)** and **(4)**. (Repeat **4** times.)
- Insert hardware **A2** onto panel **(1)**, **(3)** and **(4)**. (Repeat **12** times.)
- Insert hardware **B** onto panel **(3)** and **(4)**. (Repeat **8** times.)

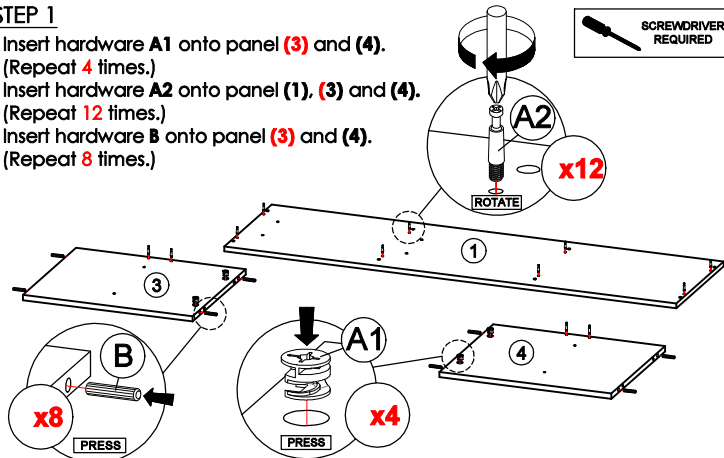

* Ensure the arrows on hardware **A1** point towards mounting positions.

STEP 3

- Insert hardware **A1** onto panel **(8)**, **(9)** and **(15)**. (Repeat **16** times.)
- Insert hardware **B** onto panel **(9)**. (Repeat **4** times.)

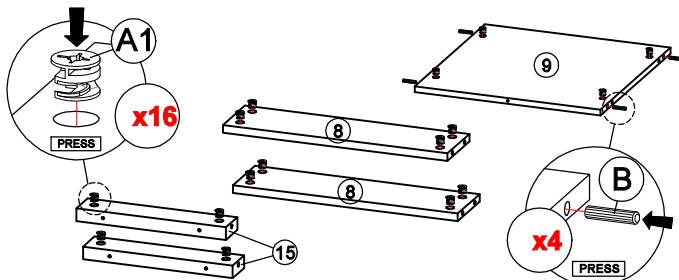

* Ensure the arrows on hardware **A1** point towards mounting positions.

STEP 2

- Insert hardware **A1** onto panel **(5)** and **(6)**. (Repeat **4** times.)
- Insert hardware **A2** onto panel **(5)** and **(6)**. (Repeat **8** times.)
- Insert hardware **B** onto panel **(5)**, **(6)** and **(7)**. (Repeat **20** times.)

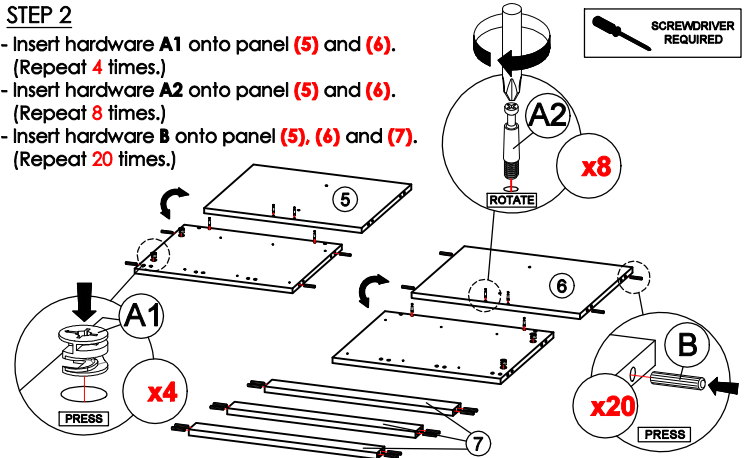

* Ensure the arrows on hardware **A1** point towards mounting positions.

STEP 4

- Insert hardware **A2** onto panel **(16)** and **(17)**. (Repeat **4** times.)
- Insert hardware **B** onto panel **(16)**, **(17)**, **(20)** and **(21)**. (Repeat **12** times.)

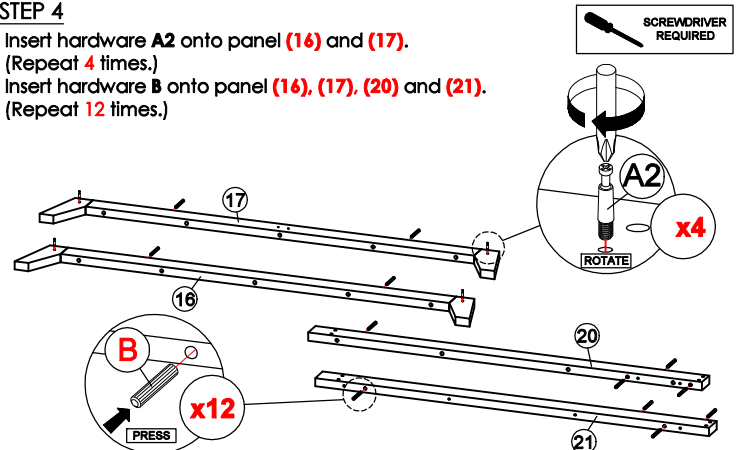

CODING
- 124057

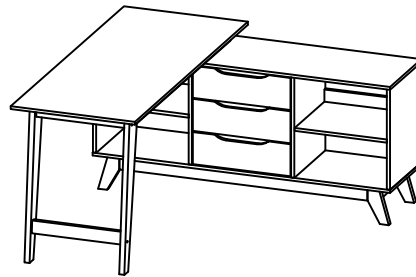

ISO 9001:2015
Reg. No. 000435-1-MY-1-QMS

nuhoom.com

STEP 5

- Insert hardware **B** onto panel **(23)**.
(Repeat **2** times.)
- Insert hardware **C** onto panel **(25)** and **(26)**.
(Repeat **4** times.)

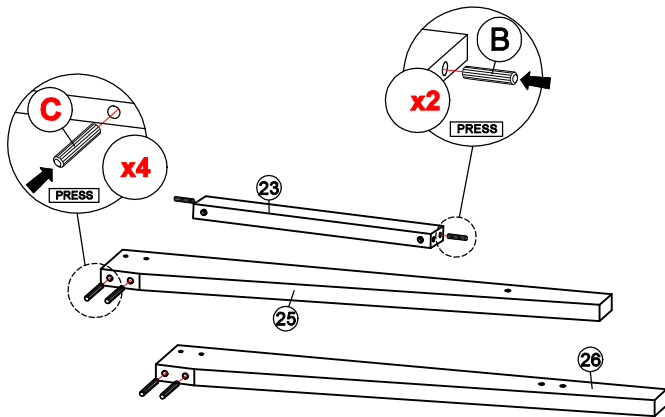

STEP 6

- Fix hardware **O1 (L)** into panel **(5)** with hardware **G**.
(Repeat **3** times for each hardware.)
- Fix hardware **O1 (R)** into panel **(6)** with hardware **G**.
(Repeat **3** times for each hardware.)

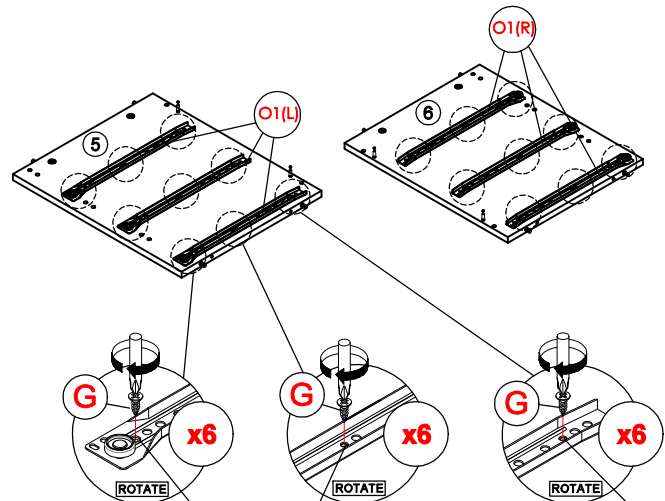

First hole from the edge. Small hole at the center. Third hole from the edge.

STEP 7

- Attach panel **(9)** to panel **(5)** and **(6)**.
- Insert all hardware **A2** into **A1**.
- Rotate all **A1** until tight.
- Apply **A3** onto all **A1**.
(Repeat **4** times.)

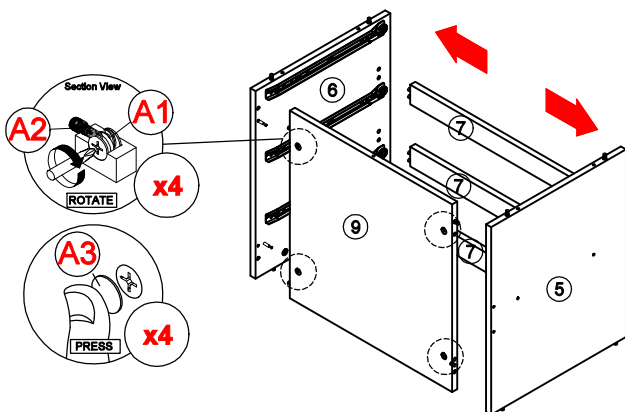
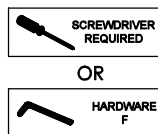

STEP 8

- Attach panel **(8)** to panel **(4)** and **(6)**.
- Attach panel **(8)** to panel **(3)** and **(5)**.
- Insert all hardware **A2** into **A1**.
- Rotate all **A1** until tight.
- Apply **A3** onto all **A1**.
(Repeat **8** times.)

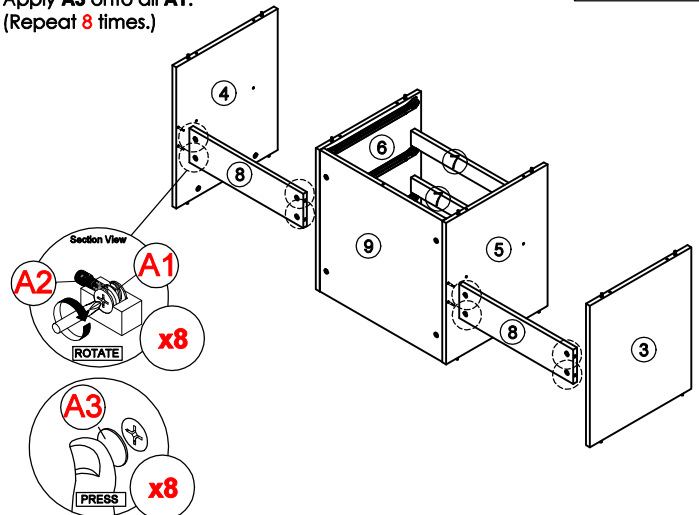
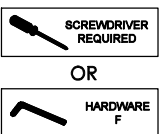

* In this step hardware **A1**, **A2** and **B** are pre-inserted.

* In this step hardware **A1**, **A2** and **B** are pre-inserted.

CODING
- 124057

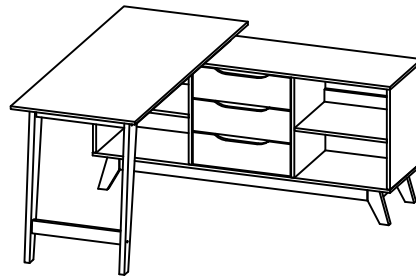

ISO 9001:2015
Reg. No. 000435-1-MY-1-QMS

nuhoom.com

STEP 9

Connect panel (2) to panel (3), (4), (5), (6) and (9) by using hardware D and F. (Repeat 9 times.)



SCREWDRIVER REQUIRED

OR



HARDWARE F

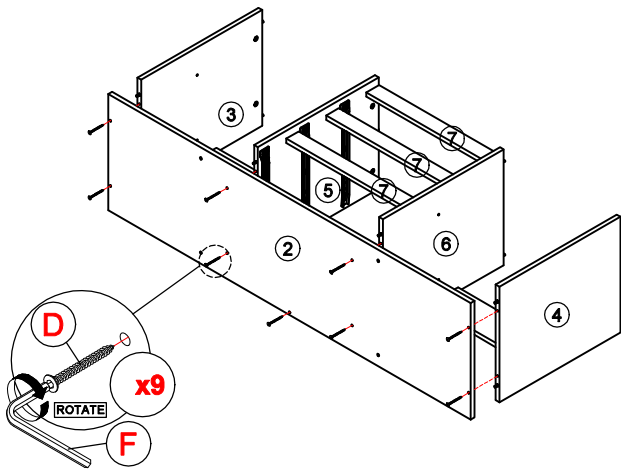

STEP 10

- Attach panel (15) to panel (16) and (17).
- Insert all hardware A2 into A1.
- Rotate all A1 until tight.
- Apply A3 onto all A1. (Repeat 4 times.)

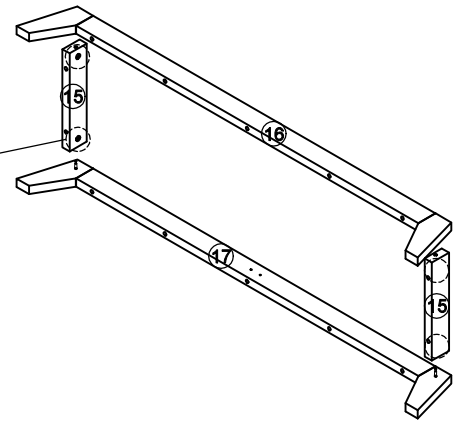
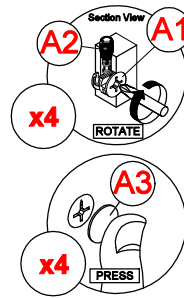

* In this step hardware B are pre-inserted.

STEP 11

- Assemble panel (2) to panel (15), (16) and (17) by using hardware I. (Repeat 14 times.)
- Assemble panel (18) to panel (17) by using hardware H. (Repeat 2 times.)
- Hit hardware N into bottom of panel (16), (17) and (18). (Repeat 5 times.)



AND



SCREWDRIVER REQUIRED

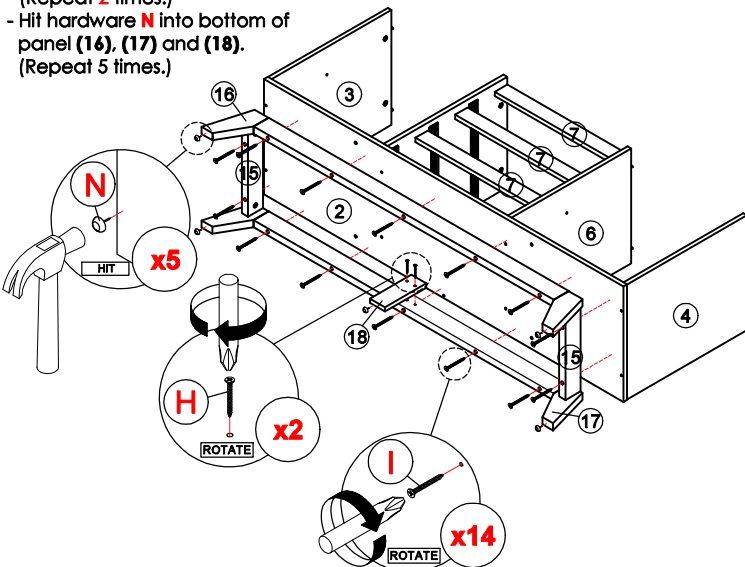

* In this step hardware A1 and A2 are pre-inserted.

STEP 12

Insert hardware L into mounting positions on panel (3), (4), (5) and (6) by hand. (Repeat 8 times.)

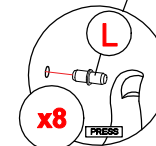
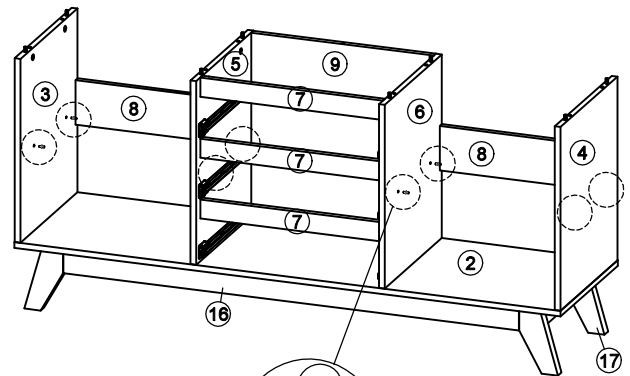

CODING
- 124057

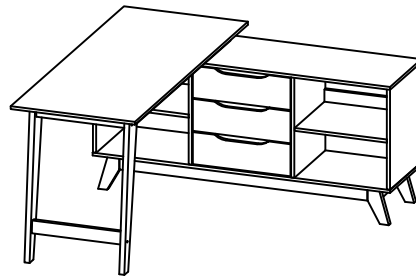

ISO 9001:2015
Reg. No. 000436-1-MY-1-QMS

nuhoom.com

STEP 13

- Assemble the panel (10) into between panel (3) and (5). (Repeat 1 times.)
- Assemble the panel (10) into between panel (4) and (6). (Repeat 1 times.)

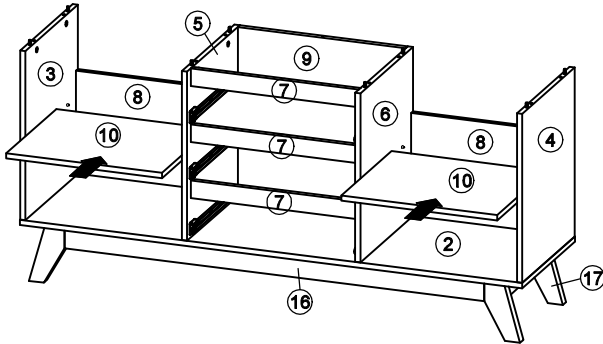

STEP 14

- Connect panel (20) and (21) to panel (22) by using hardware E and F. (Repeat 8 times.)

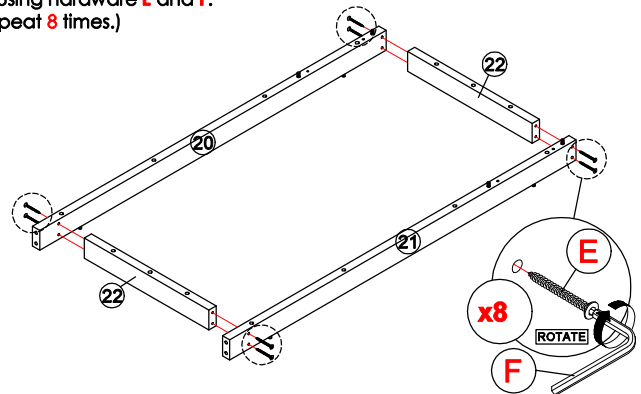

STEP 15

- Assemble panel (24) to panel (20) and (21) by using hardware H. (Repeat 4 times.)

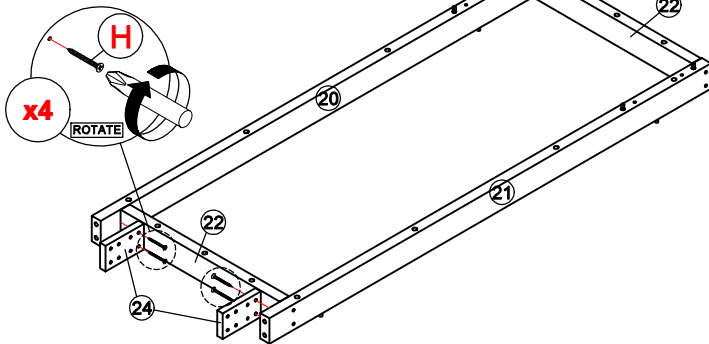

* In this step hardware B are pre-inserted.

STEP 16

- Connect panel (23) to panel (25) and (26) by using hardware F, J and K. (Repeat 2 times.)

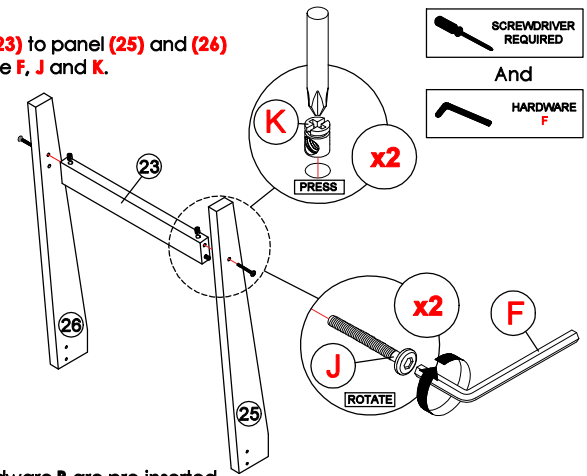
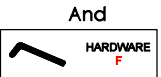

*part (24) shall be leaning against panel (22) when assembling.

STEP 17

- Attach panel (20) and (21) to panel (25) and (26).
- Assemble panel (24) to panel (25) and (26) by using hardware H. (Repeat 12 times.)

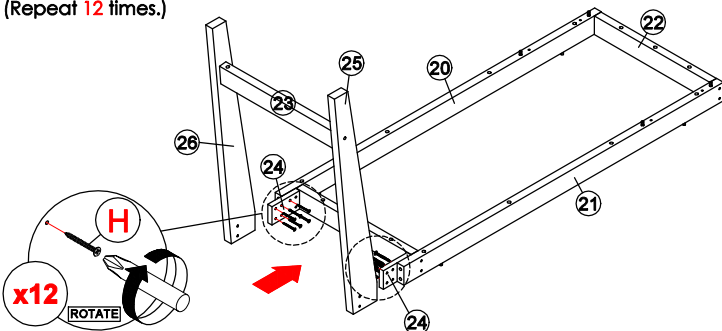

* In this step hardware B are pre-inserted.

STEP 18

- Connect panel (22) to panel (25) and (26) by using hardware E and F. (Repeat 4 times.)

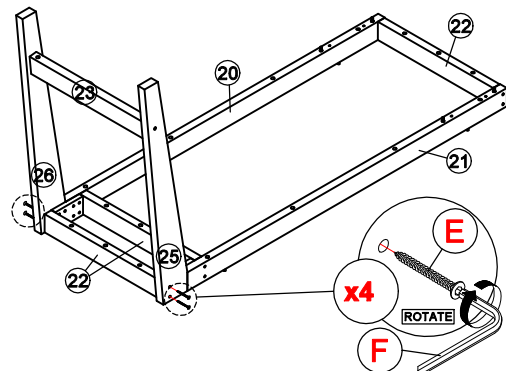

* In this step hardware C are pre-inserted.

CODING
- 124057

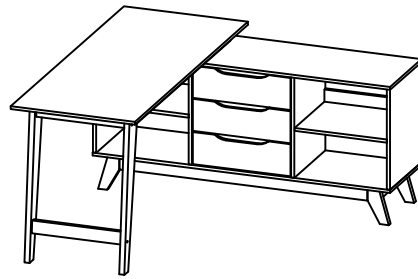

ISO 9001:2015
Reg. No. 000436-1-MY-1-QMS

nuhoom.com

STEP 19
Assemble panel (19) to panel (20), (21) and (22) by using hardware I.
(Repeat 17 times.)

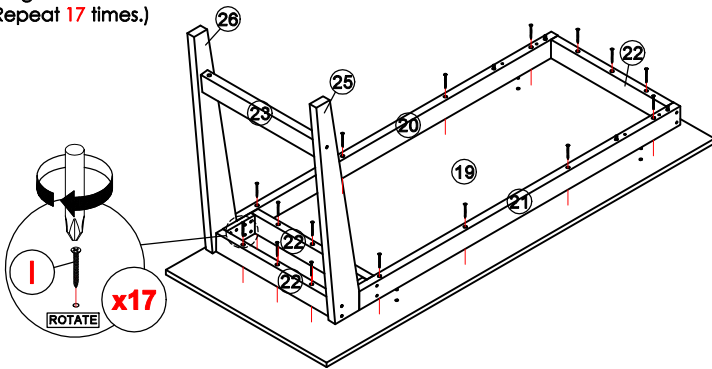

STEP 20
Hit hardware N into bottom of panel (25) and (26).
(Repeat 2 times.)

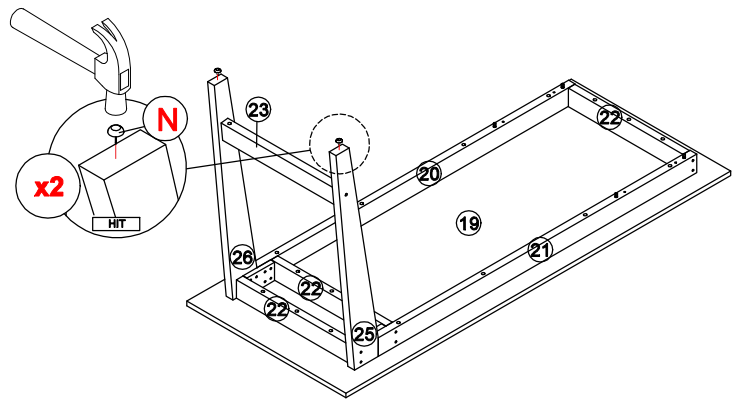

* In this step hardware B are pre-inserted.

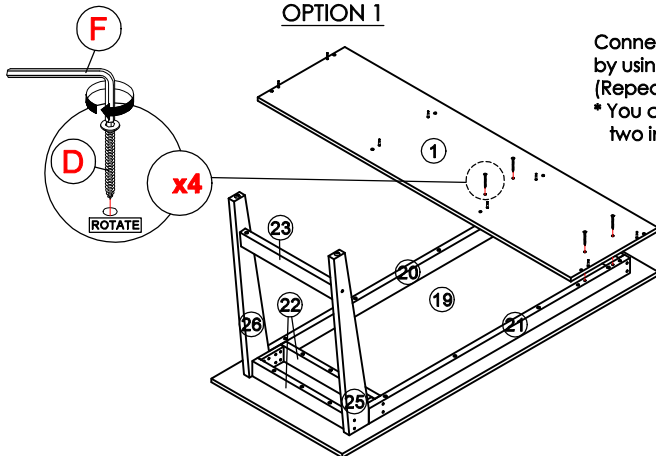

STEP 21
Connect panel (1) to panel (20) and (21) by using hardware D and F.
(Repeat 4 times.)
* You can install this cabinet using two installation methods

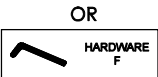
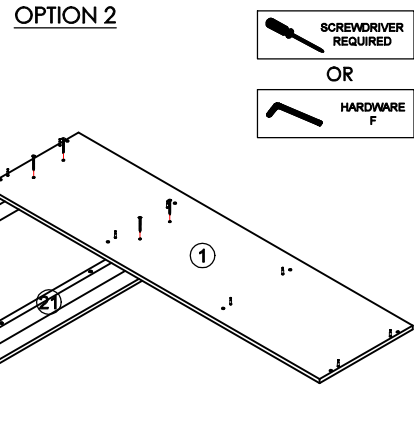

* In this step hardware B are pre-inserted.

STEP 22
- Attach panel (1) to panel (3), (4), (5) and (6).
- Insert all hardware A2 into A1.
- Rotate all A1 until tight.
- Apply A3 onto all A1.
(Repeat 8 times.)
* You can install this cabinet using two installation methods

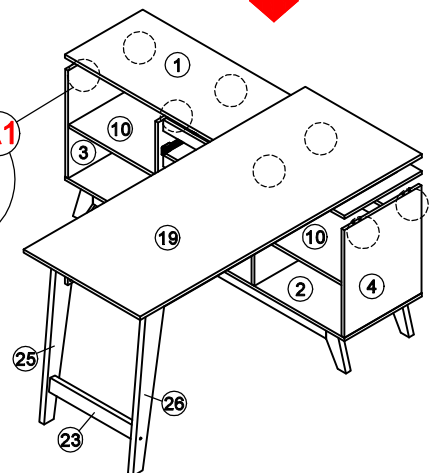
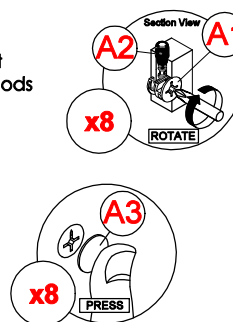
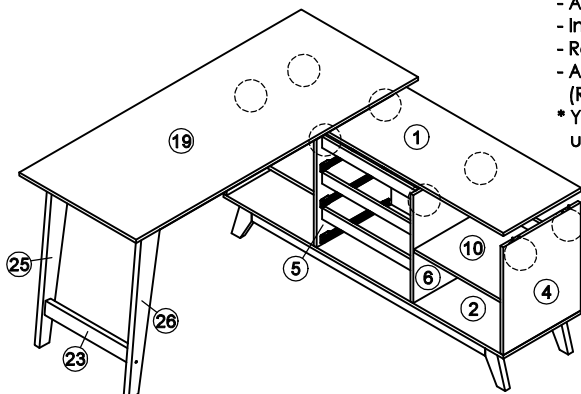

* In this step hardware A1, A2 and B are pre-inserted.

CODING
- 124057

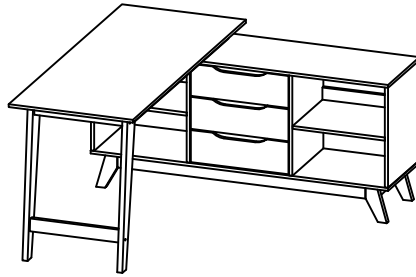

ISO 9001:2015
Reg. No. 000436-1-MY-1-QMS

nuhoom.com

STEP 23

Assemble panel (13) to panel (11) and (12) by using hardware I.
(Repeat 24 times.)
* In this step only show one of the drawers.



STEP 24

Assemble panel (14) to entire body with hardware M.
(Repeat 24 times.)
* In this step only show one of the drawers.

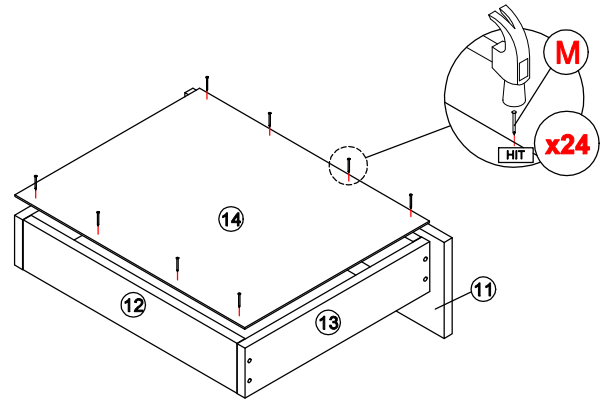
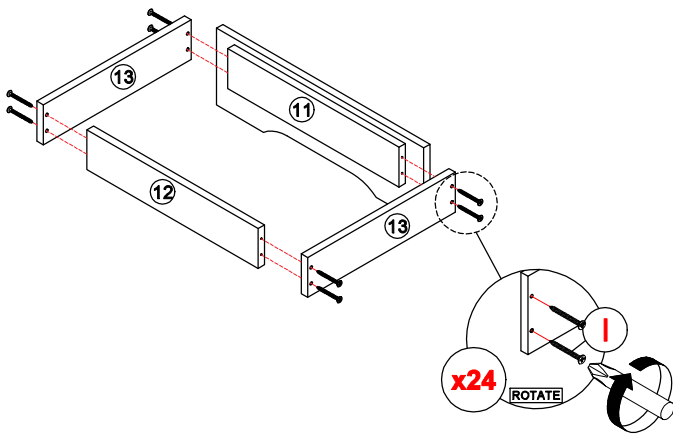

STEP 25

Assemble hardware O2 (L/R) to panel (14) by using hardware G.
(Repeat 3 times for each hardware.)
* In this step only show one of the drawers.



STEP 26

Put all the drawer in place along the drawer slides.

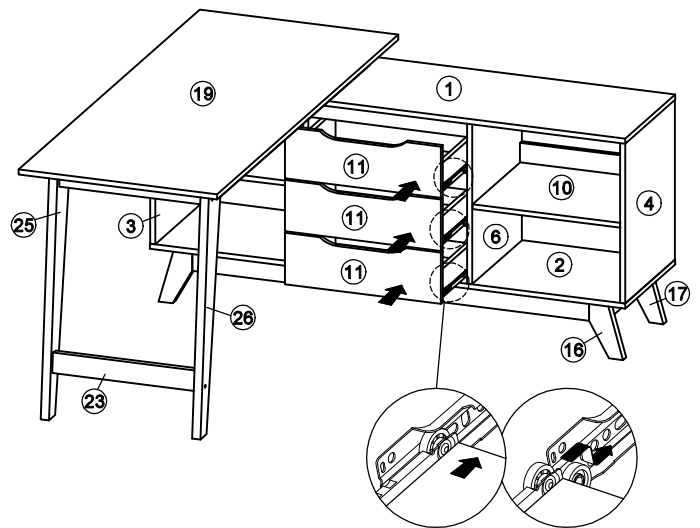
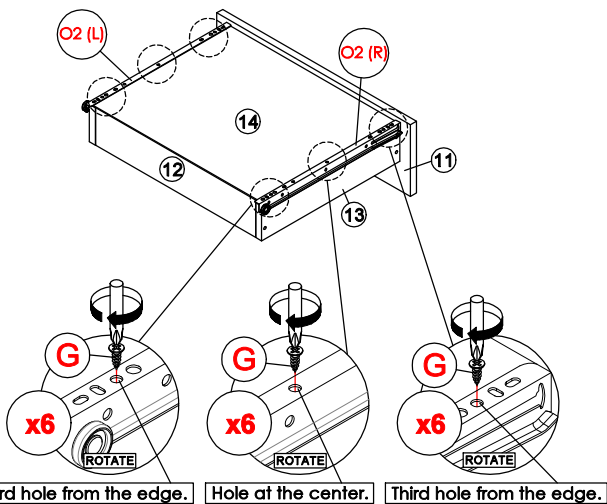

*Hardware O2 (L/R) shall be leaning against panel (11) when assembling.